

Glenn D. Strait
REGISTERED LAND SURVEYOR

LAND PLANNING
CITY LOTS
ACREAGES
SUBDIVISIONS

TOPOGRAPHIC
MORTGAGE
TIMBER
HOUSE PLANS

January 11, 1971

Ed P. Stanley Survey JO. S-7017
Southwest $\frac{1}{4}$ Section 27, T 1 N, R 10 E, WM.

I established the West $\frac{1}{16}$ corner of the Southwest $\frac{1}{4}$ of Section 27 by dividing the total distance of the West line of the Southwest $\frac{1}{4}$ of Section 27, of which I found the West $\frac{1}{4}$ corner of said Section 27 and the Southwest corner of said Section, as shown on plat.

I established the East $\frac{1}{16}$ corner of said Southwest $\frac{1}{4}$ by the same method, as shown. I found the South $\frac{1}{4}$ corner of said Section 27 with witness stumps and trees in place as shown, I also used the Steel Plate on the fence post for the center of Section 27 as accepted by Hood River County. I found the North $\frac{1}{16}$ corner of said Southwest $\frac{1}{4}$ and the South $\frac{1}{16}$ corner as shown on my plat and which was shown on plats of record. Then proceeded as shown on plat.

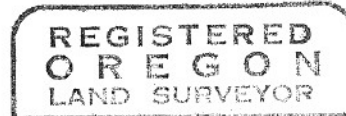

Glenn D. Strait

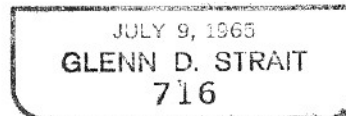

FILED

SEP 30 1971
Carlos Van Elsberg
COUNTY SURVEYOR

By _____
DEPUTY