

CONSULTING
Engineers TENNESON ENGINEERING CORPORATION

PHONE Cypress 6-9177
412 WEST SECOND PLACE
THE DALLES, ORE. 97058

June 1, 1966

FIELD NOTES

FOR: Hines Lumber Company - Work Order #3586-66 - Survey of Hardboard Plant Site in the Northwest one-quarter of Section 7, Township 1 North, Range 10 East of the Willamette Meridian, Hood River County, Oregon.

CREW: Verl R. Fraley, Party Chief and Registered Oregon Land Surveyor #183
Rollo Solvester, Chainman
Lowell Finn, Chainman

DATE PERFORMED: May 13-23, 1966

WEATHER: Fair

REFERENCE: 18" X 24" Map #3586-66 Hardboard Plant

On April 28, 1966, our firm was retained by the Edward Hines Lumber Company at Dee, Oregon to survey and mark with proper monuments their Plant Site together with the preparation of a legal description. They also required drafting a map showing building locations and facilities.

Before beginning the survey, we obtained a map from the Oregon Highway Department entitled, "North Unit, Dee - Parkdale Section, Hood River Highway, Drawing No. 5B-31-15". This map shows a tie from Station 32 + 88.2 P.I. to the Northwest corner of Lot 7, which is an iron bolt. On the Easterly right-of-way line, at Stations 31 + 46.7 P.C. and 34 + 28.8 P.T., we found iron rods and right-of-way posts. From these points, we re-established the centerline P.I. and then traversed to the Northeast corner of the Hardboard Plant Site survey. A distance and bearing was computed from the Northwest corner of Section 7 to a nail on the centerline of the East end of the bridge, which we used for the Point of Beginning of the legal description.

State Highway Bearings were used on this survey.

The attached 18" X 24 map, which is by reference made a part of these notes, shows the distances, bearings, and points established on this survey.

1
IN-10-7

FIELD NOTES
Edward Hines Lumber Company
June 1, 1966

Page -2-

I certify that this work was done under my direct supervision.

Signed Verl R. Fraley
Verl R. Fraley, Oregon Land Surveyor No. 183

CHECKED AND APPROVED:

TENNESON ENGINEERING CORPORATION

Donald J. Branton
Donald J. Branton, President

DJB:kkk

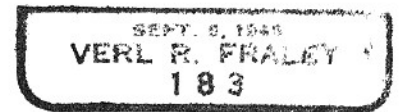
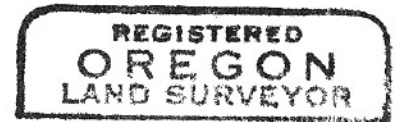

FILED

APR 29 1969

Charles Van Elsberg
COUNTY SURVEYOR