

CONSULTING
Engineers — TENNESON ENGINEERING CORPORATION

PHONE (503) 296-9177
 412 WEST SECOND PLACE
 THE DALLES, ORE. 97058

August 4, 1967

Plot Filed: SE 1/4 Sec 35 T3N R10EWM
 Plot # 20

FIELD NOTES

FOR: Work Order #3708-67 - Survey for Building Development Service (Anderson Mortuary) in the Northeast one-quarter of the Southeast one-quarter of Section 35, Township 3 North, Range 10 East, Willamette Meridian, Hood River County, Oregon.

CREW: Verl R. Fraley - Reg. Oregon Land Surveyor #183
 Dave Tuttle - Instrumentman
 Larry Jones - Chainman

DATES PERFORMED: July 19, 20, 25, 26 and 28, 1967

WEATHER: Fair

REFERENCE: 8 1/2" x 11" map 1"=100' - Work Order #3708-67
 Official Plat Maps of Stranahans 1st, 2nd and 3rd Additions.

On July 18, 1967, our firm was retained by the Building Development Service to survey a new site for the Anderson Mortuary.

A legal description was furnished us and we surveyed the tract according to it. This survey revealed the following discrepancies. Near the Northwest corner of the tract a 2 1/2" iron pin 3' high was found to be 2.3 feet East. At the Southwest corner of the tract a 1/2" iron pin 6" deep was found to be 2.4 feet East. The length of the tract to this found 1/2" iron pin was found to be about 20 feet short. The true centerline of Belmont Road has been questionable. A centerline as established from a iron pin at 12th and the Jenkins D.L.C. corner at 18th falls about 5 feet South of the centerline as determined by splitting the pavement. The true centerline of Belmont was established by measuring 30 feet from the South line of Stranahan's 1st and 2nd Additions. Several lot corners were found in the two additions to get the South plat line established. A 10.19 foot jog in the North line of Belmont was found at the North line of 14th Street. This is a common line between Stranahan's 2nd and 3rd Additions.

No record could be found for the dedication of Belmont Road from 12th to 14th Streets. Stranahan's 3rd Addition dedicates the North 30 feet from 14th to 18th Streets.

The South right-of-way line of Belmont Road was established 30 feet South of the Jenkins D.L.C. corner at 18th Street and 30 feet South of the point of intersection of the centerline of Belmont Road (as established from Stranahan's 1st and 2nd Additions) with the centerline of 12th Street.

In order to get the West and South lines of the tract accurately located, we projected the West line South to intersect the centerline of King Street where we found nails in the pavement at 50 foot intervals. On the North line of King Street we found a iron pin lot corner and a nail for another lot corner. These were 20 feet from the centerline. We completed our traverse back to the 1/2" iron pin at the Southwest corner of the Mortuary Tract. By using deed call distances and bearings we were

FIELD NOTES

Building Development Service (Anderson Mortuary)

Work Order #3708-67

August 4, 1967

Page -2-

1.0 feet South and 2 feet East of the 1/2" iron pin. By surveying the tract from the furnished legal description, the Southwest corner hit 2.4 feet West. Therefore to avoid any encroachments on other property, we decided to accept the found 1/2" iron pin for the true corner of the Mortuary Tract. Iron rods were set at the other 3 corners. A 2 1/2" iron pin 3' high was found to be 3' South and 0.2 feet East of our Northwest corner. On the South line of the tract, the deed bearing was used. This coincided well with a cyclone fence to the East. However; the distance from our Southeast corner to the cyclone fence corner was only 58 feet and it should have been about 78 feet according to a scaled distance on a map we prepared from the various deeds.

Deed bearings were used on the survey. The South 0° 15' East on 12th Street we accepted as true.

The attached map, which is by reference made a part of these notes, shows the distances, bearings and points established on this survey.

I certify that this work was done under my direct supervision.

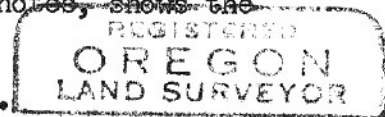

SIGNED Verl R. Fraley
Verl R. Fraley, Oregon Land Surveyor #183

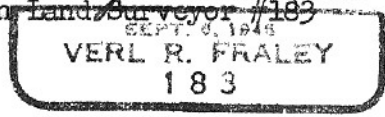

CHECKED AND APPROVED

TENNESON ENGINEERING CORPORATION

Donald J. Branton
Donald J. Branton, President



CORRECTED DESCRIPTION
for
Anderson Mortuary

A tract of land located in the Northeast one-quarter of the Southeast one-quarter of Section 35, Township 3 North, Range 10 East, Willamette Meridian, Hood River County, Oregon, more particularly described as follows:

Commencing at official monument no. 16, as located in 1953 and as the same is now located, of the City of Hood River, Oregon which monument is also the quarter section corner common to Sections 35 and 36, Township 3 North, Range 10 East of the Willamette Meridian, as said quarter section corner was located in 1953 and is now located; thence South $0^{\circ} 15'$ East along the Section line between said Sections 35 and 36 as determined by the aforesaid quarter Section corner a distance of 236.86 feet to its intersection with the centerline of Belmont Road (as determined from the South line of Stranahans 1st and 2nd Additions); thence along said centerline North $89^{\circ} 15' 21''$ West 437.60 feet to the true point of beginning of this description; thence parallel with the East line of said Section 35 South $0^{\circ} 15'$ East 363.55 feet; thence North $87^{\circ} 57'$ West 170.50 feet thence parallel with the East line of said Section 35 North $0^{\circ} 15'$ West 359.67 to the said centerline of Belmont Road; thence along said centerline South $89^{\circ} 15' 21''$ East 170.52 feet to the true point of beginning of this description.

EXCEPT: Right-of-way for Belmont Road.

Gross Area	1.42 acres
Area in Belmont Road	0.08 acres
Net Area	1.34 acres more or less

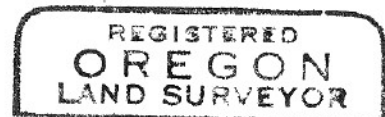

Verl R. Fraley

