

November 1, 1971

Field Notes:

A survey for Mr. Clair Smith of his property located in the SE $\frac{1}{4}$ of Section 26, T3N, R10E, W.M., Hood River County, Oregon.

Crew: R. A. King, L.S.
W. C. Brown, Party Chief
Ed Graham, Chainman

Date completed: October 25, 1971

In October, 1971 Mr. Clair Smith requested a survey of his property for the purpose of establishing a boundary between his residence and his place of business.

Information pertaining to surveys in the area was located in the office of the Hood River County Surveyor.

Points were located on the north and west lines of the property, the angle was determined to be 81°38". To establish the requested line, a point was set at 90.0 feet east of the NW property corner, I occupied this point and turned the aforementioned angle, this line did not fit the existing improvements, therefore it was decided to establish the line at angle of 84°25'. The line as thus established matched the improvements and conforms to the set backs required in the City of Hood River's zoning ordinance.

Monuments found in the course of this survey, NE cor. block 6, A $\frac{1}{2}$ " rebar, and the NW cor. block 1, an iron pipe, of the Oak Crest Addition to the City of Hood River. The NW corner of the Smith property, an iron pipe, a $\frac{1}{2}$ " rebar in the north line of the property 114.3 feet east of the NW cor., a reference pipe on the west property line.

Monuments set in the course of this survey, a rebar was set at the north and south ends of the established line, a rebar was also set 14.18' south on line.

Monuments found and set are shown on the attached drawing, which by reference is made a part of this survey.

W.C. Brown

W. C. Brown
Party Chief

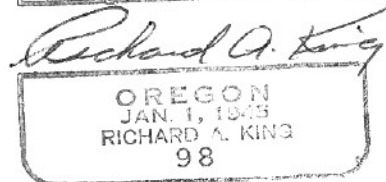
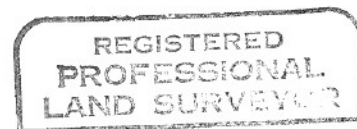

FILED

NOV 2, 1971

Carol Van Elberg
COUNTY SURVEYOR

By

COUNTY