

PRELIMINARY
SUBJECT TO CHANGE
OREGON STATE HIGHWAY DIVISION

Located Line

POLALLIE CREEK - DOG RIVER SECTION

MT. HOOD HIGHWAY

HOOD RIVER COUNTY

Scale: 1 inch = 100 feet

Traced by A.L.D. May, 1981
Revised May 26, 1981

GRID BEARINGS-NORTH ZONE

DRG. NO. 9B-19-8

Note: Coordinates used on this map are on a Local Datum Plane which represents true ground distances. Bearings are Oregon State Grid North Zone. To convert LDP Coordinates to Oregon State Grid North Zone, multiply LDP Coordinates by 0.9997987.

PRELIMINARY
SUBJECT TO CHANGE



PRELIMINARY
SUBJECT TO CHANGE

T.2S., R.10E., WM.
DRG. NO. 9B-19-8

SEE 8B-9-20 FOR PRIOR RW

PRELIMINARY
SUBJECT TO CHANGE

PRELIMINARY
SUBJECT TO CHANGE

3° CL.
Ta 17° 37'
Ts 446.22'
300' Sps.
S 4° 30'
a 1

5° CR.
Ta 64° 17' 15"
Ts 923.50'
400' Sps.
S 10°
a 1.25

U.S.A.
(National Forest)

PRELIMINARY
SUBJECT TO CHANGE

PRELIMINARY
SUBJECT TO CHANGE

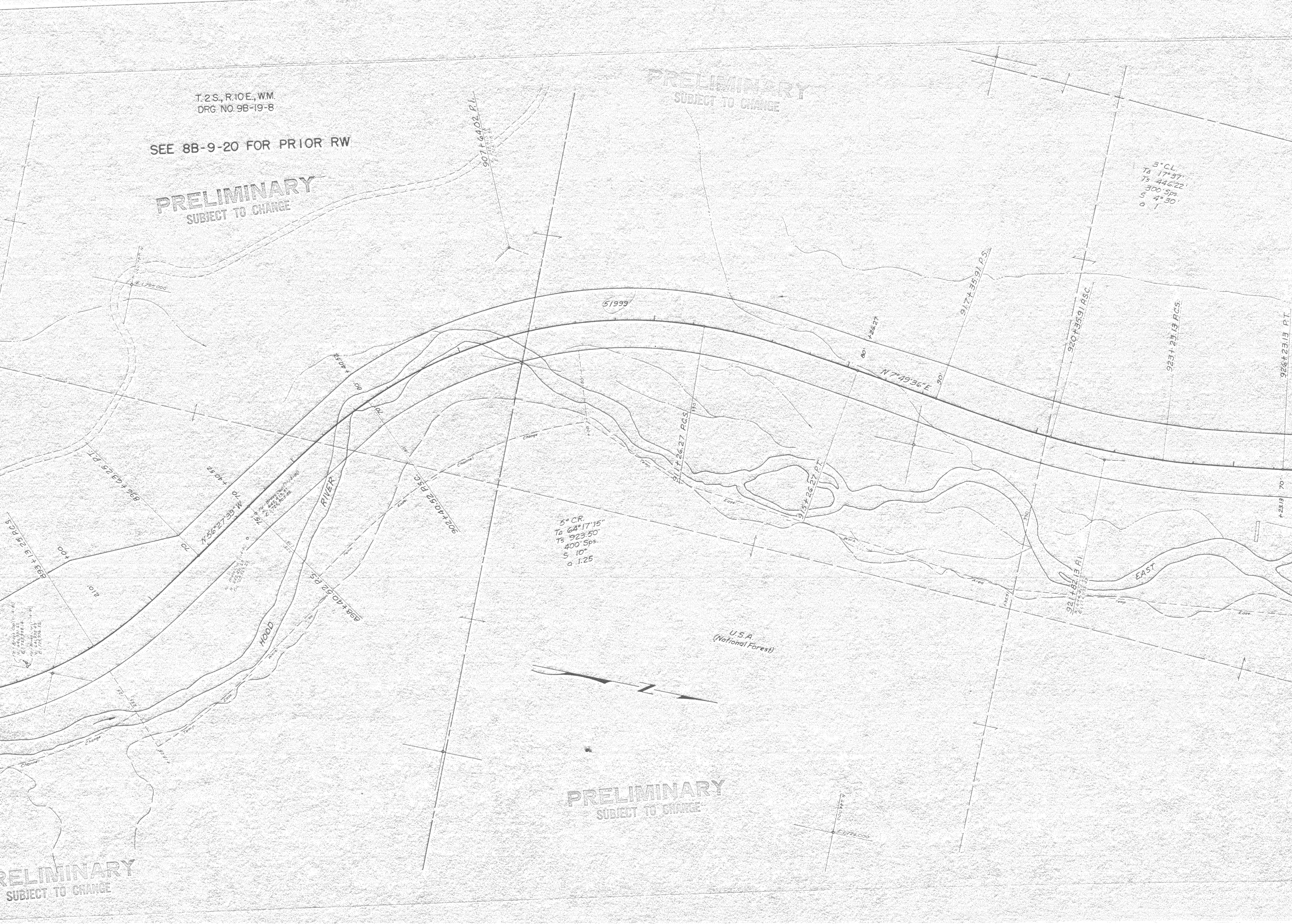

T.I.S., R.I.O.E., W.M.
DRG. NO. 9B-19-8

SEE 8B-9-20 FOR PRIOR RW

PRELIMINARY
SUBJECT TO CHANGE

PRELIMINARY
SUBJECT TO CHANGE

T.I.S., R.I.O.E., W.M.
T2S, R.I.O.E., W.M.

U.S.A.
(National Forest)

N 9° 47' 24" W

FORK

HOOD

RIVER

PRELIMINARY
SUBJECT TO CHANGE

PRELIMINARY
SUBJECT TO CHANGE

CL
7° 57'
46' 22"
5 ps.
30'

9331+23.13 P.C.S.

9241+23.13 P.T.

953+28.85 P.L.

51999

51999

B
10' 11" 128.00
11' 45" 176.68
12' 17" 241.92

946+09.39 P.S.

948+09.39 P.S.C.

1" C.P.
Ta 12° 56'
Ts 749' 46"
200' Sps.
5 1°
d 0.5

PRELIMINARY
SUBJECT TO CHANGE

U.S.A.
(National Forest)

PRELIMINARY
SUBJECT TO CHANGE

6°CL
Ta 49°32'
Ts 592.25
300' Sp.
S 9°
a 2

1°CR
Ta 12°56'
Ts 749.46
200' Sp.
S 1°
a 0.5

2°CR
Ta 10°22'
Ts 359.93
200' Sp.
S 2°
a 1

U.S.A.
(National Forest)

PRELIMINARY
SUBJECT TO CHANGE

PRELIMINARY
SUBJECT TO CHANGE



T. 1 S., R. 10 E., W.M.
DRG. NO. 9B-19-8

SEE 8B-9-20 FOR PRIOR RW

PRELIMINARY
SUBJECT TO CHANGE

PRELIMINARY
SUBJECT TO CHANGE

PRELIMINARY
SUBJECT TO CHANGE

Hood River County
75-683
F 661446

5° CL
Ta 23°17'
Ts 437.09
S 400' Sps
a 10'
a 1.25

5° CR
Ta 28°19'
Ts 496.34
S 400' Sps
a 10'
a 1.25

5° CR
Ta 21°38'
Ts 419.85
S 400' Sps
a 10'
a 1.25

2° CR
Ta 10°22'
Ts 359.93
S 200' Sps
a 1'

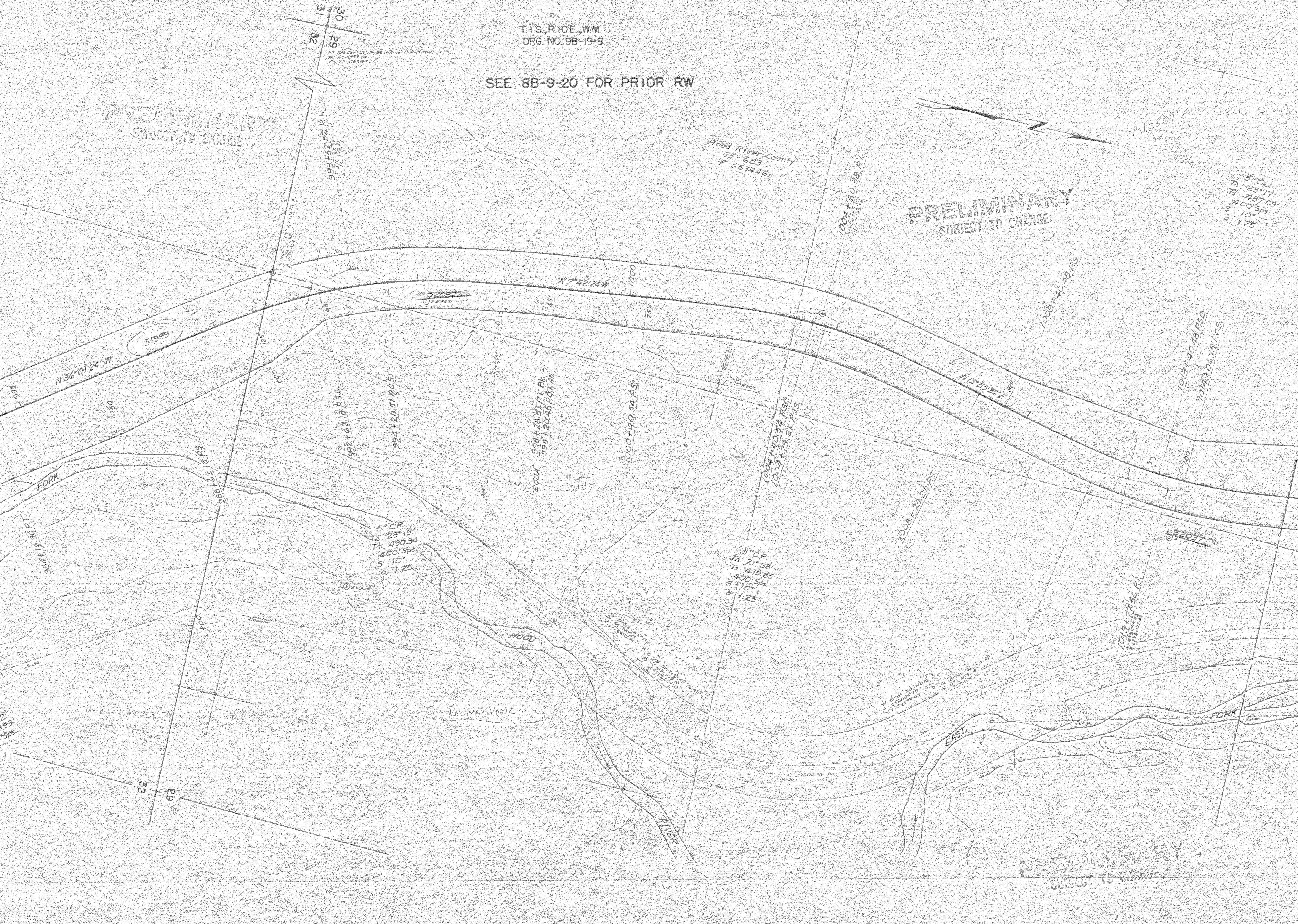

29
32

29
30
31
32

3
4
5
6
7
8
9
10
11
12
13
14
15
16
17
18
19
20
21
22
23
24
25
26
27
28
29
30
31
32

PRELIMINARY
SUBJECT TO CHANGE

PRELIMINARY
SUBJECT TO CHANGE

PRELIMINARY
SUBJECT TO CHANGE

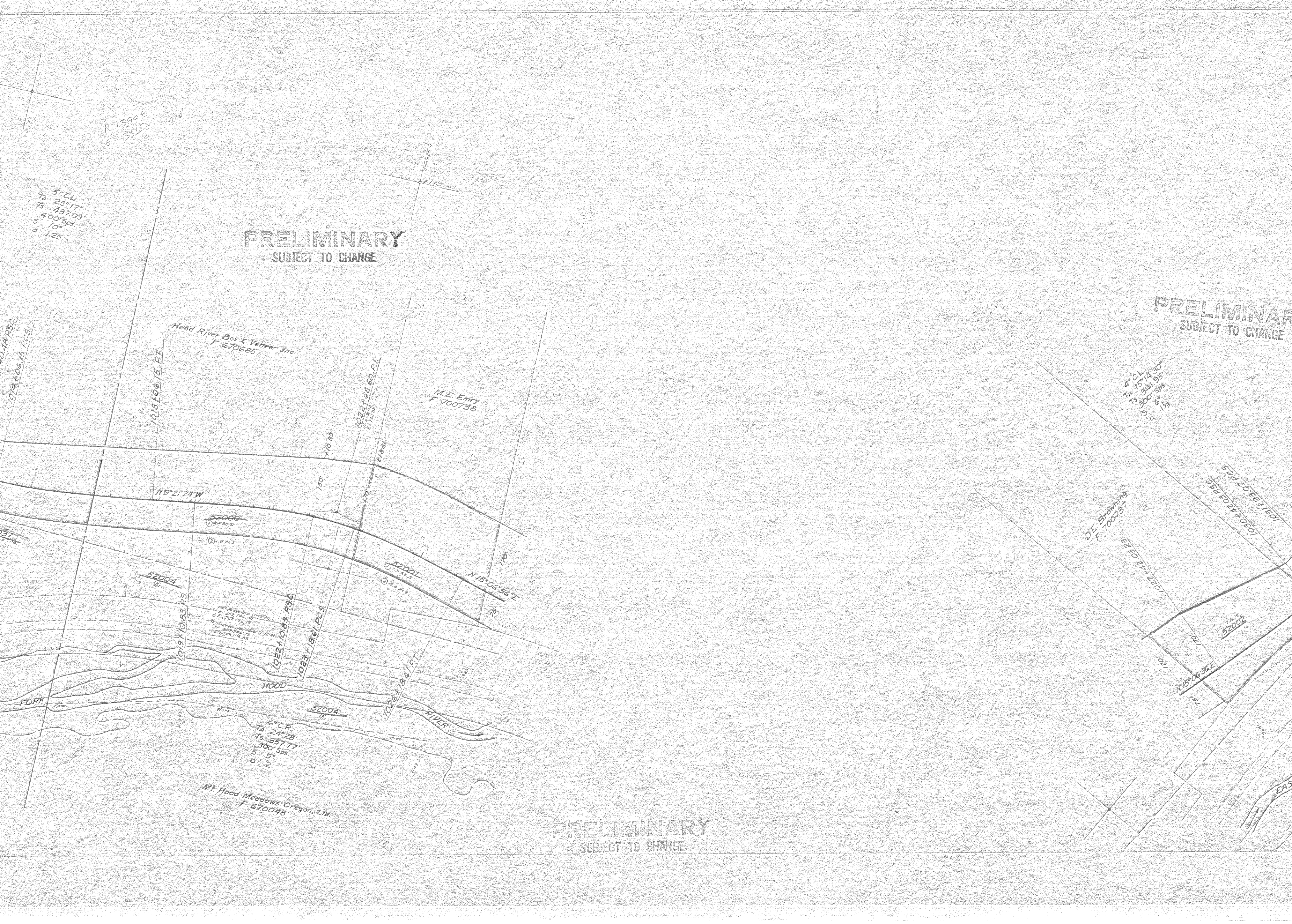

5° CL
TA 23° 17'
TS 437.09'
S 400' Sps.
S 10°
a 1.25

N 1399.61
S 33.15
1900

Hood River Box & Veneer Inc.
F 670685

M.E. Emry
F 700738

DE Browning
F 700737

MT Hood Meadows Oregon, Ltd.
F 670048

52000
0.93 Ac. ±

52001
0.94 Ac. ±

52004

52002

6° C.R.
TA 24° 28'
TS 357.77'
S 300' Sps.
S 9°
a 2

70.48 P.S.G.
10.14 + 0.615 P.C.S.

10.18 + 0.615 P.T.

10.22 + 0.615 P.L.

10.30 + 0.615 P.S.G.

10.31 + 0.615 P.T.

4° CL
TA 15° 43' 30"
TS 324.95'
S 200' Sps.
S 6° 5/8'
a 1/2

N 5° 21' 24" W

N 15° 06' 36" E

N 15° 06' 36" E

FORK

HOOD

RIVER

EAS

PI

PRELIMINARY
SUBJECT TO CHANGE

Mt. Hood Meadows Oregon, Ltd.
F 670048

PRELIMINARY
SUBJECT TO CHANGE

PRELIMINARY
SUBJECT TO CHANGE

POLALLIE CREEK - DOG RIVER SECTION
MT. HOOD HIGHWAY
HOOD RIVER COUNTY
SCALE: 1" = 100'
DRG. NO. 9B-19-8

PRELIMINARY
SUBJECT TO CHANGE

PRELIMINARY
SUBJECT TO CHANGE

PRELIMINARY
SUBJECT TO CHANGE

