

PROFILE

QUANTITY SUMMARY	
Cleaning	5.2 Acres
Comp. RINTEX	21700 CY
Solid Excav	6000 CY
Overhaul	1100 SYD
12" Culverts	270 LF
24" Culverts	60 LF
Guard Fence	300 LF
Changing Trout Creek	

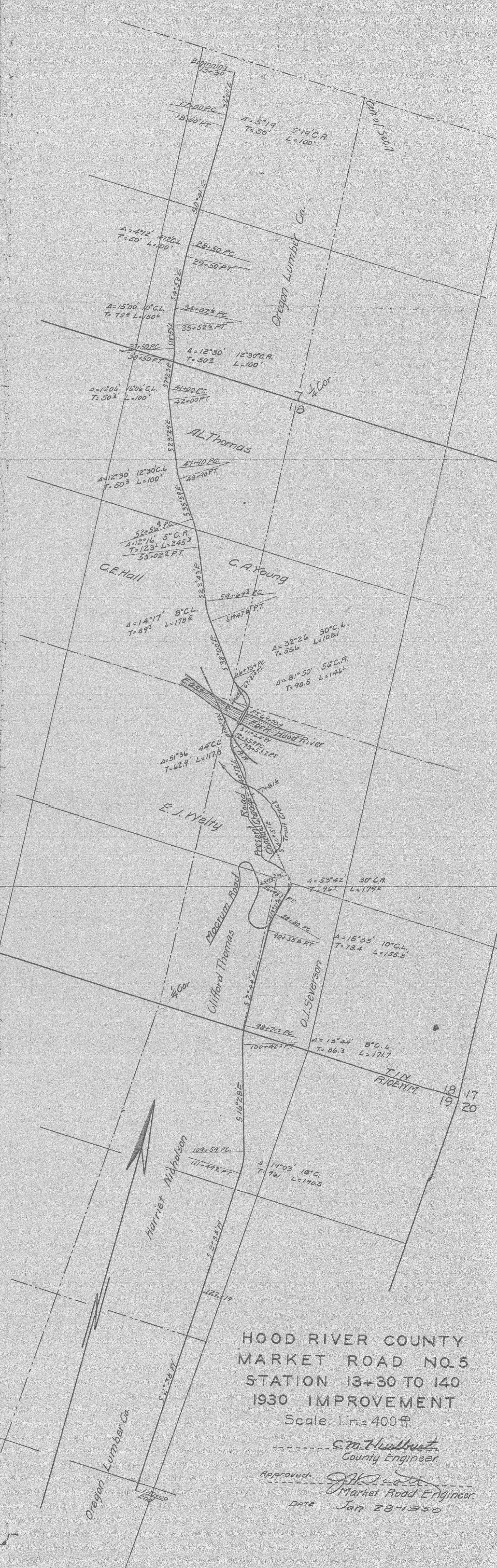

HOOD RIVER COUNTY
 MARKET ROAD NO. 5
 STATION 13+30 TO 140
 1930 IMPROVEMENT
 Scale: 1 in. = 400 ft.

S.M. Hulbert
 County Engineer.
 Approved: J.W. Scott
 Market Road Engineer.
 DATE Jan 28-1930