

Overall Length of Project 0.53 Mile

| INDEX OF SHEETS |                   |
|-----------------|-------------------|
| SHEET NO.       | DESCRIPTION       |
| 1               | Title Sheet       |
| 2, 2A           | Typical Section   |
| 2B, 2C          | Details & Summary |
| 2D              | Pipe Data         |
| 3-4             | Plan & Profile    |

- Drq. Nos.
- 2050-Manholes & Feathering
  - 2050A-Manholes
  - 2105-Inlets
  - 2077-Concrete Curbs & Driveways
  - 2091-Culverts
  - 2112-Sloped Ends
  - 2121 " "
  - 9796-Box Culvert
  - 12950 " "
  - 17292 " "
  - 21052-Retaining Wall

STATE OF OREGON  
STATE HIGHWAY DEPARTMENT

PLANS FOR PROPOSED PROJECT  
GRADING & PAVING  
**INDIAN CREEK SECTION**  
HOOD RIVER HIGHWAY  
HOOD RIVER COUNTY  
JULY, 1967

|   |        |                |             |              |             |
|---|--------|----------------|-------------|--------------|-------------|
| INDIAN CREEK SECTION<br>HOOD RIVER HIGHWAY<br>HOOD RIVER COUNTY |        |                |             |              | SHEET No. 1 |
| FED. ROAD Div. No.  | STATE  | PROJECT NUMBER | FISCAL YEAR | TOTAL SHEETS |             |
| 8   | OREGON | STATE SAFETY   |             | See Index    |             |

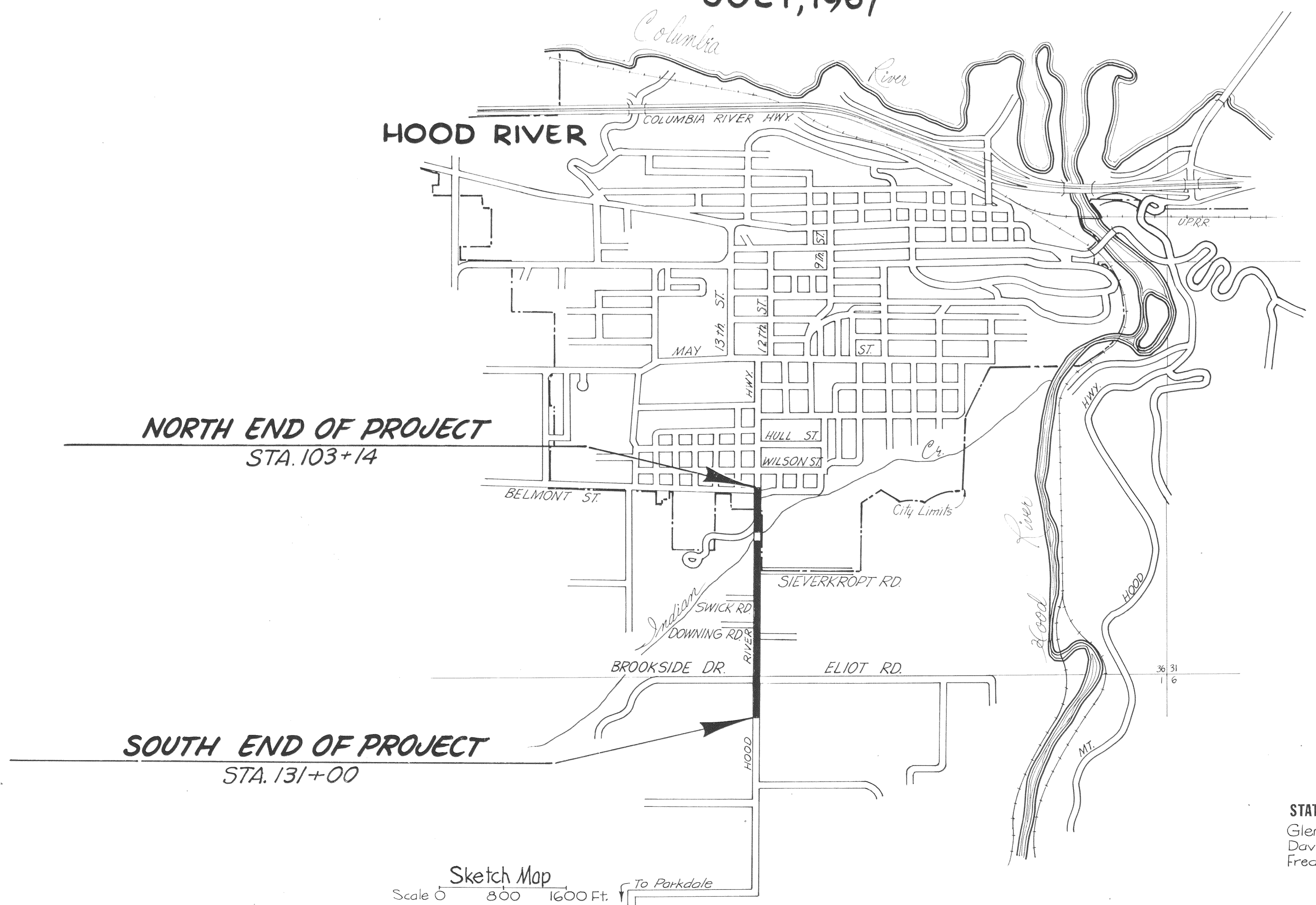
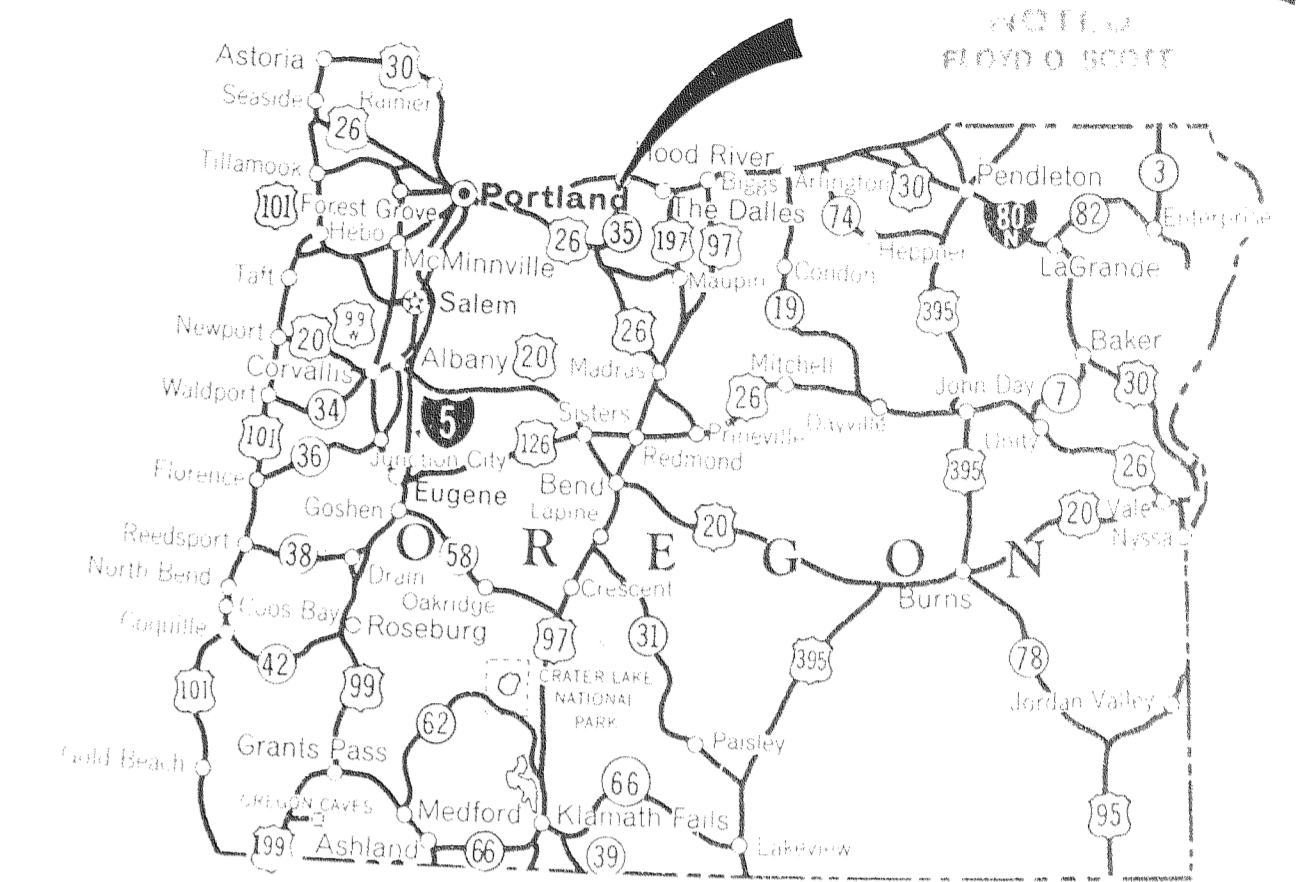

AS CONSTRUCTED  
August, 1968  
J. B. Sawyer, Res. Engr.

9F 14-12  
SH 1



STATE HIGHWAY ENGINEER

STATE HIGHWAY COMMISSION  
Glenn L. Jackson, Chairman  
David B. Simpson, Commissioner  
Fred W. Hill, Commissioner

|  |       |
|--|-------|
| DEPARTMENT OF COMMERCE<br>BUREAU OF PUBLIC ROADS |       |
| APPROVED:  | DATE: |
| DISTRICT ENGINEER                                |       |

Sketch Map  
Scale 0 800 1600 Ft. To Parkdale

# TYPICAL SECTIONS

|                             |        |                |             |              |
|-----------------------------|--------|----------------|-------------|--------------|
| <b>INDIAN CREEK SECTION</b> |        |                |             | SHEET No.    |
| HOOD RIVER HIGHWAY          |        |                |             | 2            |
| HOOD RIVER COUNTY           |        |                |             |              |
| FED. ROAD Div. No.          | STATE  | PROJECT NUMBER | FISCAL YEAR | TOTAL SHEETS |
| 8                           | OREGON | STATE          |             | See Index    |

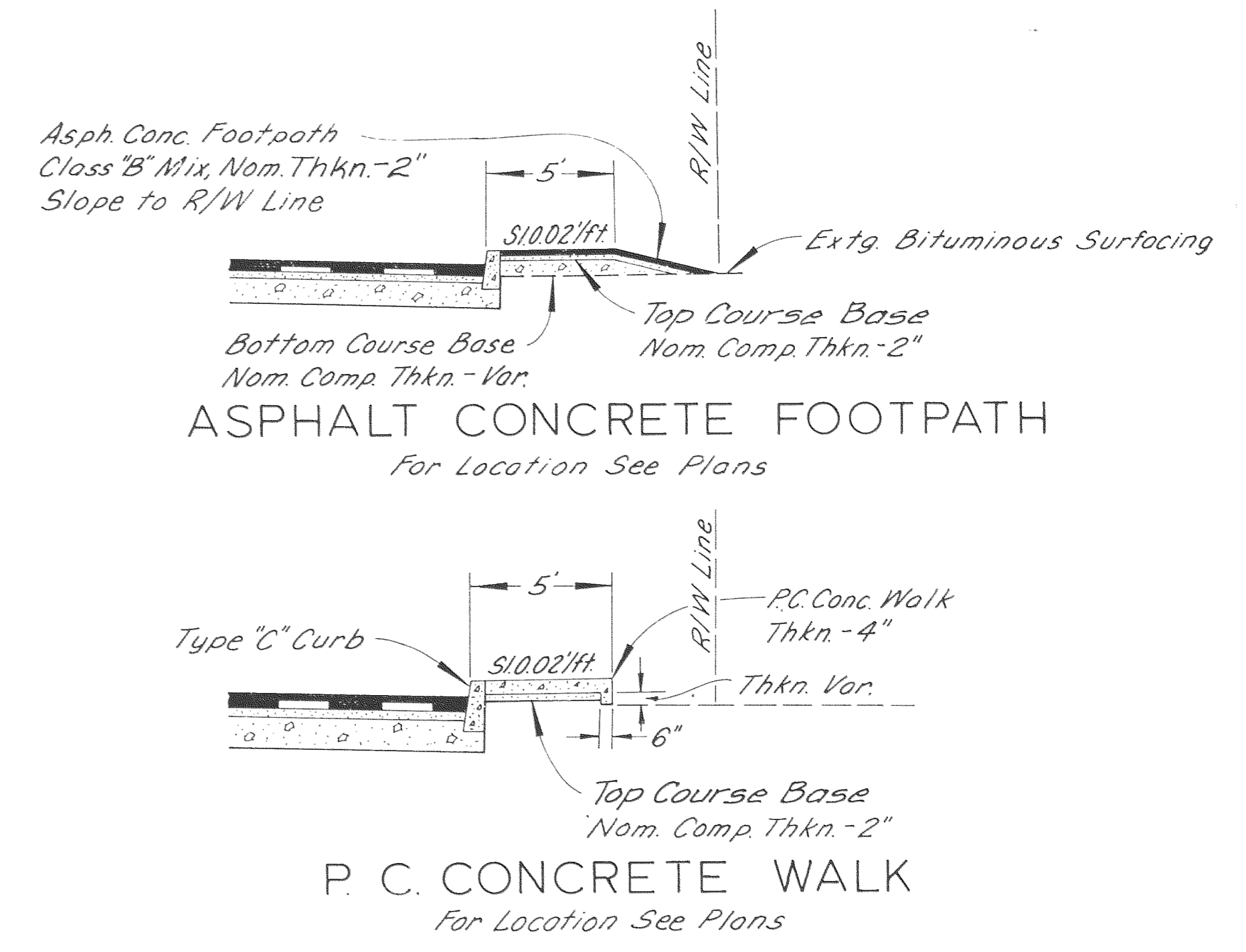
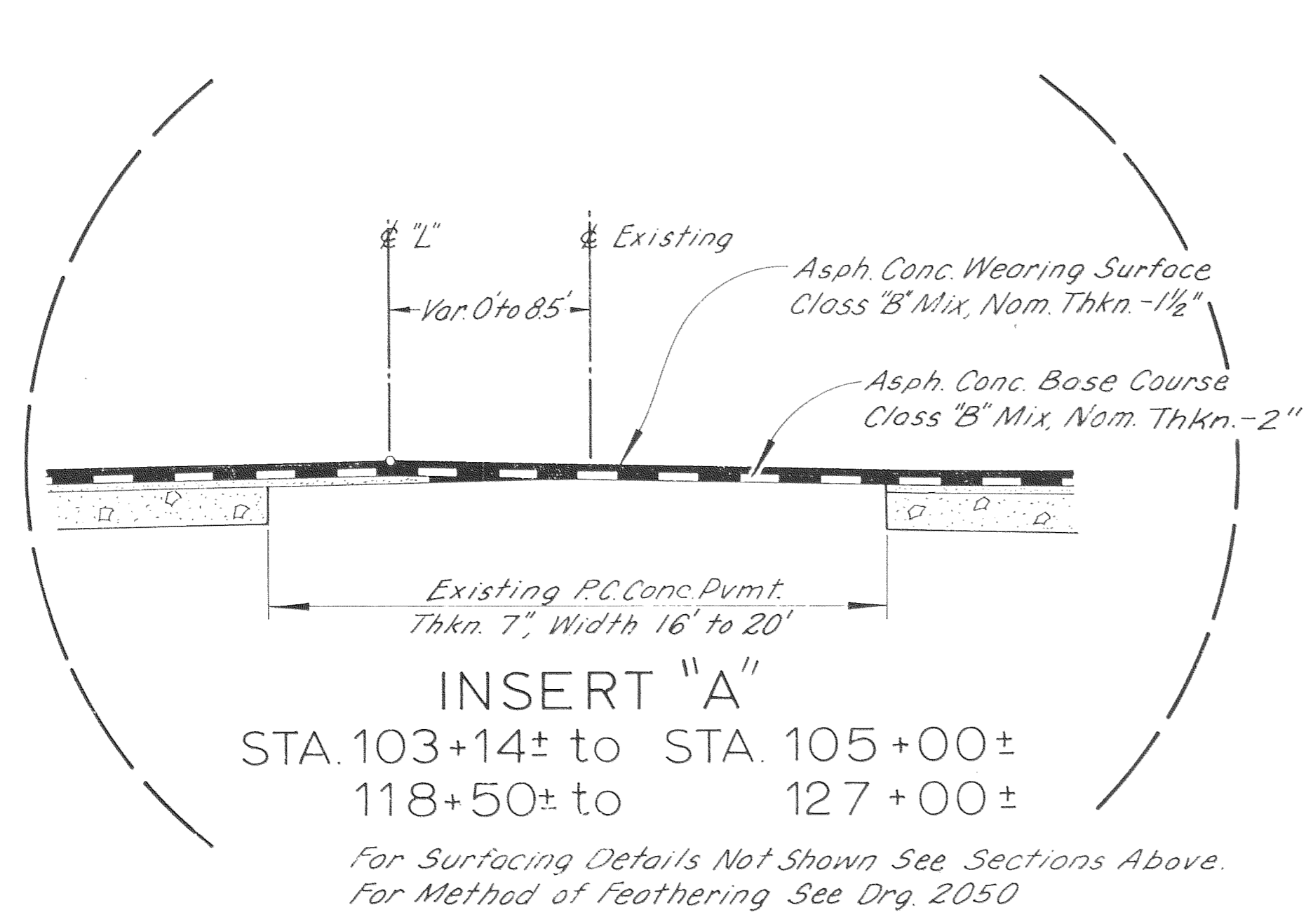
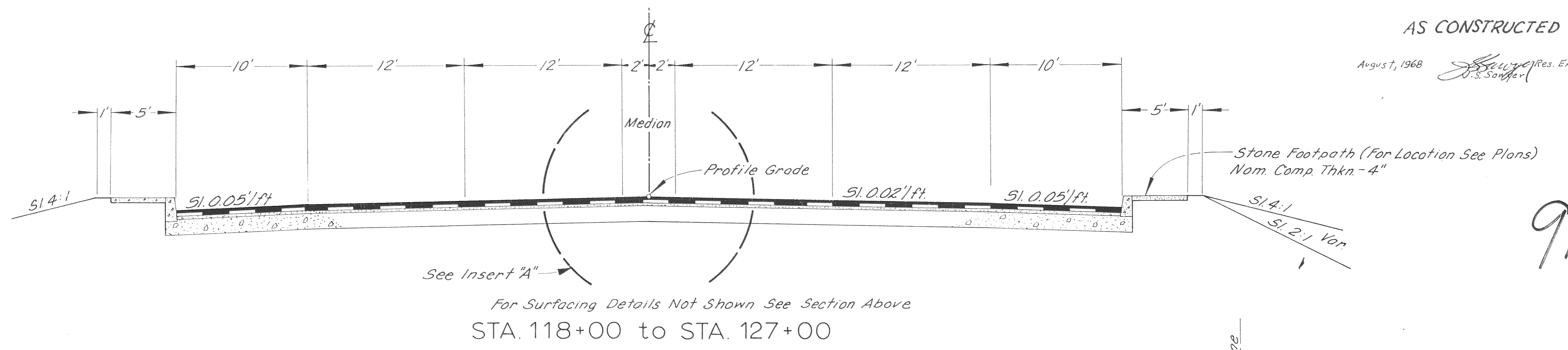
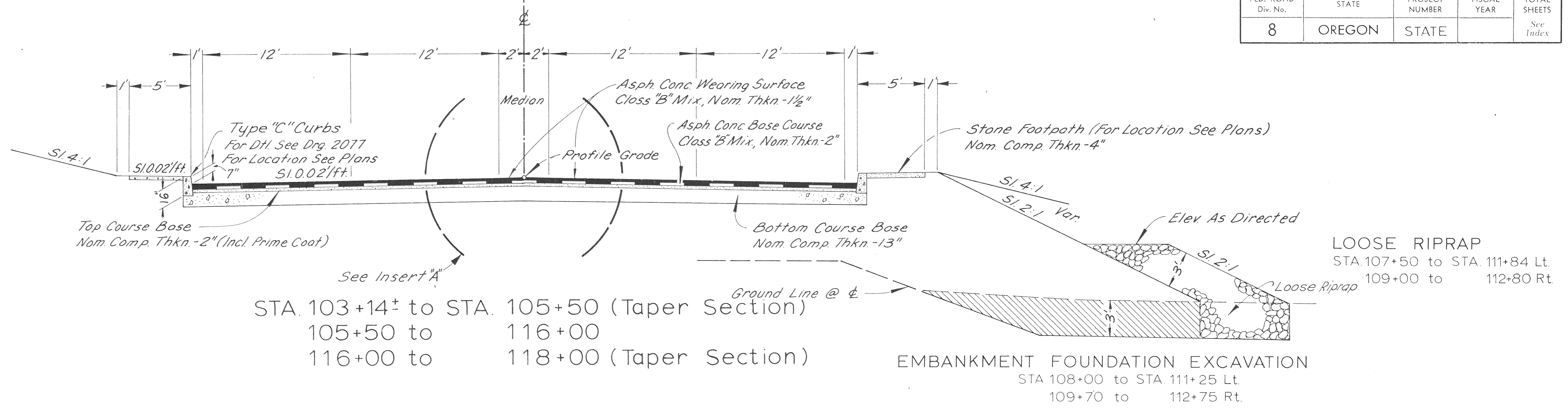

9F14-12  
Sh 2

|                       |        |                   |                |       |                           |
|-----------------------|--------|-------------------|----------------|-------|---------------------------|
| INDIAN CREEK SECTION  |        |                   |                |       | SHEET<br>No.<br><b>2A</b> |
| HOOD RIVER HIGHWAY    |        |                   |                |       |                           |
| HOOD RIVER COUNTY     |        |                   |                |       | TOTAL<br>SHEETS           |
| FED. ROAD<br>Div. No. | STATE  | PROJECT<br>NUMBER | FISCAL<br>YEAR | STATE |                           |
| 8                     | OREGON |                   |                | STATE | See<br>Index              |

TYPICAL SECTIONS CONT.

STAGE CONSTRUCTION

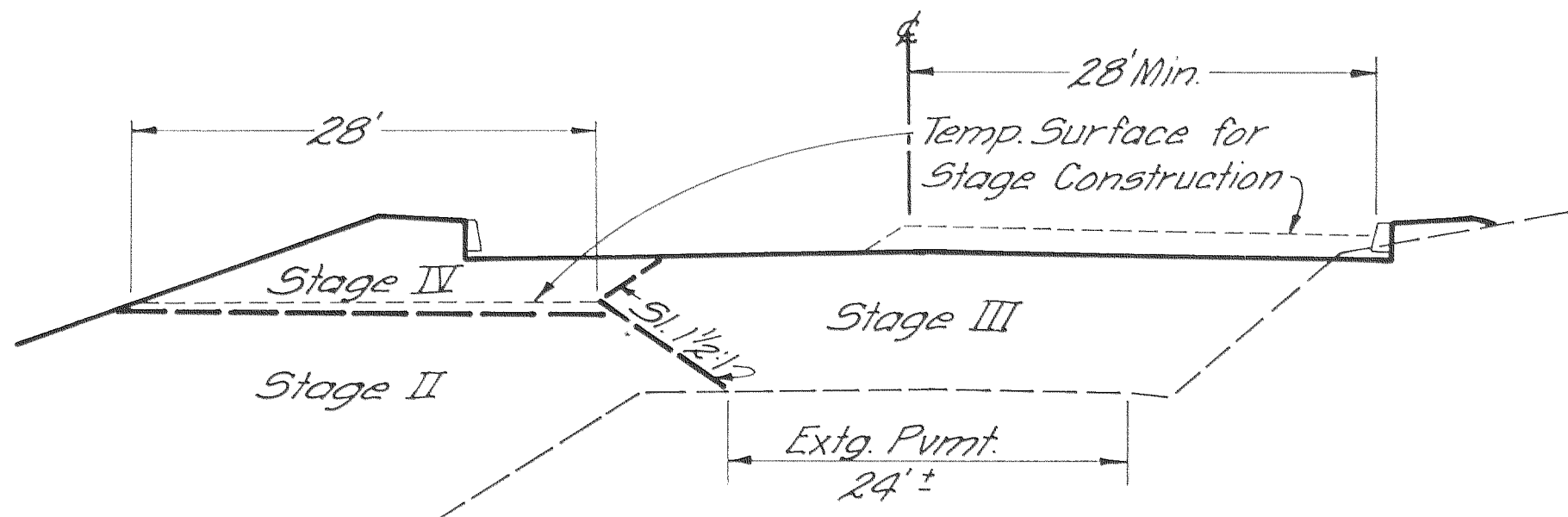

STA. 104+50 to STA. 111+84  
For Surfacing Details Not Shown, See Section Below.

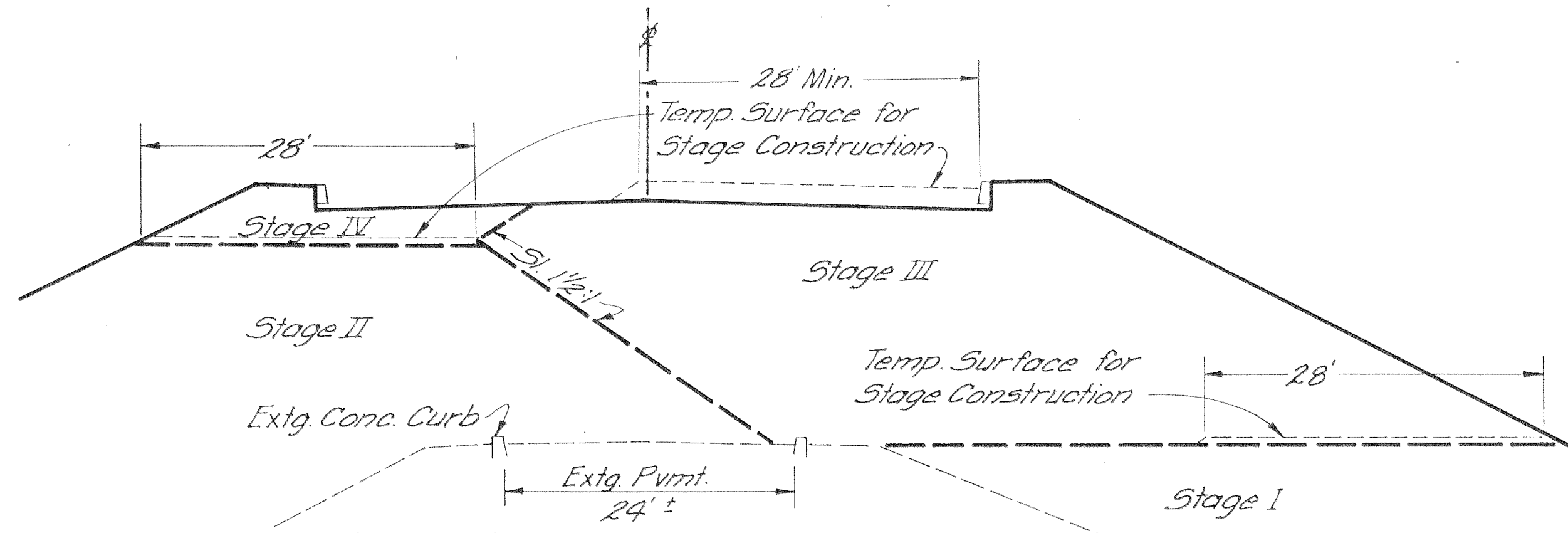

STA. 111+84 to STA. 113+00  
For Surfacing Details Not Shown, See Section Below

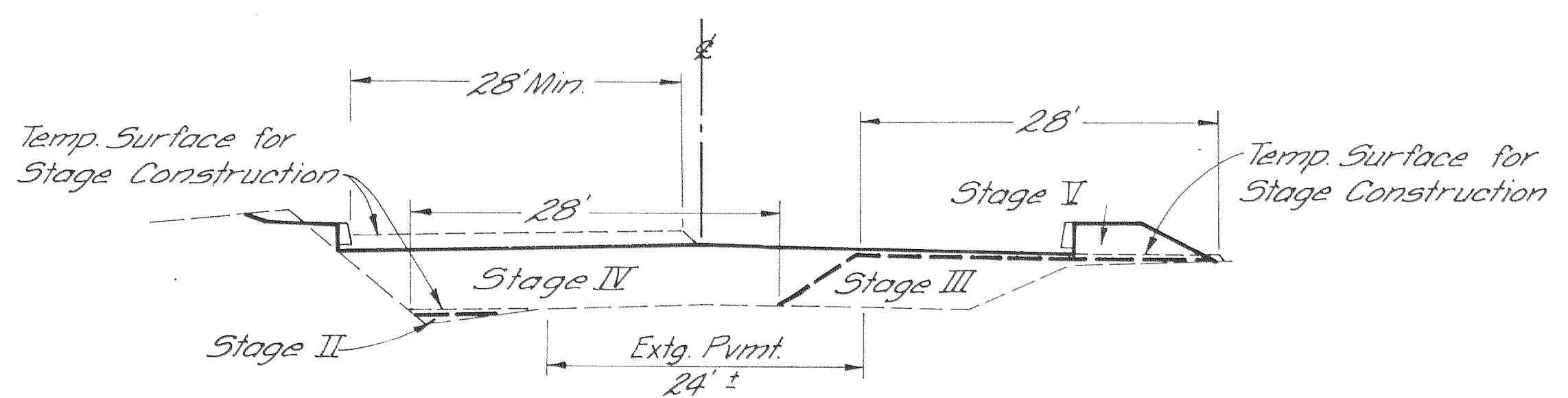

STA. 113+00 to STA. 115+00  
For Surfacing Details Not Shown, See Section Below

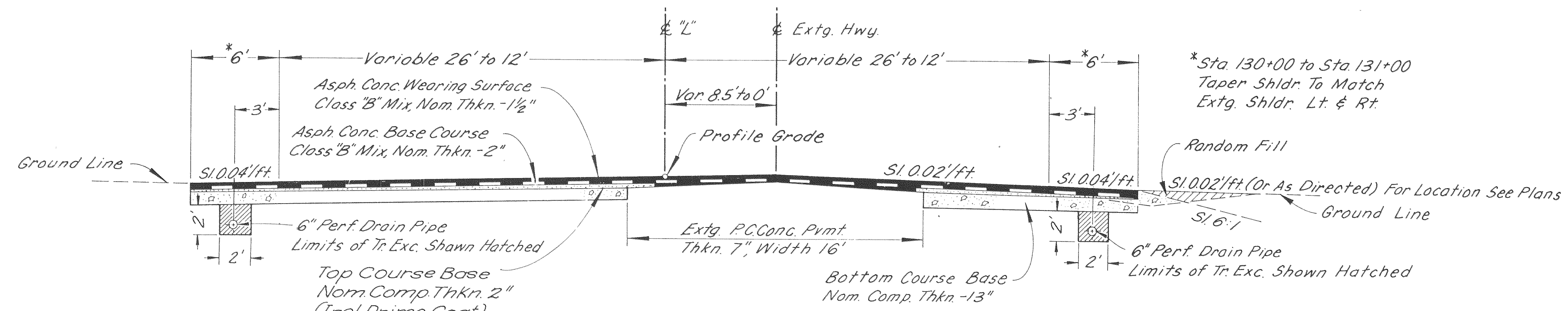

STA. 127+00 to STA. 131+00 (Taper Section)  
For Method of Feathering See Drg. 2050

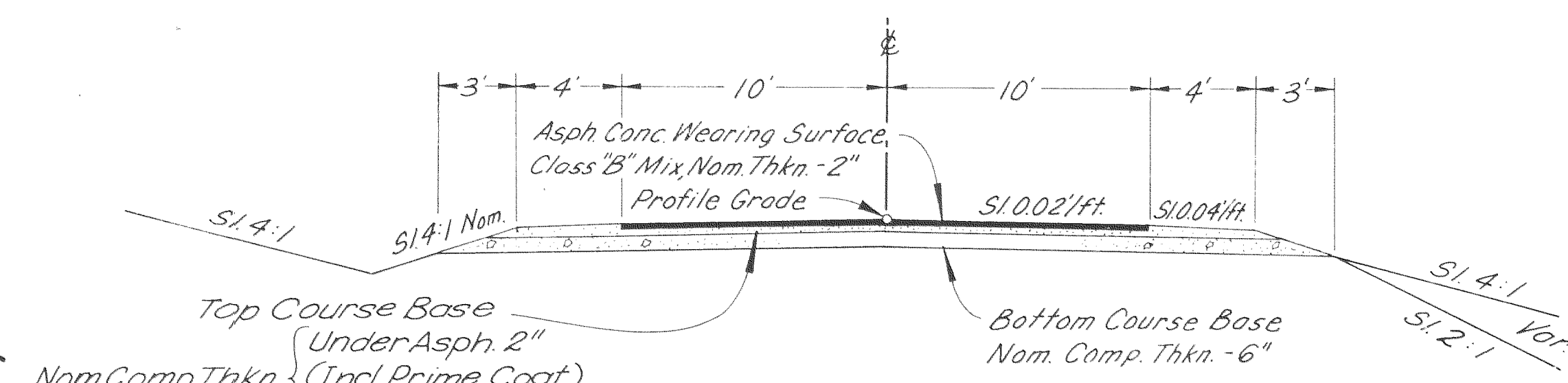

INDIAN CREEK ROAD  
STA. 10+45 to STA. 12+35

9F14-12  
Sh 3

AS CONSTRUCTED

August, 1968  
Res. Eng'r.  
D. S. Sawyer

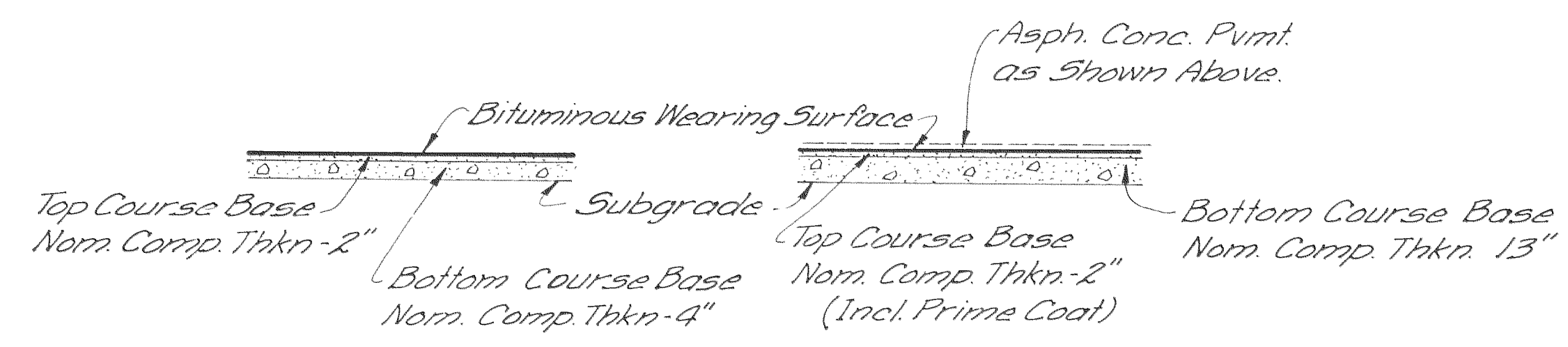

TEMPORARY LOCATION FINAL LOCATION  
STAGE CONSTRUCTION SURFACING

| INDIAN CREEK SECTION |        |                |             | SHEET No.    |
|----------------------|--------|----------------|-------------|--------------|
| HOOD RIVER HIGHWAY   |        |                |             | 2B           |
| HOOD RIVER COUNTY    |        |                |             | TOTAL SHEETS |
| FED. ROAD Div. No.   | STATE  | PROJECT NUMBER | FISCAL YEAR | See Index    |
| 8                    | OREGON | STATE          |             |              |

# S U M M A R Y

| ITEM  | UNIT     | NET QUANT. | ALLOW. | TOTAL  |
|---|----------|------------|--------|--------|
| Clearing & Grubbing                           | All      | All        |        | All    |
| Embankment Foundation Excavation Unclassified | Cu. Yd.  | 3,628      | 372    | 4,000  |
| Embankment in Place                           | " "      | 55,727     | 5,273  | 61,000 |
| Special Rock Backfill                         | " "      | 367        | 33     | 400    |
| Finishing Roadbed & Slopes                    | Mile     | 0.53       |        | 0.53   |
| Rounding Cutbanks                             | Lin. Ft. | 100        | 10     | 110    |
| Trench Excavation                             | Cu. Yd.  | 1,271      | 129    | 1,400  |
| Special Backfill in Drains                    | " "      | 120        | 10     | 130    |
| Watering                                      | M. Gal.  | 370        | 30     | 400    |
| 3/4" O Material in Base                       | Ton      | 3,494      | 306    | 3,800  |
| Stone Base                                    | " "      | 12,557     | 1,243  | 13,800 |
| 3/4" O Aggregate in Prime Coat                | Cu. Yd.  | 125        | 15     | 140    |
| RC-250 Asphalt in Prime Coat                  | Ton      | 20         | 2      | 22     |
| Asphalt in Tack Coat                          | " "      | 1          |        | 1      |
| Class "B" Asphalt Concrete                    | " "      | 3,700      | 300    | 4,000  |
| Stage Construction Surfacing                  | Sq. Yd.  | 7,200      | 700    | 7,900  |
| Class "A" Concrete in Retaining Wall          | Cu. Yd.  | 30         | 2      | 32     |
| " " " " Box Culvert                           | " "      | 196        | 20     | 216    |
| Reinforcement in Retaining Wall               | lbs      | 1,500      | 150    | 1,650  |
| " " " " Box Culvert                           | " "      | 39,323     | 3,677  | 43,000 |
| Loose Riprap                                  | Cu. Yd.  | 1,980      | 200    | 2,180  |
| 12-inch Culvert Pipe                          | Lin. Ft. | 30         | 2      | 32     |
| 18-inch " "                                   | " "      | 120        | 12     | 132    |
| 21-inch " "                                   | " "      | 80         | 8      | 88     |
| 36-inch " "                                   | " "      | 194        | 16     | 210    |
| 12-inch Sewer Pipe                            | " "      | 2,544      | 256    | 2,800  |
| 15-inch " "                                   | " "      | 450        | 50     | 500    |
| 6-inch Drain Pipe                             | " "      | 724        | 76     | 800    |
| Concrete Manholes                             | One      | 3          | 1      | 4      |
| Concrete Inlets, Type "CG-1"                  | " "      | 1          |        | 1      |
| " " " " "G-1"                                 | " "      | 10         |        | 10     |
| " " " " "G-1" (With Special Grate)            | " "      | 11         | 1      | 12     |
| Concrete Curbs                                | Cu. Yd.  | 160        | 16     | 176    |
| " " Driveways                                 | Sq. Yd.  | 502        | 18     | 520    |
| " " Walks                                     | " "      | 135        | 5      | 140    |
| Extra For A.C. Concrete Approaches            | One      | 11         | 1      | 12     |
| " " " " " Walks                               | Sq. Yd.  | 540        | 60     | 600    |

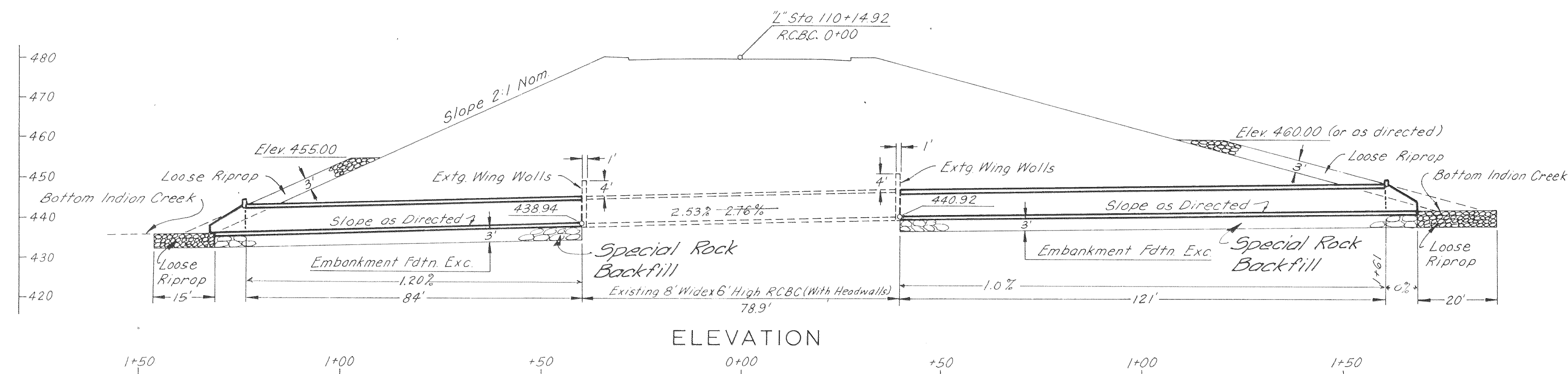
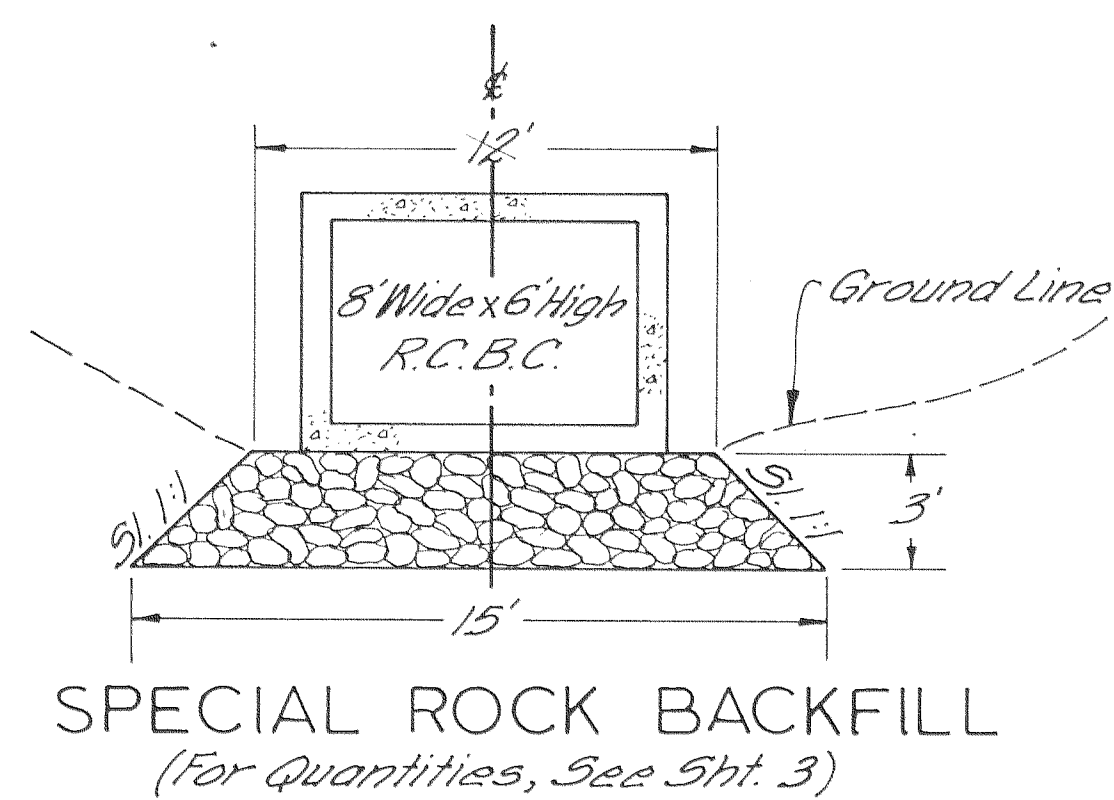
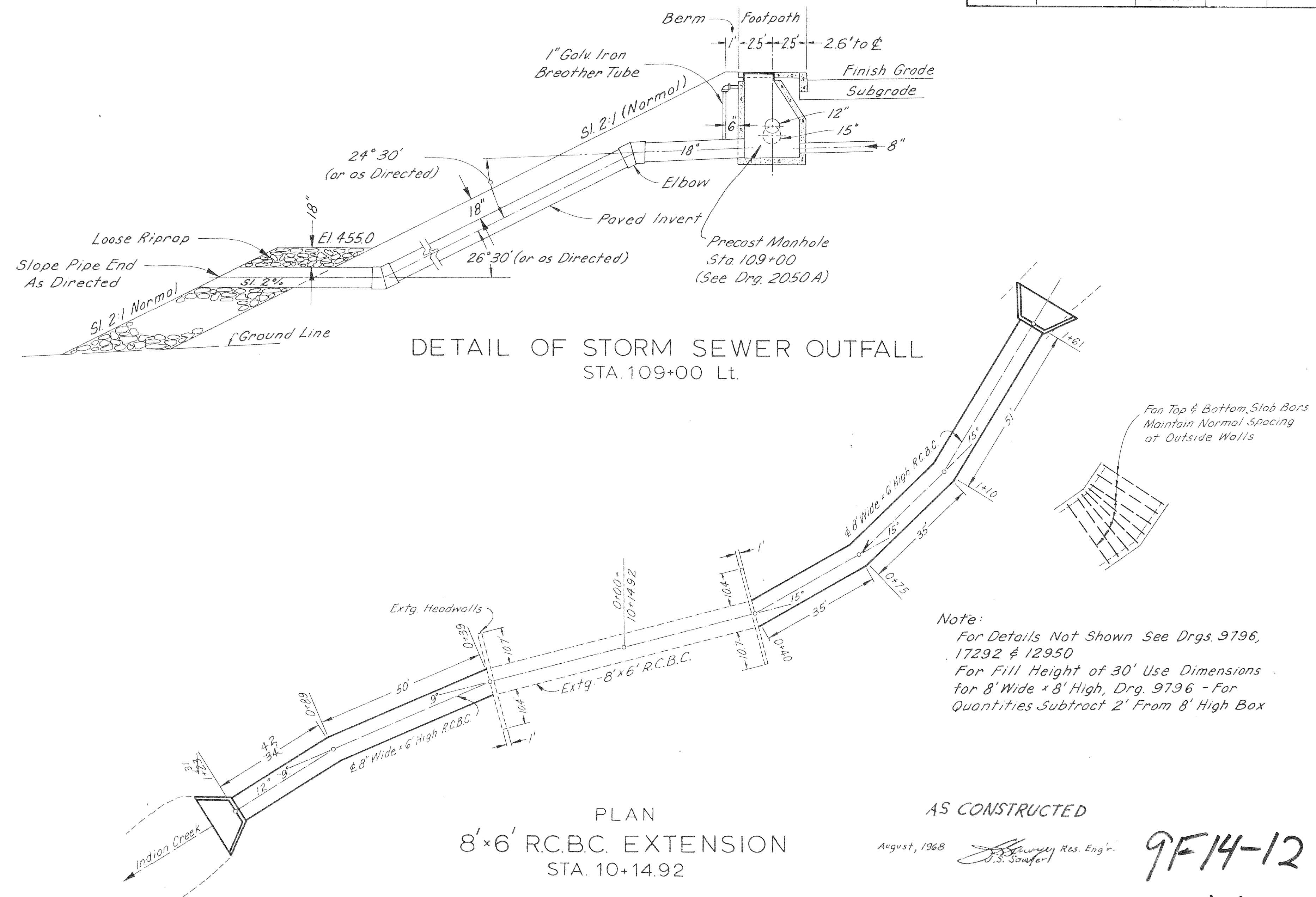

| INDIAN CREEK SECTION<br>HOOD RIVER HIGHWAY<br>HOOD RIVER COUNTY |        |                   |                | SHEET<br>No.    |
|---|--------|-------------------|----------------|-----------------|
| FED. ROAD<br>Div. No.   | STATE  | PROJECT<br>NUMBER | FISCAL<br>YEAR | TOTAL<br>SHEETS |
| 8   | OREGON | STATE             |                | 2C              |
|   |        |                   |                | See<br>Index    |

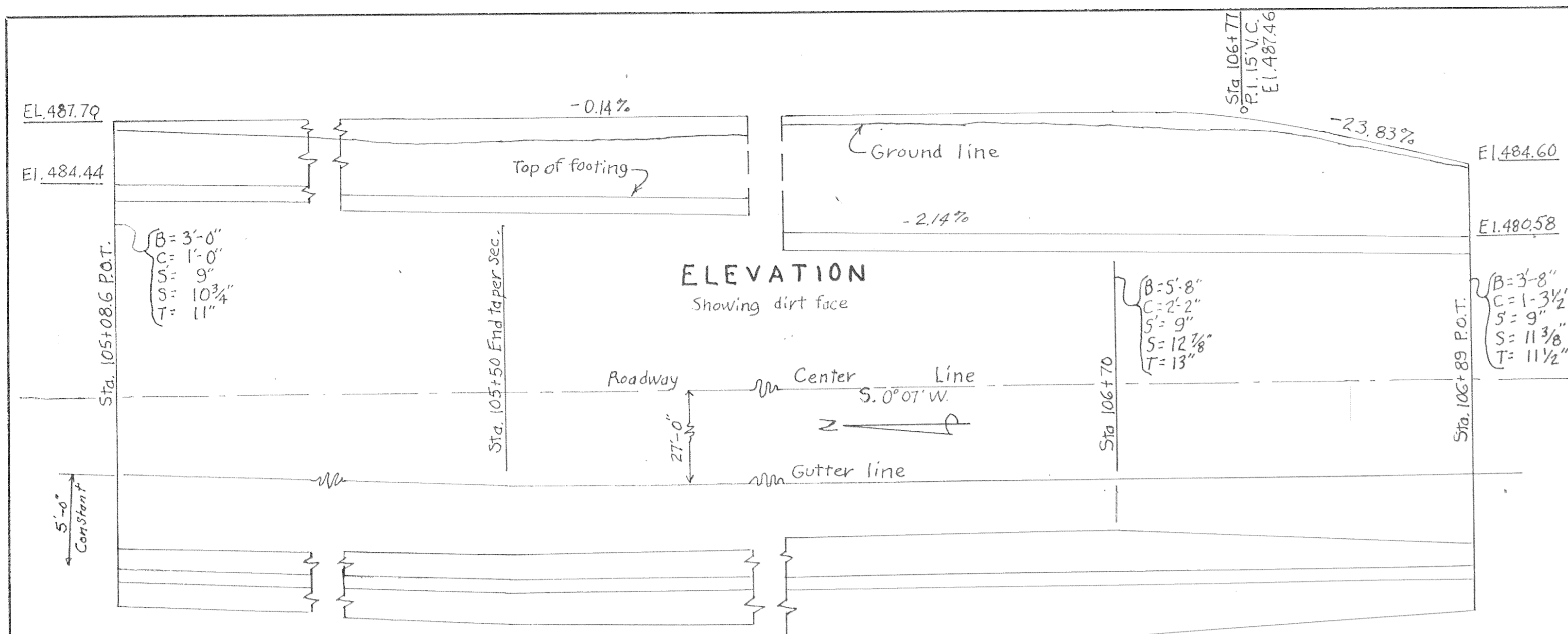

**ELEVATION**  
Showing dirt face

**PLAN VIEW**  
Scale 1"=5'-0"

Note: Top of footing to be placed at subgrade. For details not shown on this sheet, refer to Type (H) wall on Dwg. 21052. For reinforcing use H-8 for entire wall. Contraction and expansion joints to be placed for convenience but also in accordance Dwg. 21052.

Accompanied by Dwg. 21052

OREGON STATE HIGHWAY DEPARTMENT  
BRIDGE DIVISION

**Retaining Wall Sta. 105+08.6 to 106+89**  
**Indian Creek Section**  
Hood River Highway Hood River County

APPROVED: Ivon Merchant, BRIDGE ENGINEER  
DATE 9-14-67  
DESIGNED (C.C.M.)  
DRAWN (L.M.) DRAWING NO. **B-277**

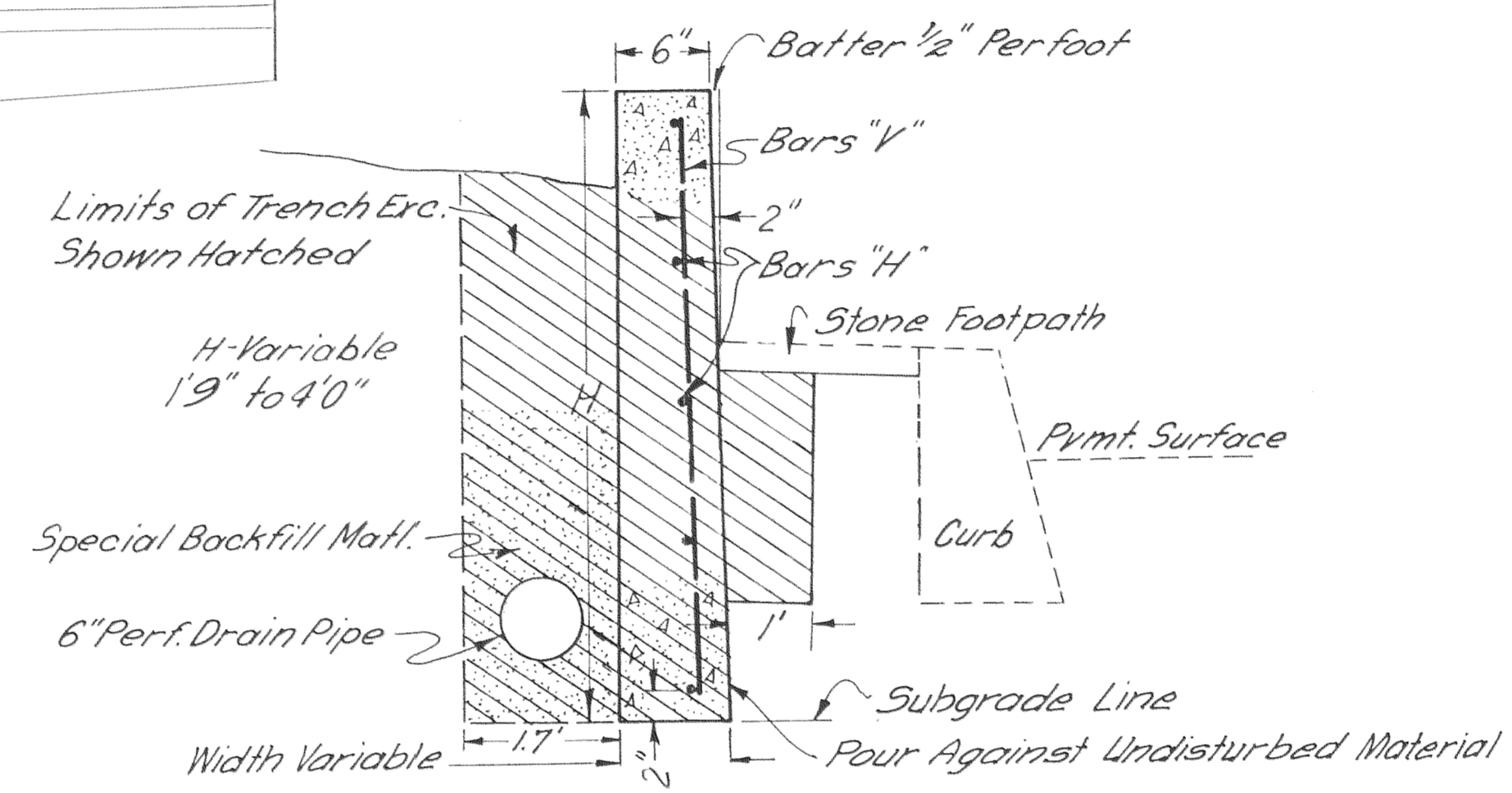

**REINFORCING STEEL IN WALL**

| H   | Bars "V"     | Bars "H"      |
|-----|--------------|---------------|
| 4'  | #4 Bars @ 9" | #4 Bars @ 18" |
| 3'  | #4 Bars @ 9" | #4 Bars @ 18" |
| 2'  | None         | None          |
| 16" | None         | None          |

**SECTION A-A**  
(GRAVITY TYPE WALL)

AS CONSTRUCTED

August, 1968  
Res. Engr. J.S. Sawyer

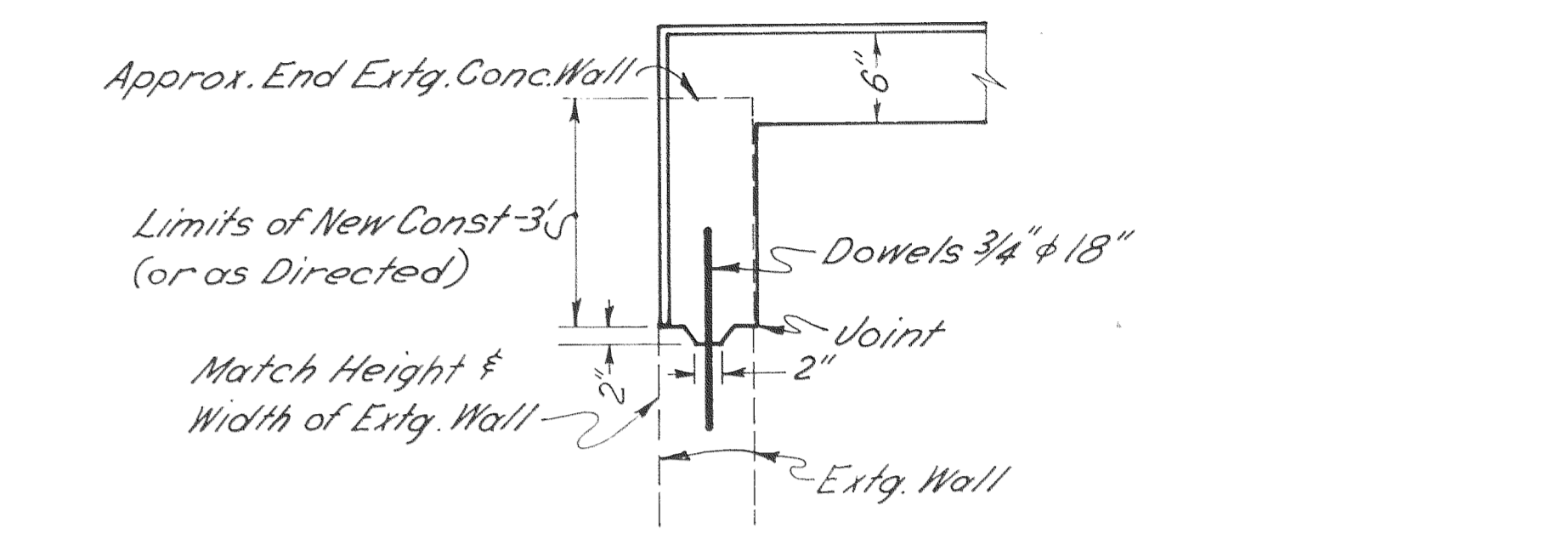

**PLAN**  
(GRAVITY TYPE WALL)

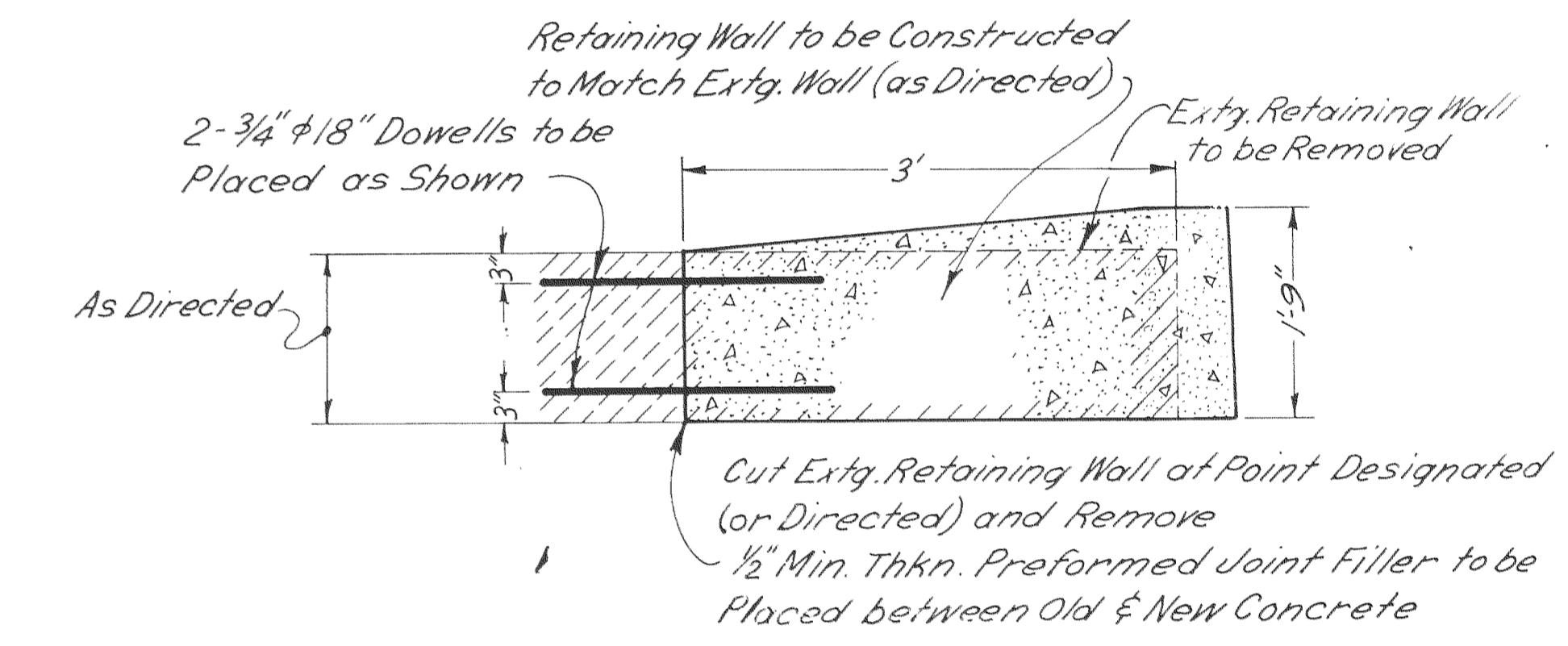

**ELEVATION**  
(GRAVITY TYPE WALL)

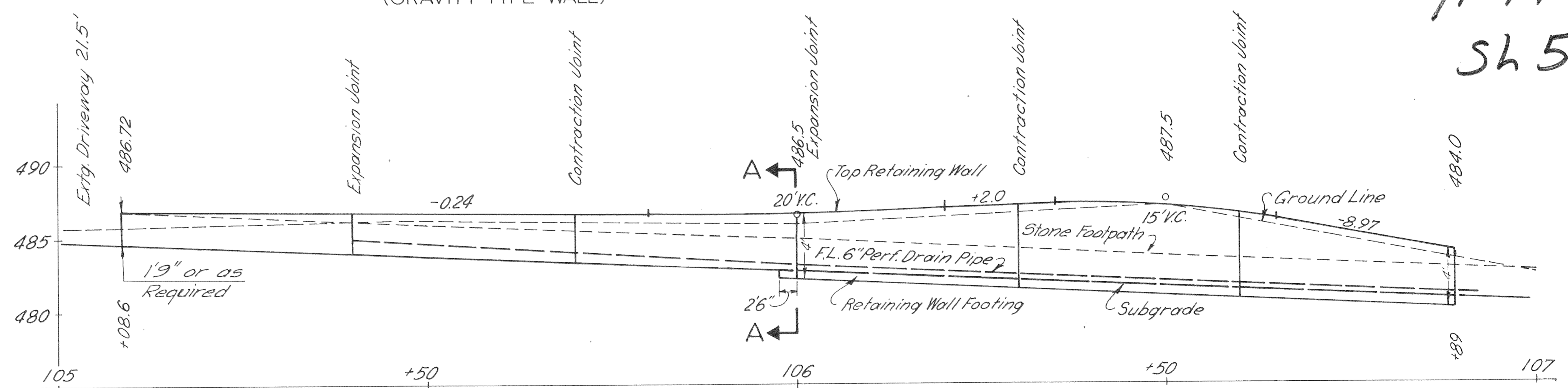

**GRAVITY TYPE RETAINING WALL**  
STA. 105+08.5 to STA. 106+00  
(For Details of Exp. & Cont. Joints, See Drg. No. 21052)

**TYPE "H" RETAINING WALL**  
STA. 106+00 to STA. 106+89  
For Details, See Drg. No. 21052

9F14-12  
SL5





Const. 19 PC Conc. Dwy. Type "A" Shown Thus:

Note:  
 Fire Hydrants To Be Moved (By Others)  
 Valve Boxes To Be Adjusted (By Others)  
 Siphon Boxes, Junction Boxes, Valves & Pump Houses To Be Inst. or Const. (By Others)  
 Extg. Irrig. System To Be Salvaged or Abandon (By Others)

Sta. 121+59<sup>±</sup> Const. Type G-1 inlet  
 Sta. 121+88 to Sta. 126+95 Inst. 12" Irrig. Pipe 506' (By Others)

| INDIAN CREEK SECTION  |        |                |             |                        |
|---|--------|----------------|-------------|------------------------|
| HOOD RIVER HIGHWAY  |        |                |             |                        |
| HOOD RIVER COUNTY   |        |                |             |                        |
| FED. ROAD Div. No.  | STATE  | PROJECT NUMBER | FISCAL YEAR | SHEET No.              |
| 8   | OREGON | STATE          |             | 4                      |
| Sta. 126+95 to Sta. 128+76 Inst. 15" Irrig. Pipe - 180' (By Others) |        |                |             | TOTAL SHEETS See Index |

|               |      |
|---------------|------|
| FINAL SURVEY  | DATE |
| SURVEYED      |      |
| PLOTTED       |      |
| INSTRUMENTS   |      |
| NOTE BOOK     |      |
| AREAS CHECKED |      |
| NO.           |      |

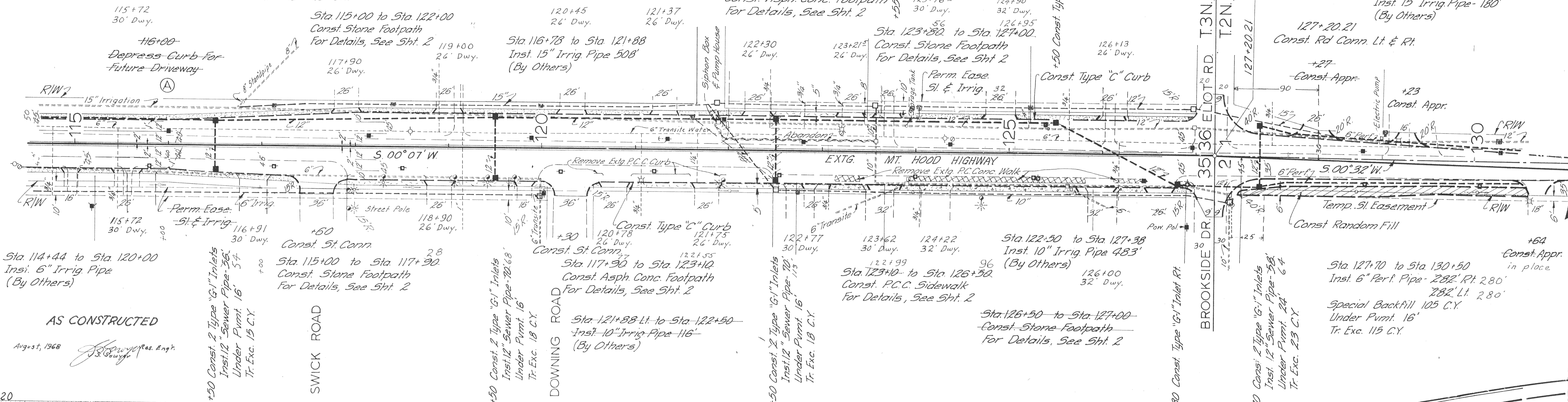

AS CONSTRUCTED

August, 1968  
*J.S. Sawyer* Res. Engr.  
 S. Sawyer

|                 |      |
|-----------------|------|
| ORIGINAL SURVEY | DATE |
| SURVEYED        |      |
| PLOTTED         |      |
| INSTRUMENTS     |      |
| NOTE BOOK       |      |
| AREAS CHECKED   |      |
| NO.             |      |

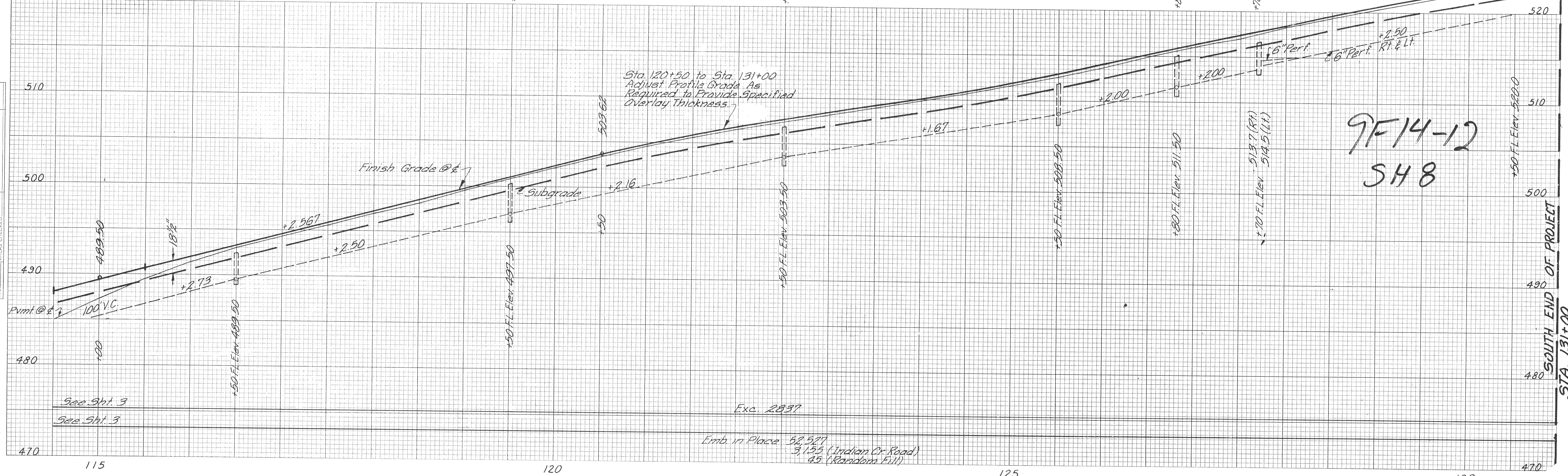

9F14-12  
 SH8

Sta. 120+50 to Sta. 131+00  
 Adjust Profile Grade As Required to Provide Specified Overlay Thickness

Exc. 2837  
 Emb. in Place 52,527  
 3,155 (Indian Cr. Road)  
 45 (Random Fill)

SOUTH END OF PROJECT STA. 131+00