

OREGON STATE HIGHWAY DEPARTMENT  
**WARREN CREEK VICINITY**  
**WYETH-VIENTO SECTION**  
**COLUMBIA RIVER HIGHWAY**  
**LE PROJECTION**  
 SCALE 1"=50' HORIZ. ORE. NORTH ZONE GRID  
 2"=50' VERT. FEB., 1959  
 K.D. LIMBOCKER, LOC. ENG.

9F 11-1  
 Sh 1

378.82' Sp.  
 S=2°51' 22"  
 a=0.3981

680+0.75 P.T.

676+26.93 P.C.S.

Bottom Flume Gone, Last 8 ft  
 R.R. Portion of Flume & Lining in Poor Condition.

END OF 1940 CONSTR. FLUME  
 PACIFIC RAILROAD

Edge B-II Mod. Oil Mat

BRIDGE NO. 2638  
 DRG. NO. 6768  
 100'-24" C.M. Pipe

Entire Flume Destroyed Dec. '64 by Flood.

WARREN CREEK DIVISION  
 CONSTRUCTED IN 1940  
 SEE DRG. 6768-1959  
 Treated Timber Flume

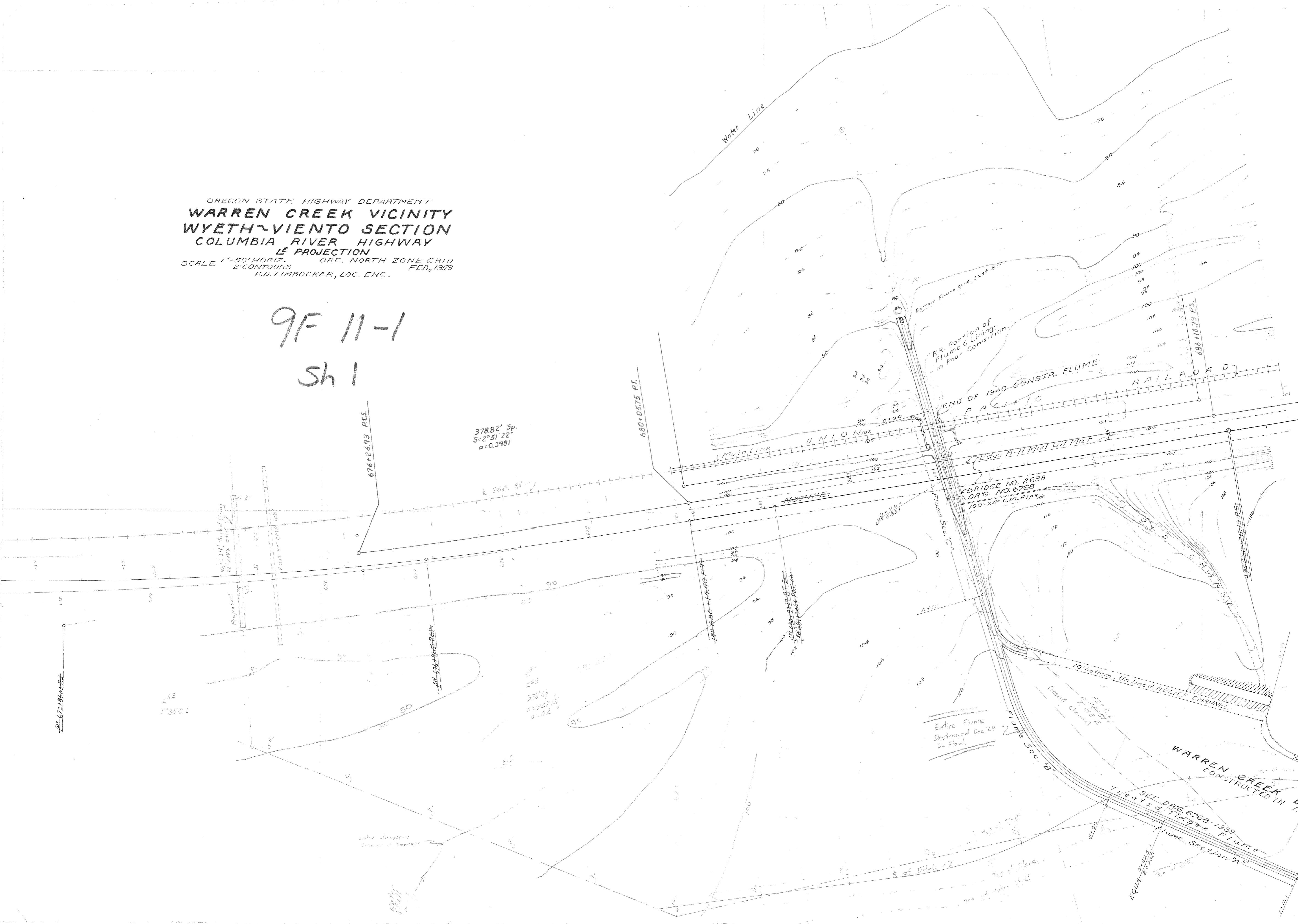

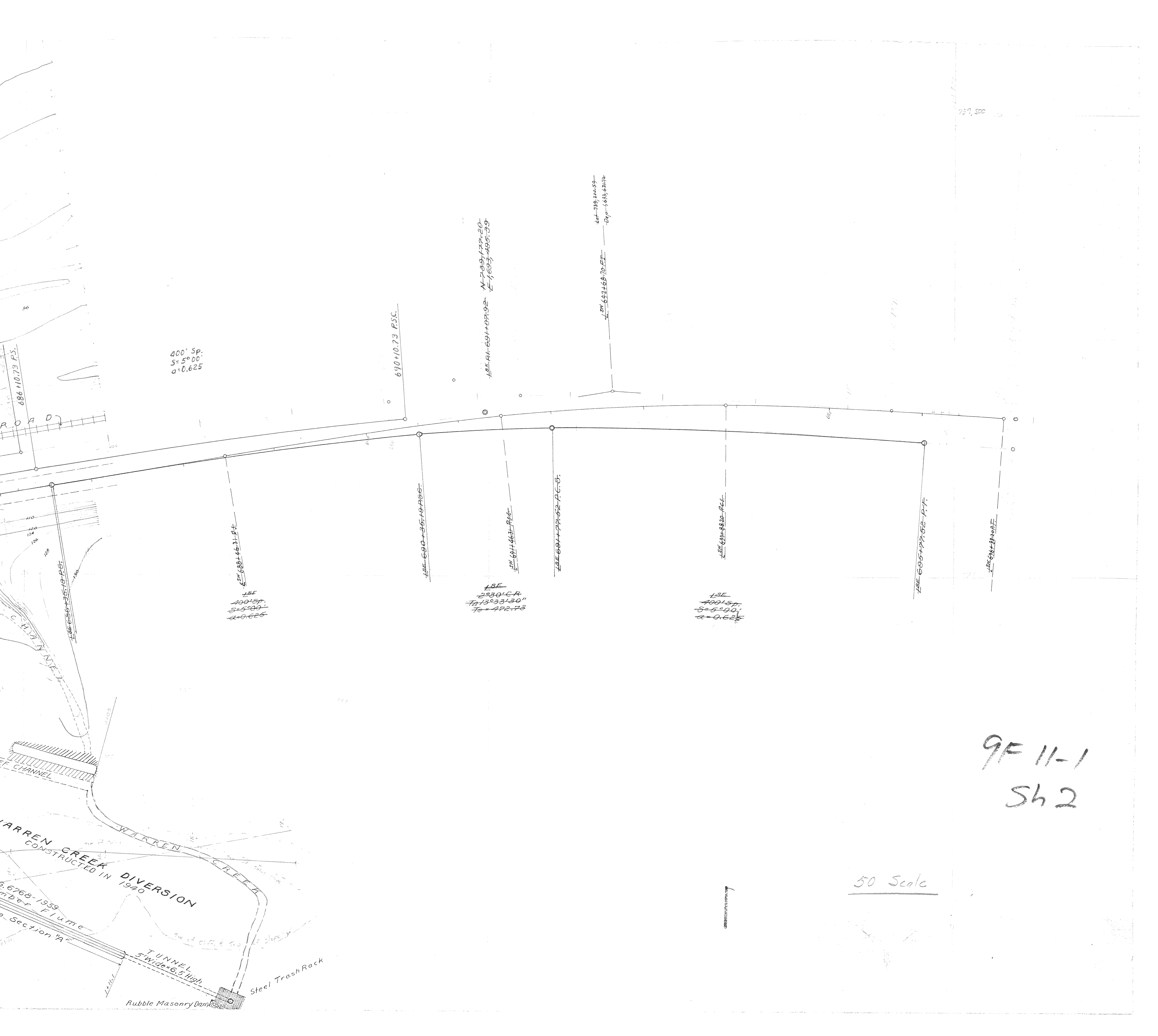

400' SP.  
S=5°00'  
G=0.625

690+10.73 P.S.C.

LS E 61-69+10.73-9.2  
N=73°39'17.20"  
E=160°3'40.50"

LS W 69+68-70 P.T.  
Lat=73°20'59"  
Dep=-165°53'17"

LS E 688+46.31 P.C.  
LS E 400' SP.  
S=5°00'  
G=0.625

LS E 230' C.R.  
TA=13°33'30"  
T=472.73

LS E 400' SP.  
S=5°00'  
G=0.625

LS E 690+35-19 P.S.C.

LS W 69+146.31 P.C.

LS E 69+77-52 P.C.S.

LS W 69+82.20 P.C.S.

LS E 695+77-52 P.T.

9F 11-1  
Sh 2

50 Scale

WARREN CREEK DIVERSION  
CONSTRUCTED IN 1940  
6.6768-1939  
Flume  
Section A-A  
TUNNEL  
5' Wide x 6.5' High  
Steel Trash Rack  
Rubble Masonry Dam

737,500