

See 6B-35-6 for R/W  
See 5B-34-21 for R.R. encroachment

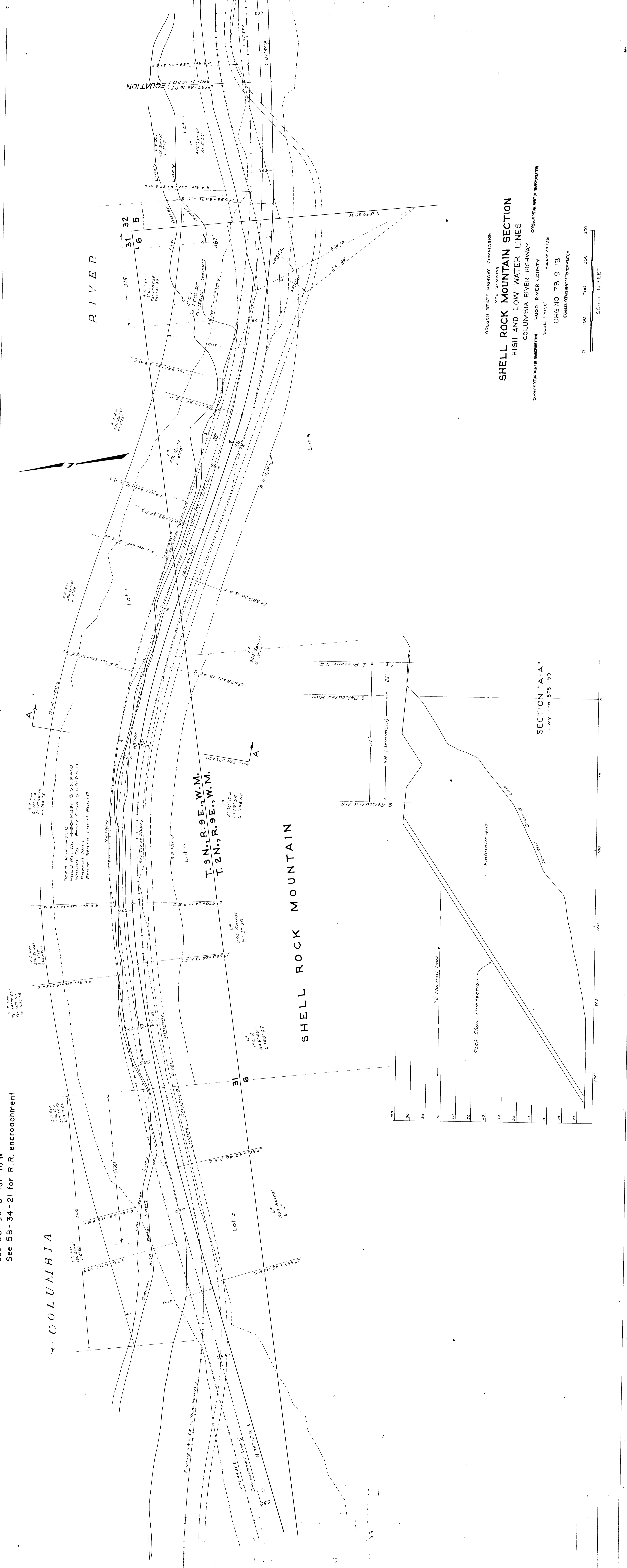

**SHELL ROCK MOUNTAIN SECTION**  
**HIGH AND LOW WATER LINES**  
OREGON DEPARTMENT OF TRANSPORTATION  
HOOD RIVER COUNTY  
COLUMBIA RIVER HIGHWAY  
Scale 1"=100' August 28, 1951  
DRG NO 7B-9-13  
OREGON DEPARTMENT OF TRANSPORTATION

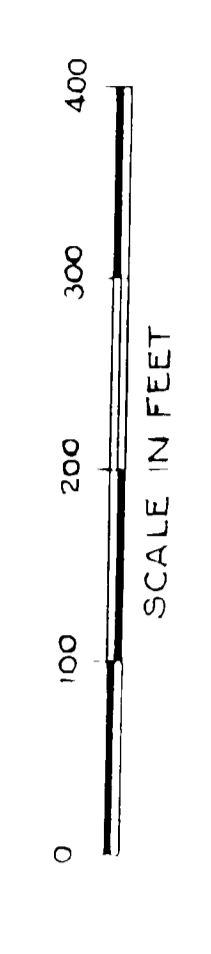

SECTION "A-A"  
Rwy Sta 575 +50

COLUMBIA

SHELL ROCK MOUNTAIN

T. 3 N., R. 9 E., W. M.  
T. 2 N., R. 9 E., W. M.

RIVER