

Section: 31 Township:1N Range: 11E

Date: 6/6/24

Corner Designation Z2A (angle point)

- Condition Report Only
- Not Found
- Renewed
- Unrecorded
- Surveyed In
- Referenced Out

**Previous Renewals/Surveys, etc:**

(1859) The U.S. General Land Office contracted with David P. Thompson, Deputy Surveyor, under contract No. 79, to survey the Baseline from the southeast corner of section 32 in T1N R8E to the southeast corner of T1N R32E, conducted May 21, 1859 through June 8, 1859. At 40 chains Thompson "set post for 1/4 sec corner" between section 31 of T1N R11E and section 1 of T1S R10E. References set:

- 5" Fir, N8E, 30 links
- 5" Fir, N55W, 12 links

(1882) The U.S. General Land Office contracted with Henry Meldrum, Deputy Surveyor, under contract No. 436, on April 26, 1882 to subdivide T1N R10E, conducted in November of 1882. Meldrum found Thompson's work through R11E to be out of specifications and therefore resurveyed the Baseline. From the old corner to secs 31 and 32, Meldrum found the "old 1/4 section corner" at 48.60 chains.

(1984) Danny Cron, under contract with the U.S. Forest Service, CS1985036, performed field work in the fall of 1984. Per Bureau of Land Management, old Thompson corners act as angle points and Cron set 2"x30" aluminum pipe with 3" aluminum cap stamped "T1NR11E AP S31/S1 T1SR10E 1084 PLS1028" References set:

- 9" D. fir, N2E, 23.1', scribed "AP S31 BT"
- 10" White Fir, S19E, 27.4', scribed "AP S1 BT"

(1994) R.A. Morris surveyed the south lines of section 36 T1N R10E and section 31 T1N R11E, CS1994132, for the U.S. Forest Service, conducted October 1993 and October 1994. Morris found the angle point, "3" alum cap per Survey No. 85036."

**Monument(s) & Accessories Found: (Condition and Source)**

(2024) S. Deshong of US Forest Service, Columbia Land Zone recovered corner monument as set in 1984. References found:

- 16" doug fir, N2E, 23.1', with healed blaze
- 26" doug fir S19E, 27.4', with healed blaze

**Monument Detail**

Found 3.25" alum cap, flush in ground with rock collar

**Monument Set (Procedures and Description)**

None

**New Accessories:**

None

**Location & Comments:**

-Corner lies on level ground approx 1/4 miles east of forest road 1710-630

-Painted 6" red bands around Bearing Trees, added tags

-set aluminum guard posts 5' east and west of monument with Land Survey Monument signs attached.

Compass Declination \_\_\_\_\_

Firm/Agency USDA Forest Service

Gifford Pinchot National Forest, Columbia Lands Zone

Address 987 McClellan Road

Vancouver, WA 98661

Party Chief S. Deshong

Notes \_\_\_\_\_

Witness R. Ellis, C. Clark

**Sketch**

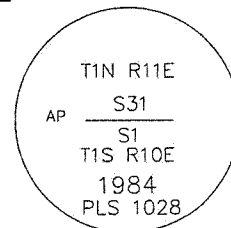

**Surveyor's Seal**

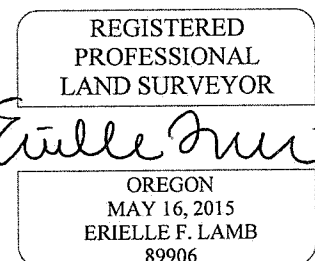

EXPIRES: 12/31/2024