

SECTION OR SUBDIVISION C-E 1/16 SEC 2 CORNER No. 1189

TWP. 2N, RANGE 10 E, W.M.

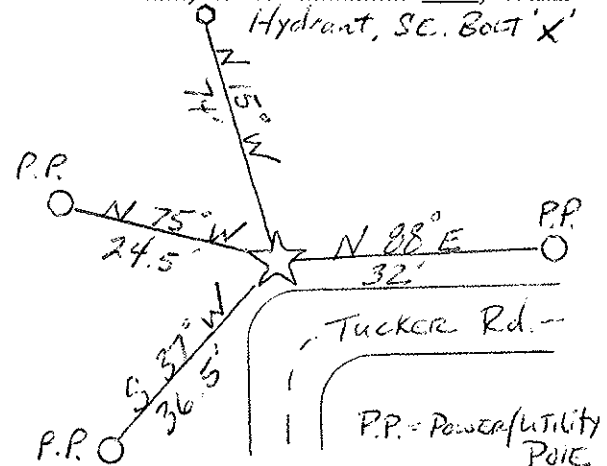

CORNER DESCRIPTION

ORIGINAL WAGON SKEIN  
WAS RESET IN OUR  
ORIGINAL TIED POSITION.  
SKEIN WAS DISTURBED  
DURING CONSTRUCTION  
OF PIPELINE.

FIBERGLASS POST SET  
1' ± NORTH OF SKEIN  
MAY 26<sup>th</sup> 2009  
EMC

W.O. REF. \_\_\_\_\_

SEE: CS2009 021 & 028  
& ULH 1A, 122 & 123

CARD 1 OF 1