

SECTION OR SUBDIVISION

1/4 104  $\frac{28}{33}$

CORNER No.

1038

TWP. 1S....., RANGE 10 E, W.M.

CORNER DESCRIPTION

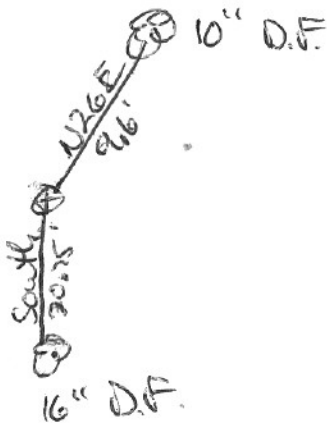

2 1/2" IP w/brass cap  
set by Bishop 1979

see CS# 79104

W.O. REF.

CARD

OF