

SECTION OR SUBDIVISION $\frac{1}{4}$ cor 29/28

CORNER No. 1035

TWP. 1S, RANGE 10E, W.M.

CORNER DESCRIPTION

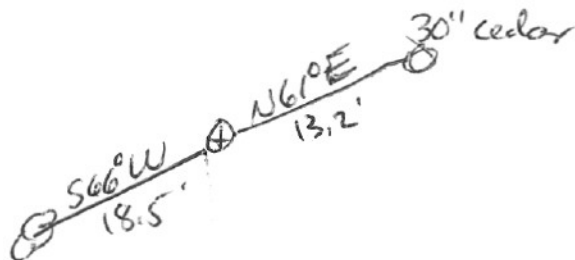

18" cedar

W.O. REF. _____

2 1/2" IP w/buss
cap. set by
Bishop 1979

see 15#79104

CARD _____ OF _____