

SECTION OR SUBDIVISION 1/4 cor 16/15

CORNER No. 969

TWP. 2N, RANGE 2E, W.M.

CORNER DESCRIPTION

this cor cut by  
proportion in 1980  
by T.E.C.

CORNER RECORD (PERPETUATION)

L-13

MONUMENT DESCRIBE NEW MONUMENT SET, OR WORK DONE TO PRESERVE EXISTING MONUMENT

Set aluminum cap on a 2-1/2 inch aluminum pipe, 30 inches long, 24 inches in the ground and built a mound of stone.

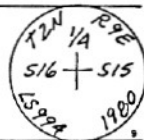

ACCESSORIES DESCRIBE NEW BT'S WITNESS OBJECTS ETC. ESTABLISHED, OR WORK DONE TO PRESERVE EXISTING EVIDENCE

A fir 12" in diameter bears S. 43° E. 4.9 ft. dist., marked 1/4 S 15 (BT)  
A fir 10" in diameter bears S. 51° W. 18.8 ft. dist. marked 1/4 S. 16 (BT)

W

10

Work Done By Lawrence E. Jones Title Surveyor Date 10/80 State Registration No. or Agency L.S. 994

Certified Cor Record Prepared? Yes No Filed At Date

11

REMARKS

CORNER RECORD (SEARCH)

(Ref. FSM 7151.4)

T 2 N. R. 9 E.

R.D. Hood River County Hood River

Merid. Willamette

N.F. Mt. Hood State Oregon

CORNER DIAGRAM

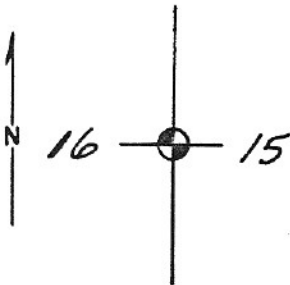

DESCRIBE CORNER MONUMENT FOUND

None: Corner location established by proportionment.

DESCRIBE BEARING TREES OR OTHER OFFICIAL ACCESSORIES FOUND

None.

PHOTO IDENTIFICATION DATA

Photo No. \_\_\_\_\_

Filed At. \_\_\_\_\_

Object Ident. \_\_\_\_\_

Ident. By \_\_\_\_\_

Signature

PLANE COORDINATE POSITION DATA

State Oregon Zone North

X 727,594.59

Y 1,696,182.42

Estab. By \_\_\_\_\_

TEC

Agency

DESCRIBE CORNER LOCATION RELATIVE TO NEAR-BY FEATURES, ALSO HOW TO REACH CORNER

From junction of Roads N-20 and N-21 go n.e. on N-21 - 1.9 mile to road marked dead end. Go northerly on dead end road 0.9 mile to clear cut. Leave road and go east 400 ft., more or less along south edge clear cut. Corner lies approx. 150 feet south in timber.

Signature

Title

Division

Headquarters

Date

7100-52 (3-68)

Surveyor

Oct., 1980

CORNER RECORD (PERPETUATION)

L-13

MONUMENT: DESCRIBE NEW MONUMENT SET, OR WORK DONE TO PRESERVE EXISTING MONUMENT

Set aluminum cap on a 2-1/2 inch aluminum pipe, 30 inches long, 24 inches in the ground and built a mound of stone.

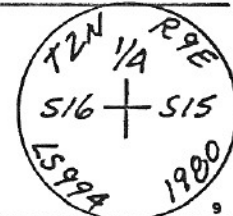

ACCESSORIES: DESCRIBE NEW BT'S WITNESS OBJECTS ETC. ESTABLISHED, OR WORK DONE TO PRESERVE EXISTING EVIDENCE

A fir 12" in diameter bears S. 43° E. 4.9 ft. dist., marked 1/4 S 15 (BT)  
A fir 10" in diameter bears S. 51° W. 18.8 ft. dist. marked 1/4 S. 16 (BT)

Work Done By Lawrence E. Jones Title Surveyor Date 10/80 State Registration No. L.S. 994

Certified Cor. Record Prepared? Yes No Filed At. Date

REMARKS