

SECTION OR SUBDIVISION

CORNER No. 889

TWP. 14, RANGE 9 E, W.M.

CORNER DESCRIPTION

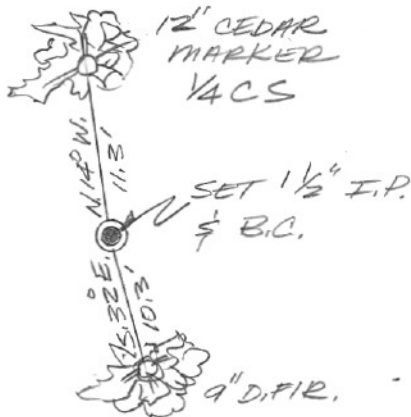

CORNER IS A
1 1/2" IRON PIPE
WITH BRASS CAP
MARKED
T. 14 N. R. 9 E. W. M.
1/4 S 30
S 31
H. R. C. 1980

W.O. REF. _____

SET BY ARNOLD,
DALEY, BLUMENSTEIN

CARD 1 OF 1

OREGON CORNER RESTORATION FORM

Section 30 Township 1 N Range 9 E

County Hood River Date September 14, 2011

CORNER DESIGNATION

South 1/4 Corner Section 30, T1N, R9E
North 1/4 Corner Section 31, T1N, R9E

- Condition Report Only
- Not Found
- Renewed
- Unrecorded
- Surveyed In
- Referenced Out

Previous Renewals/Surveys, etc. Corner was established by Hood River County in survey dated 2-5-81, CS-81006.

Monument(s) & Accessories Found: (Condition and Source)

Found 1-1/2" Pipe with 2-1/2" brass cap, 24" Cedar N14°W at 11.3; 18" Fir S32°E at 13.3; both with healed scar; steel fence post by monument; see corner card 889.

Monument Detail

Sketch

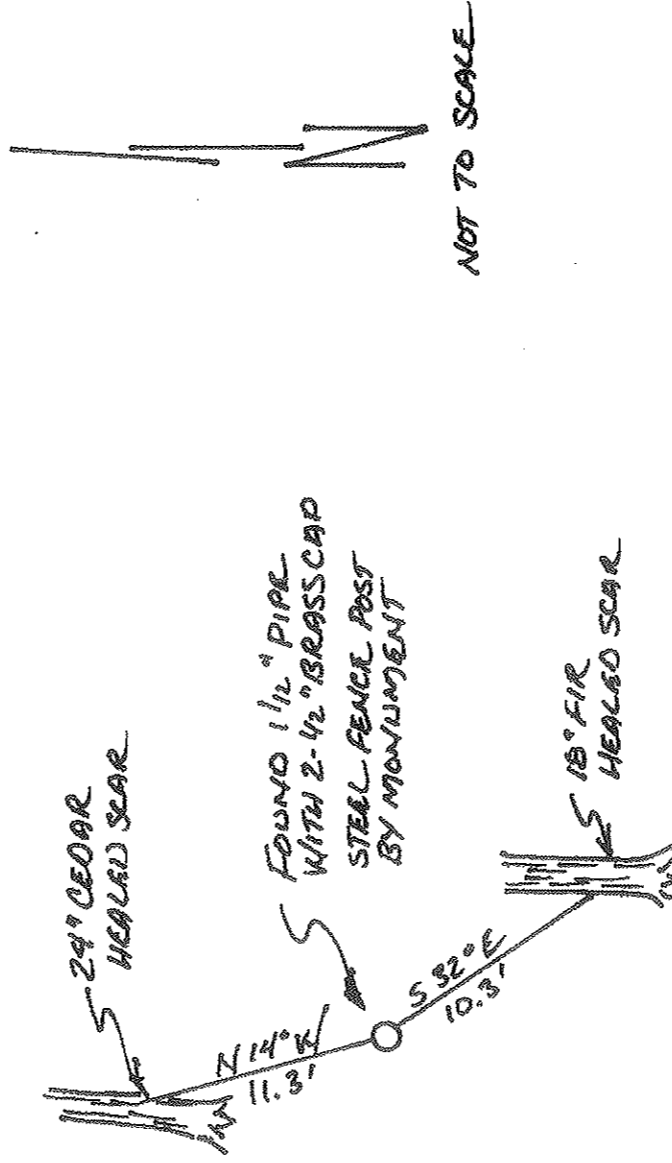

NOT TO SCALE

Monument Set (procedures and Description)

N/A

New Accessories

No new accessories added

Location & Comments

No comments

Compass Declination 16°E

Firm/Agency:

Ford Land Surveying
PO Box 353
Klickitat, WA 98628
Party Chief: George Ford
Notes: Field Book - 2011-4
Witness: Brett Crooks

Surveyor's Seal

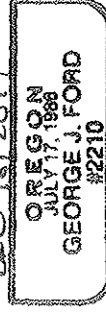

EXPI: 12/31/11