

SECTION OR SUBDIVISION CW 1/16 13

TWP. 1 S, RANGE 9 E, W.M.

CORNER No. 872

CORNER DESCRIPTION

SET 5/8" I.R. W1

YELLOW PLASTIC CAP

"HRC"

U.S.I.F.S. BOUNDARY POST

BEARS 2° N.

A 26" D.F. BEARS 554°W

@ 37 1/2' WITH YELLOW

BEARING, TREE TAG

HRC 1980

CARD 1 OF 1

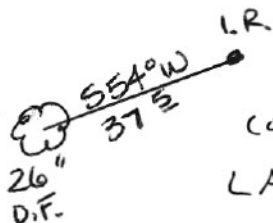

Cor. balls in  
LAVA BEDS

W.O. REF.