

SECTION OR SUBDIVISION

SEC. 17 - SE 1/4



CORNER No.

798

TWP., RANGE., W.M.

CORNER DESCRIPTION

PLAQUE 4' ABOVE GROUND ON OAK TREE
 7" DBH PLAQUE READS "SEC 17
 T-1N, R-10E. 1/4 COR. 10 FT. NE



W.O. REF.

CARD

OF |

PROPERTY CORNER INVESTIGATION

LOCATION

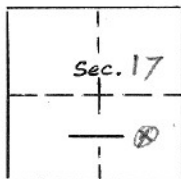
T. 1N R. 10EMer. WM State ORForest HRC Dist. HRC

LEGEND

- Corner searched—no evidence
 Corner or accessory found
 Corner marked by perm. mon.

DESCRIPTION OF FOUND CORNER

MATERIAL: OAK TREE SIZE: 7" DBHHEIGHT ABOVE GROUND: 4 FT. ^{PLAQUE} CONDITION: GOODMARKINGS: 2 COUNTY BOUNDARY SIGNS
1 SEC. TAG, ORANGE RIBBON

DESCRIPTION OF FOUND ACCESSORIES

7" DIAM OAK TREE
 WITH TOP THAT CURVES
 TO THE NW

CORNER POINT NOT FOUND

TAG READS

SEC. 17	T-1N R-10E	10
1/4 COR	10 FT. NE	20

NOTE: Indicate full investigative details on back of form.

PHOTO IDENTIFICATION

Symbol & date _____ Line or Roll _____ Exposure _____

How Identified _____ Where filed _____

RECOVERED BY: _____

DATE: _____

TITLE: _____

WAGE PINE 2 TOPS
S 82° W. APP. 30'

WAGE D. FR S. 50' E
APP. 25'