

SECTION OR SUBDIVISION

36/6
1/6

CORNER No.

789

TWP. ^{3N}/_{2N}, RANGE 9/10E, W.M.

CORNER DESCRIPTION

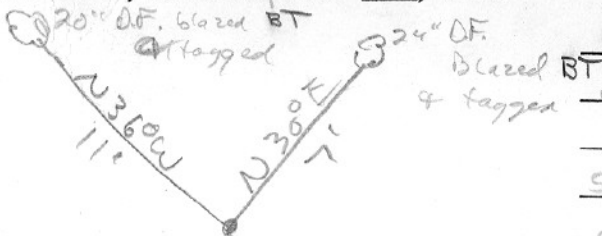

cor. is 2" I.P.
 in brass cap.
 approx 10' E of
 5/8" rebar set for approx
 cor.

W.O. REF. _____

CARD OF