

SECTION OR SUBDIVISION $\frac{1}{4}$ cor 16

TWP. 1 S, RANGE 9 E 10 E, W.M.

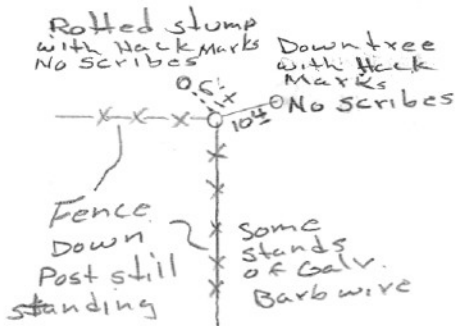

W.O. REF. _____

CORNER No. 779

CORNER DESCRIPTION

FD Old Fence
Cor. (cedar pole 6'
out of ground).

Fence Cor is best
evidence of 1/4
cor but does not
fit GLO ^{calls} from the
South by 40' & from
the North by 16'
ACK Mar 1977

CARD 1 OF 2

SEE NEXT CARD

SECTION OR SUBDIVISION

1/4 cor 166

TWP. 1S

RANGE 9/10 E, W.M.

CORNER No.

779

CORNER DESCRIPTION

D.L. Crow, set
2" I.D. w/ alum cap
IN 1985.

He accepted cedar
post + set pipe
alongside.

Fd. T.E.C. corner

34.4' S + 11.8' E

6" W.F.

7" W.F.

N 55° W
12.5

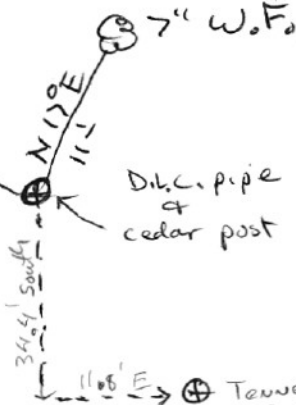

D.L.C. pipe
&
cedar post

34.4' South

11.8' E

Tennessee
single prop.
corner

W.O. REF.

CARD

2

OF

2