

SECTION OR SUBDIVISION

33 | 34  
4 | 3

24

TWP. 14....., RANGE 10E \_\_\_\_, W.M.

CORNER No. 775-A.....

CORNER DESCRIPTION

SEC CORNER Common

to Secs 33 | 34  
4 | 3

FD stone as per  
John Henderson Survey  
1907

Fd BT 16" OAK  
with SCALED FACE  
Matches Henderson's  
Ref 1907 Survey

Sec 3 IN 10E  
1977 ack

CARD 1 OF 2.....

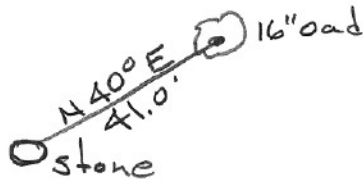
N 40° E  
41.0'  
Stone 

W.O. REF. \_\_\_\_\_

\_\_\_\_\_

\_\_\_\_\_

SECTION OR SUBDIVISION

33 | 37  
4 | 3

CORNER No. ~~775-B~~

775-B

TWP. <sup>2N</sup> 11N ..... , RANGE 10E ..... , W.M.

CORNER DESCRIPTION

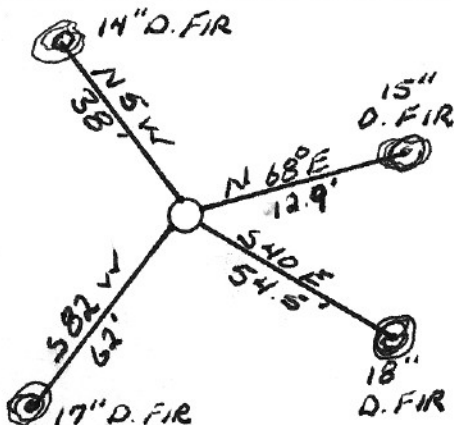

Set I.P. & BRASS CAP  
 AT STONE AS PER  
 CORNER CARD 775-A.  
 BLAZED & SCRIBED  
 FOUR B.T.'S AS  
 NOTED AT LEFT.

(SEE SKETCH ON BACK)

W.O. REF.

See "B.T.'s 81' & 82'"

3/8/82

CARD 2 OF 2

775-B

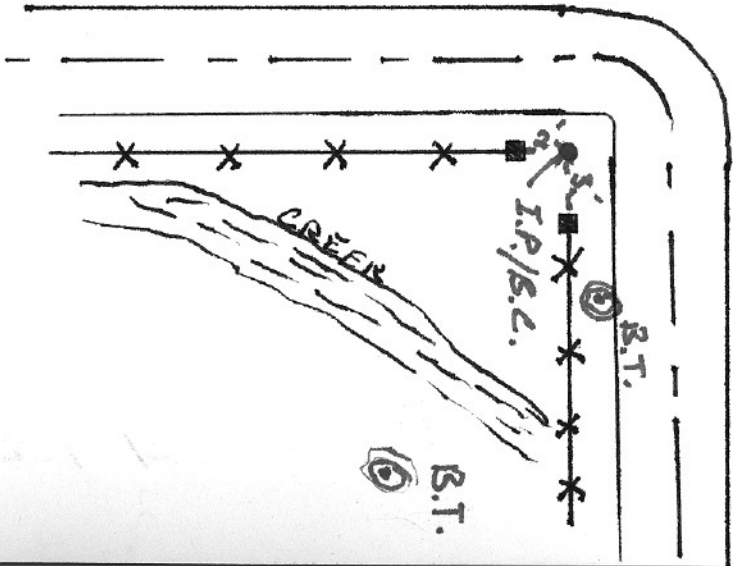
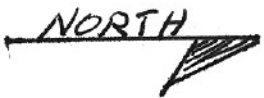

B.T.

I.P./S.C.

CREEK

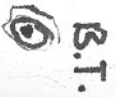

B.T.