

SECTION OR SUBDIVISION

1/4 COR 3166

CORNER No. 732

TWP. 3N/2N, RANGE 10 E, W.M.

CORNER DESCRIPTION



40" D. FIR, LIVE,
HEALED FACE
(ORIG 12", N10W, 0.52d)
W/TA9

FOUND 40" D. FIR BT, LIVE,
HEALED FACE 1 3/4" I.P. IN
RING OF STONES.

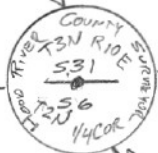

N75°E
18'

7" CHINQUAPIN
"S31 BT"
W/TA9

12" D. FIR
"T2N R10E
S6 BT"
W/TA9

16" D. FIR
"T2N R10E
S6 BT"
W/TA9

SET 2" BC/ I.P. IN RING
OF STONE & 3 NEW BTs'

W.O. REF.

COR IS 100± E OF DIRT RD (HRC
#3032?); N of "FIR" & "WALNUT"
HRC TIMBER SALES

FIELD BK 90-1

CARD

OF

1 OF 1