

SECTION OR SUBDIVISION 5

CORNER No. 709

TWP. 1S, RANGE 10 E, W.M.

CORNER DESCRIPTION

Set 5/8" I. Rod  
with Lead Cap  
1' below Surface



Orchard Access Road

Driveway

W 1/4 Cor. Sec 5 1S 10E

Set 5/8" I-Rod with  
Lead Cap 1' below

Surface just on south  
edge of Orchard Access  
Road.

Tag on  
Power Pole

Tag on Power Pole

1/2" Mile South of

Baseline Rd on E. Side of

Casper Spur Road

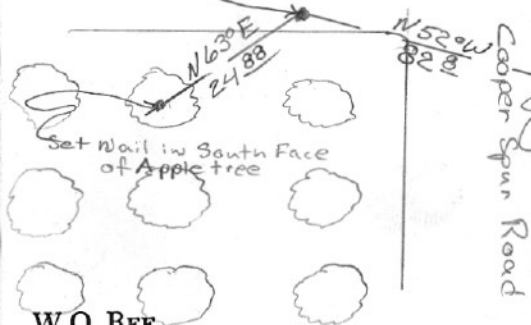

Cooper Spur Road

W.O. REF.

CARD OF