

SECTION OR SUBDIVISION

4/5/8/9

CORNER No.

627

B-1-90

TWP. 2N, RANGE 10E, W.M.

CORNER DESCRIPTION

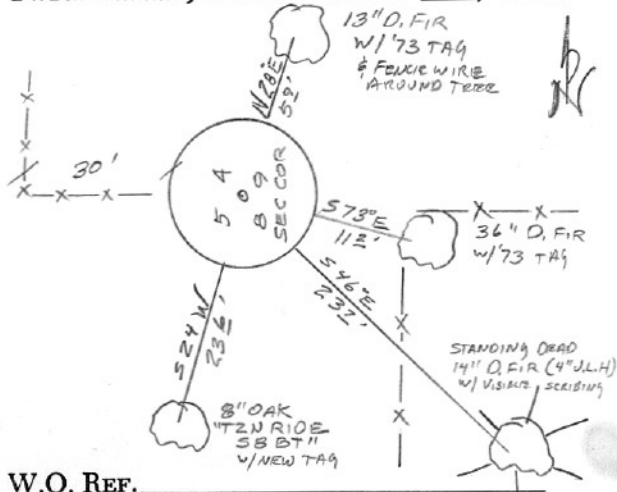

FOUND 2 1/2" OD. IP W/ LEAD CAP
OVER 1/2" IP W/ COUPLING, AS PER
ULH IN SURVEY RECORDS.

SET = 8" OAK

CORNER IS 50±' W OF PHILIPS CR.; 50±' @
N 40° E FROM END POWER POLE OF
LINE FROM SOUTH

W.O. REF.

FIELD BOOK 90-1, pg 90;

SURVEY RECORDS, BOOK 1, pg 444;

CARD

OF

CORNERS
IN
MONUMENT CASES ●

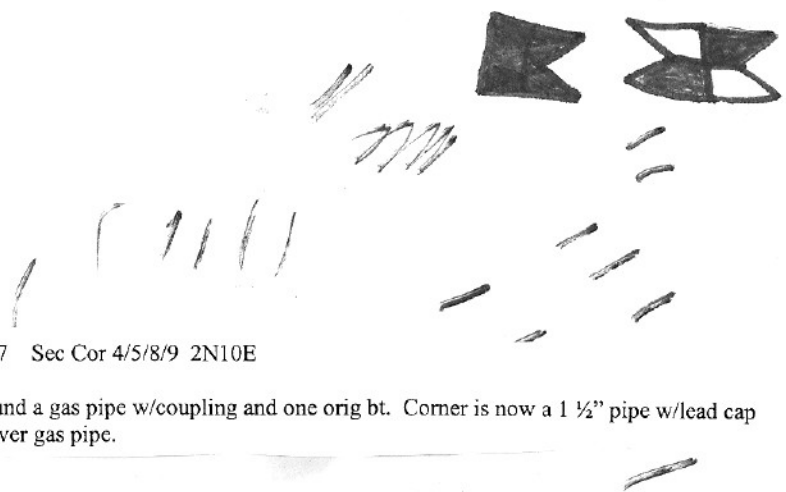

Cor# 627 Sec Cor 4/5/8/9 2N10E

JLH found a gas pipe w/coupling and one orig bt. Corner is now a 1 1/2" pipe w/lead cap driven over gas pipe.