

SECTION OR SUBDIVISION

9/10  
16/15 SEC. 60R

CORNER No.

559

TWP. 2N, RANGE 10E, W.M.

CORNER DESCRIPTION

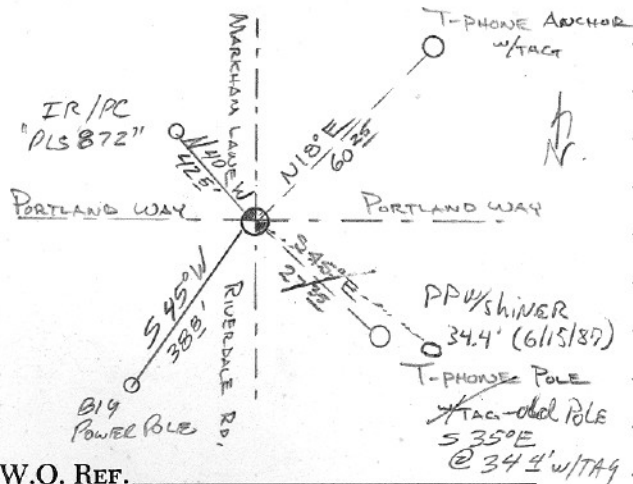

FD. BRASS CAP IN MON. CASE  
 BURIED BY STUPID ROAD DEPT.  
 UNDER 2" OF A/C.

1972 - MARCH

FD. MON BOX PAID OVER 6-20-90  
 ADDED RING ≠ RP'S AS SHOWN

W.O. REF.

FIELD BK 1-90, pg 54

FIELD BK 1-87

CARD

OF

Cor#559 sec cor 9/10/15/16 2N10E

This corner fits the old measurments to the west, east, and south fairly closely. Murray Kay found a stone and two orig bt's and set gas pipes 660'± to the east and 660'± to the south in 1911. See MK bk2 pp. 97-98 and bk4 pp. 5-7.