

SECTION OR SUBDIVISION SEC. COR.

18	17
19	20

CORNER No. 530

TWP. 13, RANGE 10 E, W.M.

CORNER DESCRIPTION

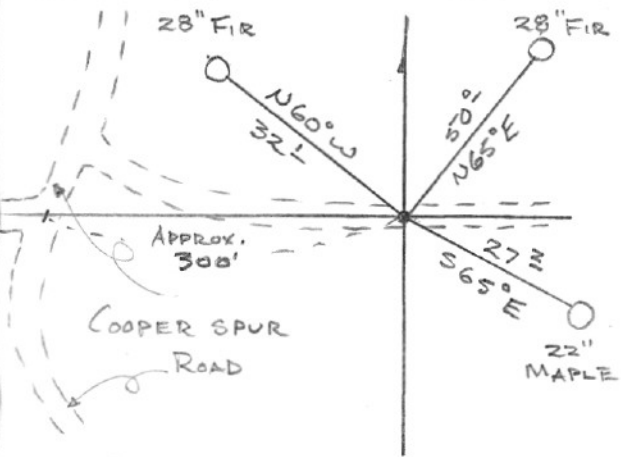

SET H.R.Co. BRASS
CAP IN CONCRETE
WITH COFFEE CAN FORM
8" BELOW ROAD SURFACE.
TAGGED & SCRIBED
3 TREES.
Cor. good 6/75 DD

W.O. REF. _____

ANTOINE SURVEY

SEPT. 28, 1971

CARD OF