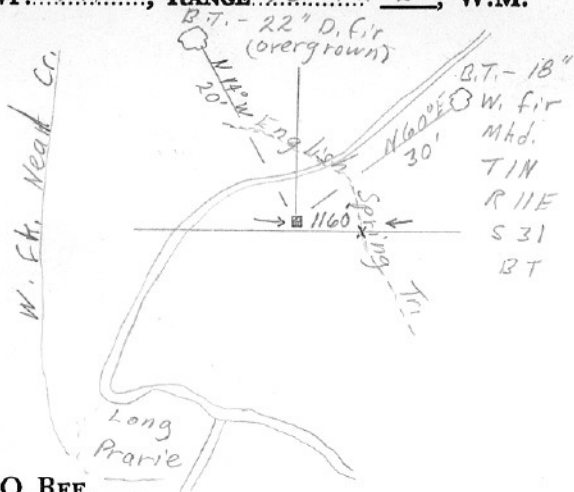

SECTION OR SUBDIVISION

TWP. 1 N, RANGE 10 & 11 E, W.M.CORNER No. 241

CORNER DESCRIPTION

Sec. CorRocks & 3x3x24 stakefd. by V.B.E. - May, 1945x - indicates position  
of sec. cor marker

W.O. REF. \_\_\_\_\_

CARD ..... OF .....

HOOD RIVER COUNTY CORNER RESTORATION FORM

Section: 31 Township: 1N Range: 11E

Date: 5/30/24

Corner Designation Z25

- Condition Report Only
- Not Found
- Renewed
- Unrecorded
- Surveyed In
- Referenced Out

**Previous Renewals/Surveys, etc:**

(1859)The U.S. General Land Office contracted with David P. Thompson, Deputy Surveyor, under contract No. 79, to survey the Baseline from the southeast corner of section 32 in T1N R8E to the southeast corner of T1N R32E, conducted May 21, 1859 through June 8, 1859. Thompson set "post for corner to Township 1 North of Ranges 10 & 11 East." References set:

- 18" fir, N30W, 35 links
- 18" fir, N84E, 3.33 links

(1879) The U.S. General Land Office contracted with Alonzo Gesner, Deputy Surveyor, under contract No. 336, on August 13, 1879 to survey the exterior lines of T1N R10E. Gesner found old post rotted down and lying on ground. Reference found:

- stump standing N85E, 33links
- Set fir post 4" in diameter, 3' long. Set references:
- 8" fir, N29E, 38 links
- 3" fir, N62W, 18 links

(1882) The U.S. General Land Office contracted with Henry Meldrum, Deputy Surveyor, under contract No. 436, on April 26, 1882 to subdivide T1N R10E, conducted in November of 1882. Meldrum found Thompson's work through R11E to be out of specifications and therefore resurveyed the Baseline. Found Post 4" diameter marked "T1NBL" on North face, "R11ES31" on East face, "R10ES36" on West face. Also 6 notches on North, East and West faces. References found:

- 8" fir, N29E, 38 links, marked " T1NR10ES36BT"
- 3" fir, N62W, 18 links, marked "T1NR11ES31BT"

(1945)Corner found by V.B.E, US Forest Service Corner Card No. 241, as "rocks and 3"x3"x24" stake" References found:

- 22" D. fir (overgrown), N14W, 20'
- 18" W. fir, N60E, 30', marked "T1NR11ES31BT"

(1984) Danny Cron, under contract with the U.S. Forest Service, CS1985036, performed field work in the fall of 1984. Cron set 2"x30" aluminum pipe with 3" aluminum cap stamped "T1N R10E S36/R11E S31/S2 T1SR10E 1984 PLS1028" Set orange post with sign attached warning against destroying. Set references:

- 12" D. Fir, N46E, 26.3', scribed "T1NR11ES31BT"
- 19"D. Fir, N57W, 38.2', scribed "T1NR10ES36BT"

Set Bearing Tree and Attention signs and 6" red band on Bearing Trees, set brass disc stamped "LS1028" on bottom of blaze.

**Monuments & Accessories Found: (Condition and Source)**

(2024) S. Deshong of US Forest Service, Columbia Land Zone recovered corner monument as set in 1984. References found:

- 27" Doug fir, N57W, 38.2' with healed blaze
- 13" doug fir, N46E, 26.3' with healed blaze

**Monument Detail**

Found 3" Aluminum Cap on 2.5" aluminum pipe, 1" high in collar of stone.

**Monument Set (Procedures and Description)**

None

**New Accessories:**

None

**Location & Comments:**

- Corner lies approximately 100' South of Rd170
- Set aluminum guard posts 5' East and West of monument w/Property Boundary and Land Survey Monument signs attached.
- Painted 6" red bands around Bearing Trees.

**Sketch**

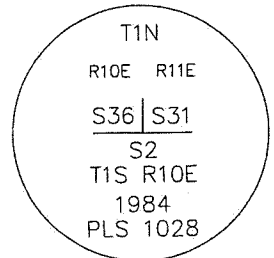

**Surveyor's Seal**

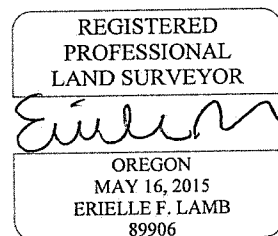

EXPIRES: 12/31/2024

Compass Declination \_\_\_\_\_  
 Firm/Agency USDA Forest Service  
Gifford Pinchot National Forest, Columbia Lands Zone  
 Address 987 McClellan Road  
Vancouver, WA 98661  
 Party Chief S. Deshong  
 Notes \_\_\_\_\_  
 Witness R. Ellis, C. Clark