

SECTION OR SUBDIVISION

33 - 34

CORNER NO.

235

TWP. 1N, RANGE 10, W.M.

CORNER DESCRIPTION

SC
TIN RIOE
33 | 34
TIS RIOE
1968

Toll Bridge Paved Rd.

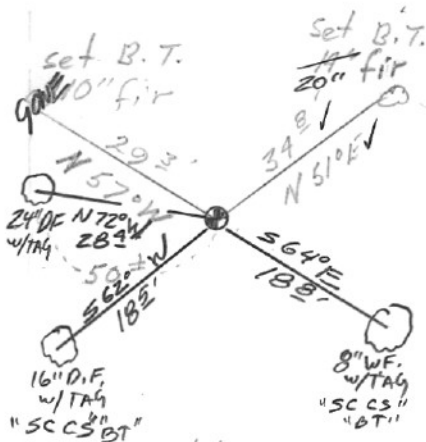

Set Brass Cap

Y - 677, 435.70

X - 4726, 575.17

SET 3 NEW BT'S 11-89

W.O. REF.

3774 orth

1027 Baseline T.E.C.

CS BK 1-89

CARD

P. 1 OF

P. 1

SECTION OR SUBDIVISION

33 | 34

CORNER No. 715 233TWP. 1N, RANGE 10S E, W.M.

CORNER DESCRIPTION

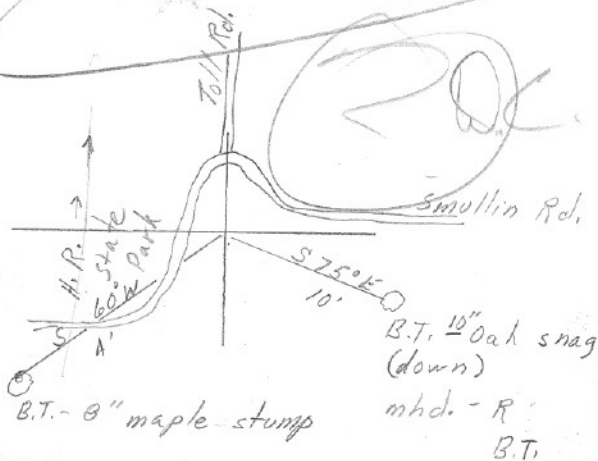
Sec. Cor.I. pipe 2" x 12"fd. by V.R.E. Mar., 1946B.T. 10" Oak snag
(down)mhd. - R
B.T.

W.O. REF. _____

CARD 1 OF 2