

SECTION OR SUBDIVISION $\frac{1}{4}$ COR 14 • 13

CORNER No. ~~218~~ 218

TWP. 1N, RANGE 9E, W.M.

CORNER DESCRIPTION

Fd. BT. set nail on
E. side 1' up.

cor is 2" I.P.
w/ brass cap
1" below surface

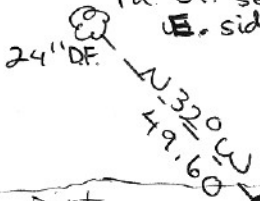

Cor was reset by using
information from Section
breakdown from Dec
Flat Thinning See Back
of Card

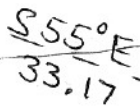

18" D.F.
Fd. BT. set
nail on w side
1' up.

W.O. REF. _____

CARD 1 OF 1

21-75

This Cor. & the one on [#] 19 was
set by using the information
from the worksheet located in
the Dee Flat Thinning File. The
distance between the Cent. Sec
& N/4 was checked to proportion
the distance however we checked
their work and found only .06 ft.