

SECTION OR SUBDIVISION

CORNER No. 202

TWP. 1N, RANGE 9 E, W.M.

CORNER DESCRIPTION

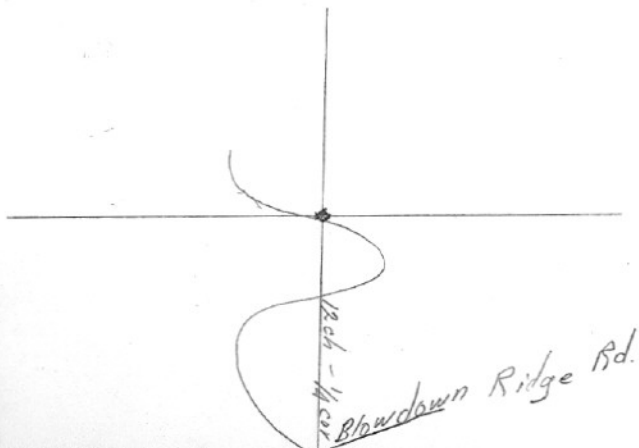

1/16 cor
4" x 4" x 36"
mhd. 1/16 S 9 + 1/16 S 10
similar to type set
by Bert Udall
Ed. by R. Ward
9/21/60

W.O. REF. _____

see note on back

CARD..... OF

N. of road down slight grade in cut over
area. Blow down tree hit same bending it,
18" fir by road in N.S. line cor. blaze.
E & W with paint & blaze on trees

202