

SECTION OR SUBDIVISION

CORNER No. .... 172 .....

TWP. .... 15 ....., RANGE ..... 9 ..... 5, W.M.

CORNER DESCRIPTION

I.P. W/BRASS CAP MOUND ROCK

N.W. 1'

BT. WITH 16" 10° 30'

DI. 20" 240° 12'

42" 350° 28'

6" 24° 14' DEAD

FOUND T.E. NEWELL JULY 11, 1958

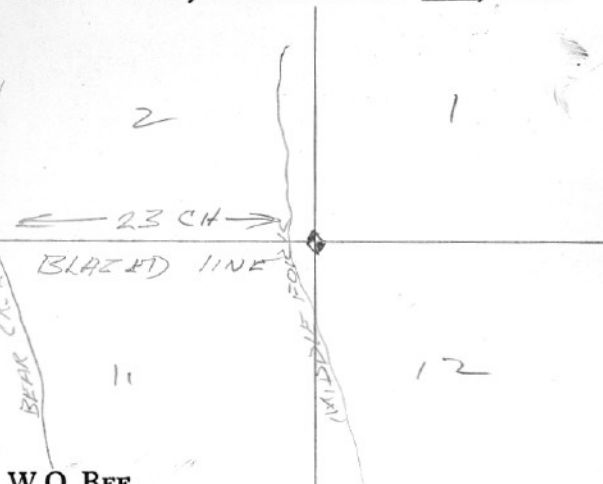

W.O. REF. \_\_\_\_\_

CARD ..... OF .....