

SECTION OR SUBDIVISION 30-31

CORNER No. 94

TWP. 11N., RANGE 10 E, W.M.

CORNER DESCRIPTION

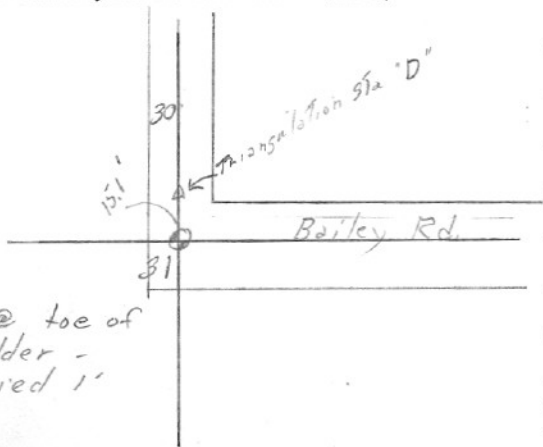

S 1/4 Cor Sec 30

fd 1 1/4" Pipe

A "D" y - 683,082.82

x - 1,713,205.55

y - 683,067.73

x - 1,713,205.29

Cor. @ toe of shoulder - buried 1'

W.O. REF. \_\_\_\_\_

Tennison #3737 Cor #262

see back

CARD ..... OF .....

94

Replaced by Oreg. Lum. Co. when tract  
in Sec. 30 was subdivided - according to  
V.B.E. - 1961

tag on 6" maple on SW side of rd.

S 50° W - 12' from cor.