

SECTION OR SUBDIVISION

 $\frac{1}{12} \frac{6}{7}$

CORNER No. 54

TWP. 1N, RANGE 9&10 E, W.M.

CORNER DESCRIPTION

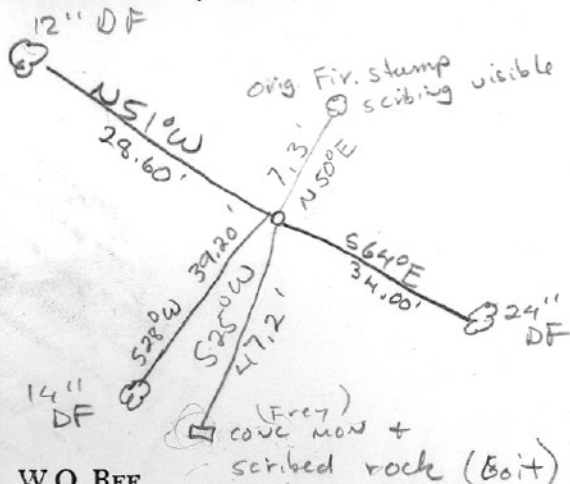

W.O. REF.

cor. is 1 1/2" I.P. with
 lead cap. Set in
 Dec. 1979 by HRC.
 Fd. 3 other scribed BT's,
 not orig., + tagged said trees

Fd. conc. mon. (Frey) &
 stone set by Goit in
 1906 47.2' S25°W.

CARD 1 OF 3

SECTION OR SUBDIVISION

116
12/7

void

CORNER No.

54

TWP. 1 N, RANGE 9410 E, W.M.

CORNER DESCRIPTION

R 9E
1

R 10E
6

LP in mound of stone
Found by Geo Frey
5-60
2 old BT's - NOT
identified.

To Dee Flat

Punch B. Rd.
Hood R.

12

Dee 7

3" x 30" stake & rock mound
May, 1944 W. R. E.

W.O. REF.

see sketch on back

CARD

2

OF

3

54

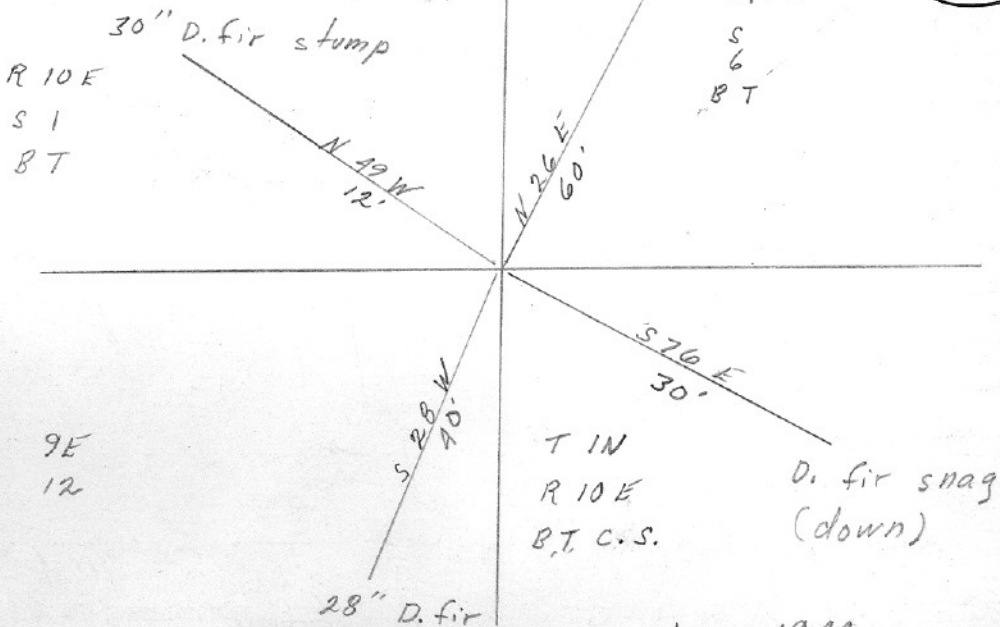

May 7 1944

SECTION OR SUBDIVISION

 $\frac{16}{7}$ ~~VOID~~

CORNER No.

54A

TWP. 1N....., RANGE 9E 10 E, W.M.

CORNER DESCRIPTION

12" FIR

N53W
28 22'

R9E

R10E

TIN

1

6

12

7

N50°E ORIGINAL BT
7 26'
N63°E ROTTEN STUMP
24 12'

10" FIR

S30°W
39 02'S65°E
34 00'

24" FIR

12" FIR

W.O. REF. _____

CORNER No.

54A

CORNER DESCRIPTION

SET 1" x 2" WOODEN

STAKE 7/19/70

H.B.C.O.

(Stake replaced with
1 1/2" I.P. w/ lead cap
Dec. 1979 RJA)

CARD

EM

OF

W