

SECTION OR SUBDIVISION  $\frac{1}{4}$  33/34

CORNER No. 44

TWP. 2N, RANGE 9 E, W.M.

CORNER DESCRIPTION

$\frac{1}{4}$  33/34

Iron rod with 3"

Brass marked 33-34 2N4

2 BT's are not originals

70' W on a brushed line

is a metal tag telling  
distance with sig. RMW

Found by A. Hutson

4-25-68 - Not Verified

SEE  
NEXT  
CARD

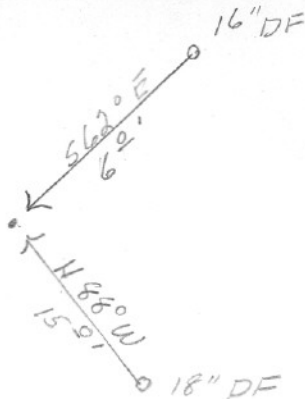

W.O. REF. \_\_\_\_\_

CARD 1 OF 2

SECTION OR SUBDIVISION

1/4 cor 33/34

CORNER No.

44

TWP. 2N, RANGE 9E, W.M.

CORNER DESCRIPTION

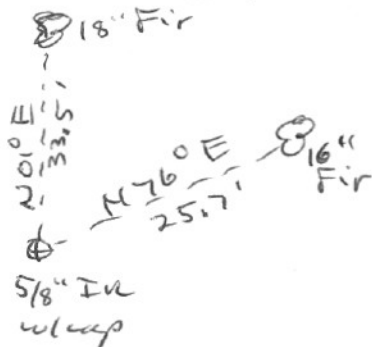

cor set by  
 single proportion  
 in 1979 by TEC

W.O. REF.

Dwg # 79067

CARD

2

OF

2