

T 2S R 10E M WILL

SECTION 15, R10E

HES

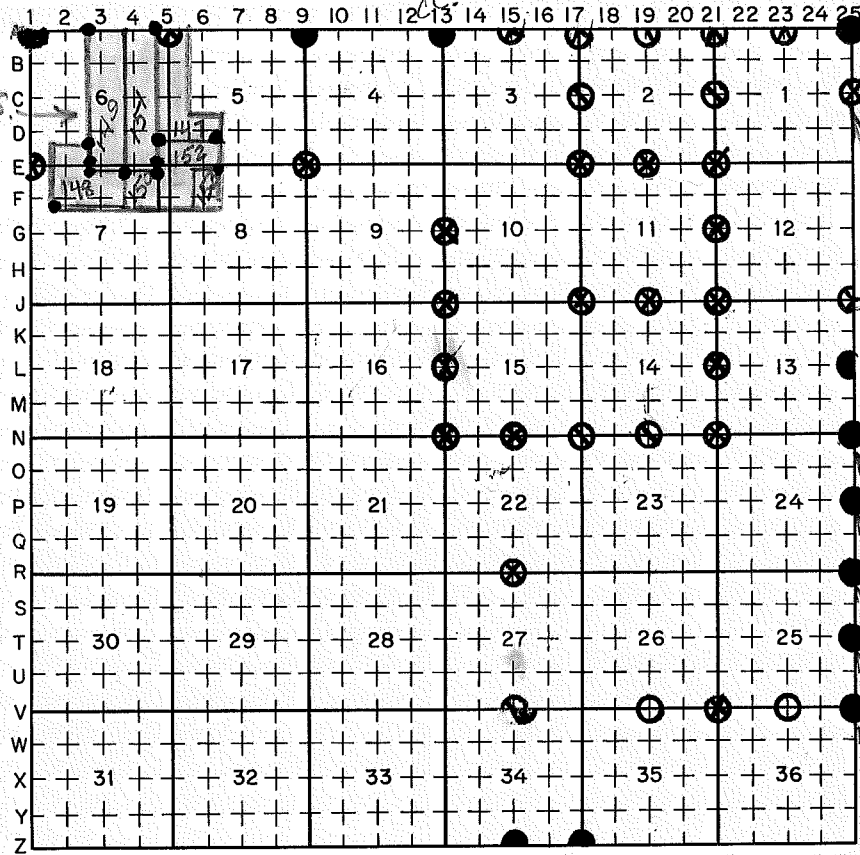

**LEGEND**

- PERMANENT MONUMENT
- ⊗ ORIGINAL CORNER RECOVERED
- ⊙ EVIDENCE RECOVERED
- SEARCHED, NOT FOUND

**FILING INSTRUCTION**

File 5680-2 card record by letter and number coordinates behind the file guide for the township in which it falls.

File the 5680-2 card record by letter and then by number i.e., all A cards first, then B cards etc.

The first card behind the file guide (if data have been obtained and recorded) will be card A-1 for N.W. Township Corner, then card A-2 for 1/16 corner then card A-3 for 1/4 corner etc.

SEE T2S, R10E

Index

File No. A-1

**CORNER RECORD (SEARCH)**

(Ref. FSM 7151.4)

Tract or Survey No. \_\_\_\_\_

Cor. No. Section

T 2S R. 10E

R.D. Hood River County Hood River

Merid. Willamette

N.F. Mt. Hood State Oregon

CORNER DIAGRAM Sec.6

DESCRIBE CORNER MONUMENT FOUND

Stone buried in ground 6"x11"x5" exposed X on top.

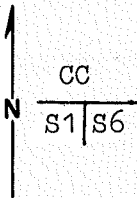

DESCRIBE BEARING TREES OR OTHER OFFICIAL ACCESSORIES FOUND

Orig. 18" Fir now 30" D-Fir bears S42E-29 lks. Face well healed.  
 Orig. 30" Fir now 36" stump bears S37W-6 lks. healed over blaze  
 apparently chopped out so scribing can be read. T2S S1  
 R9E BT

PHOTO IDENTIFICATION DATA

Photo No. \_\_\_\_\_

Filed At. \_\_\_\_\_

Object Ident. \_\_\_\_\_

Ident. By \_\_\_\_\_

*Signature*

PLANE COORDINATE POSITION DATA

State \_\_\_\_\_ Zone \_\_\_\_\_

X \_\_\_\_\_

Y \_\_\_\_\_

Estab. By \_\_\_\_\_

*Agency*

DESCRIBE CORNER LOCATION RELATIVE TO NEAR-BY FEATURES, ALSO HOW TO REACH CORNER

From Cooper Spur Inn drive towards Hood River on Cooper Spur road approx. 1/2 + mile to 1/4 S31 and posted line. Follow posted line West 2100 feet to corner.

*Signature*

Signature

Title  
Land Surveyor

Division

Headquarters

Date  
10/83

FS-7100-52 (3/68)

**CORNER RECORD (PERPETUATION)**

**MONUMENT : DESCRIBE NEW MONUMENT SET, OR WORK DONE TO PRESERVE EXISTING MONUMENT**

Set 2½" x 30" Aluminum pipe with a 3" Aluminum cap, 20" in ground 1.91 feet South-made rock mound to within 4" of cap. Left orig. stone in place.

Marked:

R9E - R10E

A.M.

T1S CC

T2S S1 | S6

1983

PLS 896

9

**ACCESSORIES : DESCRIBE NEW BT'S WITNESS OBJECTS ETC. ESTABLISHED, OR WORK DONE TO PRESERVE EXISTING EVIDENCE**

6" Wh. Fir S55W-34.4 ft. scribed T2SR9ES1CCBT and with a 1" Brass disk stamped PLS 896.

10

Work Done By Larry D. Bishop Title Surveyor

Date 10/83

State Registration No. 896  
or Agency

Certified Cor. Record Prepared ? Yes No  Filed At:

Date

11

**REMARKS**

Painted blazes and bands new and old BT's, signed BT's.  
Guard posts East and West with boundary and survey marker decals.

12

Index File No.

T.2S

R. 10E

M.

Tract or Surv. No.

Cor. Section 13

LAND CORNER RECORD

5680-2

1. T2S R 10E No. A1 Cor. Mer. WM State Oregon (Rectangular) N. F. Mt. Hood Dist. Hood River

2. Corner Status

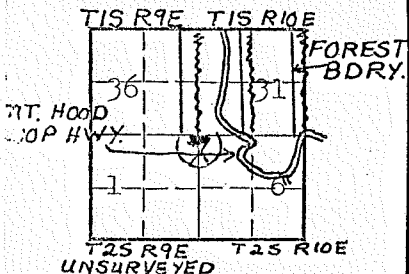

7. Photo Identification

Photo No. \_\_\_\_\_  
Ident. By: \_\_\_\_\_

8. Plane Coordinate Position Data

State \_\_\_\_\_ Zone \_\_\_\_\_  
X \_\_\_\_\_  
Y \_\_\_\_\_  
Estab. By \_\_\_\_\_  
Field Book No. \_\_\_\_\_  
Where Filed \_\_\_\_\_

9. Evaluation

Authentic \_\_\_\_\_  
Needs Verif. \_\_\_\_\_ Monument \_\_\_\_\_  
Re-estab. \_\_\_\_\_ Survey \_\_\_\_\_  
Land Status \_\_\_\_\_

3. Original Description \_\_\_\_\_ Vol. \_\_\_\_\_ Page \_\_\_\_\_ Where Recorded \_\_\_\_\_

4. Description of Corners: Corner consists of a basalt stone in place. Good condition. Dimensions above ground 12x8x4".

+			
ON			
TOP			
N	W	S	E
CARDINAL POSITION			

COMMON ONLY TO 6 & 1

5. Investigation Notes:

Grown Over	T2S
	R10E
	S 6
	B.T.

Species	Hemlock	D. Fir Stump
Diameter	30"	36"
Bearing	S41°E	S24°W
Distance	16'	4'

Believed to be a genuine Land Office Corner. This corner is approximately 2000' West of entrance marker on the Loop Highway.

**OLD HIGHWAY 35 AT HUTSON PARK. ✕**

6. Signed Van B. Embree Title \_\_\_\_\_ Date 1959



1. T. 2S R. 10E No. A5 Cor. Sec. Mer. WM State Oregon (Rectangular) N. F. Mt. Hood Dist. Hood River

2. Corner Status

T1S R10E

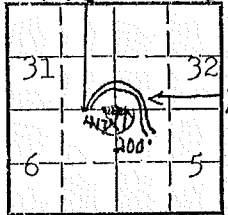

T2S R10E

7. Photo Identification

Photo No. \_\_\_\_\_

Ident. By: \_\_\_\_\_

8. Plane Coordinate Position Data

State \_\_\_\_\_ Zone \_\_\_\_\_

X \_\_\_\_\_

Y \_\_\_\_\_

Estab. By \_\_\_\_\_

Field Book No. \_\_\_\_\_

Where Filed \_\_\_\_\_

9. Evaluation

Authentic \_\_\_\_\_

Needs Verif. \_\_\_\_\_ Monument \_\_\_\_\_

Re-estab. \_\_\_\_\_ Survey \_\_\_\_\_

Land Status \_\_\_\_\_

3. Original Description \_\_\_\_\_ Vol. \_\_\_\_\_ Page \_\_\_\_\_ Where Recorded \_\_\_\_\_

4. Description of Corners: Corner consists of a - 2 rocks. Dimensions above ground No. 1 rock 14x12x4" No. 2 rock 12x6x3".

ON TOP

No. 1	-	CC	III
		III	
N	W	S	E

COMMON TO 5 & 6

5. Investigation Notes:

Grown Over Grown Over

Species Larch D. Fir

Diameter 24" 20"

Bearing S15°E S 7°30'W

Distance 137' 159'

Believed to be a genuine Land Office Corner. Metal Locatinn Pgster is on a D. Fir tree 8" diamter from which this Corner bears N8 W 15'. This corner is 417'E of section corner 31-32 T1S,R10E. Section line marker on Mt. Hood Loop Highway on a post 200' East at corner.

6. Signed Van B. Embree Title Guard

Date Aug. 2, 1954 & 2/4/44

USDA-FOREST SERVICE

Index  
File No. A-9

CORNER RECORD (SEARCH)

(Ref. FSM 7151.4)

Tract or  
Survey No. \_\_\_\_\_  
Cor.  
No. \_\_\_\_\_

T 2S R. 10E R.D. Hood River County Hood River

Merid. Willamette N.F. Mt. Hood State Oregon

CORNER DIAGRAM

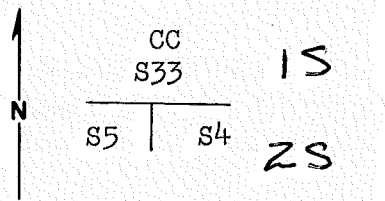

DESCRIBE CORNER MONUMENT FOUND

Stone 16 x 12 x 6 mkd. CC on South  
4 grooves on East  
2 grooves on West

DESCRIBE BEARING TREES OR OTHER OFFICIAL ACCESSORIES FOUND

Orig. 36" now 36" Pine S83W 100.0' recorded as S81W 99.7'  
scribing visible  
Orig. 30" now 40" Larch S10E 87.3' recorded as S 8°E 87.8'  
blaze mostly overgrown

PHOTO IDENTIFICATION DATA

Photo No. \_\_\_\_\_  
Filed At. \_\_\_\_\_  
Object Ident. \_\_\_\_\_  
Ident. By \_\_\_\_\_  
*Signature*

DESCRIBE CORNER LOCATION RELATIVE TO NEAR-BY FEATURES, ALSO HOW TO REACH CORNER

From the end of Road #S-204R follow the old Dog River Trail to the new Dog River Trail follow the new Trail North to the foot of steep slope and a location poster on a 26" White Fir- See sign for Bearing & Dist. to corner

PLANE COORDINATE POSITION DATA

State \_\_\_\_\_ Zone \_\_\_\_\_  
X \_\_\_\_\_  
Y \_\_\_\_\_  
Estab. By \_\_\_\_\_  
*Agency*

*Signature* \_\_\_\_\_ Title Owner Division \_\_\_\_\_ Headquarters \_\_\_\_\_ Date 10/79 7100-52 (3. 68)

CORNER RECORD (PERPETUATION)

MONUMENT: DESCRIBE NEW MONUMENT SET, OR WORK DONE TO PRESERVE EXISTING MONUMENT

Set 2 1/2" Brass Cap in a 2 1/2" x 30" Galvanized Iron Pipe in mound of stone  
Buried stone upside down next to monument

ACCESSORIES : DESCRIBE NEW BT'S WITNESS OBJECTS ETC. ESTABLISHED, OR WORK DONE TO PRESERVE EXISTING EVIDENCE

Added red paint and BT signs to orig. BT's

Work Done By Larry Bishop Title Surveyor Date 10/79 State Registration No. 896  
or Agency \_\_\_\_\_  
Certified Cor. Record Prepared? Yes  No  Filed At: \_\_\_\_\_ Date \_\_\_\_\_

REMARKS

Set Guard Post North with sign 54-4

Index File No. T. R. M. Tract or Surv. No. Cor. 12 13

Index  
File No. A-9  
T ZS R. 10E  
Merid. WM

CORNER RECORD (SEARCH)

(Ref. FSM 7151.4)

Tract or  
Survey No. \_\_\_\_\_  
Cor.  
No. \_\_\_\_\_  
R.D. H.R. County H.R.  
N.F. MT HOOD State OR

CORNER DIAGRAM

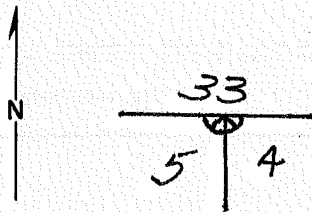

DESCRIBE CORNER MONUMENT FOUND BASALT STONE 5" X 7" X 5" ABOVE GROUND. VISIBLE = ON W & E ONE. STONE IN WELL SET IN GROUND ABOUT 12" FAIR CONDITION. YELLOW FLAGGING

AGREES WITH GLO NOTES

DESCRIBE BEARING TREES OR OTHER OFFICIAL ACCESSORIES FOUND

3 1/4" LARCH 55° E 90' LARGE "X" ON N SIDE, BLAZE NEAR BASE, ROTTED OUT.

LOCATION POSTER ON 6" PINE S 15° W 15' DIST POSTED BY VAN EMBRY 1953

DID NOT HAVE GLO NOTES, SO DIDN'T FIND SW QUAD BT. THE TREE FOUND HOWEVER  
AGREES WITH GLO NOTES

DESCRIBE CORNER LOCATION RELATIVE TO NEAR-BY FEATURES, ALSO HOW TO REACH CORNER

COR IS APPROX 400' WEST OF 2ND SWITCH BACK OF NEW DOG RIVER TRAIL - NO LOCATION POSTER.

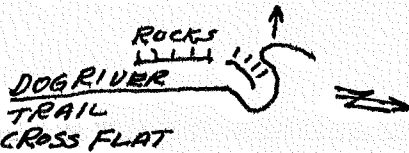

PHOTO IDENTIFICATION DATA

Photo No. \_\_\_\_\_  
Filed At. \_\_\_\_\_  
Object Ident. \_\_\_\_\_  
Ident. By \_\_\_\_\_  
*Signature*

PLANE COORDINATE POSITION DATA

State \_\_\_\_\_ Zone \_\_\_\_\_  
X \_\_\_\_\_  
Y \_\_\_\_\_  
Estab. By \_\_\_\_\_

DAVE TURNER Agency H.R.

Signature

Title

Division

Headquarters

Date

7100-52 (3/68)

GLENN V. CLEVENGER SURVY TECH L.L.L. S.O.

05-25-79

CORNER RECORD (PERPETUATION)

MONUMENT : DESCRIBE NEW MONUMENT SET, OR WORK DONE TO PRESERVE EXISTING MONUMENT

9

ACCESSORIES : DESCRIBE NEW BT's WITNESS OBJECTS ETC. ESTABLISHED, OR WORK DONE TO PRESERVE EXISTING EVIDENCE

10

Work Done By \_\_\_\_\_ Title \_\_\_\_\_ Date \_\_\_\_\_ State Registration No. or Agency \_\_\_\_\_

Certified Cor. Record Prepared ? Yes No Filed At: \_\_\_\_\_ Date \_\_\_\_\_

11

REMARKS

12

Index File No. T. R. M. Tract or Surv. No. Cor. \_\_\_\_\_

13

USDA-FOREST SERVICE

Index

File No. A-13

CORNER RECORD (SEARCH)

(Ref. FSM 7151.4)

Tract or Survey No. \_\_\_\_\_

Cor. No. \_\_\_\_\_

T. 2S R. 10E

R.D. Hood River County Hood River

Merid. Willamette

N.F. Mt. Hood State Oregon

CORNER DIAGRAM

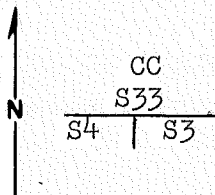

DESCRIBE CORNER MONUMENT FOUND

Stone 19x15x12 with "X" on top, CC on South -3 Grooves on East and West.

2

DESCRIBE BEARING TREES OR OTHER OFFICIAL ACCESSORIES FOUND

Orig. 7" now White Fir stump 1 foot high scribing rotted away S20W 7.3 feet

Orig. 12" now 16" White Fir with face grown over S 8°E 5.6' (recorded as S14E 5.9 feet)

PHOTO IDENTIFICATION DATA

Photo No. \_\_\_\_\_

Filed At. \_\_\_\_\_

Object Ident. \_\_\_\_\_

Ident. By \_\_\_\_\_

*Signature*

PLANE COORDINATE POSITION DATA

State \_\_\_\_\_ Zone \_\_\_\_\_

X \_\_\_\_\_

Y \_\_\_\_\_

Estab. By \_\_\_\_\_

*Agency*

DESCRIBE CORNER LOCATION RELATIVE TO NEAR-BY FEATURES, ALSO HOW TO REACH CORNER

Corner is located 50 feet East of road N107N 0.4 mile from its junction with N107

*Signature*

*Title*

Owner

*Division*

*Headquarters*

*Date*

8/79 100-52 (3. 68)

(5) LARRY BISHOP

5

CORNER RECORD (PERPETUATION)

MONUMENT: DESCRIBE NEW MONUMENT SET, OR WORK DONE TO PRESERVE EXISTING MONUMENT

Set 2½" x 30" Gal. Steel pipe with a 2½" Brass cap in mound of stone - Buried stone up side down next to monument set.

ACCESSORIES : DESCRIBE NEW BT'S WITNESS OBJECTS ETC. ESTABLISHED, OR WORK DONE TO PRESERVE EXISTING EVIDENCE

14" Lodgepole Pine S41½ W - 83.0 feet scribed T25|R10E S4 upper blaze and a lower blaze scribed BT and with a ¾" Brass Disk stamped PLS 896

Work Done By L. Bishop Title Surveyor Date 8/79 State Registration No. 896  
or Agency

Certified Cor. Record Prepared? Yes  No  Filed At: Hood River County Date Oct. 1979

REMARKS

Set guard post East with sign 54-4

Signed and painted BT's per contract instructions

Index File No. T. R. M. Tract or Surv. No. Cor.

Index  
File No. A-13

CORNER RECORD (SEARCH)  
(Ref. FSM 7151.4)

Tract or  
Survey No. \_\_\_\_\_  
Cor.  
No. \_\_\_\_\_

T 25 R. 10E  
Merid. MM

R.D. H.R. County H.R.  
N.F. MT Hood State OR

CORNER DIAGRAM

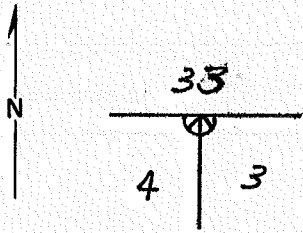

DESCRIBE CORNER MONUMENT FOUND 15" X 12" X 6" ABOVE GROUND BASALT STONE, MARKED 'X' ON S. SIDE OF TOP 'C' ON S. SIDE, E ON E. & W. SIDES. GOOD CONDITION

AGREES WITH G.L.O. NOTES 2

DESCRIBE BEARING TREES OR OTHER OFFICIAL ACCESSORIES FOUND  
18" W. FIR S 8° E 5 1/2' DIST. BLAZED AT 1' & 4'; 'X' AT 5' & BLAZED AT 3 1/2' ON N.E.

3' HIGH SHATTERED STUMP, WAS ABOUT 14" W. FIR BENG S 22° W 7' DIST. PULLED STUMP APART & FOUND SCRIBING "T25, R10E, S4, BT,"

AGREES WITH GLO NOTES 3

DESCRIBE CORNER LOCATION RELATIVE TO NEAR-BY FEATURES, ALSO HOW TO REACH CORNER  
FROM JUNG. N-107 & N-107N, TRAVEL 0.6 MI WEST ON N-107N. COR IS 30' NORTH OF N-107N. FLAGGED WITH YELLOW RIBBON

PHOTO IDENTIFICATION DATA

Photo No. \_\_\_\_\_  
Filed At. \_\_\_\_\_  
Object Ident. \_\_\_\_\_  
Ident. By \_\_\_\_\_  
*Signature*

PLANE COORDINATE POSITION DATA

State \_\_\_\_\_ Zone \_\_\_\_\_  
X \_\_\_\_\_  
Y \_\_\_\_\_  
Estab. By \_\_\_\_\_  
*Agency*

*OVER*

Signature GLENN V. CLEVENGER Title SURVYNG TECH L.L.L. Division S.O. Headquarters \_\_\_\_\_ Date 07-05-79 7100-52 (3/68)



CORNER RECORD (PERPETUATION)

MONUMENT: DESCRIBE NEW MONUMENT SET, OR WORK DONE TO PRESERVE EXISTING MONUMENT

REMONUMENTED 10/99 BY BISHOP SURVEYING  
 SET 2 1/2" BRASS CAP IN 2 1/2" X 30" I.P.  
 PAINTED S.E. B.T. & S.W. B.T. STUMP  
 SET NEW S.W. B.T. ACROSS ROAD  
 BURIED STONE BENEATH ROCK MOUND AT BASE OF I.P. *LC*

ACCESSORIES: DESCRIBE NEW BT'S WITNESS OBJECTS ETC. ESTABLISHED, OR WORK DONE TO PRESERVE EXISTING EVIDENCE

10

Work Done By \_\_\_\_\_ Title \_\_\_\_\_ Date \_\_\_\_\_ State Registration No. or Agency \_\_\_\_\_

Certified Cor. Record Prepared? Yes No Filed At: \_\_\_\_\_ Date \_\_\_\_\_

11

REMARKS

Index File No. T. R. M. Tract or Surv. No. Cor. \_\_\_\_\_

12

13

1. T 25 R 10E No. A-13 Cor. SEC Mer. W State ORE (Rectangular) N. F. MT HOOD Dist. HOOD R.

2. Corner Status

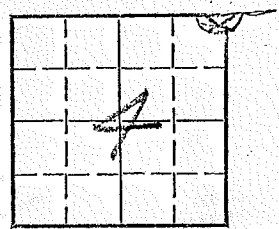

7. Photo Identification

Photo No. \_\_\_\_\_  
Ident. By: \_\_\_\_\_

8. Plane Coordinate Position Data

State \_\_\_\_\_ Zone \_\_\_\_\_  
X \_\_\_\_\_  
Y \_\_\_\_\_  
Estab. By \_\_\_\_\_  
Field Book No. \_\_\_\_\_  
Where Filed \_\_\_\_\_

9. Evaluation

Authentic X  
Needs Verif. \_\_\_\_\_ Monument X  
Re-estab. \_\_\_\_\_ Survey \_\_\_\_\_  
Land Status N.F.

3. Original Description \_\_\_\_\_ Vol. \_\_\_\_\_ Page \_\_\_\_\_ Where Recorded \_\_\_\_\_

4. Description of Corners:  
Rock 12" X 15" WITH "X" ON SOUTH SIDE AND "CC" ON SW SIDE, S. 10° E TO 18" WHITE FIR WITH AN X BLAZED ON IT, SCRIBING ON TRUNK IS OVERGROWN WITH BARK. S 40° W TO 9" WHITE FIR WITH X ON IT - TREE IS FRESHLY BROKEN AT BASE

5. Investigation Notes:

CONDITION POOR.  
CORNER IS LOCATED INSIDE R/W OF PROPOSED TBR SALE ROAD. NEEDS PROPER MONUMENTATION.

6. Signed M. J. Conley Title Surveyor T.M.A. Date 8/5/69

1. T. 2S R. 10E No. A13 Cor. Sec. Mer. WM State Oregon (Rectangular) N. F. Mt. Hood Dist. Hood River

2. Corner Status

STEEL BREAK

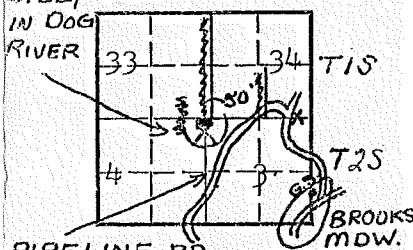

7. Photo Identification

Photo No. \_\_\_\_\_

Ident. By: \_\_\_\_\_

8. Plane Coordinate Position Data

State \_\_\_\_\_ Zone \_\_\_\_\_

X \_\_\_\_\_

Y \_\_\_\_\_

Estab. By \_\_\_\_\_

Field Book No. \_\_\_\_\_

Where Filed \_\_\_\_\_

9. Evaluation

Authentic \_\_\_\_\_

Needs Verif. \_\_\_\_\_ Monument \_\_\_\_\_

Re-estab. \_\_\_\_\_ Survey \_\_\_\_\_

Land Status \_\_\_\_\_

3. Original Description \_\_\_\_\_ Vol. \_\_\_\_\_ Page \_\_\_\_\_ Where Recorded \_\_\_\_\_

4. Description of Corners: Corner consists of a Basalt Stone in place. Good condition. Dimensions above ground 14x10x6".

+ ON	TOP	CC	≡
N	W	S	E

COMMON ONLY TO 3 &amp; 4

5. Investigation Notes: Grown Over Grown Over

Species W. Fir W. Fir

Diameter 18" 8"

Bearing S10°E S20°W

Distance 4' 5'

Believed to be a genuine Land Office Corner. Metal Location Poster is on a W. Fir (B.T.) tree 18" diameter from which this Corner bears N 10° W 4'.

6. Signed Van B. Embree Title \_\_\_\_\_ Date 1958

LAND CORNER RECORD

1. T. 25 R. 10E No. A15 Cor. 1/4 Mer. WM State Oregon N. F. Mt. Hood Dist. Hood River

2. Corner Status PIPELINE

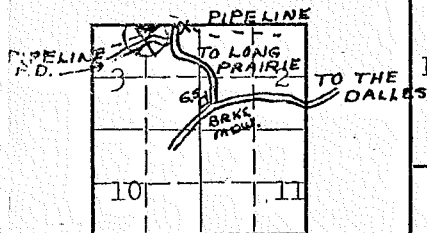

COMMON TO SEC. 3 ONLY

7. Photo Identification

Photo No. \_\_\_\_\_  
Ident. By: \_\_\_\_\_

8. Plane Coordinate Position Data

State \_\_\_\_\_ Zone \_\_\_\_\_  
X \_\_\_\_\_  
Y \_\_\_\_\_  
Estab. By \_\_\_\_\_  
Field Book No. \_\_\_\_\_  
Where Filed \_\_\_\_\_

9. Evaluation

Authentic \_\_\_\_\_  
Needs Verif. \_\_\_\_\_ Monument \_\_\_\_\_  
Re-estab. \_\_\_\_\_ Survey \_\_\_\_\_  
Land Status \_\_\_\_\_

3. Original Description \_\_\_\_\_ Vol. \_\_\_\_\_ Page \_\_\_\_\_ Where Recorded \_\_\_\_\_

4. Description of Corners: Corner consists of a stone in place. Good condition

Dimensions above ground 16x6x6".

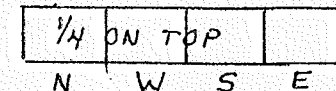

5. Investigation Notes:

Grown Over                      Grown Over

Species	D. Fir	D. Fir
Diameter	24"	20"
Bearing	S3°W	S41°E
Distance	15'	10'

Believed to be a genuine Land Office Corner. Metal Location Poster is on a D. Fir tree 24" diameter on the East side of tree (B.T.) from which this Corner bears N3°E, 24'. Section line marker between Secs. 3 and 34 is on a tree on the Brooks-Long Prairie Road located 790' E from 1/4 Corner.

6. Signed Van B. Embree Title \_\_\_\_\_

Date Aug. 22, 1956

1. T. 2S R. 10E No. A17 Cor. Sec Mer. WM State Oregon (Rectangular) N. F. Mt. Hood Dist. Hood River

2. Corner Status  
COMMON ONLY TO 2 & 3  
TIS RICE

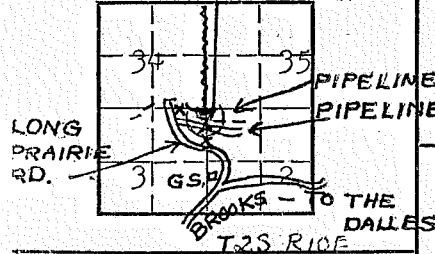

3. Original Description \_\_\_\_\_ Vol. \_\_\_\_\_ Page \_\_\_\_\_ Where Recorded \_\_\_\_\_

4. Description of Corners: Corner consists of a stone in place. Good condition. Dimensions above ground 10x6x5".

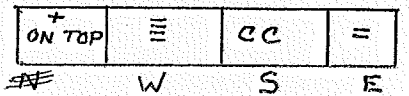

7. Photo Identification  
Photo No. \_\_\_\_\_  
Ident. By: \_\_\_\_\_

8. Plane Coordinate Position Data  
State \_\_\_\_\_ Zone \_\_\_\_\_  
X \_\_\_\_\_  
Y \_\_\_\_\_  
Estab. By \_\_\_\_\_  
Field Book No. \_\_\_\_\_  
Where Filed \_\_\_\_\_

9. Evaluation  
Authentic \_\_\_\_\_  
Needs Verif. \_\_\_\_\_ Monument \_\_\_\_\_  
Re-estab. \_\_\_\_\_ Survey \_\_\_\_\_  
Land Status \_\_\_\_\_

5. Investigation Notes:

	Grown Over	Grown Over
Species	White Pine	D. Fir
Diameter	20"	24"
Bearing	S50°W	S82°E
Distance	28'	23'

Believed to be a genuine Land Office Corner. Metal Location Poster is on a White Fir tree 5" diameter on the South side of tree from which this Corner bears South 4'. Section line marker between Secs. 3 and 34 is on a tree on the Long Prairie located 1880' W from Sec. Corner.

6. Signed Van B. Embree Title \_\_\_\_\_ Date Aug. 22, 1956

LAND CORNER RECORD

1. T2S R 10E No. A19 Cor.  $\frac{1}{4}$  Mer. WM State Oregon N. F. Mt. Hood Dist. Hood River  
(Rectangular)

2. Corner Status

THE DALLES - BRKS. MDW. RD.

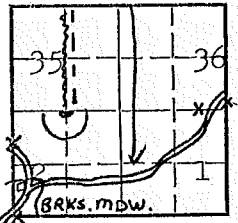

COMMON ONLY TO SEC. 2

7. Photo Identification

Photo No. \_\_\_\_\_

Ident. By: \_\_\_\_\_

8. Plane Coordinate Position Data

State \_\_\_\_\_ Zone \_\_\_\_\_

X \_\_\_\_\_

Y \_\_\_\_\_

Estab. By \_\_\_\_\_

Field Book No. \_\_\_\_\_

Where Filed \_\_\_\_\_

9. Evaluation

Authentic \_\_\_\_\_

Needs Verif. \_\_\_\_\_ Monument \_\_\_\_\_

Re-estab. \_\_\_\_\_ Survey \_\_\_\_\_

Land Status \_\_\_\_\_

3. Original Description \_\_\_\_\_ Vol. \_\_\_\_\_ Page \_\_\_\_\_ Where Recorded \_\_\_\_\_

4. Description of Corners: Corner consists of B.T.'s only. No corner found.

5. Investigation Notes:

	Grown Over	Grown Over
Species	W. Fir	D. Fir
Diameter	18"	36"
Bearing	?	?
Distance	?	?

Believed to be a genuine Land Office Corner. The B.T.'s are o.k. but I had no field notes to locate the corner from. Metal Location Poster is on a White Fir tree 18" diameter. This is a B.T. Probably marked on large basalt stone about 24" square.

6. Signed Van B. Embree Title \_\_\_\_\_ Date 1958

LAND CORNER RECORD

5680-2

1. T. 2S R. 10E No. A21 Cor. Sec Mer. WM State Oregon N. F. Mt. Hood Dist. Hood River

2. Corner Status  
COMMON TO L&2 T2S, R10E

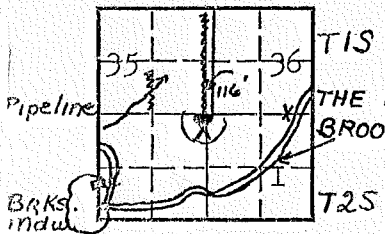

3. Original Description Vol. Page Where Recorded

4. Description of Corners: Corner consists of a stone in place. Good condition. Dimensions above ground 20x12x6".

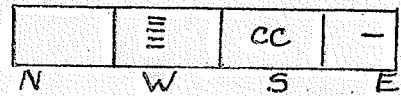

5. Investigation Notes:

	Grown Over	Grown Over
Species	W. Fir	Cedar
Diameter	16"	16"
Bearing	S20°E	S57°W
Distance	57'	23'
Believed to be a genuine Land Office Corner.		

7. Photo Identification  
Photo No. \_\_\_\_\_  
Ident. By: \_\_\_\_\_

8. Plane Coordinate Position Data  
State \_\_\_\_\_ Zone \_\_\_\_\_  
X \_\_\_\_\_  
Y \_\_\_\_\_  
Estab. By \_\_\_\_\_  
Field Book No. \_\_\_\_\_  
Where Filed \_\_\_\_\_

9. Evaluation  
Authentic \_\_\_\_\_  
Needs Verif. \_\_\_\_\_ Monument \_\_\_\_\_  
Re-estab. \_\_\_\_\_ Survey \_\_\_\_\_  
Land Status \_\_\_\_\_

6. Signed Van B. Embree Title \_\_\_\_\_ Date 1957

LAND CORNER RECORD

(Rectangular)  
Oregon

1. T 2S R 10E No. A23 Cor. 1/4 Mer. WM State \_\_\_\_\_ N. F. Mt. Hood Dist. Hood River

2. Corner Status

T1SR10E T1S,R11E

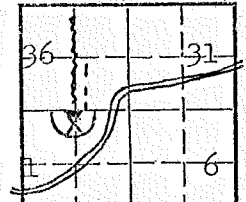

T2SR10E T2SR11E  
COMMON TO SEC 1

7. Photo Identification

Photo No. \_\_\_\_\_  
Ident. By: \_\_\_\_\_

8. Plane Coordinate Position Data

State \_\_\_\_\_ Zone \_\_\_\_\_  
X \_\_\_\_\_  
Y \_\_\_\_\_  
Estab. By \_\_\_\_\_  
Field Book No. \_\_\_\_\_  
Where Filed \_\_\_\_\_

9. Evaluation

Authentic \_\_\_\_\_  
Needs Verif. \_\_\_\_\_ Monument \_\_\_\_\_  
Re-estab. \_\_\_\_\_ Survey \_\_\_\_\_  
Land Status \_\_\_\_\_

3. Original Description \_\_\_\_\_ Vol. \_\_\_\_\_ Page \_\_\_\_\_ Where Recorded \_\_\_\_\_

4. Description of Corners: Corner consists of a stone in place. Good condition. Dimensions above ground 8x9x5".

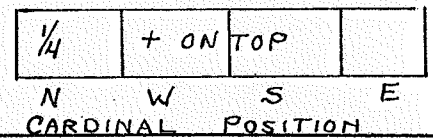

5. Investigation Notes:

	Grown Over	Grown Over	Grown Over
Species	W. Fir	Spruce	W. Fir
Diameter	10"	10"	8"
Bearing	S50°E	S49°W	S82°W
Distance	18'	15'	20'
Believed to be a genuine Land Office Corner.			

6. Signed Van B. Embree Title \_\_\_\_\_ Date 1957



LAND CORNER RECORD

C-17/OutsideA3

2S R 10E No. 217 Cor.  $\frac{1}{4}$  Mer. WM State Oregon (Rectangular) N. F. Mt. Hood Dist. Hood River

Corner Status \_\_\_\_\_

TO LONG PRAIRIE

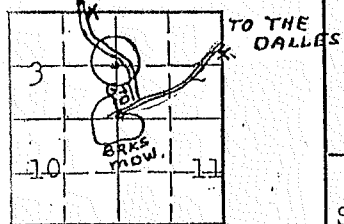

MON TO SECS. 2 & 3

Photo Identification \_\_\_\_\_

No. \_\_\_\_\_

By: \_\_\_\_\_

Plane Coordinate Position Data \_\_\_\_\_

Zone \_\_\_\_\_

By \_\_\_\_\_

Book No. \_\_\_\_\_

re Filed \_\_\_\_\_

valuation \_\_\_\_\_

entic \_\_\_\_\_

s Verif. \_\_\_\_\_ Monument \_\_\_\_\_

stab. \_\_\_\_\_ Survey \_\_\_\_\_

Status \_\_\_\_\_

3. Original Description \_\_\_\_\_ Vol. \_\_\_\_\_ Page \_\_\_\_\_ Where Recorded \_\_\_\_\_

4. Description of Corners: No corner found (1958)

5. Investigation Notes: Grown Over \_\_\_\_\_ Probably Down \_\_\_\_\_

Species	W. Fir	Fir	THESE DESCRIPTIONS
Diameter	12"	20"	ARE FROM U.S. LAND
Bearing	S7°E	S56°W	OFFICE FIELD NOTES.
Distance	26.4'	17.2'	

This B.T. is o.k. Corner probably under some logs. Metal Location Poster is on a W. Fir B.T. tree 12" diameter from which this Corner bears N7°W 26.4'. This corner was found several years ago and at that time was in place. Two trees have fallen over where this corner should be. No doubt it is under the trees.

6. Signed Van B. Embree Title \_\_\_\_\_ Date 1958

LAND CORNER RECORD

C-21/1102 G4

2S R. 10E No. 221 Cor.  $\frac{1}{4}$  Mer. WM State Oregon N. F. Mt. Hood Dist. Hood River

Corner Status

MON TO 1 & 2

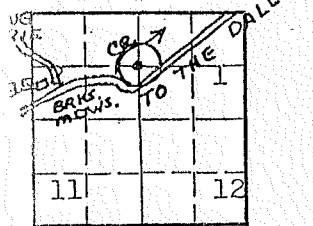

Photo Identification

No. \_\_\_\_\_

By: \_\_\_\_\_

Plane Coordinate Position Data

Zone \_\_\_\_\_

By \_\_\_\_\_

Book No. \_\_\_\_\_

File \_\_\_\_\_

Evaluation

entic \_\_\_\_\_

Is Verif. Monument

stab. Survey

Status \_\_\_\_\_

3. Original Description \_\_\_\_\_ Vol. \_\_\_\_\_ Page \_\_\_\_\_ Where Recorded \_\_\_\_\_

4. Description of Corners: No corner found.

5. Investigation Notes:

$\frac{1}{4}$	$\frac{1}{4}$
S 1	S 2
B.T.	B.T.

These B.T.'s are 5' apart

Species	Fir	Hemlock
Diameter	10"	12"
Bearing	NE	W
Distance	?	?

Believed to be a genuine Land Office Corner. B.T.'s o.k. and corner can be but a foot or so one way or the other. Metal Location Poster is on a Hemlock tree 8" diameter on the South side of tree.

6. Signed Van B. Embree Title \_\_\_\_\_

Date Aug. 21, 1956

USDA-FOREST SERVICE

Index

File No. D-3

CORNER RECORD (SEARCH)

(Ref. FSM 7151.4)

Tract or 148 HES

Cor. 8

Survey No. \_\_\_\_\_

No. #~~8~~-HES-148

T 2S R. 10E

R.D. Hood River County Hood River

\_\_\_\_\_

Merid. Willamette

N.F. Mt. Hood State \_\_\_\_\_

Oregon

CORNER DIAGRAM

Sec. 6

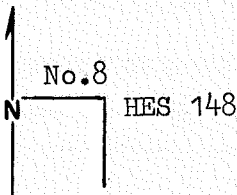

DESCRIBE CORNER MONUMENT FOUND

Stone 15"x14"x5", 12" in ground with 8 HES 148 chisled on West face no other marks on stone.

2

DESCRIBE BEARING TREES OR OTHER OFFICIAL ACCESSORIES FOUND

Unrecord now 16" Pine S46E-7.2 ft healed blaze.

3

PHOTO IDENTIFICATION DATA

Photo No. \_\_\_\_\_

Filed At. \_\_\_\_\_

Object Ident. \_\_\_\_\_

Ident. By \_\_\_\_\_

*Signature*

7

DESCRIBE CORNER LOCATION RELATIVE TO NEAR-BY FEATURES, ALSO HOW TO REACH CORNER

From Cooper Spur ski road junction at Cooper Spur Inn, follow Cooper Spur ski road to posted line follow posted line West 1600 feet, then follow posted line North 1/4 mile to corner.

PLANE COORDINATE POSITION DATA

State \_\_\_\_\_ Zone \_\_\_\_\_

X \_\_\_\_\_

Y \_\_\_\_\_

Estab. By \_\_\_\_\_

*Agency*

8

*Signature*  
*Loring D. Burkup*

Title  
Land Surveyor

Division \_\_\_\_\_

Headquarters \_\_\_\_\_

Date  
10/83

FS-7100-52 (3/68)

4

5

## CORNER RECORD (PERPETUATION)

MONUMENT: DESCRIBE NEW MONUMENT SET, OR WORK DONE TO PRESERVE EXISTING MONUMENT

Set 2½" x 30" Aluminum pipe with 3" Aluminum cap flush  
in ground. Buried stone in hole next to monument set.

Marked:

T2S R10E  
No. 8  
HES 148  
1983  
PLS 896

9

ACCESSORIES: DESCRIBE NEW BT'S WITNESS OBJECTS ETC. ESTABLISHED, OR WORK DONE TO PRESERVE EXISTING EVIDENCE

11" Pine S52W-8.1 ft. scribed X8HES148BT and with a 1" Brass disk stamped PLS 896.  
14" D-Fir N22E-14.5 ft. scribed X8HES148BT and with a 1" Brass disk stamped PLS 896.

10

Work Done By Larry D. Bishop Title Surveyor Date 10/83 State Registration No. 896  
or Agency

Certified Cor. Record Prepared? Yes No  Filed At: \_\_\_\_\_ Date \_\_\_\_\_

11

## REMARKS

Nailed 54-4 and BT signs to BT's and painted band and blazes red.  
Set guard posts North and South with decals 54-2 and survey marker.

12

Index File No. T.2S R. 10E M. Tract or Surv. No. Cor. #8-HES 148

USDA-FOREST SERVICE

Index

File No. D-3

**CORNER RECORD (SEARCH)**

(Ref. FSM 7151.4)

Tract or 148 & 149

Survey No. \_\_\_\_\_

Cor. 1 & 6

No. ~~#6-HES-149~~

T 2S R. 10E

R.D. Hood River County Hood River

Merid. Willamette

N.F. Mt. Hood State Oregon

**CORNER DIAGRAM**

Sec. 6

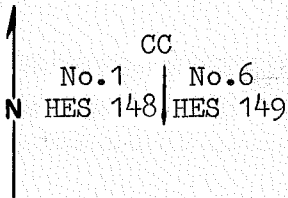

**DESCRIBE CORNER MONUMENT FOUND**

15"x9"x8" stone, 12" in ground, marked 6 HES 149 on East face.  
1 HES 148 on West face.

2

**DESCRIBE BEARING TREES OR OTHER OFFICIAL ACCESSORIES FOUND**

6

**PHOTO IDENTIFICATION DATA**

Photo No. \_\_\_\_\_

Filed At. \_\_\_\_\_

Object Ident. \_\_\_\_\_

Ident. By \_\_\_\_\_

*Signature*

7

**PLANE COORDINATE POSITION DATA**

State \_\_\_\_\_ Zone \_\_\_\_\_

X \_\_\_\_\_

Y \_\_\_\_\_

Estab. By \_\_\_\_\_

*Agency*

8

**DESCRIBE CORNER LOCATION RELATIVE TO NEAR-BY FEATURES, ALSO HOW TO REACH CORNER**

From Cooper Spur ski road junction at Cooper Spur Inn, follow Cooper Spur ski road to posted line follow posted line West 1600 feet, then go North 55 feet to corner.

3

*Signature*  
*James D. Pennington*

Title  
Land Surveyor

Division

Headquarters

Date  
10/83

FS-7100-52 (3/68)

4

5

**CORNER RECORD (PERPETUATION)**

MONUMENT: DESCRIBE NEW MONUMENT SET, OR WORK DONE TO PRESERVE EXISTING MONUMENT Marked:

Set 2½" x 30" Aluminum pipe with a 3" Aluminum cap flush in ground.  
buried stone in hole.

T2S R10E  
CC  
No.1 No.6  
HES 148 HES 149  
1983  
PLS 896

ACCESSORIES : DESCRIBE NEW BT'S WITNESS OBJECTS ETC. ESTABLISHED, OR WORK DONE TO PRESERVE EXISTING EVIDENCE 9

18" Wh.Fir S69W-5.4 ft. scribed X1HES148CCBT and with a 1" Brass disk stamped PLS 896.  
12" Pine S50E-11.1 ft. scribed X6HES149CCBT and with a 1" Brass disk stamped PLS 896.

Work Done By Larry D. Bishop Title Surveyor Date 10/83 State Registration No. 896 or Agency 10  
Certified Cor. Record Prepared ? Yes No  Filed At: \_\_\_\_\_ Date 11

**REMARKS**

Nailed 54-4 and BT signs to BT's and painted bands and blazes red.  
Set guard post North with decals 54-2 and survey marker.

Index File No. T.2S R10E M. Tract or Surv. No. #6 Cor. HES 149 12  
13

USDA-FOREST SERVICE

Index

File No.

D-3

CORNER RECORD (SEARCH)

(Ref. FSM 7151.4)

Tract or

148 & 149

Survey No.

Cor.

285

No.

#5 HES 149

T

2S

R.

10E

R.D.

Hood River

County

Hood River

Merid.

Willamette

N.F. Mt.

Hood

State

Oregon

CORNER DIAGRAM

Sec.6

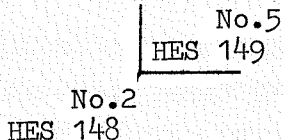

DESCRIBE CORNER MONUMENT FOUND

13"x17"x2" stone, 13" in ground, chisled 2 HES 148 on West face.

DESCRIBE BEARING TREES OR OTHER OFFICIAL ACCESSORIES FOUND

Unrecorded now 20" burnt stump N18E-19.3 ft. scribing visible.

PHOTO IDENTIFICATION DATA

Photo No.

Filed At.

Object Ident.

Ident. By

Signature

PLANE COORDINATE POSITION DATA

State

Zone

X

Y

Estab. By

Agency

Signature: Larry D. ...

Title: Land Surveyor

Division

Headquarters

Date: 10/83

FS-7100-52 (3/68)

**CORNER RECORD (PERPETUATION)**

**MONUMENT: DESCRIBE NEW MONUMENT SET, OR WORK DONE TO PRESERVE EXISTING MONUMENT**

Set 2½"x30" Aluminum pipe with a 3" Aluminum cap flush  
in ground buried stone in hole.

T2S R10E  
No.5  
HES 149

No.2  
HES 148 1983  
PLS 896

9

**ACCESSORIES : DESCRIBE NEW BT'S WITNESS OBJECTS ETC. ESTABLISHED, OR WORK DONE TO PRESERVE EXISTING EVIDENCE**

15" Wh.Fir S39W-10.2 ft. scribed X2HES148BT and with a 1" Brass disk stamped PLS 896.  
10" Wh.Fir N18E-12.9 ft. scribed X5HES149BT and with a 1" Brass disk stamped PLS 896.

10

Work Done By Larry D. Bishop Title Surveyor Date 10/83 State Registration No. or Agency 896

Certified Cor. Record Prepared ? Yes No  Filed At: \_\_\_\_\_ Date \_\_\_\_\_ 11

**REMARKS**

Nailed 54-4 and BT signs to BT's and painted band and blazes red.  
Set guard posts North and East with boundary and survey marker decals.

12

Index File No. T. 2S R. 10E M. Tract or Surv. No.

Cor. #5-HES 149 13



USDA-FOREST SERVICE

Index

File No. D-4

CORNER RECORD (SEARCH)

(Ref. FSM 7151.4)

Tract or 148-151

Survey No. \_\_\_\_\_

<sup>3&4</sup>  
Cor. # 4-HES 151  
No. \_\_\_\_\_

T 2S R. 10E

R.D. Hood River

County Hood River

Merid. Willamette

N.F. Mt. Hood

State Oregon

CORNER DIAGRAM Sec.6

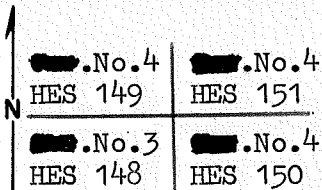

DESCRIBE CORNER MONUMENT FOUND

Stone 40x24x12 marked as corner to HES 148-150-151-149.

Stone donated to Hood River Historical Society.

2

DESCRIBE BEARING TREES OR OTHER OFFICIAL ACCESSORIES FOUND

3

PHOTO IDENTIFICATION DATA

Photo No. \_\_\_\_\_

Filed At. \_\_\_\_\_

Object Ident. \_\_\_\_\_

Ident. By \_\_\_\_\_

*Signature*

7

PLANE COORDINATE POSITION DATA

State \_\_\_\_\_ Zone \_\_\_\_\_

X \_\_\_\_\_

Y \_\_\_\_\_

Estab. By \_\_\_\_\_

*Agency*

8

DESCRIBE CORNER LOCATION RELATIVE TO NEAR-BY FEATURES, ALSO HOW TO REACH CORNER

Corner is located between the two lanes of the switchback of road to Cooper Spur ski area approx. 1/2 mile from old Hwy. 35.

4

Signature

*Larry D. Beckwith*

Title

Land Surveyor

Division

Headquarters

Date

10/83 FS-7100-52 (3/68)

5

**CORNER RECORD (PERPETUATION)**

**MONUMENT: DESCRIBE NEW MONUMENT SET, OR WORK DONE TO PRESERVE EXISTING MONUMENT**

Set 2 1/2" x 30" Aluminum pipe with a 3" Aluminum disk.

Stamped:

T2S	R10E-
.No.4	.No.4
HES 149	HES 151
.No.3	.No.4
HES 148	HES 150

1983

9

**ACCESSORIES : DESCRIBE NEW BT'S WITNESS OBJECTS ETC. ESTABLISHED, OR WORK DONE TO PRESERVE EXIS PLS 896.CE**

5" Cedar N15W-10.3 ft. scribed X<sup>4</sup>HES149BT and with a 1" Brass disk stamped PLS 896.  
 12" Wh.Fir N9E-15.9 ft. scribed X<sup>4</sup>HES151BT and with a 1" Brass disk stamped PLS 896.  
 18" P.Pine S66E-47.9 ft. scribed X<sup>4</sup>HES150BT and with a 1" Brass disk stamped PLS 896.  
 16" Wh.Fir S80W-12.1 ft. scribed X<sup>3</sup>HES148BT and with a 1" Brass disk stamped PLS 896.

10

Work Done By: Larry D. Bishop Title Surveyor Date 10/83 State Registration No. 896  
 or Agency \_\_\_\_\_  
 Certified Cor. Record Prepared ? Yes No  Filed At: \_\_\_\_\_ Date: \_\_\_\_\_

11

**REMARKS**

Set guard posts East and West with decals 54-2 and "survey marker".  
 Nailed 54-4 and BT signs to BT's and painted band and blazes red.

12

Index File No. T.2S R. 10E M. Tract or Surv. No. Cor #4-HES-151

USDA-FOREST SERVICE

Index

File No. D-5

CORNER RECORD (SEARCH)

(Ref. FSM 7151.4)

Tract or 147&152

Cor. 288

Survey No. \_\_\_\_\_

No. #~~2~~-HES 152

T 2S R. 10E

R.D. Hood River County Hood River

Merid. Willamette

N.F. Mt. Hood State Oregon

CORNER DIAGRAM Sec.6



No.8  
HES 147  
No.2  
HES 152

DESCRIBE CORNER MONUMENT FOUND

Stone with X 12"x17"x4", 12" in ground. Marked 8 HES 147 on North face, HES 152 on South face.

2

DESCRIBE BEARING TREES OR OTHER OFFICIAL ACCESSORIES FOUND

6

PHOTO IDENTIFICATION DATA

Photo No. \_\_\_\_\_

Filed At. \_\_\_\_\_

Object Ident. \_\_\_\_\_

Ident. By \_\_\_\_\_

*Signature*

7

PLANE COORDINATE POSITION DATA

State \_\_\_\_\_ Zone \_\_\_\_\_

X \_\_\_\_\_

Y \_\_\_\_\_

Estab. By \_\_\_\_\_

*Agency*

8

DESCRIBE CORNER LOCATION RELATIVE TO NEAR-BY FEATURES, ALSO HOW TO REACH CORNER

From Cooper Spur road junction at Cooper Spur Inn follow Cooper Spur ski road to posted line. Follow posted line East 900 ft. and North 1/4 mile to corner.

3

Signature

*Larry D. [Signature]*

Title  
Land Surveyor

Division

Headquarters

Date  
10/83

FS-7100-52 (3/68)

4

5

**CORNER RECORD (PERPETUATION)**

**MONUMENT : DESCRIBE NEW MONUMENT SET, OR WORK DONE TO PRESERVE EXISTING MONUMENT**

Set 2½" x 30" Aluminum pipe with a 3" Aluminum cap flush with ground. Buried stone in hole.

Marked:

T2S	R10E
	No.8
	HES 147
	No.2
	HES 152

1983

9

**ACCESSORIES : DESCRIBE NEW BT'S WITNESS OBJECTS ETC. ESTABLISHED, OR WORK DONE TO PRESERVE** PLS 896 **IDENTENCE**

22" Wh.Fir N47E-14.0 ft. scribed X8HES147BT and with a 1" Brass disk stamped PLS 896.  
 10" Wh.Fir S22E-4.7 ft. scribed X2HES152BT and with a 1" Brass disk stamped PLS 896.

10

Work Done By Larry D. Bishop Title Surveyor Date 10/83 State Registration No. 896  
 or Agency \_\_\_\_\_

Certified Cor. Record Prepared ? Yes No  Filed At: \_\_\_\_\_ Date \_\_\_\_\_

11

**REMARKS**

Nailed 54-4 and BT signs to BT's and painted band and blazes red.  
 Guard posts North and South with boundary and survey marker decals.

12

Index File No. T. 2S R. 10E M. Tract or Surv. No. Cor. #2-HES 152

13

USDA-FOREST SERVICE

Index

File No. D-5

**CORNER RECORD (SEARCH)**

(Ref. FSM 7151.4)

Tract or 150, 151, 152  
Survey No. \_\_\_\_\_  
Cor. - 3, 3, 11  
No. # 3-HES 151

T 2S R. 10E

R.D. Hood River County Hood River

Merid. Willamette

N.F. Mt. Hood State Oregon

CORNER DIAGRAM Sec.6

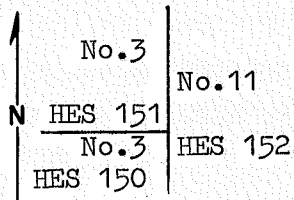

**DESCRIBE CORNER MONUMENT FOUND**

Stone 18"x11"x5", 9" in ground, HES 151 & HES 152 markings readable.

**DESCRIBE BEARING TREES OR OTHER OFFICIAL ACCESSORIES FOUND**

**PHOTO IDENTIFICATION DATA**

Photo No. \_\_\_\_\_

Filed At. \_\_\_\_\_

Object Ident. \_\_\_\_\_

Ident. By \_\_\_\_\_

*Signature*

**PLANE COORDINATE POSITION DATA**

State \_\_\_\_\_ Zone \_\_\_\_\_

X \_\_\_\_\_

Y \_\_\_\_\_

Estab. By \_\_\_\_\_

*Agency*

**DESCRIBE CORNER LOCATION RELATIVE TO NEAR-BY FEATURES, ALSO HOW TO REACH CORNER**

From Cooper Spur road junction at Cooper Spur Inn follow Cooper Spur ski road to posted line follow posted line East 900 feet to corner.

*Larry J. Bishop*  
Signature

Title \_\_\_\_\_ Division \_\_\_\_\_

Headquarters \_\_\_\_\_

Date 10/83

FS-7100-52 (3/68)

**CORNER RECORD (PERPETUATION)**

MONUMENT: DESCRIBE NEW MONUMENT SET, OR WORK DONE TO PRESERVE EXISTING MONUMENT

Set 2 1/2"x30" Aluminum pipe with a 3" Aluminum cap flush with ground. Buried stone in hole.

Marked:

-T2S	R10E
No.3	-
HES 151	No.11
	HES 152
No.3	
Hes 150	

ACCESSORIES : DESCRIBE NEW BT'S WITNESS OBJECTS ETC. ESTABLISHED, OR WORK DONE TO PRESERVE EXISTING

10" D-Fir N34W-112.6 ft. scribed X3HES151BT and with a 1" Brass disk stamped PLS 896.  
 8" D-Fir S75W-55.1 ft. scribed X3HES150BT and with a 1" Brass disk stamped PLS 896.  
 18" Pine N76E-19.7 ft. scribed X11HES152BT and with a 1" Brass disk stamped PLS 896.

1983  
 PLS 896

10

Work Done By Larry D. Bishop Title Surveyor Date 10/83 State Registration No. or Agency 896

Certified Cor. Record Prepared ? Yes No  Filed At: \_\_\_\_\_ Date \_\_\_\_\_ 11

**REMARKS**

Nailed 54-4 and BT signs to BT's.  
 Painted bands and blazes red.  
 Set guard post North and West with both boundary and survey marker decals.

12

Index File No. T.2S R. 10E M. Tract or Surv. No. Cor. #3-HES 151 13

USDA-FOREST SERVICE

Index  
File No. D-5

**CORNER RECORD (SEARCH)**  
(Ref. FSM 7151.4)

Tract or 151 & 152 Cor. 281  
Survey No. \_\_\_\_\_ No. #2-HES-151

T 2S R. 10E R.D. Hood River County Hood River

Merid. Willamette N.F. Mt. Hood State Oregon

CORNER DIAGRAM  
Sec. 6

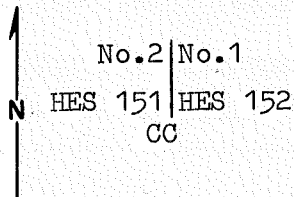

DESCRIBE CORNER MONUMENT FOUND  
Stone 16"x11"x5", 8" in ground, HES 151 on West face.

DESCRIBE BEARING TREES OR OTHER OFFICIAL ACCESSORIES FOUND

PHOTO IDENTIFICATION DATA

Photo No. \_\_\_\_\_  
Filed At. \_\_\_\_\_  
Object Ident. \_\_\_\_\_  
Ident. By \_\_\_\_\_  
*Signature*

DESCRIBE CORNER LOCATION RELATIVE TO NEAR-BY FEATURES, ALSO HOW TO REACH CORNER  
From Cooper Spur road junction at Cooper Spur Inn follow Cooper Spur ski road to posted line follow posted line East 900 feet then go North 65 feet to corner.

PLANE COORDINATE POSITION DATA

State \_\_\_\_\_ Zone \_\_\_\_\_  
X \_\_\_\_\_  
Y \_\_\_\_\_  
Estab. By \_\_\_\_\_  
*Agency*

*Signature*  
*Louise De Bruijn*

Title \_\_\_\_\_ Division \_\_\_\_\_ Headquarters \_\_\_\_\_ Date 10/83 FS-7100-52 (3/68)

**CORNER RECORD (PERPETUATION)**

**MONUMENT : DESCRIBE NEW MONUMENT SET, OR WORK DONE TO PRESERVE EXISTING MONUMENT**

Set 2½" x 30" Aluminum pipe with a 3" Aluminum cap flush with ground.  
Buried stone in hole.

Marked: T2S R10E  
No.2 No.1  
HES 151 HES 152  
CC  
1983  
PLS 896

9

**ACCESSORIES : DESCRIBE NEW BT'S WITNESS OBJECTS ETC. ESTABLISHED, OR WORK DONE TO PRESERVE EXISTING EVIDENCE**

10" D-Fir N44W-30.8 ft. scribed X2HES151BT and with a 1" Brass disk stamped PLS 896.  
13" D-Fir N48E-18.3 ft. scribed X1HES152BT and with a 1" Brass disk stamped PLS 896.

10

Work Done By Larry D. Bishop Title Surveyor Date 10/83 State Registration No. 896  
or Agency

Certified Cor. Record Prepared ? Yes No  Filed At: \_\_\_\_\_ Date \_\_\_\_\_ 11

**REMARKS**

Set guard post South with decals 54-2 and survey marker.  
Nailed 54-4 and BT signs to BT's and painted band and blazes red.

12

Index File No. T.2S R. 10E M. Tract or Surv. No. Cor #2-HES 151



LAND CORNER RECORD

5680-2

1. T. 2S R. 10E No. D-6 1/2 Cor. HES Mer. Wm. State Oregon (Rectangular) N. F. Mt. Hood Dist. Hood River

2. Corner Status

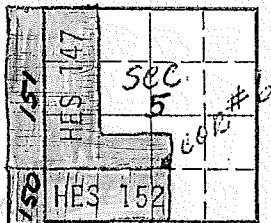

3. Original Description \_\_\_\_\_ Vol. \_\_\_\_\_ Page \_\_\_\_\_ Where Recorded \_\_\_\_\_

4. Description of Corners:  
 Approx HES Corner - HES Sec. No. 152, Corner No.6. Consists of 2" x 2" x 4' Post, Painted red.

5. Investigation Notes:  
 Douglas Fir 10" with red painted "X" bears N50°W at 12'.  
 Western Larch 12" with red painted "x" bears S40°E at 15'.

7. Photo Identification  
 Photo No. \_\_\_\_\_  
 Ident. By: \_\_\_\_\_

8. Plane Coordinate Position Data  
 State \_\_\_\_\_ Zone \_\_\_\_\_  
 X \_\_\_\_\_  
 Y \_\_\_\_\_  
 Estab. By \_\_\_\_\_  
 Field Book No. \_\_\_\_\_  
 Where Filed \_\_\_\_\_

9. Evaluation  
 Authentic NIO GR  
 Needs Verif. \_\_\_\_\_ Monument \_\_\_\_\_  
 Re-estab. \_\_\_\_\_ Survey \_\_\_\_\_  
 Land Status \_\_\_\_\_

Corner was established by Larry Rector & Jim McCullough by hand compass and chaining for cruising on 10/20/76

75

6. Signed Larry Rector Title Forestry Techn Date 10/20/76  
Jim McCullough

1. T 2S R 10E N. ~~D-21/2~~ Cor. HES Mer. State Oregon (Rectangular) N.F. Mt. Hood Dist. Hood River

2. Corner Status *E-6 1/2*

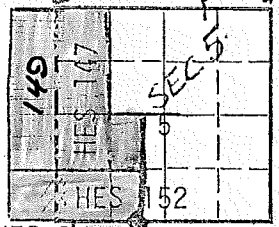

HES 1531 ← Cor No. 1

7. Photo Identification  
Photo No. \_\_\_\_\_  
Ident. By: \_\_\_\_\_

8. Plane Coordinate Position Data  
State \_\_\_\_\_ Zone \_\_\_\_\_  
X \_\_\_\_\_  
Y \_\_\_\_\_  
Estab. By \_\_\_\_\_  
Field Book No. \_\_\_\_\_  
Where Filed \_\_\_\_\_

9. Evaluation  
Authentic *NO* *91R*  
Needs Verif. \_\_\_\_\_ Monument \_\_\_\_\_  
Re-estab. \_\_\_\_\_ Survey \_\_\_\_\_  
Land Status \_\_\_\_\_

3. Original Description \_\_\_\_\_ Vol. \_\_\_\_\_ Page \_\_\_\_\_ Where Recorded \_\_\_\_\_

4. Description of Corners:  
Approx HES Corner - HES Sec. No. 153, Corner No. 1.  
Consists of 1" x 1" x 4' Post painted red on edge of timber and brush.

5. Investigation Notes:  
Witness Tree: 24" DBH Grand Fir bears N20°E at 20'.

Corner can be reached by old Pollalie Creek Campground and follow red ribbon line.

Corner was established by Larry Rector and Jim McCullough by hand compass and chaining for cruising on 10/20/76.

*75*

6. Signed Larry Rector Title Forestry Techs Date 10/20/76  
Jim McCullough

1. T. 25 R. 10E No. 51 Cor. Sec Mer. 4M State Oregon (Rectangular) N. F. Mt Hood Dist. Hood River

2. Corner Status

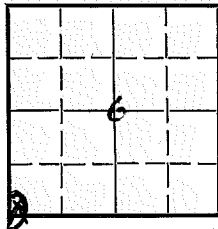

7. Photo Identification

Photo No. \_\_\_\_\_

Ident. By: \_\_\_\_\_

8. Plane Coordinate Position Data

State \_\_\_\_\_ Zone \_\_\_\_\_

X \_\_\_\_\_

Y \_\_\_\_\_

Estab. By \_\_\_\_\_

Field Book No. \_\_\_\_\_

Where Filed \_\_\_\_\_

9. Evaluation

Authentic  \_\_\_\_\_

Needs Verif.  Monument  \_\_\_\_\_

Re-estab.  Survey  \_\_\_\_\_

Land Status \_\_\_\_\_

3. Original Description \_\_\_\_\_ Vol. \_\_\_\_\_ Page \_\_\_\_\_ Where Recorded B/M

4. Description of Corners: Native Rock 8" above ground.  
East side marked E south marked +  
Good Condition BT, Fir, 30" dia, N15E, 30' (closed).

5. Investigation Notes:



6. Signed Barry B. Barbour Title Civ Eng Tech Date 9-25-62

# PERPETUATION RECORD

10. Monument:

11. Accessories

Field Book \_\_\_\_\_ Page \_\_\_\_\_

12. Set By \_\_\_\_\_ Title \_\_\_\_\_  
License \_\_\_\_\_ Agency \_\_\_\_\_ Date \_\_\_\_\_

13. Recorded By \_\_\_\_\_ Volume \_\_\_\_\_ Page \_\_\_\_\_  
(Agency)  
(Date) (City) (County) (State)

14. Remarks:

LAND CORNER RECORD  
(Rectangular)

1. T. 2S R. 10E No. E-5 Cor. Sec. Mer. State Oregon N. F. Mt. Hood Dist. Hood River

2. Corner Status \_\_\_\_\_

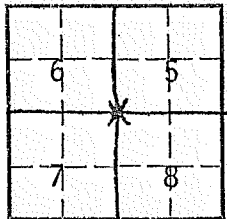

7. Photo Identification  
Photo No. \_\_\_\_\_  
Ident. By: \_\_\_\_\_

8. Plane Coordinate Position Data  
State \_\_\_\_\_ Zone \_\_\_\_\_  
X \_\_\_\_\_  
Y \_\_\_\_\_  
Estab. By \_\_\_\_\_  
Field Book No. \_\_\_\_\_  
Where Filed \_\_\_\_\_

9. Evaluation  
Authentic \_\_\_\_\_  
Needs Verif.  Monument \_\_\_\_\_  
Re-estab. \_\_\_\_\_ Survey \_\_\_\_\_  
Land Status \_\_\_\_\_

3. Original Description \_\_\_\_\_ Vol. \_\_\_\_\_ Page \_\_\_\_\_ Where Recorded \_\_\_\_\_

4. Description of Corners:  
HES Corner Stone *W. H. J. II*

5. Investigation Notes:  
Did not find actual section corner, found HES corner approx 20' from where section corner should be located. Corner is located 1200' n. of S230.

*7R & 7D*

6. Signed L. Rector Title Frstry Tech. Date 9/15/76  
F. Menard

(Rectangular)

1. T 25 R 10E No. 59 Cor. Sec Mer 10W State Oregon N. F. Mt Hood Dist. Hood River

2. Corner Status

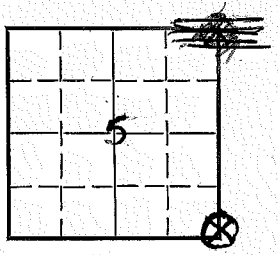

7. Photo Identification

Photo No. \_\_\_\_\_  
Ident. By: \_\_\_\_\_

8. Plane Coordinate Position Data

State \_\_\_\_\_ Zone \_\_\_\_\_  
X \_\_\_\_\_  
Y \_\_\_\_\_  
Estab. By \_\_\_\_\_  
Field Book No. \_\_\_\_\_  
Where Filed \_\_\_\_\_

9. Evaluation

Authentic X  
Needs Verif. \_\_\_\_\_ Monument \_\_\_\_\_  
Re-estab. \_\_\_\_\_ Survey \_\_\_\_\_  
Land Status \_\_\_\_\_

3. Original Description \_\_\_\_\_ Vol. \_\_\_\_\_ Page \_\_\_\_\_ Where Recorded BIM

4. Description of Corners: Common to 4, 5, 8 & 9. Native Rock only top showing, BTs, P. Pine, 40" dia, 576°E, 28.4'; P Pine 42', 516W, 39.2'. Faces open.

5. Investigation Notes:

Scribing visible T&S T&S  
R 10E R 10E  
59 8

Corner 10<sup>2</sup> Ch. East of Trail to Lookout Ridge  
Poster on snag 30" dia East of trail  
Corner found 80' below Ridge top.

6. Signed Barry B Barber Title Civ Eng Tech Date 9-19-62

# PERPETUATION RECORD

10. Monument:

11. Accessories

Field Book \_\_\_\_\_ Page \_\_\_\_\_

12. Set By \_\_\_\_\_ Title \_\_\_\_\_  
License \_\_\_\_\_ Agency \_\_\_\_\_ Date \_\_\_\_\_

13. Recorded By \_\_\_\_\_ Volume \_\_\_\_\_ Page \_\_\_\_\_  
(Agency)  
(Date) (City) (County) (State)

14. Remarks:

LAND CORNER RECORD

E-17/1103 B2

RS RIDE No. E17 Cor. SEC Mer. Will State OREGON (Rectangular) N. F. MT. HOOD Dist. HOOD RIVER

Corner Status \_\_\_\_\_

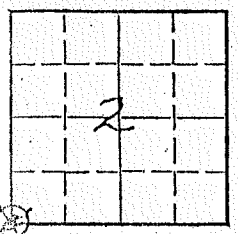

Photo Identification \_\_\_\_\_

No. \_\_\_\_\_

By: \_\_\_\_\_

Plane Coordinate Position Data \_\_\_\_\_

Zone \_\_\_\_\_

By \_\_\_\_\_

Book No. \_\_\_\_\_

re Filed \_\_\_\_\_

Evaluation \_\_\_\_\_

entire \_\_\_\_\_

is Verif. \_\_\_\_\_ Monument \_\_\_\_\_

stab. \_\_\_\_\_ Survey \_\_\_\_\_

Status \_\_\_\_\_

3. Original Description \_\_\_\_\_ Vol. \_\_\_\_\_ Page \_\_\_\_\_ Where Recorded \_\_\_\_\_

4. Description of Corners:

SET BASALT STONE 15" X 10" X 8" SET 10" IN GROUND  
 SPRUCE 20" DIA. S 11° E 188 LINKS  
 " 12" " S 1° 30' W 208 "

5. Investigation Notes:

BASALT STONE COULD NOT BE FOUND, IRON PIPE  
 ESTABLISHED AS SEC. COR. SET FROM BEARING  
 TREES. GOOD COR.

6. Signed C. V. NORMAN Title \_\_\_\_\_ Date 12/9/61



# LAND CORNER RECORD

5680-2

2S R 10E No. E17 Cor. Sec Mer. WM State Oregon N. F. Mt. Hood Dist Hood River

Corner Status  
ONG  
IRIE

THE  
DALLE-  
BROS. RD.

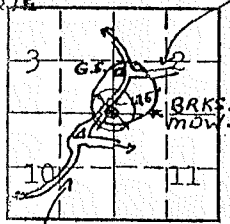

TLE PRAIRIE RD.

Photo Identification

No. \_\_\_\_\_

By: \_\_\_\_\_

Name Coordinate Position Data

Zone \_\_\_\_\_

By \_\_\_\_\_

Book No. \_\_\_\_\_

re Filed \_\_\_\_\_

valuation

antic

s Verif. Monument \_\_\_\_\_

stab. Survey \_\_\_\_\_

Status \_\_\_\_\_

3. Original Description \_\_\_\_\_ Vol. \_\_\_\_\_ Page \_\_\_\_\_ Where Recorded \_\_\_\_\_

4. Description of Corners: Corner consists of a rock, 2" iron pipe for marker in place. Good condition. Dimensions above ground 8x10x4".

+ ON	TOP		-
N	W	S	E

COMMON TO 2,3,10 & 11

5. Investigation Notes: Two pits are located SE and SW 5'.

(Other  
scribing  
grown over)

10		T2S
10	S11	R11E
		S2
B.T.		B.T.

Species	Spruce	Spruce	Larch (snag)
Diameter	20"	24"	30"
Bearing	S1°30'W	S11°E	N80°E
Distance	137'	124'	1120'

Believed to be a genuine Land Office Corner. Metal Location Poster is on a small post ~~tree~~ 3" diameter, on the South side of The Dalles-Brooks Mdw. Rd. from which this corner bears South 125'.

6. Signed Van B. Embree Title

Date 1956

Index  
File No. E 19  
T. 2 S R. 10 E  
Merid. Willamette

**CORNER RECORD (SEARCH)**  
(Ref. FSM 7151.4)

Tract or  
Survey No. \_\_\_\_\_  
Cor.  
No. \_\_\_\_\_

R.D. Barlow County Hood River  
N.F. Mt. Hood State Oregon

**CORNER DIAGRAM**

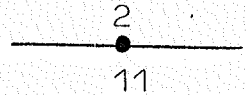

**DESCRIBE CORNER MONUMENT FOUND**  
Rock- 12 x 2 1/2" - 6" above ground in good condition=  
Marked with X on top & 1/4 on North face.

**DESCRIBE BEARING TREES OR OTHER OFFICIAL ACCESSORIES FOUND**  
S 11 BT- 36" GF- 246°30" - 3ft6"  
S 2 BT- 14" GF-broken snag- 85°45' - 16ft6".

**PHOTO IDENTIFICATION DATA**  
Photo No. \_\_\_\_\_  
Filed At. \_\_\_\_\_  
Object Ident. \_\_\_\_\_  
Ident. By \_\_\_\_\_  
*Signature*

**DESCRIBE CORNER LOCATION RELATIVE TO NEAR-BY FEATURES, ALSO HOW TO REACH CORNER**

**LANE COORDINATE POSITION DATA**  
State \_\_\_\_\_ Zone \_\_\_\_\_  
Established By \_\_\_\_\_  
*Agency*

Signature Keith D. Fagerberg Title Forester Division Planning Headquarters Barlow Date 9-14-76 7100-52 (3/68)

Index file No. E 21

CORNER RECORD (SEARCH)  
(Ref. FSM 7151.4)

Tract or Survey No. \_\_\_\_\_  
Cor. No. \_\_\_\_\_

2 S R. 10 E R.D. Barlow County Hood River  
Merid. Willamette N.F. Mt. Hood State Oregon

CORNER DIAGRAM

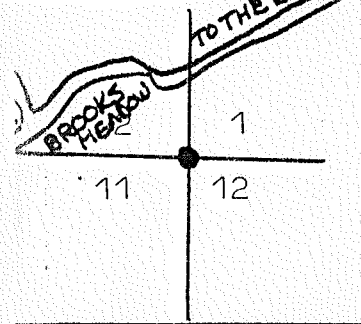

DESCRIBE CORNER MONUMENT FOUND

Rock- 11 x 6"- 4" above ground- in good condition but loose- Marked with X on top and 5 slashes on South face.

2

DESCRIBE BEARING TREES OR OTHER OFFICIAL ACCESSORIES FOUND

S 11 BT- 24" GF snag 230°15'- 10'dis.  
(S 50°E)

Note: 1-29-70 notes read this BT has scribing visible; Also have a BT- 24" GF blow down, bears N80W- 6 ft.

3

PHOTO IDENTIFICATION DATA

photo No. \_\_\_\_\_  
filed At. \_\_\_\_\_  
subject Ident. \_\_\_\_\_  
sent. By \_\_\_\_\_  
Signature \_\_\_\_\_

7

DESCRIBE CORNER LOCATION RELATIVE TO NEAR-BY FEATURES, ALSO HOW TO REACH CORNER

Near Brooks Meadow- South of Road S-162

PLANE COORDINATE POSITION DATA

date \_\_\_\_\_ Zone \_\_\_\_\_  
\_\_\_\_\_   
\_\_\_\_\_   
stab. By \_\_\_\_\_  
Agency \_\_\_\_\_

8

Note: 9/12/62 notes have Loc.tag on nearby tree with good blazed line from road to corner.

4

Signature <i>Frank Jagerberg</i>	Title Forester	Division Planning	Headquarters Barlow	Date 9-11-76	7100-52 (3/68)
-------------------------------------	-------------------	----------------------	------------------------	-----------------	----------------

5

1. T2S R10E No. F-2 Property (Rectangular) Mer. Wm. State Oregon N. F. Mt. Hood Dist. Hood River

2. Corner Status

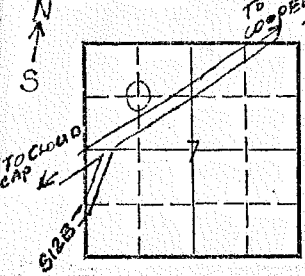

7. Photo Identification

Photo No. \_\_\_\_\_  
Ident. By: \_\_\_\_\_

8. Plane Coordinate Position Data

State \_\_\_\_\_ Zone \_\_\_\_\_  
X \_\_\_\_\_  
Y \_\_\_\_\_  
Etab. By \_\_\_\_\_  
Field Book No. \_\_\_\_\_  
Where Filed \_\_\_\_\_

9. Evaluation

Authentic \_\_\_\_\_  
Needs Verif. \_\_\_\_\_ Monument \_\_\_\_\_  
Re-estab. \_\_\_\_\_ Survey \_\_\_\_\_  
Land Status \_\_\_\_\_

3. Original Description \_\_\_\_\_ Vol. \_\_\_\_\_ Page \_\_\_\_\_ Where Recorded \_\_\_\_\_

4. Description of Corners:

No actual corner monument located.  
Believe to be private survey for property line.

5. Investigation Notes:

Location poster on line is on a 8"DBH Lodgepole Pine.  
Corner located on N. side of S-12 near cooper spur.  
Property corner of Mt. Hood National Forest and Hood River County.

7Q

6. Signed F. Menard Title Forestry Techs Date 9/15/76  
L. Rector

LAND CORNER RECORD

G-13/Outside A1

T. 25 S. R. 10 E. No. G13 Cor.  $\frac{1}{4}$  Mer. WM State Oregon N. F. Mt. Hood Dist. Hood River

Corner Status \_\_\_\_\_

TRAIL DOG RIVER  
COOKS MEADOW

NEAR SPRING

GN TO 9 & 10

Photo Identification

No. \_\_\_\_\_

By: \_\_\_\_\_

Plane Coordinate Position Data

Zone \_\_\_\_\_

By \_\_\_\_\_

Book No. \_\_\_\_\_

Filed \_\_\_\_\_

Evaluation

entic \_\_\_\_\_

Is Verif. \_\_\_\_\_ Monument \_\_\_\_\_

stab. \_\_\_\_\_ Survey \_\_\_\_\_

Status \_\_\_\_\_

3. Original Description \_\_\_\_\_ Vol. \_\_\_\_\_ Page \_\_\_\_\_ Where Recorded \_\_\_\_\_

4. Description of Corners: Corner consists of a rock in place. Good condition. Dimensions above ground 8x6x4".

+ ON	TOP		
	$\frac{1}{4}$		
N	W	S	E
CARDINAL POSITION			

5. Investigation Notes:

$\frac{1}{4}$	$\frac{1}{4}$
S9	S10
B.T.	B.T.

Species D. Fir W. Fir

Diameter 30" 8"

Bearing S8°W S10°E

Distance 10' 6'

Believed to be a genuine Land Office Corner. Section line marker between Secs. 9 and 10 is on a tree on the old trail from Clinger Spring to Cooks Meadow located 30' N from  $\frac{1}{4}$  Corner.

6. Signed Van B. Embree Title Guard Date Aug. 24, 1948

Index  
File No. G 21

**CORNER RECORD (SEARCH)**  
(Ref. FSM 7151.4)

Tract or  
Survey No. \_\_\_\_\_  
Cor.  
No. \_\_\_\_\_

2 s R. 10 E R.D. Barlow County Hood River  
Merid. Willamette N.F. Mt. Hood State Oregon

**CORNER DIAGRAM**

**ROCKS  
MEADOW**

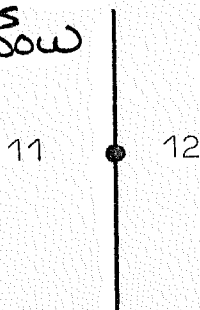

**DESCRIBE CORNER MONUMENT FOUND**

Rock- 15 x 8"- 6" above ground in good condition-  
Markings-X on top & ¼ on West face.

Note: A 1½" GF sapling is growing next to rock, hiding it from view. 2

**DESCRIBE BEARING TREES OR OTHER OFFICIAL ACCESSORIES FOUND**

S 11 BT- 14" GF- 315°45'- 17Ft.  
S 12 BT- 42" butt-forked Larch- 86°15'- 4 Ft.

**PHOTO IDENTIFICATION DATA**

Photo No. \_\_\_\_\_  
Filed At. \_\_\_\_\_  
Object Ident. \_\_\_\_\_  
Ident. By \_\_\_\_\_  
*Signature* 7

**DESCRIBE CORNER LOCATION RELATIVE TO NEAR-BY FEATURES, ALSO HOW TO REACH CORNER**

Go South from Sec. Cor. of 1,2,11,12 to ¼ cor.- close to Brooks Meadow. 3

**PLANE COORDINATE POSITION DATA**

State \_\_\_\_\_ Zone \_\_\_\_\_  
\_\_\_\_\_   
\_\_\_\_\_   
Established By \_\_\_\_\_  
*Agency* 8

*Signature*  
*South D. ...*

Title Forester Division Planning Headquarters Barlow

Date 9-11-76 4  
8700-52 (3/68) 5

## LAND CORNER RECORD

J-13/1104 A1

3. R. JOE No. J13 Cor. SEC Mer. WILL State <sup>(Rectangular)</sup> OREGON N. F. MT HOOD Dist. HOOD RIVER

Corner Status

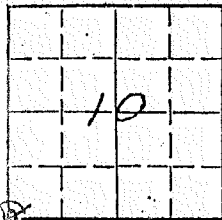

Photo Identification

to No. \_\_\_\_\_

t. By: \_\_\_\_\_

Plane Coordinate Position Data

a. \_\_\_\_\_ Zone \_\_\_\_\_

b. By \_\_\_\_\_

l Book No. \_\_\_\_\_

re Filed \_\_\_\_\_

Evaluation

entic \_\_\_\_\_

Is Verif. \_\_\_\_\_ Monument \_\_\_\_\_

stab. \_\_\_\_\_ Survey \_\_\_\_\_

l Status \_\_\_\_\_

3. Original Description \_\_\_\_\_ Vol. \_\_\_\_\_ Page \_\_\_\_\_ Where Recorded \_\_\_\_\_

## 4. Description of Corners:

FIR TREE 24" DIA. FOR COR.  
 FIR 10" DIA. N 84° E 48 LINKS  
 " 12" " S 70° E 54 LINKS  
 " 20" " S 36° W 42 LINKS  
 TAMARACK 5" " N 10° W 34 LINKS

## 5. Investigation Notes:

WENT TO CORNER FOUND SAME, FOUND BEARING  
 TREES NOTHING CHANGED (EXCEPT 5" TAMERACK  
 IS DEAD)

6. Signed C. Y. NORMAN Title \_\_\_\_\_ Date 12/9/62

LAND CORNER RECORD

R 10E No. J13 Cor. Sec Mer. WM State Oregon (Rectangular) N. F. Mt. Hood Dist. Hood River

Corner Status

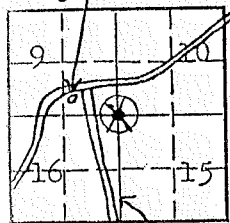

Lookout MtN. Rd.

Photo Identification  
No. \_\_\_\_\_  
By: \_\_\_\_\_

Plane Coordinate Position Data  
Zone \_\_\_\_\_

By \_\_\_\_\_  
Book No. \_\_\_\_\_  
e Filed \_\_\_\_\_

valuation \_\_\_\_\_  
entic \_\_\_\_\_  
s Verif. \_\_\_\_\_ Monument \_\_\_\_\_  
stab. \_\_\_\_\_ Survey \_\_\_\_\_

3. Original Description \_\_\_\_\_ Vol. \_\_\_\_\_ Page \_\_\_\_\_ Where Recorded \_\_\_\_\_

4. Description of Corners: Corner consists of a large gree white fir in place. Good condition. Dimensions above ground 36" tree.

	NW	SW	SE	NE
DIAGONAL POSITION →	S	S	S	S
	9	16	15	10

COMMON TO 9,10,15 & 16

5. Investigation Notes: Section line marker between Secs. 9 and 10 is on a tree on the Bottle Prairie Road located 26 chains N from Sec. Cor.

Signed J. D. Pedersen Title Dist. Ass't. Date 9/15/52





CORNER RECORD (SEARCH)

(Ref. FSM 7151.4)

Tract or

Survey No.

Cor.

No.

No. J 19

S R. 10 E

R.D. Barlow County Hood River

id. W.M

N.F. Mt. Hood State Oregon

FIELD DIAGRAM

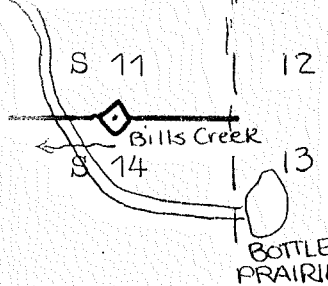

DESCRIBE CORNER MONUMENT FOUND

Rock- 10"x6"x7" above ground in good condition with X marked on top and 1/4 on North face.

DESCRIBE BEARING TREES OR OTHER OFFICIAL ACCESSORIES FOUND

12" LP bears 316° at 17'3"- S 11 BT.  
8" LP bears 184° at 14'0"- S 14 BT- now dead.

IDENTIFICATION DATA

No. \_\_\_\_\_  
At. \_\_\_\_\_  
Ident. \_\_\_\_\_  
By \_\_\_\_\_  
Signature

DESCRIBE CORNER LOCATION RELATIVE TO NEAR-BY FEATURES, ALSO HOW TO REACH CORNER

Near Agnes Spring on Touchdown Sale.

COORDINATE POSITION DATA

Zone \_\_\_\_\_  
By \_\_\_\_\_  
Agency

Signature  
John Fagerberg Forester

Title  
Planning

Headquarters  
Barlow

Date  
9-11-76

7100-52 (3-68)

CORNER RECORD (SEARCH)

Tract or

1103-03

ex No. J 21

(Ref. FSM 7151.4)

Survey No.

Cor.

No.

2 S R. 10 E

R.D. Barlow

County Hood River

rid. W.M.

N.F.Mt. Hood

State Oregon

NEAR DIAGRAM

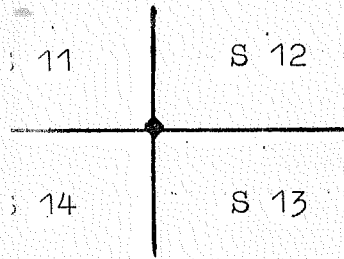

DESCRIBE CORNER MONUMENT FOUND

Rock-9x8"-4" above ground in good condition with X on top & 2 notches on S, 1 notch on E faces.

DESCRIBE BEARING TREES OR OTHER OFFICIAL ACCESSORIES FOUND

- 15" GF bears 331° 15' at 17'0"- S11 BT.
- 16" GF bears 51° 15' at 10'9"- S12 BT.
- 22" GF bears 113° 30' at 11'2"- S13 BT.
- 26" GF bears 254° 0' at 24'0"- S14 BT.

TO IDENTIFICATION DATA

to No. \_\_\_\_\_  
 d At. \_\_\_\_\_  
 ert Ident. \_\_\_\_\_  
 if. By \_\_\_\_\_  
*Signature*

DESCRIBE CORNER LOCATION RELATIVE TO NEAR-BY FEATURES, ALSO HOW TO REACH CORNER

NE COORDINATE POSITION DATA

te \_\_\_\_\_ Zone \_\_\_\_\_  
 \_\_\_\_\_  
 ob. By \_\_\_\_\_  
*Agency*

Signature

Title

Division

Headquarters

Date

7100-52 (3/68)

lth Fagerberg

Forester

Planning

Barlow

9-11-76

CORNER RECORD (SEARCH)  
(Ref. FSM 7151.4)

Tract or Survey No. \_\_\_\_\_ Cor. No. \_\_\_\_\_

X No. J 25

S R. 10 E R.D. Barlow County Wasco & Hood River  
id. W.M. N.F. Mt. Hood State Oregon

NEEDER DIAGRAM

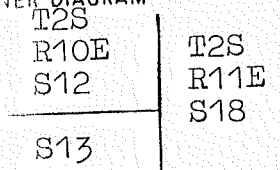

DESCRIBE CORNER MONUMENT FOUND  
Cor. est. Oct. 1912. Set basalt stone 15x12x5", 10" in ground for closing corner of sec. 12&13 mkd. C on W, w/2 grooves on N & 4 on S face from which a 6" lodgepole pine bears S77W 10 lks. mkd. T2S, R10E, S13, BT. A 6" Lodgepole pine bears N 84 W, 31 lks. mkd. T2S, R10E, S12, Bt.

DESCRIBE BEARING TREES OR OTHER OFFICIAL ACCESSORIES FOUND  
Original BT's: 12" LPP bears S87W, 10 lks., with fragmentary scribe marks visible on a partially healed blaze (record bearing, S 77 W).  
10" LPP bears N 79 1/2 W, 31 lks., with scribe marks T2S, R10E, S12, BT visible on opened blaze (record bearing, N 84 W).

IDENTIFICATION DATA

a. No. \_\_\_\_\_  
At. \_\_\_\_\_  
Ident. \_\_\_\_\_  
i. By \_\_\_\_\_  
*Signature* \_\_\_\_\_

DESCRIBE CORNER LOCATION RELATIVE TO NEAR-BY FEATURES, ALSO HOW TO REACH CORNER

COORDINATE POSITION DATA

e. \_\_\_\_\_ Zone \_\_\_\_\_  
b. By \_\_\_\_\_  
*Agency* \_\_\_\_\_

Signature: ooks/Peterson Title: Cas. Surveyors Division: \_\_\_\_\_ Headquarters: \_\_\_\_\_ Date: Jan. 1963 7100-52 (3-68)

LAND CORNER RECORD

L-13/1104 B2

2S R 10E No. L13 Cor. 1/4 Mer. WM State Oregon N. F. Mt. Hood Dist. Hood River

Corner Status

Lookout MT. Rd.

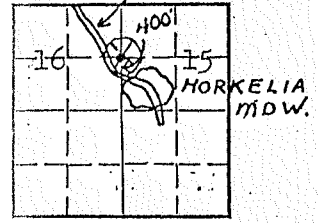

MON TO 15 & 16

Photo Identification

No. \_\_\_\_\_

By: \_\_\_\_\_

Plane Coordinate Position Data

Zone \_\_\_\_\_

\_\_\_\_\_

By \_\_\_\_\_

Book No. \_\_\_\_\_

Filed \_\_\_\_\_

\_\_\_\_\_

Valuation

Antic \_\_\_\_\_

Verif. \_\_\_\_\_ Monument \_\_\_\_\_

stab. \_\_\_\_\_ Survey \_\_\_\_\_

Status \_\_\_\_\_

3. Original Description \_\_\_\_\_ Vol. \_\_\_\_\_ Page \_\_\_\_\_ Where Recorded \_\_\_\_\_

4. Description of Corners: Corner consists of a rock in place. Good condition. Dimensions above ground 12x4x6".

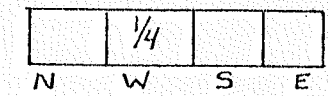

5. Investigation Notes:

1/4
S15
B.T.

Species W. Fir  
 Diameter 28"  
 Bearing S38°W  
 Distance 3'

Believed to be a genuine Land Office Corner. Metal Location Poster is on a White Fir (B.T.) tree 28" diameter from which this Corner bears S30°W 3'. Section line marker between Secs. 15 and 16 is on a tree on the Lookout Mt. Road located 400', S from 1/4 Corner.

6. Signed Van B. Embree Title \_\_\_\_\_ Date 1954

FOREST SERVICE

CORNER RECORD (SEARCH)  
(Ref. FSM 7151.4)

Tract or  
Survey No. \_\_\_\_\_

Cor.  
No. \_\_\_\_\_

10. L 21

S R. 10 E

R.D. Barlow

County

Hood River

d. \_\_\_\_\_

N.F. \_\_\_\_\_

State \_\_\_\_\_

ER DIAGRAM  
BOTTLE PR. RD.

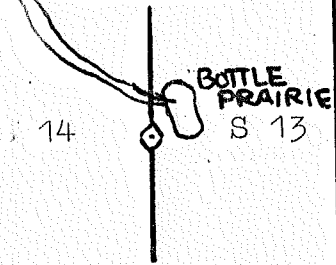

DESCRIBE CORNER MONUMENT FOUND

Rock-10"x5"-4" above ground in good condition with ¼ on West face and X on top.

DESCRIBE BEARING TREES OR OTHER OFFICIAL ACCESSORIES FOUND

14" LP bears 222°30' at 6'10"-scribed ¼ S14 BT.  
9" LP bears 132°15' at 5'0" -scribed ¼ S13 BT.

IDENTIFICATION DATA

c No. \_\_\_\_\_  
At. \_\_\_\_\_  
cf Ident. \_\_\_\_\_  
f. By \_\_\_\_\_  
*Signature*

DESCRIBE CORNER LOCATION RELATIVE TO NEAR-BY FEATURES, ALSO HOW TO REACH CORNER

E COORDINATE POSITION DATA

e \_\_\_\_\_ Zone \_\_\_\_\_  
b. By \_\_\_\_\_  
*Agency*

Signature  
th Eagerberg

Title  
Forester Planning

Division  
Barlow

Headquarters

Date  
9-11-78

7100-52 (3-68)

T22 R10E No. L25 Cor. 1/4 Mer. W: 1/1 State <sup>(Rectangular)</sup> Oregon N.F. Mt. Hood Dist. Hood River

Corner Status  
MINOR ONLY TO SEC. 13

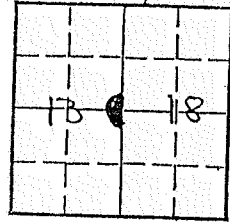

3. Original Description \_\_\_\_\_ Vol. \_\_\_\_\_ Page \_\_\_\_\_ Where Recorded \_\_\_\_\_

4. Description of Corners: Iron pipe with Brass Cap. Pipe 2" Cap 3", 8" above ground. Rock w/ "1/4" on w face. 6x12x10 high. All good condition.  
Markings: Rock "1/4" on w. face. Brass Cap.

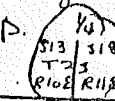

Dept. Mt.  
B.L.M.

Photo Identification

Photo No. \_\_\_\_\_

Developed By: \_\_\_\_\_

Plane Coordinate Position Data

Latitude \_\_\_\_\_ Zone \_\_\_\_\_

Longitude \_\_\_\_\_

Established By \_\_\_\_\_

Field Book No. \_\_\_\_\_

Where Filed \_\_\_\_\_

Evaluation

Monument \_\_\_\_\_

Is Verif. \_\_\_\_\_ Monument \_\_\_\_\_

Stable \_\_\_\_\_ Survey \_\_\_\_\_

Status \_\_\_\_\_

5. Investigation Notes: WP. 6" dia, Brs. N77°W, 11 ft. dist., scribing legible, frost "1/4 S 13PT". Also nailed to same tree is 4"x5" yellow metal loc. poster w/ hole punched halfway on E. edge of. Sec. 13, 2S, R. 10 E.

6. Signed E.S. Nance Title For Tech Date 6/27/68

LAND CORNER RECORD

N-13/OutsideB2

R 10E No. N13 Cor. SEC Mer. Will State OREGON (Rectangular) N. F. Mt. Hood Dist. Hood River

or Status

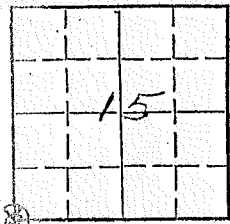

to Identification

No. \_\_\_\_\_

By: \_\_\_\_\_

Coordinate Position Data

Zone \_\_\_\_\_

By \_\_\_\_\_

ook No. \_\_\_\_\_

Filed \_\_\_\_\_

aluation

lic \_\_\_\_\_

Verif. Monument \_\_\_\_\_

ib. Survey \_\_\_\_\_

tatus \_\_\_\_\_

3. Original Description \_\_\_\_\_ Vol. \_\_\_\_\_ Page \_\_\_\_\_ Where Recorded \_\_\_\_\_

4. Description of Corners:  
 SET BASALT STONE, 18" X 12" X 6" SET 12" IN GROUND  
 FIR 24" DIA. N 40° E 45 LKS.  
 " 6" " S 15° E 22 "  
 " 3" " S 26° W 23 "  
 " 24" " N 6° W 23 "

5. Investigation Notes:  
 FOUND CORNER STONE, FOUND ALL BEARING  
 TREES GOOD COR.

6. Signed C.V. NORMAN Title \_\_\_\_\_ Date 12/9/64



R 10E No. N13 Cor. Sec Mer. WM State Oregon N. F. Mt. Hood Dist. Hood River

Original Status  
Lookout Mt. Rd.

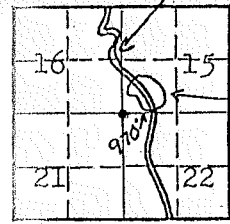

3. Original Description \_\_\_\_\_ Vol. \_\_\_\_\_ Page \_\_\_\_\_ Where Recorded \_\_\_\_\_

4. Description of Corners: Corner consists of a stone in place. Good condition.

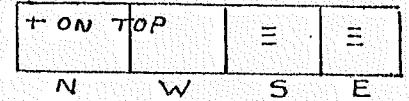

COMMON TO 15, 16, 21 & 22

Photo Identification

No. \_\_\_\_\_

By: \_\_\_\_\_

and Coordinate Position Data

Zone \_\_\_\_\_

By \_\_\_\_\_

Book No. \_\_\_\_\_

Filed \_\_\_\_\_

valuation

ntic \_\_\_\_\_

Verif. \_\_\_\_\_ Monument \_\_\_\_\_

ab. \_\_\_\_\_ Survey \_\_\_\_\_

Status \_\_\_\_\_

5. Investigation Notes:

2S	S	S	T2S
10E	10	R10	R10E
S16		S21	S22
		B.T.	B.T.

Species White Fir W.Fir W.Fir (snag) White Fir

Diameter 30" 36" 12" 10"

Bearing N53°W N40°E S28°W S11°30'E

Distance 11' 25' 14' 15'

Believed to be a genuine Land Office Corner. Metal Location Poster is on a Fir tree 24" diameter on the East side of Lookout Mt. Road from which this Corner bears West 970'.

6. Signed Van B. Embree Title \_\_\_\_\_ Date July 23, 1957

LAND CORNER RECORD

N-15/1104 B2

T. 2 S R10E No. N 15 Cor. Mer. Will. State Oregon N. F. Mt. Hood Dist. Hood River

Corner Status

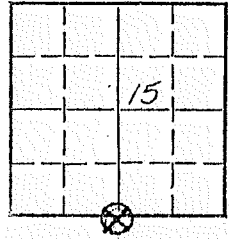

3. Original Description \_\_\_\_\_ Vol. \_\_\_\_\_ Page \_\_\_\_\_ Where Recorded \_\_\_\_\_

4. Description of Corners:  
Material: Rock Size: 15" x 6" x 20"  
Height above ground: 6" Condition: Good  
Markings: X on surface of rock

5. Investigation Notes:

1/4 corner between Sec. 15/22. Approximately 22 chains East of Ridge Road from line tag on road.

Photo Identification

to No. \_\_\_\_\_

nt. By: \_\_\_\_\_

Plane Coordinate Position Data

to \_\_\_\_\_ Zone \_\_\_\_\_

ib. By \_\_\_\_\_

d Book No. \_\_\_\_\_

ro Filed \_\_\_\_\_

Evaluation

entic \_\_\_\_\_

ds Verif. \_\_\_\_\_ Monument \_\_\_\_\_

stab. \_\_\_\_\_ Survey \_\_\_\_\_

l Status \_\_\_\_\_

6. Signed G.F. Erickson Title Forester Date 7-28-65

Section Cor.  
Cor. 14, 15, 22, 23  
No. \_\_\_\_\_

CORNER RECORD (SEARCH)

Tract or  
Survey No. \_\_\_\_\_

No. N 17  
2S R. 10E

R.D. \_\_\_\_\_ County \_\_\_\_\_

Merid. WM N.F. Mt. Hood State Oregon

CORNER DIAGRAM

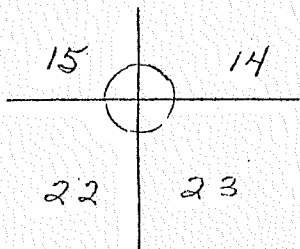

DESCRIBE CORNER MONUMENT FOUND  
B.T.

DESCRIBE BEARING TREES OR OTHER OFFICIAL ACCESSORIES FOUND  
Scribed T2S, R10E, S14 7ft. stump L.P.P. 20" diameter bearing N42°E  
distance 138 ft. Believed to be genuine corner.

PHOTO IDENTIFICATION DATA

Photo No. \_\_\_\_\_  
Filed At. \_\_\_\_\_  
Object Ident. \_\_\_\_\_  
Ident. By \_\_\_\_\_

DESCRIBE CORNER LOCATION RELATIVE TO NEAR-BY FEATURES, ALSO HOW TO REACH CORNER  
Metal Location Poster is on a Fir tree 12" diameter on the East  
from which this corner bears East 14ft. Section line marker  
between Secs. 14 and 23 is on a tree on the Blue Bucket Trail lo-  
cated 270ft E from Sec. Cor. Also tag placed on Blue Bucket Trail  
116ft S at Corner.

PLANE COORDINATE POSITION DATA

Date \_\_\_\_\_ Zone \_\_\_\_\_  
\_\_\_\_\_   
\_\_\_\_\_   
Stub. By \_\_\_\_\_  
Agency \_\_\_\_\_

Signature  
Barry B. Barbour

Title  
Civ. Eng. Tech.

Division \_\_\_\_\_

Headquarters \_\_\_\_\_

Date

9/24/62

7100-52

REV. 65 5



Index file No. N 19

**CORNER RECORD (SEARCH)**

(Ref. FSM 7151.4)

Tract or Survey No. \_\_\_\_\_ Cor. No. \_\_\_\_\_

2 S R. 10 E R.D. Barlow County Hood River  
 Merid. Willamette N.F. Mt. Hood State Oregon

**CORNER DIAGRAM**

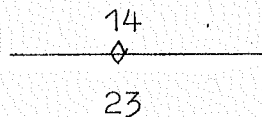

**DESCRIBE CORNER MONUMENT FOUND**

None Visible

**DESCRIBE BEARING TREES OR OTHER OFFICIAL ACCESSORIES FOUND**

DF- 30"- 1/4 S 23 BT  
 DF- 30"- 1/4 S 14 BT  
 DF- 32"- Blazed X- Dead

**PHOTO IDENTIFICATION DATA**

Photo No. \_\_\_\_\_  
 Filed At. \_\_\_\_\_  
 Object Ident. \_\_\_\_\_  
 Sent. By \_\_\_\_\_  
*Signature*

**DESCRIBE CORNER LOCATION RELATIVE TO NEAR-BY FEATURES, ALSO HOW TO REACH CORNER**

Located on West side of Dog River in Watershed (The Dalles) upstream from old cabin and on opposite side.

**PLANE COORDINATE POSITION DATA**

Date \_\_\_\_\_ Zone \_\_\_\_\_  
 Stationed By \_\_\_\_\_  
*Agency*

Signature Jourdet Title Forestry Aid Division Planning Headquarters Barlow Date 7-9-80 7100-52 (3/68)

X 2 /

Index File No. N 21

CORNER RECORD (SEARCH)

Tract or Survey No. \_\_\_\_\_ Cor. No. 13,14,23,24

T 2S R. 10E

R.D. \_\_\_\_\_ County \_\_\_\_\_

Merid. WM

N.F. Mt. Hood State Oregon

CORNER DIAGRAM

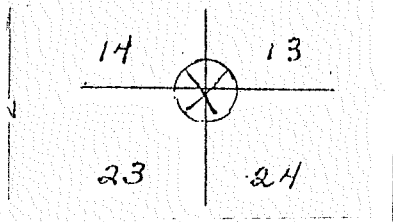

DESCRIBE CORNER MONUMENT FOUND  
 N.R. in place, good condition. Marked -  
 - -  
 S E

DESCRIBE BEARING TREES OR OTHER OFFICIAL ACCESSORIES FOUND  
 Scribed T2S,R10E,S14,open, Fir 45" diameter bearing N86°E distance 28.3ft.; Fir 24" diameter bearing S55°E distance 54ft.; Fir 41" diameter bearing S55°W 41ft distance; Fir 18" diameter bearing N78°W distance 8.5ft. .

PHOTO IDENTIFICATION DATA  
 Photo No. \_\_\_\_\_  
 Filed At. \_\_\_\_\_  
 Object Ident. \_\_\_\_\_  
 dent. By \_\_\_\_\_  
*Signature*

DESCRIBE CORNER LOCATION RELATIVE TO NEAR-BY FEATURES, ALSO HOW TO REACH CORNER  
 Metal Location Poster is on a Fir tree 5" diameter on the East from which this Corner bears East 6ft. Partially reblazed trail to corner lies. Part way up a small hill. About 300ft. S of clearing.

LANE COORDINATE POSITION DATA  
 State \_\_\_\_\_ Zone \_\_\_\_\_  
 \_\_\_\_\_  
 \_\_\_\_\_  
 Instab. By \_\_\_\_\_  
*Agency*

Signature	Title	Division	Headquarters	Date	7100-52
Barry B. Barbour	Civ. Eng. Tech.			10/17/62	REV. 65 5

LAND CORNER RECORD

(Rectangular)

25 RIDE No R15 Cor. Mer Will. State Oregon N. F. Mt Hood Dist. Hoc R 15  
1704-B3

Corner Status

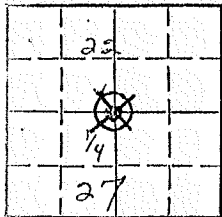

3. Original Description \_\_\_\_\_ Vol. \_\_\_\_\_ Page \_\_\_\_\_ Where Recorded \_\_\_\_\_

4. Description of Corners: Section line well blazed.  
Corner is at edge of a small meadow

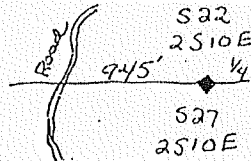

5. Investigation Notes:

Photo Identification

No. \_\_\_\_\_  
By: \_\_\_\_\_

Plane Coordinate Position Data

Zone \_\_\_\_\_  
\_\_\_\_\_

By \_\_\_\_\_

Book No. \_\_\_\_\_

File Filed \_\_\_\_\_

valuation

ntic \_\_\_\_\_

s Verif. \_\_\_\_\_ Monument \_\_\_\_\_

tab. \_\_\_\_\_ Survey \_\_\_\_\_

Status \_\_\_\_\_

6. Signed E.S. Nance Title Tech. For.

Date 8-17-65

LAND CORNER RECORD

23 R 10E No. R15 Cor. 1/4 Mer. WM State Oregon (Rectangular) N. F. Mt. Hood Dist. Hood River

Corner Status \_\_\_\_\_

ADJACENT TO SECS. 22 & 27

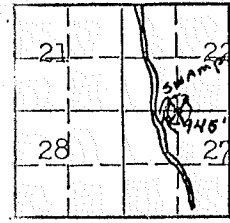

Photo Identification \_\_\_\_\_

No. \_\_\_\_\_

By \_\_\_\_\_

Plane Coordinate Position Data \_\_\_\_\_

Zone \_\_\_\_\_

By \_\_\_\_\_

Book No. \_\_\_\_\_

File No. \_\_\_\_\_

Valuation \_\_\_\_\_

Antic \_\_\_\_\_

Is Verif. \_\_\_\_\_ Monument \_\_\_\_\_

Is Tab. \_\_\_\_\_ Survey \_\_\_\_\_

Status \_\_\_\_\_

3. Original Description \_\_\_\_\_ Vol. \_\_\_\_\_ Page \_\_\_\_\_ Where Recorded \_\_\_\_\_

4. Description of Corners: Corner consists of a stone in place. Good condition.

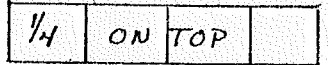

N W S E  
CARDINAL POSITION

5. Investigation Notes:

1/4	Grown Over
S22	
B.T.	

Species	Spruce	Spruce
Diameter	14"	16"
Bearing	N27°E	S61°W
Distance	6'	15'

Believed to be a genuine Land Office Corner. Metal Location Poster is on a Spruce tree 16" diameter on the West side of Lookout Mt. Road from which this Corner bears East, 945'.

6. Signed Van B. Embree Title \_\_\_\_\_ Date July 23, 1957



LAND CORNER RECORD

V 15

RIDE No. V15 Cor. Metull. State Oregon (Rectangular) N. F. Mt Hood Dist. 6 Outside BZ

Corner Status

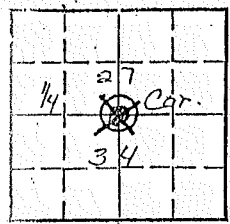

3. Original Description \_\_\_\_\_ Vol. \_\_\_\_\_ Page \_\_\_\_\_ Where Recorded \_\_\_\_\_

4. Description of Corners: N.B. 2 witness trees in Sec. 34. None seen in Sec. 27. This corner is inside a proposed logging unit #6, Horkelia Meadow Sale. Trees marked for high stumpage.

5. Investigation Notes:

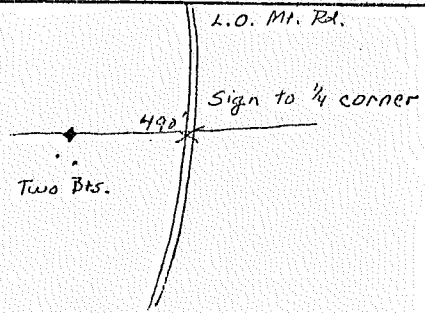

Photo Identification.

No. \_\_\_\_\_  
By: \_\_\_\_\_

Plane Coordinate Position Data  
Zone \_\_\_\_\_

By \_\_\_\_\_  
Book No. \_\_\_\_\_  
Filed \_\_\_\_\_

valuation \_\_\_\_\_  
ntific \_\_\_\_\_  
s Verif. \_\_\_\_\_ Monument \_\_\_\_\_  
tab. \_\_\_\_\_ Survey \_\_\_\_\_

Status \_\_\_\_\_

6. Signed F. S. Vance Title For. Tech. Date 8/18/65

LAND CORNER RECORD

25<sup>th</sup> R 10E No. V13 Cor. 1/4 Mer. WM State Oregon (Rectangular) N. F. Mt. Hood Dist. Hood River

Original Status MON TO 34

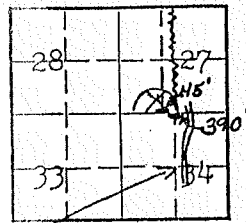

LOOKOUT MTN. ROAD

Photo Identification

No. \_\_\_\_\_

By: \_\_\_\_\_

Plane Coordinate Position Data

Zone \_\_\_\_\_

By \_\_\_\_\_

Book No. \_\_\_\_\_

Filed \_\_\_\_\_

Location \_\_\_\_\_

Method \_\_\_\_\_

Verif. \_\_\_\_\_ Monument \_\_\_\_\_

Character of Survey \_\_\_\_\_

Original Status \_\_\_\_\_

3. Original Description \_\_\_\_\_ Vol. \_\_\_\_\_ Page \_\_\_\_\_ Where Recorded \_\_\_\_\_

4. Description of Corners: Corner consists of a rock in place. Good condition. Dimensions above ground 8x6x2".

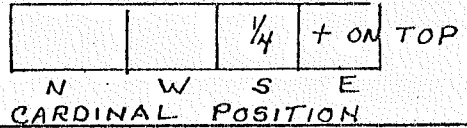

5. Investigation Notes:

1/4	1/4
S 34	S 34
B.T.	B.T.

Species W. Fir W. Fir

Diameter 20" 10"

Bearing S25°W S

Distance 20' 28'

Believed to be a genuine Land Office Corner. Metal Location Poster is on a White Fir (B.T.) tree 20" diameter from which this Corner bears N25°E, 20'. Section line marker between Secs. 27 and 34 is on a tree on the Lookout Mt. Road located 390' E from 1/4 Corner. The 1/4 corner for Section 27 is 45' West of this corner.

6. Signed Van B. Embree Title \_\_\_\_\_ Date Aug. 8, 1954

25<sup>th</sup> R 10E No. V15 Cor.  $\frac{1}{4}$  Mer. WM State Oregon (Rectangular) N. F. Mt. Hood Dist. Hood River

or Status \_\_\_\_\_  
ON TO 27

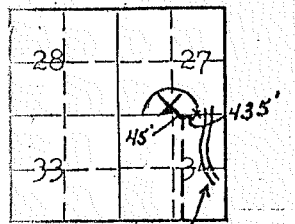

Lookout Mt. Rd.

Photo Identification

No. \_\_\_\_\_

By: \_\_\_\_\_

Plane Coordinate Position Data

Zone \_\_\_\_\_

By \_\_\_\_\_

Book No. \_\_\_\_\_

Filed \_\_\_\_\_

valuation \_\_\_\_\_

ntic \_\_\_\_\_

3 Verif. \_\_\_\_\_ Monument \_\_\_\_\_

tab. \_\_\_\_\_ Survey \_\_\_\_\_

Status \_\_\_\_\_

3. Original Description \_\_\_\_\_ Vol. \_\_\_\_\_ Page \_\_\_\_\_ Where Recorded \_\_\_\_\_

4. Description of Corners: Corner consists of a rock in place. Good condition. Dimensions above ground 8x8x4".

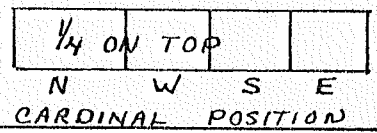

5. Investigation Notes:

$\frac{1}{4}$	$\frac{1}{4}$
S27	S27
B.T.	B.T.

Species W. Fir (snag) W. Fir

Diameter 14" 18"

Bearing N60°W N85°E

Distance 12' 8'

Believed to be a genuine Land Office Corner. Section line marker between Secs. 27 and 34 is on a tree on the Lookout Mt. Road located 435' E. from  $\frac{1}{4}$  Corner. The  $\frac{1}{4}$  corner for section 34 is 45' East of this corner.

6. Signed Van B. Embree Title \_\_\_\_\_ Date Aug. 8., 1954

Index V 19  
File No. \_\_\_\_\_  
2 S R. 10 E

**CORNER RECORD (SEARCH)**  
(Ref. FSM 7151.4)

Tract or Survey No. \_\_\_\_\_  
Cor. No. \_\_\_\_\_

Merid. Willamette

R.D. Barlow County Hood River  
N.F. Mt. Hood State Oregon

**CORNER DIAGRAM**

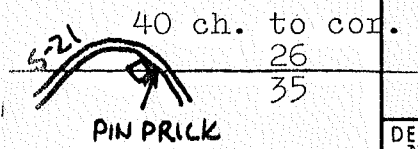

DESCRIBE CORNER MONUMENT FOUND  
None Found

DESCRIBE BEARING TREES OR OTHER OFFICIAL ACCESSORIES FOUND  
None- only one spruce large enough and it wasn't showing any blazes.

**PHOTO IDENTIFICATION DATA**

Photo No. 478-122  
Filed At. Planning  
Object Ident. \_\_\_\_\_  
Ident. By \_\_\_\_\_  
*Signature*

**DESCRIBE CORNER LOCATION RELATIVE TO NEAR-BY FEATURES, ALSO HOW TO REACH CORNER**

In the tip of S 21 that goes farthest North  
Location tag put on only large spruce in the area.

**PLANE COORDINATE POSITION DATA**

State \_\_\_\_\_ Zone \_\_\_\_\_  
\_\_\_\_\_   
\_\_\_\_\_   
Establish. By \_\_\_\_\_  
*Agency*

*Signature*  
*Alb McArthur*

Title Forester Division Planning Headquarters Barlow

Date 10-23-80 7100-52 (3/68)

Index

File No.

V 21

CORNER RECORD (SEARCH)

(Ref. FSM 7151.4)

Tract or

Survey No.

Cor.

No.

V 21

1104-D4

2 S R. 10 E

R.D. Barlow

County

Hood River

Merid. Willamette

N.F. Mt. Hood

State

Oregon

CORNER DIAGRAM

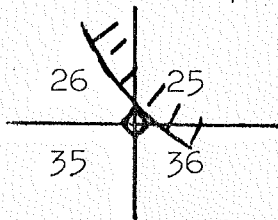

DESCRIBE CORNER MONUMENT FOUND

Stone- 12x12"- Flat on top

DESCRIBE BEARING TREES OR OTHER OFFICIAL ACCESSORIES FOUND

A Tamarack 30"- bears S 84°15'W- 26 ft.  
A Tamarack 13"- bears S 23°30'E- 12 ft.

PHOTO IDENTIFICATION DATA

Photo No.

Filed At.

Object Ident.

Ident. By

Signature

PLANE COORDINATE POSITION DATA

Date

Zone

Established By

Agency

DESCRIBE CORNER LOCATION RELATIVE TO NEAR-BY FEATURES, ALSO HOW TO REACH CORNER

Signature  
*Rich M. ...*

Title  
Forester

Division  
Planning

Headquarters  
Barlow

Date  
10-22-80

7100-52 (3/68)

Index File No. V 23

**CORNER RECORD (SEARCH)**  
(Ref. FSM 7151.4)

Tract or Survey No. \_\_\_\_\_

Cor. No. \_\_\_\_\_

V 23  
1104-D2

2 S R. 10 E R.D. Barlow County Hood River  
Merid. Willamette N.F. Mt. Hood State Oregon

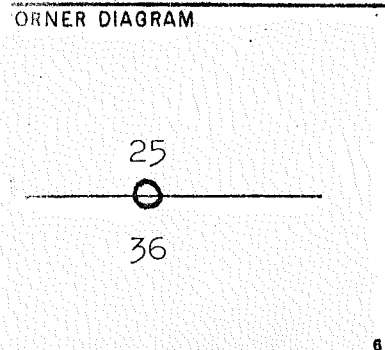

DESCRIBE CORNER MONUMENT FOUND  
No evidence of corner

DESCRIBE BEARING TREES OR OTHER OFFICIAL ACCESSORIES FOUND  
Timber not as described  
Survey calls in 1878 survey are not possible

PHOTO IDENTIFICATION DATA  
Photo No. \_\_\_\_\_  
Filed At. \_\_\_\_\_  
Object Ident. \_\_\_\_\_  
Ident. By \_\_\_\_\_  
*Signature*

DESCRIBE CORNER LOCATION RELATIVE TO NEAR-BY FEATURES, ALSO HOW TO REACH CORNER  
I don't believe that the corner was ever set

PLANE COORDINATE POSITION DATA  
State \_\_\_\_\_ Zone \_\_\_\_\_  
Established By \_\_\_\_\_  
*Agency*

*Signature* Title Division Headquarters Date  
Rob M. Bowler Forester Planning Barlow 10-22-80 7100-52 (3/68)

# LAND CORNER RECORD

25 R 10E No. 215 Cor. 1/4 Mer. WM State Oregon (Rectangular) N. F. Mt. Hood Dist. Hoo 1104-B5 Z 15

Owner Status \_\_\_\_\_

Lookout Mtn. Rd.

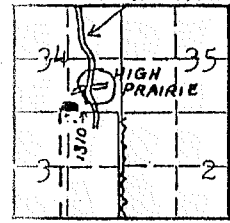

IN TO 34 \_\_\_\_\_

Photo Identification \_\_\_\_\_

No. \_\_\_\_\_

By: \_\_\_\_\_

and Coordinate Position Data \_\_\_\_\_

Zone \_\_\_\_\_

By \_\_\_\_\_

Book No. \_\_\_\_\_

Filed \_\_\_\_\_

valuation \_\_\_\_\_

ntic \_\_\_\_\_

Verif. Monument \_\_\_\_\_

ab. Survey \_\_\_\_\_

Status \_\_\_\_\_

3. Original Description \_\_\_\_\_ Vol. \_\_\_\_\_ Page \_\_\_\_\_ Where Recorded \_\_\_\_\_

4. Description of Corners: Corner consists of a iron pipe brass cap in place. Good condition. Dimensions above ground 1x8". Mound of rock is located North.



5. Investigation Notes:

1/4	1/4	1/4 S	1/4 S
S	S	34	34
B.T.	B.T.	B.T.	B.T.

Species	Hemlock	Hemlock	Fir	Hemlock
Diameter	12"	10"	10"	6"
Bearing	S14°W	S79°W	N59°E	N6°W
Distance	12'	10'	23'	4'

Believed to be a genuine Land Office Corner. Metal Location Poster is on a Fir tree 30" diameter on the West side of Lookout Mt. Road from which this Corner bears West 1310'. This line crosses the Lookout Mt. Road approximately 100' after leaving High Prairie.

6. Signed Vam B. Embree Title \_\_\_\_\_ Date July 18, 1957

LAND CORNER RECORD

(Rectangular)

Z 17  
1784 C 5

2S R 10E No. Z 17

Cor. Sec Mer. WM State Oregon

N. F. Mt. Hood

Dist. Hood 7104-05 Z 17

Corner Status

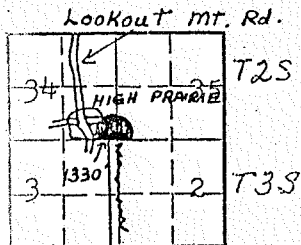

40N ON TO 34 & 35

Photo Identification

No. \_\_\_\_\_

By: \_\_\_\_\_

Plane Coordinate Position Data

Zone \_\_\_\_\_

By: \_\_\_\_\_

Book No. \_\_\_\_\_

Date Filed \_\_\_\_\_

valuation

ntic \_\_\_\_\_

Verif. Monument \_\_\_\_\_

tab. Survey \_\_\_\_\_

Status \_\_\_\_\_

3. Original Description \_\_\_\_\_ Vol. \_\_\_\_\_ Page \_\_\_\_\_ Where Recorded \_\_\_\_\_

4. Description of Corners: Corner consists of an iron pipe, brass cap in place. Good condition. Dimensions above ground  $1\frac{1}{2} \times 10$ ". Mound of rock is located North.

S34 | S35  
T2S | R10E  
52  
T3S | R10E

5. Investigation Notes:

T2S	T2S
R10E	R10E
S34	S 35
B.T.	B.T.

Species	Hemlock	Hemlock
Diameter	26"	24"
Bearing	N15°W	N47°E
Distance	30'	35'

Believed to be a genuine Land Office Corner. Metal Location Poster is on a Fir tree 30" diameter on the West side of Lookout Mt. Road from which this Corner bears West 1330'. This line crosses the Lookout Mt. Road approximately 100' after leaving High Prairie.

6. Signed Van B. Embree Title \_\_\_\_\_ Date July 18, 1957