

LEGEND

○ = Corner having information on form 7100-52 in this file.

FILING INSTRUCTION

File 7100-52 card record by letter and number coordinates behind the file guide for the township in which it falls.

File the 7100-52 card record by letter and then by number i.e., all A cards first, then B cards etc.

The first card behind the file guide (if data have been obtained and recorded) will be card A-1 for N.W. Township Corner, then card A-2 for 1/16 corner then card A-3 for 1/4 corner etc.

FROM BPA DWG. BONNEVILLE-DALLES LINE
3 DEC 84

Index File No. _____ CORNER RECORD (SEARCH) (Ref. FSM 7151.4) Tract or Survey No. _____ Cor. No. G-25
 T 2N. R. 7E. R.D. _____ County HOOD RIVER
 Merid. W.M. N.F. CRGNSA State OREGON

CORNER DIAGRAM

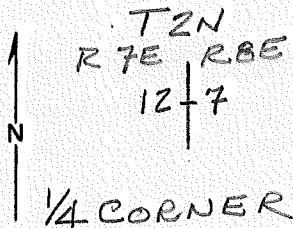

DESCRIBE CORNER MONUMENT FOUND

FD, I.P.

2

DESCRIBE BEARING TREES OR OTHER OFFICIAL ACCESSORIES FOUND

3

DESCRIBE CORNER LOCATION RELATIVE TO NEAR-BY FEATURES, ALSO HOW TO REACH CORNER

PHOTO IDENTIFICATION DATA

Photo No. _____
 Filed At. _____
 Object Ident. _____
 Ident. By _____
 Signature _____

6

7

PLANE COORDINATE POSITION DATA

State _____ Zone _____
 X _____
 Y _____
 Estab. By _____
 Agency _____

8

4

Signature _____ Title _____ Division _____ Headquarters _____ Date _____ FS-7100-52 (3/68)

CORNER RECORD (PERPETUATION)

MONUMENT: DESCRIBE NEW MONUMENT SET, OR WORK DONE TO PRESERVE EXISTING MONUMENT

9

ACCESSORIES : DESCRIBE NEW BT'S WITNESS OBJECTS ETC. ESTABLISHED, OR WORK DONE TO PRESERVE EXISTING EVIDENCE

10

Work Done By _____ **Title** _____ **Date** _____ **State Registration No.**
or Agency _____

Certified Cor. Record Prepared ? Yes No **Filed At:** _____ **Date** _____ 11

REMARKS

12

Index File No. **T.** **R.** **M.** **Tract or Surv. No.** **Cor,** 13

Index
File No. _____

CORNER RECORD (SEARCH)
(Ref. FSM 7151.4)

Tract or Survey No. _____
Cor. No. J-23

T 2N. R. 7E
Merid. W.M.

R.D. _____ County HOOD RIVER
N.F. CRGNSA State OREGON

CORNER DIAGRAM

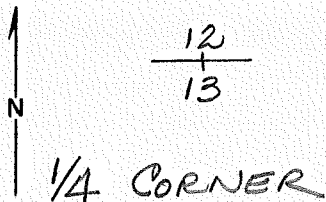

DESCRIBE CORNER MONUMENT FOUND

U.S.E.D. MON

DESCRIBE BEARING TREES OR OTHER OFFICIAL ACCESSORIES FOUND

PHOTO IDENTIFICATION DATA

Photo No. _____
Filed At. _____
Object Ident. _____
Ident. By _____

Signature

PLANE COORDINATE POSITION DATA

State _____ Zone _____
X _____
Y _____
Estab. By _____

Agency

Signature

Title

Division

Headquarters

Date

FS-7100-52 (3/68)

6

8

2

3

4

CORNER RECORD (PERPETUATION)

MONUMENT: DESCRIBE NEW MONUMENT SET, OR WORK DONE TO PRESERVE EXISTING MONUMENT

9

ACCESSORIES : DESCRIBE NEW BT'S WITNESS OBJECTS ETC. ESTABLISHED, OR WORK DONE TO PRESERVE EXISTING EVIDENCE

10

Work Done By _____ **Title** _____ **Date** _____ **State Registration No. or Agency** _____

Certified Cor. Record Prepared ? Yes No **Filed At:** _____ **Date** _____ **11**

REMARKS

12

Index File No. **T.** **R.** **M.** **Tract or Surv. No.** **Cor.** **13**

FROM BPA DWG. BONNEVILLE-DALLES
3 DEC 84 LINE

Index
File No. _____

CORNER RECORD (SEARCH)
(Ref. FSM 7151.4)

Tract or
Survey No. _____

Cor.
No. J-25

T 2N R. 7E
Merid. U.M.

R.D. _____ County HOOD RIVER
N.F. CR6NSA State OREGON

CORNER DIAGRAM

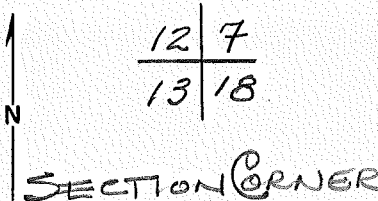

DESCRIBE CORNER MONUMENT FOUND

FD. STONE

DESCRIBE BEARING TREES OR OTHER OFFICIAL ACCESSORIES FOUND

PHOTO IDENTIFICATION DATA

Photo No. _____
Filed At. _____
Object Ident. _____
Ident. By _____
Signature

DESCRIBE CORNER LOCATION RELATIVE TO NEAR-BY FEATURES, ALSO HOW TO REACH CORNER

PLANE COORDINATE POSITION DATA

State _____ Zone _____
X _____
Y _____
Estab. By _____
Agency

Signature

Title

Division

Headquarters

Date

FS-7100-52 (3/68)

CORNER RECORD (PERPETUATION)

MONUMENT: DESCRIBE NEW MONUMENT SET, OR WORK DONE TO PRESERVE EXISTING MONUMENT

9

ACCESSORIES : DESCRIBE NEW BT'S WITNESS OBJECTS ETC. ESTABLISHED, OR WORK DONE TO PRESERVE EXISTING EVIDENCE

10

Work Done By _____ Title _____ Date _____ State Registration No. or Agency _____

Certified Cor. Record Prepared ? Yes No Filed At: _____ Date _____ 11

REMARKS

12

Index File No. T. R. M. Tract or Surv. No. Cor, 13

Index
File No. _____

CORNER RECORD (SEARCH)
(Ref. FSM 7151.4)

Tract or Survey No. _____
Cor. No. L-21

T 2N R. 7E
Merid. W.M.

R.D. _____ County HOOD RIVER
N.F. CRGNSA State OREGON

CORNER DIAGRAM

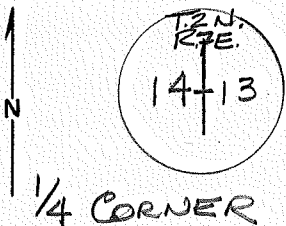

DESCRIBE CORNER MONUMENT FOUND

U.S.E.D MON.

DESCRIBE BEARING TREES OR OTHER OFFICIAL ACCESSORIES FOUND

PHOTO IDENTIFICATION DATA

Photo No. _____
Filed At. _____
Object Ident. _____
Ident. By _____

Signature

PLANE COORDINATE POSITION DATA

State _____ Zone _____
X _____
Y _____
Estab. By _____

Agency

Signature

Title

Division

Headquarters

Date

FS-7100-52 (3/68)

6

8

2

3

4

CORNER RECORD (PERPETUATION)

MONUMENT: DESCRIBE NEW MONUMENT SET, OR WORK DONE TO PRESERVE EXISTING MONUMENT

9

ACCESSORIES : DESCRIBE NEW BT'S WITNESS OBJECTS ETC. ESTABLISHED, OR WORK DONE TO PRESERVE EXISTING EVIDENCE

10

Work Done By _____ Title _____ Date _____ State Registration No.
or Agency _____

Certified Cor. Record Prepared ? Yes No Filed At: _____ Date _____ 11

REMARKS

12

Index File No. T. R. M. Tract or Surv. No. Cor. 13

Index
File No. _____
T 2N. R. 7E
Merid. W.M.

CORNER RECORD (SEARCH)
(Ref. FSM 7151.4)

Tract or
Survey No. _____
Cor. L-23
No. _____

R.D. _____ County HOOD RIVER
N.F. CR6NSA State OREGON

CORNER DIAGRAM

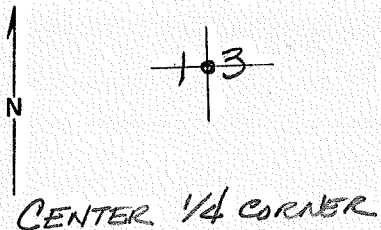

DESCRIBE CORNER MONUMENT FOUND

I.P.

DESCRIBE BEARING TREES OR OTHER OFFICIAL ACCESSORIES FOUND

PHOTO IDENTIFICATION DATA

Photo No. _____
Filed At. _____
Object Ident. _____
Ident. By _____
Signature

DESCRIBE CORNER LOCATION RELATIVE TO NEAR-BY FEATURES, ALSO HOW TO REACH CORNER

PLANE COORDINATE POSITION DATA

State _____ Zone _____
X _____
Y _____
Estab. By _____
Agency

Signature

Title

Division

Headquarters

Date

FS-7100-52 (3/68)

CORNER RECORD (PERPETUATION)

MONUMENT: DESCRIBE NEW MONUMENT SET, OR WORK DONE TO PRESERVE EXISTING MONUMENT

ACCESSORIES : DESCRIBE NEW BT'S WITNESS OBJECTS ETC. ESTABLISHED, OR WORK DONE TO PRESERVE EXISTING EVIDENCE

Work Done By _____ Title _____ Date _____ State Registration No. or Agency _____

Certified Cor. Record Prepared ? Yes No Filed At: _____ Date _____

REMARKS

Index File No. T. R. M. Tract or Surv. No. Cor. _____

Index
 File No. J-21.5
 T 2N R. 7E
 Merid. Willamette

CORNER RECORD (SEARCH)

(Ref. FSM 7151.4)

Tract or Survey No. _____
 R.D. Columbia Gorge County Hood River
 N.F. Mt. Hood State Oregon

Cor. No. WCMC

CORNER DIAGRAM

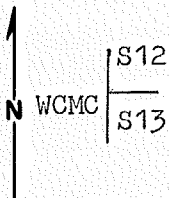

DESCRIBE CORNER MONUMENT FOUND

DESCRIBE BEARING TREES OR OTHER OFFICIAL ACCESSORIES FOUND

PHOTO IDENTIFICATION DATA

Photo No. _____
 Filed At. _____
 Object Ident. _____
 Ident. By _____
Signature

DESCRIBE CORNER LOCATION RELATIVE TO NEAR-BY FEATURES, ALSO HOW TO REACH CORNER

Corner is on the edge of the bank above the Columbia River West of the railroad tracks about 50' SW of the Bridge of the Gods.

PLANE COORDINATE POSITION DATA

State _____ Zone _____
 X _____
 Y _____
 Estab. By _____
Agency

Signature John D. ...

Title Land Surveyor Division _____ Headquarters _____

Date 6/87 FS-7100-52 (3/68)

CORNER RECORD (PERPETUATION)

MONUMENT : DESCRIBE NEW MONUMENT SET, OR WORK DONE TO PRESERVE EXISTING MONUMENT

Set 2"x30" Gal. steel pipe with a 3" Brass cap 28" in ground on edge of bank to river stamped:

T2N	R7E
	S12
WCMC	S13
LS	896
	1987

9

ACCESSORIES : DESCRIBE NEW BT'S WITNESS OBJECTS ETC. ESTABLISHED, OR WORK DONE TO PRESERVE EXISTING EVIDENCE

Telephone pole N77W-3.1'.
Center of joint of West rail of by-pass track S30E-28.75'.

10

Work Done By Larry D. Bishop Title Surveyor Date 6/87 State Registration No. 896
or Agency _____

Certified Cor. Record Prepared ? Yes No Filed At: _____ Date _____

11

REMARKS

Set guard post NW with decal survey marker only.

12

Index File No. J-21.5T. 2N R. 7E M. _____ Tract or Surv. No. _____ Cor. WCMC

13

Index
File No. J-23

CORNER RECORD (SEARCH)
(Ref. FSM 7151.4)

Tract or
Survey No. _____ Cor. No. 1/4

T 2N R. 7E R.D. Columbia Gorge County Hood River

Merid. Willamette N.F. Mt. Hood State Oregon

CORNER DIAGRAM

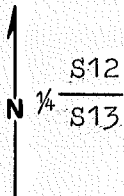

DESCRIBE CORNER MONUMENT FOUND

Brass capped Iron pipe by Hood River Co.

S1/4
Sec 12
T2N R7E

Monument firmly set in a small mound of stone stamped:

2

DESCRIBE BEARING TREES OR OTHER OFFICIAL ACCESSORIES FOUND

Powers reference trees:

30" Fir now a 48" sawed, rotted D-Fir stump N85 1/2 W-46.4' no marks.

24" now 32" D-Fir S2E-35.9' (record S4-48E 34.5') no marks.

4" Oak gone as are all traces of the original BT's.

3

PHOTO IDENTIFICATION DATA

Photo No. _____

Filed At. _____

Object Ident. _____

Ident. By _____

Signature _____

6

PLANE COORDINATE POSITION DATA

State _____ Zone _____

X _____

Y _____

Estab. By _____

Agency _____

8

DESCRIBE CORNER LOCATION RELATIVE TO NEAR-BY FEATURES, ALSO HOW TO REACH CORNER

Corner is 80' North of Pacific Crest Trail about 800' from its junction with trail to Eagle creek.

4

Signature

Louis O. Anderson

Title
Land Surveyor

Division

Headquarters

Date 7/87 FS-7100-52 (3/68)

5

CORNER RECORD (PERPETUATION)

MONUMENT : DESCRIBE NEW MONUMENT SET, OR WORK DONE TO PRESERVE EXISTING MONUMENT

9

ACCESSORIES : DESCRIBE NEW BT'S WITNESS OBJECTS ETC. ESTABLISHED, OR WORK DONE TO PRESERVE EXISTING EVIDENCE

6" Maple N50W-28.1' scribed 1/4S12BT
 18" D-Fir S43E-17.6' scribed 1/4S13BT
 Both BT's have a 1" Brass disk stamped PLS 896.

10

Work Done By Larry D. Bishop Title Surveyor Date 7/87 State Registration No. 896
 or Agency _____

Certified Cor. Record Prepared ? Yes No Filed At: _____ Date _____

11

REMARKS

Set guard posts South & East with decals 54-2 & survey marker.
 Nailed 54-4 & BT signs to BT's & painted band & blazes red.

12

Index File No. J-23 T. 2N R. 7E M. Tract or Surv. No. _____ Cor. 1/4

13

CORNER RECORD (SEARCH)

B.5-R.20

Index
File No. K.2-4

(Ref. FSM 7151.4)

Tract or
Survey No. _____
Cor. No. WCMC

T 2N R. 7E R.D. Columbia Gorge County Hood River
Merid. Willamette N.F. Mt. Hood State Oregon

CORNER DIAGRAM

DESCRIBE CORNER MONUMENT FOUND

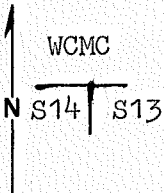

DESCRIBE BEARING TREES OR OTHER OFFICIAL ACCESSORIES FOUND

PHOTO IDENTIFICATION DATA

Photo No. _____
Filed At. _____
Object Ident. _____
Ident. By _____
Signature

DESCRIBE CORNER LOCATION RELATIVE TO NEAR-BY FEATURES, ALSO HOW TO REACH CORNER

From Bridge of Gods follow old Hwy 30 & Frontage road SW to railroad cross tracks and go about 300'-corner is on edge of rip rap bank to river.

PLANE COORDINATE POSITION DATA

State _____ Zone _____
X _____
Y _____
Estab. By _____
Agency

Signature

Title _____ Division _____ Headquarters _____
Land Surveyor

Date 6/87 FS-7100-52 (3/68)

Larry D. M... ..

CORNER RECORD (PERPETUATION)

MONUMENT: DESCRIBE NEW MONUMENT SET, OR WORK DONE TO PRESERVE EXISTING MONUMENT

T2N R7E
 WCMC
 S14 | S13
 LS 896
 1987

Set 2"x30" Gal. steel pipe with a 3" Brass cap 15" in rip rap-
 built mound of stone 4' base to top stamped:

9

ACCESSORIES: DESCRIBE NEW BT'S WITNESS OBJECTS ETC. ESTABLISHED, OR WORK DONE TO PRESERVE EXISTING EVIDENCE

14" D-Fir S46W-81.3' scribed WCMCS13 upper blaze and a lower blaze scribed BT and with
 a 1" Brass disk stamped PLS 896.
 Chisled BXO on top East face 3'x3'x2' boulder S55-30E 9.67' to X.

10

Work Done By Larry D. Bishop Title Surveyor Date 6/87 State Registration No. 896
 or Agency

Certified Cor. Record Prepared? Yes No Filed At: _____ Date _____

11

REMARKS

Set guard post NE with decal survey marker only.
 Nailed 54-4 & BT signs to BT & painted band & blazes red.

12

Index File No. K.2-4 T. 2N R. 7E M. Tract or Surv. No. _____ Cor. WCMC

13

CORNER RECORD (SEARCH)

(Ref. FSM 7151.4)

Index File No. K-21.2

Tract or Survey No. _____ Cor. No. N-1/16

T 2N R. 7E R.D. Columbia Gorge County Hood River

Merid. Willamette N.F. Mt. Hood State Oregon

CORNER DIAGRAM

DESCRIBE CORNER MONUMENT FOUND

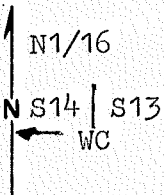

DESCRIBE BEARING TREES OR OTHER OFFICIAL ACCESSORIES FOUND

PHOTO IDENTIFICATION DATA

Photo No. _____
 Filed At. _____
 Object Ident. _____
 Ident. By _____
 Signature _____

DESCRIBE CORNER LOCATION RELATIVE TO NEAR-BY FEATURES, ALSO HOW TO REACH CORNER

From Bridge of Gods follow old Hwy 30 & Frontage road SW to railroad corss tracks and go about 200' - corner is on edge of rip rap bank to river.

PLANE COORDINATE POSITION DATA

State _____ Zone _____
 X _____
 Y _____
 Estab. By _____
 Agency _____

Signature

Title
 Land Surveyor

Division

Headquarters

Date
 6/87

FS-7100-52 (3/68)

Louise D. Buckley

CORNER RECORD (PERPETUATION)

MONUMENT : DESCRIBE NEW MONUMENT SET, OR WORK DONE TO PRESERVE EXISTING MONUMENT

Set 2"x30" Gal. steel pipe with a 3" Brass cap 6" in ground-built mound of stone 5' base to top stamped:

T2N R7E
 N1/16
 ← S14 | S13
 W0
 LS 896
 1987

9

ACCESSORIES : DESCRIBE NEW BT's WITNESS OBJECTS ETC. ESTABLISHED, OR WORK DONE TO PRESERVE EXISTING EVIDENCE

Chisled BXO on top SE corner of a 4'x4'x3' boulder N37-05E-5.06' to X.
 Chisled BXO on top SE corner of a 5'x3'x3' boulder S19-24W-11.70' to X.

10

Work Done By Larry D. Bishop Title Surveyor Date 6/87 State Registration No. 896
 or Agency _____

Certified Cor. Record Prepared ? Yes No Filed At: _____ Date _____

11

REMARKS

Set guard post East with decals 54-2 & survey marker.
 Painted chisled areas red.

12

Index File No. K-21.2 T. 2N R. 7E M. _____ Tract or Surv. No. _____ CorN-1/16

13

Index
File No. K-22

CORNER RECORD (SEARCH)
(Ref. FSM 7151.4)

B. & P. 22

Tract or
Survey No. _____ Cor. No. NW1/16

T 2N R. 7E R.D. Columbia Gorge County Hood River

Merid. Willamette N.F. Mt. Hood State Oregon

CORNER DIAGRAM

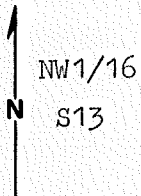

DESCRIBE CORNER MONUMENT FOUND

Unrecorded 1" Iron pipe West 2.0'.

DESCRIBE BEARING TREES OR OTHER OFFICIAL ACCESSORIES FOUND

PHOTO IDENTIFICATION DATA

Photo No. _____
Filed At. _____
Object Ident. _____
Ident. By _____
Signature

DESCRIBE CORNER LOCATION RELATIVE TO NEAR-BY FEATURES, ALSO HOW TO REACH CORNER

Corner is 300' East of I-84 R/W fence about 500' NE of the Cascade Locks exit.

PLANE COORDINATE POSITION DATA

State _____ Zone _____
X _____
Y _____
Estab. By _____
Agency

Long D. Bulaway
Signature

Title
Land Surveyor

Division

Headquarters

Date

7/87

2

3

4

5

CORNER RECORD (PERPETUATION)

MONUMENT : DESCRIBE NEW MONUMENT SET, OR WORK DONE TO PRESERVE EXISTING MONUMENT

Set 2"x30" Gal. steel pipe with a 3" Brass cap 24" in ground
built mound of earth & stone 1½' base to top stamped:

T2N R7E
NW1/16
S13
LS 896
1987

9

ACCESSORIES : DESCRIBE NEW BT'S WITNESS OBJECTS ETC. ESTABLISHED, OR WORK DONE TO PRESERVE EXISTING EVIDENCE

8" D-Fir N1E-17.2' scribed NW1/16S13BT
6" D-Fir S76W-5.7' scribed NW1/16S13BT
Both BT's have a 1" Brass disk stamped PLS 896.

10

Work Done By Larry D. Bishop Title Surveyor Date 7/87 State Registration No. 896
or Agency _____

Certified Cor. Record Prepared ? Yes No Filed At: _____ Date _____ 11

REMARKS

Set guard posts South & West with decals 54-2 & survey marker.
Nailed 54-4 & BT signs to BT's & painted band & blazes red.

12

Index File No. K-22 T. 2N R. 7E M. _____ Tract or Surv. No. _____ Cor. NW1/16 13

CORNER RECORD (PERPETUATION)

MONUMENT : DESCRIBE NEW MONUMENT SET, OR WORK DONE TO PRESERVE EXISTING MONUMENT.

Replaced Iron pipe with a Gal. steel pipe 2"x30" with a 3" Brass cap 26" in ground-built mound of stone & earth 3' base to top.
 Unrecorded 1" Iron pipe S69-10W 42.87'. Buried found pipe next to monument set.

T2N R7E
 C
 N1/16 | S13
 C
 LS 896
 1987

9

ACCESSORIES : DESCRIBE NEW BT'S WITNESS OBJECTS ETC. ESTABLISHED, OR WORK DONE TO PRESERVE EXISTING EVIDENCE

8" D-Fir N29E-20.9' scribed CN1/16S13BT
 20" D-Fir S69E-21.1' scribed CN1/16S13BT
 Both BT's have a 1" Brass disk stamped PLS 896.

10

Work Done By Larry D. Bishop Title Surveyor Date 7/87 State Registration No. 896
 or Agency

Certified Cor. Record Prepared ? Yes No Filed At: _____ Date _____

11

REMARKS

Set guard posts North & South with decals 54-2 & survey marker.
 Nailed 54-4 & BT signs to BT's & painted band & blazes red.

Index File No. K-23 T. 2N R. 7E M. _____ Tract or Surv. No. _____ Cor. CN1/16

12

13

Index
File No. L-21

CORNER RECORD (SEARCH)
(Ref. FSM 7151.4)

Tract or
Survey No. _____ Cor. No. 1/4

T 2N R. 7E R.D. Columbia Gorge County Hood River

Merid. Willamette N.F. Mt. Hood State Oregon

CORNER DIAGRAM

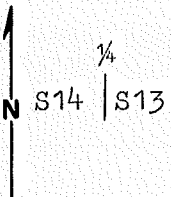

DESCRIBE CORNER MONUMENT FOUND U.S.A.E. 3" Brass capped pipe,
Monument is in R/W fence line radial to centerline 1/4
on right of I-84 stamped: S14 | S13
1935

DESCRIBE BEARING TREES OR OTHER OFFICIAL ACCESSORIES FOUND
Orig. 8" now 20" sawed, rotted D-Fir stump N80W-27.7' (record N84 1/2W) no marks remain.
Reference trees by Powers 24" Fir now 14" D-Fir S71E-43.0' no marks. 12" Fir now 30" D-Fir S5E-61.3' no marks.
Believe Powers reversed tree sizes (record bearings S10-50E & S76-36E).

PHOTO IDENTIFICATION DATA
Photo No. _____
Filed At. _____
Object Ident. _____
Ident. By _____
Signature

DESCRIBE CORNER LOCATION RELATIVE TO NEAR-BY FEATURES, ALSO HOW TO REACH CORNER
Corner is 1 foot SW of I-84 R/W fence 12' SE of angle corner.

PLANE COORDINATE POSITION DATA
State _____ Zone _____
X _____
Y _____
Estab. By _____
Agency

Signature Jerry D. Durbin Title Land Surveyor Division _____ Headquarters _____ Date 7/87 FS-7100-52 (3/68)

CORNER RECORD (PERPETUATION)

MONUMENT : DESCRIBE NEW MONUMENT SET, OR WORK DONE TO PRESERVE EXISTING MONUMENT

9

ACCESSORIES : DESCRIBE NEW BT'S WITNESS OBJECTS ETC. ESTABLISHED, OR WORK DONE TO PRESERVE EXISTING EVIDENCE

10" D-Fir N63E-14.7' scribed 1/4S13BT and with a 1" Brass disk stamped PLS 896.
SHRW pin 1.3' SW of fence corner N58°24'38"W 8.43'.

10

Work Done By Larry D. Bishop Title Surveyor Date 7/87 State Registration No. 896
or Agency

Certified Cor. Record Prepared ? Yes No Filed At: _____ Date _____

11

REMARKS

Set guard post NE with decal survey marker only.

12

Index File No. L-21 T. 2N R. 7E M. Tract or Surv. No. _____ Cor. 1/4

13

Index
 File No. L-22
 T 2N R. 7E
 Merid. Willamette

CORNER RECORD (SEARCH)

(Ref. FSM 7151.4)

Tract or Survey No. _____ Cor. No. CW1/16
 R.D. Columbia Gorge County Hood River
 N.F. Mt. Hood State Oregon

CORNER DIAGRAM

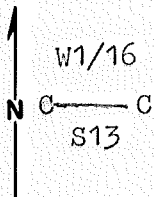

DESCRIBE CORNER MONUMENT FOUND

DESCRIBE BEARING TREES OR OTHER OFFICIAL ACCESSORIES FOUND

DESCRIBE CORNER LOCATION RELATIVE TO NEAR-BY FEATURES, ALSO HOW TO REACH CORNER

Corner is 1000' West of road to BPA powerline at metal gate & posted line.

PHOTO IDENTIFICATION DATA

Photo No. _____
 Filed At. _____
 Object Ident. _____
 Ident. By _____
Signature

PLANE COORDINATE POSITION DATA

State _____ Zone _____
 X _____
 Y _____
 Estab. By _____
Agency

Signature
Larry D. B. [unclear]

Title
 Land Surveyor

Division

Headquarters

Date

7/87

FS-7100-52 (3/68)

CORNER RECORD (PERPETUATION)

MONUMENT : DESCRIBE NEW MONUMENT SET, OR WORK DONE TO PRESERVE EXISTING MONUMENT

Set 2"x30" Gal steel pipe with a 3" Brass cap 20" in ground-built mound of earth & stone 3' base to top stamped:

T2N R7E
W1/16
C— C
S13
LS 896
1987

9

ACCESSORIES : DESCRIBE NEW BT'S WITNESS OBJECTS ETC. ESTABLISHED, OR WORK DONE TO PRESERVE EXISTING EVIDENCE

16" D-Fir N69W-17.1' scribed CW1/16S13BT
20" D-Fir S6½E-32.6' scribed CW1/16S13BT
Both BT's have a 1" Brass disk stamped PLS 896.

10

Work Done By Larry D. Bishop Title Surveyor Date 7/87 State Registration No. 896
or Agency _____

Certified Cor. Record Prepared ? Yes No Filed At: _____ Date _____

11

REMARKS

Set guard posts North & East with decals 54-2 & survey marker.
Nailed 54-4 & BT signs to BT's & painted band & blazes red.

Index File No. L-22 T. 2N R. 7E M. _____ Tract or Surv. No. _____ Cor. CW1/16

12

13

Index
 File No. L-23
 T 2N R. 7E
 Merid. Williamette

CORNER RECORD (SEARCH)

(Ref. FSM 7151.4)

R.D. Columbia Gorge County Hood River
 N.F. Mt. Hood State Oregon

Tract or
 Survey No. _____
 Cor. No. C 1/4

B.L.P. 21

CORNER DIAGRAM

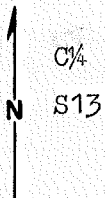

DESCRIBE CORNER MONUMENT FOUND

2

DESCRIBE BEARING TREES OR OTHER OFFICIAL ACCESSORIES FOUND

3

PHOTO IDENTIFICATION DATA

Photo No. _____
 Filed At. _____
 Object Ident. _____
 Ident. By _____
Signature

6

DESCRIBE CORNER LOCATION RELATIVE TO NEAR-BY FEATURES, ALSO HOW TO REACH CORNER

Corner is 350' East of road to BPA line at metal gate & posted line.

PLANE COORDINATE POSITION DATA

State _____ Zone _____
 X _____
 Y _____
 Estab. By _____
Agency

8

Signature
Long D. ...

Title
 Land Surveyor

Division
 Headquarters

Date 7/87 FS-7100-52 (3/68)

4

5

CORNER RECORD (PERPETUATION)

MONUMENT : DESCRIBE NEW MONUMENT SET, OR WORK DONE TO PRESERVE EXISTING MONUMENT

Set 2"x30" Gal. steel pipe with a 3" Brass cap 20" in ground-built mound of earth & stone 4' base to top stamped:

T2N R7E
C³/₄
S13
LS 896
1987

9

ACCESSORIES : DESCRIBE NEW BT'S WITNESS OBJECTS ETC. ESTABLISHED, OR WORK DONE TO PRESERVE EXISTING EVIDENCE

30" D-Fir N7¹/₄E-44.1' scribed S¹/₄S13BT
24" D-Fir S7⁷/₈E-14.2' scribed C¹/₄S13BT
Both BT's have a 1" Brass disk stamped PLS 896.

10

Work Done By Larry D. Bishop Title Surveyor Date 7/87 State Registration No. 896
or Agency _____

Certified Cor. Record Prepared ? Yes No ^X Filed At: _____ Date _____

11

REMARKS

Set guard posts North & West with decals 54-2 & survey amrker.
Nailed 54-4 & BT signs to BT's & painted band & blazes red.

12

Index File No. L-23 T. 2N R. 7E M. _____ Tract or Surv. No. _____ Cor. C³/₄

13

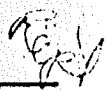

Index File No. N 17
T 2 N R. 7 E
Merid. WM

CORNER RECORD (SEARCH)

Tract or Survey No. _____
County Multnomah
State Oregon

R.D. _____
N.F. Mt. Hood

Cor. No. _____

CORNER DIAGRAM

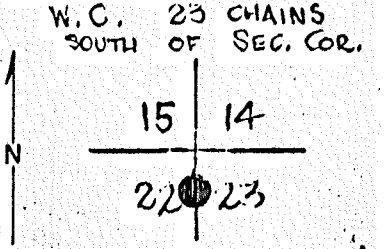

DESCRIBE CORNER MONUMENT FOUND
Found $1\frac{1}{2}$ " B.I.P. with brass cap set by U.S.E.D. 1934 for witness corner. O.K. Rereferenced.
 $1/16$ Cor. $1\frac{1}{2}$ " G.I.P. with brass cap in concrete collar hit. We straightened up. N $0^{\circ} 13' 30''$ E 197.92'

DESCRIBE BEARING TREES OR OTHER OFFICIAL ACCESSORIES FOUND
Found $4\frac{1}{4}$ " Crazy Fir scribed C.S.B.T. with R.R.S. & Scribed W.C. on bark. S $72^{\circ} 39' 30''$ E 29.67'
Found 11" Fir scribed C.S.B.T. with R.R.S. S $67^{\circ} 38' 30''$ W 40.99'
Found Bonser's 1" I.P. Rp. to end N $10^{\circ} 53' 30''$ W 77.26'

PHOTO IDENTIFICATION DATA

Photo No. _____
Filed At. _____
Object Ident. _____
Ident. By _____
Signature

DESCRIBE CORNER LOCATION RELATIVE TO NEAR-BY FEATURES, ALSO HOW TO REACH CORNER

PLANE COORDINATE POSITION DATA

State _____ Zone _____
X _____
Y _____
Estab. By _____
Agency

Signature _____ Title _____ Division _____ Headquarters _____ Date _____

CORNER RECORD (PERPETUATION)

MONUMENT: DESCRIBE NEW MONUMENT SET, OR WORK DONE TO PRESERVE EXISTING MONUMENT

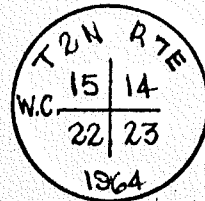

ACCESSORIES DESCRIBE NEW BT's WITNESS OBJECTS ETC. ESTABLISHED, OR WORK DONE TO PRESERVE EXISTING EVIDENCE

Work Done By Clair Pense Title County Surveyor Date 5/25/64 State Registration No. or Agency _____

Certified Cor. Record Prepared? Yes No Filed At: _____ Date _____

REMARKS

Index File No. T. R. M. Tract or Surv. No. Cor.

N-17

P 9. 2 @

FB 1958 D

Barrers' 1" I.P. RR to end of road old Columbia Riv. HWY.

W.C. 23.00 chs. South
Sec. Cor. $\begin{matrix} 19 \\ 22 \\ 23 \end{matrix}$ 2N 7E

W.C. Set by Army Engrs. 1934

2.1730 W.M.

15.7 L

MULTNOMAH 198.00' CO. HOOD RIVER

1 1/2" G.I.P. w/brass cap set by U.S.E.D.

772 ± 61.7

East end Multn. Co. sect. col. R. HWY &

Brg's staff compass
Var. 19°30'
Slope shots clino.

S. 66° W. 41.21'

Scribed 10" fir
CSBT, drove RR.S.

S. 73° E. 30.77'

42" crazy
fir scribed
CSBT. Drove
RR.S. scribed
W.C. on bark.

SEPT. 15, 1958



This is in slide area
steep North slope

Referenced

Find 1 1/2" G.I.P. w/brass cap set by U.S.E.D. 1934
Original G.I.P. - B.T.S.
Now no evidence of

S.O.

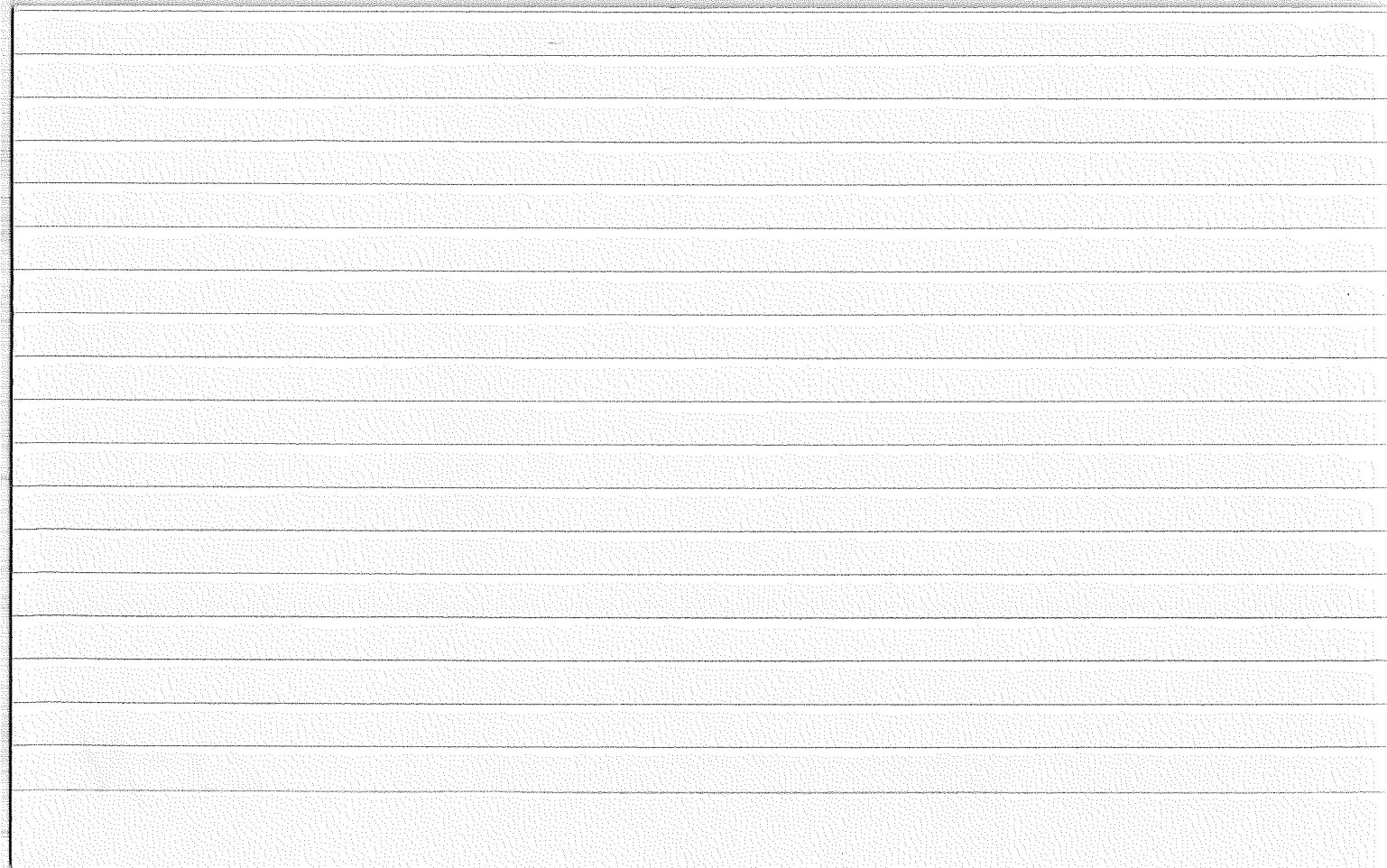

FROM BPA DWG BONNEVILLE-TREDALES

Index
File No. _____

CORNER RECORD (SEARCH)
(Ref. FSM 7151.4)

3 DEC 84

Tract or Survey No. _____
Cor. No. N-17
LINE
W.C.

T 2N. R. 7E.
Merid. WM.

R.D. _____ County MULT. & Hood Co.
N.F. ORGNSA State OREGON

CORNER DIAGRAM

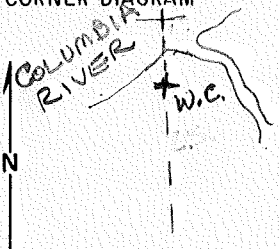

DESCRIBE CORNER MONUMENT FOUND

U.S.E.D. MON.
W.C. TO $\frac{1514}{2223}$ WHICH IS IN RIVER

DESCRIBE BEARING TREES OR OTHER OFFICIAL ACCESSORIES FOUND

PHOTO IDENTIFICATION DATA

Photo No. _____
Filed At. _____
Object Ident. _____
Ident. By _____
Signature

DESCRIBE CORNER LOCATION RELATIVE TO NEAR-BY FEATURES, ALSO HOW TO REACH CORNER

PLANE COORDINATE POSITION DATA

State _____ Zone _____
X _____
Y _____
Estab. By _____
Agency

Signature _____ Title _____ Division _____ Headquarters _____ Date _____ FS-7100-52 (3/68)

From BPA DWG BONNEVILLE-DALLES LANG
3 DEC 84

Index File No. _____

CORNER RECORD (SEARCH)
(Ref. FSM 7151.4)

Tract or Survey No. _____
Cor. No. N-19

T 2 N. R. 7 E.

R.D. _____ County HOOD RIVER

Merid. W.M.

N.F. CRGNSA State OREGON

CORNER DIAGRAM

DESCRIBE CORNER MONUMENT FOUND

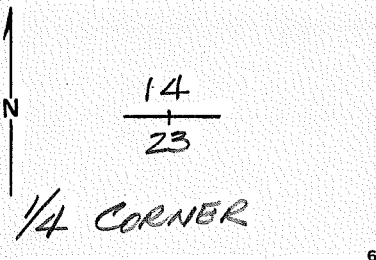

U.S.E.D. Mon.

DESCRIBE BEARING TREES OR OTHER OFFICIAL ACCESSORIES FOUND

PHOTO IDENTIFICATION DATA

Photo No. _____
Filed At. _____
Object Ident. _____
Ident. By _____
Signature

PLANE COORDINATE POSITION DATA

State _____ Zone _____
X _____
Y _____
Estab. By _____
Agency

DESCRIBE CORNER LOCATION RELATIVE TO NEAR-BY FEATURES, ALSO HOW TO REACH CORNER

Signature

Title

Division

Headquarters

Date

FS-7100-52 (3/68)

CORNER RECORD (PERPETUATION)

MONUMENT: DESCRIBE NEW MONUMENT SET, OR WORK DONE TO PRESERVE EXISTING MONUMENT

9

ACCESSORIES : DESCRIBE NEW BT'S WITNESS OBJECTS ETC. ESTABLISHED, OR WORK DONE TO PRESERVE EXISTING EVIDENCE

10

Work Done By _____ Title _____ Date _____ State Registration No. or Agency _____

Certified Cor. Record Prepared ? Yes No Filed At: _____ Date _____

REMARKS

12

Index File No. T. R. M. Tract or Surv. No. Cor. _____

13

CORNER RECORD (PERPETUATION)

MONUMENT: DESCRIBE NEW MONUMENT SET, OR WORK DONE TO PRESERVE EXISTING MONUMENT

9

ACCESSORIES : DESCRIBE NEW BT'S WITNESS OBJECTS ETC. ESTABLISHED, OR WORK DONE TO PRESERVE EXISTING EVIDENCE

10

Work Done By _____ **Title** _____ **Date** _____ **State Registration No. or Agency** _____

Certified Cor. Record Prepared ? Yes No **Filed At:** _____ **Date** _____ 11

REMARKS

12

Index File No. **T.** **R.** **M.** **Tract or Surv. No.** **Cor.** 13

Index
File No. N-21

CORNER RECORD (SEARCH)

(Ref. FSM 7151.4)

Tract or
Survey No. _____

Cor.
No. Section

T 2N R. 7E

R.D. Columbia Gorge County Hood River

Merid. Willamette

N.F. Mt. Hood State Oregon

CORNER DIAGRAM

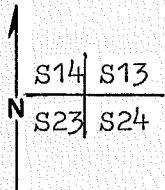

DESCRIBE CORNER MONUMENT FOUND

U.S.A.E. Brass capped pipe - 2'x2'x2'
stone mound.

Stamped:

S14	S13
S23	S24
1934	

DESCRIBE BEARING TREES OR OTHER OFFICIAL ACCESSORIES FOUND

Unrecorded 14" D-Fir N14W-13.4' healed blaze.

PHOTO IDENTIFICATION DATA

Photo No. _____
Filed At. _____
Object Ident. _____
Ident. By _____
Signature

DESCRIBE CORNER LOCATION RELATIVE TO NEAR-BY FEATURES, ALSO HOW TO REACH CORNER

Corner is 660' South of B.P.A. power line at station 170+23.

PLANE COORDINATE POSITION DATA

State _____ Zone _____
X _____
Y _____
Estab. By _____
Agency

Signature _____

Title Land Surveyor Division _____

Headquarters _____

Date 6/87 FS-7100-52 (3/68)

CORNER RECORD (PERPETUATION)

MONUMENT: DESCRIBE NEW MONUMENT SET, OR WORK DONE TO PRESERVE EXISTING MONUMENT

9

ACCESSORIES : DESCRIBE NEW BT'S WITNESS OBJECTS ETC. ESTABLISHED, OR WORK DONE TO PRESERVE EXISTING EVIDENCE

18" Fir S31E-19.19' scribed S24BT
20" Fir S54W-32.92' scribed S23BT
14" D-Fir N34W-40.00' scribed S13BT

All three BT's have a 1" Brass disk stamped PLS 896.

10

Work Done By Larry D. Bishop Title Surveyor Date 6/87 State Registration No. 896
or Agency

Certified Cor. Record Prepared ? Yes No Filed At: _____ Date _____

11

REMARKS

Set guard posts with decal survey markers.
Nailed 54-4 & BT signs to BT's & painted band & blazes red.

12

Index File No. N-21 T. 2N R. 7E M. Tract or Surv. No. _____ Cor. Section 13

Prop. Corner C.S. REPORTED

Index File No. 0 16

CORNER RECORD (SEARCH)

Tract or Survey No. _____

Cor. No. _____

T 2 N R. 7 E

R.D. _____ County Multnomah

Merid. WM

N.F. Mt. Hood State Oregon

CORNER DIAGRAM

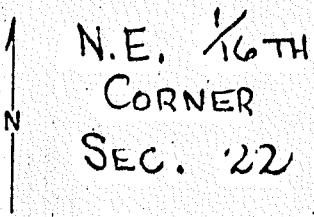

DESCRIBE CORNER MONUMENT FOUND

Found 1 1/2" GIP with brass cap stamped "NE 1/16th S 22 U.S. Army Engineers!"

DESCRIBE BEARING TREES OR OTHER OFFICIAL ACCESSORIES FOUND

Fd. old 1" GIP N 13° 42' E 17.69'
Fd. 3/4" I.P. with brass cap G.L.O. South 77.37' S1 32° 24'
Fd. 3/4" I.P. with B. Cap G.L.O. N 87° 47' W 26.71'

PHOTO IDENTIFICATION DATA

Photo No. _____
Filed At. _____
Object Ident. _____
Ident. By _____
Signature

DESCRIBE CORNER LOCATION RELATIVE TO NEAR-BY FEATURES, ALSO HOW TO REACH CORNER

PLANE COORDINATE POSITION DATA

State _____ Zone _____
X _____
Y _____
Estab. By _____
Agency

Signature

Title

Division

Headquarters

Date

7100-52

REV. 65

CORNER RECORD (PERPETUATION)

MONUMENT: DESCRIBE NEW MONUMENT SET, OR WORK DONE TO PRESERVE EXISTING MONUMENT

RP'd & set white post with yellow tag at corner.

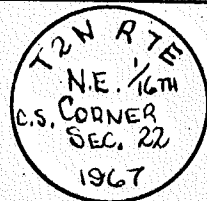

ACCESSORIES DESCRIBE NEW BT'S WITNESS OBJECTS ETC. ESTABLISHED, OR WORK DONE TO PRESERVE EXISTING EVIDENCE

Scribed 6" Oak middle one of three CSBT & Drove R.R.S. N 30° 11' E 25.41'
Drove R.R.S. in old scribed blaze now 13" Fir S. 24° 58' W 25.32'

Work Done By P.C. Northrop Title Director of P.W. Date 3/3/67 State Registration No. _____
or Agency _____

Certified Cor. Record Prepared? Yes No Filed At: _____ Date _____

REMARKS

From BPA DWG BONNEVILLE-THE DALLES
3 DEC 84 LINE

USDA-FOREST SERVICE GPO 940-117

Index
File No. _____

CORNER RECORD (SEARCH)
(Ref. FSM 7151.4)

Tract or
Survey No. _____ Cor.
No. 0-17

T 2N R. 7E.

R.D. _____ County MULT. & Hood Co.

Merid. WM

N.F. CRGNSA State OREGON

CORNER DIAGRAM

DESCRIBE CORNER MONUMENT FOUND

U.S.E.D. MON.

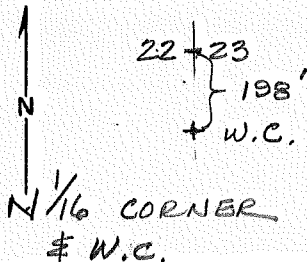

DESCRIBE BEARING TREES OR OTHER OFFICIAL ACCESSORIES FOUND

PHOTO IDENTIFICATION DATA

Photo No. _____
Filed At. _____
Object Ident. _____
Ident. By _____
Signature

DESCRIBE CORNER LOCATION RELATIVE TO NEAR-BY FEATURES, ALSO HOW TO REACH CORNER

PLANE COORDINATE POSITION DATA

State _____ Zone _____
X _____
Y _____
Estab. By _____
Agency

Signature

Title

Division

Headquarters

Date

FS-7100-52 (3/68)

CORNER RECORD (PERPETUATION)

MONUMENT: DESCRIBE NEW MONUMENT SET, OR WORK DONE TO PRESERVE EXISTING MONUMENT

ACCESSORIES : DESCRIBE NEW BT's WITNESS OBJECTS ETC. ESTABLISHED, OR WORK DONE TO PRESERVE EXISTING EVIDENCE

Work Done By _____ **Title** _____ **Date** _____ **State Registration No.**
or Agency _____

Certified Cor. Record Prepared ? Yes No **Filed At:** _____ **Date** _____

REMARKS

Index File No. **T.** **R.** **M.** **Tract or Surv. No.** **Cor.**

From BPA DWG BONNEVILLE-THO DALLEES
3 DEC 84 LINE

Index
File No. _____

CORNER RECORD (SEARCH)
(Ref. FSM 7151.4)

Tract or
Survey No. 1

Cor.
No. P-17

T 2N R. 7E.

R.D. _____

County MULTNOMAH & Hood Co.

Merid. WM

N.F. CRGNSA

State OREGON

CORNER DIAGRAM

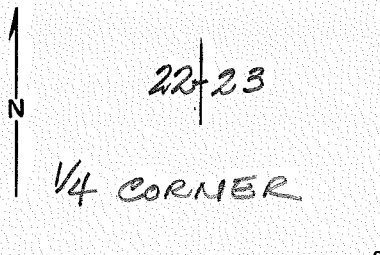

DESCRIBE CORNER MONUMENT FOUND

U.S.E.D. MON.

DESCRIBE BEARING TREES OR OTHER OFFICIAL ACCESSORIES FOUND

PHOTO IDENTIFICATION DATA

Photo No. _____

Filed At. _____

Object Ident. _____

Ident. By _____

Signature

PLANE COORDINATE POSITION DATA

State _____ Zone _____

X _____

Y _____

Estab. By _____

Agency

Signature

Title

Division

Headquarters

Date

FS-7100-52 (3/68)

CORNER RECORD (PERPETUATION)

MONUMENT: DESCRIBE NEW MONUMENT SET, OR WORK DONE TO PRESERVE EXISTING MONUMENT

9

ACCESSORIES : DESCRIBE NEW BT'S WITNESS OBJECTS ETC. ESTABLISHED, OR WORK DONE TO PRESERVE EXISTING EVIDENCE

10

Work Done By _____ **Title** _____ **Date** _____ **State Registration No. or Agency** _____

Certified Cor. Record Prepared ? Yes No **Filed At:** _____ **Date** _____ 11

REMARKS

12

Index File No. **T.** **R.** **M.** **Tract or Surv. No.** **Cor,** 13

Prop. Corrid. O.S.

REPORTED

Index File No. R 11

CORNER RECORD (SEARCH)

Tract or Survey No. _____
Cor. No. _____

T 2 N R. 7 E

R.D. _____ County Multnomah

Merid. WM

N.F. Mt. Hood State Oregon

CORNER DIAGRAM

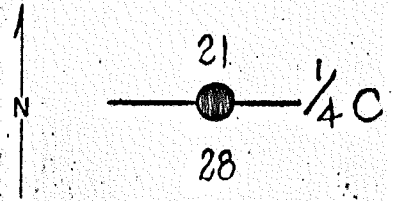

DESCRIBE CORNER MONUMENT FOUND
Original corner was destroyed in road construction.

DESCRIBE BEARING TREES OR OTHER OFFICIAL ACCESSORIES FOUND

PHOTO IDENTIFICATION DATA

Photo No. _____
Filed At. _____
Object Ident. _____
Ident. By _____
Signature

DESCRIBE CORNER LOCATION RELATIVE TO NEAR-BY FEATURES, ALSO HOW TO REACH CORNER

PLANE COORDINATE POSITION DATA

State _____ Zone _____
X _____
Y _____
Estab. By _____
Agency

Signature _____ Title _____ Division _____ Headquarters _____ Date _____

CORNER RECORD (PERPETUATION)

MONUMENT: DESCRIBE NEW MONUMENT SET, OR WORK DONE TO PRESERVE EXISTING MONUMENT

Set 42" Con. Mon. at corner. Stamped, Rpd and set white post & yellow tag.

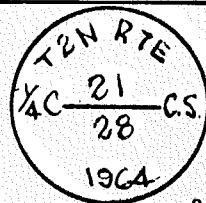

ACCESSORIES DESCRIBE NEW BT'S WITNESS OBJECTS ETC. ESTABLISHED, OR WORK DONE TO PRESERVE EXISTING EVIDENCE

Drove $\frac{1}{2}$ " x 15" GIP and set B.S. in it. in ϕ of R.R. Track N $40^{\circ} 17'$ W 189.32'

Drove $\frac{3}{4}$ x 36" GIP 10' + from ϕ of 1st track of R.R. Track N $40^{\circ} 17'$ W 163.56'

Set P.B.S. in curb of new road N $40^{\circ} 17'$ W 34.82'

Set P.B.S. in curb of new Columbia River Highway S $40^{\circ} 17'$ E 42.32'

Work Done By Clair Pense Title County Surveyor Date 5/21/64 State Registration No. _____ or Agency _____

Certified Cor. Record Prepared? Yes No Filed At: _____ Date _____

REMARKS

Prop. Cor.

REPORTED

Index File No. R 12

CORNER RECORD (SEARCH)

Tract or Survey No. _____
Cor. No. _____

T 2 N R. 7 E

R.D. _____ County Multnomah

Merid. WM

N.F. Mt. Hood State Oregon

CORNER DIAGRAM

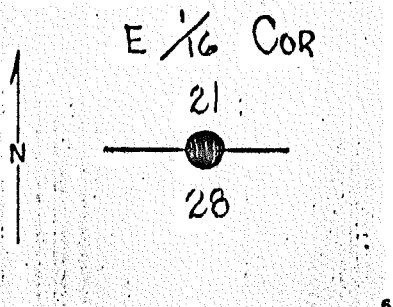

DESCRIBE CORNER MONUMENT FOUND

Found $1\frac{1}{2}$ " G.I.P. with brass cap set by U.S.E.D. 1934 for 1/16th corner. Checked good to $\frac{1}{4}$ Cor. to the West

DESCRIBE BEARING TREES OR OTHER OFFICIAL ACCESSORIES FOUND

Found 44" fir blazed & scribed 1/16 S21 BT. We drove R.R.S. & nailed yellow tag - N $1^{\circ} 45'$ E 22.60'

PHOTO IDENTIFICATION DATA

Photo No. _____
Filed At. _____
Object Ident. _____
Ident. By _____
Signature

DESCRIBE CORNER LOCATION RELATIVE TO NEAR-BY FEATURES, ALSO HOW TO REACH CORNER

PLANE COORDINATE POSITION DATA

State _____ Zone _____
X _____
Y _____
Estab. By _____
Agency

Signature _____ Title _____ Division _____ Headquarters _____ Date _____

CORNER RECORD (PERPETUATION)

MONUMENT: DESCRIBE NEW MONUMENT SET, OR WORK DONE TO PRESERVE EXISTING MONUMENT

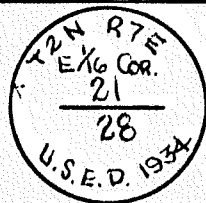

ACCESSORIES DESCRIBE NEW BT'S WITNESS OBJECTS ETC. ESTABLISHED, OR WORK DONE TO PRESERVE EXISTING EVIDENCE.
 Scribed 22" Fir C.S.B.T. & Drove R.R.S. N 84° 57' E 32.70'
 Drove 3/4" x 36" G.I.P. S 1° 45' W 5.51'
 Scribed 1 1/4" Maple C.S.B.T. & Drove R.R.S. & nailed yellow tag S 51° 29' W 33.87'

Work Done By Clair Pense Title County Surveyor Date 5/25/64 State Registration No. _____
 or Agency _____

Certified Cor. Record Prepared ? Yes No Filed At: _____ Date _____

REMARKS

Index File No. T. R. M. Tract or Surv. No. Cor.

Index
File No. _____

CORNER RECORD (SEARCH)
(Ref. FSM 7151.4)

Tract or
Survey No. _____ Cor. No. R-13

T ZN R. 7E
Merid. WM

R.D. _____ County MULTNOMAH
N.F. CRGNSA State OREGON

CORNER DIAGRAM

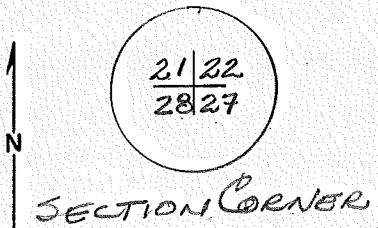

DESCRIBE CORNER MONUMENT FOUND

BRASS CAP
OREGON - N. ZONE CO-ORD.
Y = 720177.0
X = 1631224.2

DESCRIBE BEARING TREES OR OTHER OFFICIAL ACCESSORIES FOUND

PHOTO IDENTIFICATION DATA

Photo No. _____
Filed At. _____
Object Ident. _____
Ident. By _____
Signature

DESCRIBE CORNER LOCATION RELATIVE TO NEAR-BY FEATURES, ALSO HOW TO REACH CORNER

PLANE COORDINATE POSITION DATA

State _____ Zone _____
X _____
Y _____
Estab. By _____
Agency

Signature

Title

Division

Headquarters

Date

FS-7100-52 (3/68)

CORNER RECORD (PERPETUATION)

MONUMENT: DESCRIBE NEW MONUMENT SET, OR WORK DONE TO PRESERVE EXISTING MONUMENT

9

ACCESSORIES : DESCRIBE NEW BT's WITNESS OBJECTS ETC. ESTABLISHED, OR WORK DONE TO PRESERVE EXISTING EVIDENCE

10

Work Done By _____ **Title** _____ **Date** _____ **State Registration No. or Agency** _____

Certified Cor. Record Prepared ? Yes No **Filed At:** _____ **Date** _____ 11

REMARKS

12

Index File No. **T.** **R.** **M.** **Tract or Surv. No.** **Cor.** 13

Freop. Cozen. O.S.

REPORTED

215

Index
File No. T 7
T 2 N R. 7 E
Merid. WM

CORNER RECORD (SEARCH) Tract or
Survey No. _____ Cor. No. _____
County Multnomah
N.F. Mt. Hood State Oregon

CORNER DIAGRAM

N
↑
CENTER SECTION
1/4
29

DESCRIBE CORNER MONUMENT FOUND
Found 1/2" x 43" G.I.P. This I.P. being used by Land T.O.D. for center of section. Found this corner by retracing Old Columbia River Hwy tie in 1916 by Bonser. Old fence runs south from Hwy. Checked good with Bonser's tie.

DESCRIBE BEARING TREES OR OTHER OFFICIAL ACCESSORIES FOUND

PHOTO IDENTIFICATION DATA
Photo No. _____
Filed At. _____
Object Ident. _____
Ident. By _____
Signature

DESCRIBE CORNER LOCATION RELATIVE TO NEAR-BY FEATURES, ALSO HOW TO REACH CORNER

PLANE COORDINATE POSITION DATA
State _____ Zone _____
X _____
Y _____
Estab. By _____
Agency

Signature _____ Title _____ Division _____ Headquarters _____ Date _____

CORNER RECORD (PERPETUATION)

MONUMENT: DESCRIBE NEW MONUMENT SET, OR WORK DONE TO PRESERVE EXISTING MONUMENT

Set 42" Con. Mon. References as per sketch. Stamped. Set sq. obscure 4/5 bottle underneath at exact point.

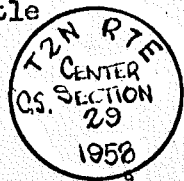

ACCESSORIES DESCRIBE NEW BT'S WITNESS OBJECTS ETC. ESTABLISHED, OR WORK DONE TO PRESERVE EXISTING EVIDENCE

Scribed 26" Fir C.S.B.T. Drove R.R.S. N 13° 30' W 20.91'

Scribed 30" Fir C.S.B.T. Drove R.R.S. N 42° 10' E 26.40'

Scribed 14" Fir C.S.B.T. Drove R.R.S. N 78° 35' W 28.00'

Placed nail and shiner at sta. 79+99.34 of New Col. Rv. Hwy. N 71° 09' E 34.60'

10

Work Done By Donald Ewing Title County Surveyor Date 10/27/58 State Registration No. _____
or Agency _____

Certified Cor. Record Prepared? Yes No Filed At: _____ Date _____

11

REMARKS

12

Index File No. T. R. M. Tract or Surv. No. Cor.

13

Cont. Case, C.S. REPORTED

Teik

Index File No. T 9

CORNER RECORD (SEARCH)

Tract or Survey No. _____ Cor. No. _____

T 2 N R. 7 E

R.D. _____ County Multnomah

Merid. WM

N.F. Mt. Hood State Oregon

CORNER DIAGRAM

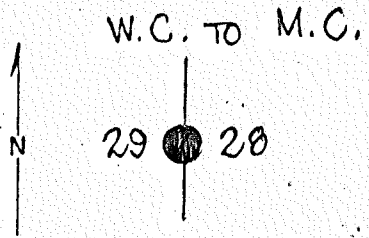

DESCRIBE CORNER MONUMENT FOUND

Found Con. Mon. slipping down the hill. (Ground bad 30% slope)

2

DESCRIBE BEARING TREES OR OTHER OFFICIAL ACCESSORIES FOUND

Fd. 72" Fir scribed C.S.B.T. with R.R.S. - also WC in bark

N 20° 32' E 81.86'

Fd. 66" Fir scribed C.S.B.T. with R.R.S. S 73° 10' W 81.17'

3

PHOTO IDENTIFICATION DATA

Photo No. _____

Filed At. _____

Object Ident. _____

Ident. By _____

Signature

7

DESCRIBE CORNER LOCATION RELATIVE TO NEAR-BY FEATURES, ALSO HOW TO REACH CORNER

PLANE COORDINATE POSITION DATA

State _____ Zone _____

X _____

Y _____

Estab. By _____

Agency

8

4

Signature

Title

Division

Headquarters

Date

7100-52

REV. 65 5

CORNER RECORD (PERPETUATION)

MONUMENT: DESCRIBE NEW MONUMENT SET, OR WORK DONE TO PRESERVE EXISTING MONUMENT

Reset Con. Mon. from evidence on ground. 3' boulder underneath. Shortened 42" C.M. 1".

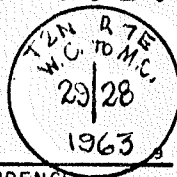

ACCESSORIES DESCRIBE NEW BT'S WITNESS OBJECTS ETC. ESTABLISHED, OR WORK DONE TO PRESERVE EXISTING EVIDENCE

Set 3/4" x 36" G.I.P. N 20° 32' E 17.10'

Scribed 13" Maple C.S.B.T. - Drove R.R.S. (SWly, 1 of 2) N 57° 43' E 16.49'

Drove 3/4 x 36" G.I.P. S 20° 32' W 5.29'

10

Work Done By. Clair Pense Title County Surveyor Date 8/30/63 State Registration No. or Agency _____

Certified Cor. Record Prepared ? Yes No Filed At: _____ Date _____ 11

REMARKS

12

Index File No. T. R. M. Tract or Surv. No. Cor. 13

From BPA DWG HANFORD-OSTRANDER
27 DEC 84

Index _____
File No. _____

CORNER RECORD (SEARCH)
(Ref. FSM 7151.4)

Tract or Survey No. _____
Cor. No. T-13

T 2N R. 7E

R.D. _____ County MULTNOMAH

Merid. WM

N.F. CRGNSA State OREGON

CORNER DIAGRAM

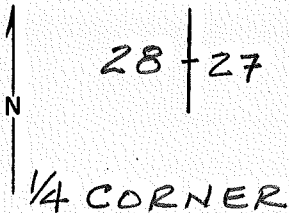

DESCRIBE CORNER MONUMENT FOUND

STONE
Y 717549.6
X 1631173.1

2

DESCRIBE BEARING TREES OR OTHER OFFICIAL ACCESSORIES FOUND

3

PHOTO IDENTIFICATION DATA

Photo No. _____
Filed At. _____
Object Ident. _____
Ident. By _____

Signature

6

DESCRIBE CORNER LOCATION RELATIVE TO NEAR-BY FEATURES, ALSO HOW TO REACH CORNER

PLANE COORDINATE POSITION DATA

State _____ Zone _____
X _____
Y _____
Estab. By _____

Agency

8

4

Signature

Title

Division

Headquarters

Date

FS-7100-52 (3/68)

CORNER RECORD (PERPETUATION)

MONUMENT: DESCRIBE NEW MONUMENT SET, OR WORK DONE TO PRESERVE EXISTING MONUMENT

ACCESSORIES : DESCRIBE NEW BT's WITNESS OBJECTS ETC. ESTABLISHED, OR WORK DONE TO PRESERVE EXISTING EVIDENCE

Work Done By _____ Title _____ Date _____ State Registration No. or Agency _____

Certified Cor. Record Prepared ? Yes No Filed At: _____ Date _____

REMARKS

Index File No. T. R. M. Tract or Surv. No. Cor. _____

FROM BPA DWG HANFORD-OSTRANDER 1
27 DEC 84

Index
File No. _____
T 2N R. 7E
Merid. W.M.

CORNER RECORD (SEARCH)
(Ref. FSM 7151.4)

Tract or
Survey No. _____
Cor. No. V-13

R.D. _____ County MULTNOMAH
N.F. CRGNSA State OREGON

CORNER DIAGRAM

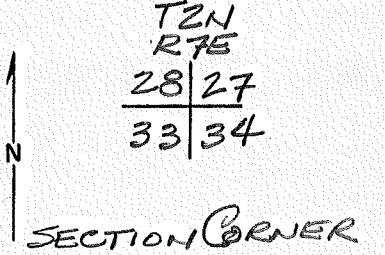

DESCRIBE CORNER MONUMENT FOUND

STONE
Y 714900.5
X 1631121.3

DESCRIBE BEARING TREES OR OTHER OFFICIAL ACCESSORIES FOUND

6

PHOTO IDENTIFICATION DATA

Photo No. _____
Filed At. _____
Object Ident. _____
Ident. By _____
Signature

DESCRIBE CORNER LOCATION RELATIVE TO NEAR-BY FEATURES, ALSO HOW TO REACH CORNER

7

PLANE COORDINATE POSITION DATA

State _____ Zone _____
X _____
Y _____
Estab. By _____
Agency

8

Signature _____ Title _____ Division _____ Headquarters _____ Date _____ FS-7100-52 (3/68)

CORNER RECORD (PERPETUATION)

MONUMENT: DESCRIBE NEW MONUMENT SET, OR WORK DONE TO PRESERVE EXISTING MONUMENT

9

ACCESSORIES : DESCRIBE NEW BT's WITNESS OBJECTS ETC. ESTABLISHED, OR WORK DONE TO PRESERVE EXISTING EVIDENCE

10

Work Done By _____ Title _____ Date _____ State Registration No. or Agency _____

Certified Cor. Record Prepared ? Yes No Filed At: _____ Date _____ 11

REMARKS

12

Index File No. T. R. M. Tract or Surv. No. Cor. 13

Prop. REPORTED

PROPERTY CORNER
Cor. No.

Regd

Index File No. 25 X-1

CORNER RECORD (SEARCH)

Tract or Survey No.

T 2 N R. 7 E

R.D. County Multnomah

Merid. WM

N.F. Mt. Hood State Oregon

CORNER DIAGRAM

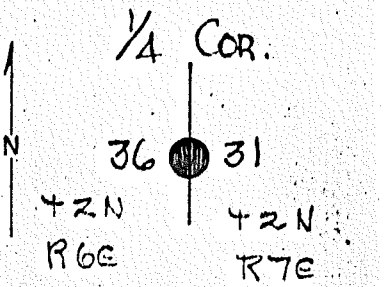

DESCRIBE CORNER MONUMENT FOUND

Found 36" Con. Mon. hit in State of Oregon trail construction.

2

DESCRIBE BEARING TREES OR OTHER OFFICIAL ACCESSORIES FOUND

Found $\frac{615}{810}$ chiseled on 4' x 5' x 7' rock leaning south
S 75° 28' W 26.68'

Found R.R.S. in scribed C.S.B.T. S 31 22" fir. Buried 18" in Forest Service trail construction with yellow tag.
N 84° 16' E 9.66'

3

PHOTO IDENTIFICATION DATA

Photo No.
Filed At.
Object Ident.
Ident. By
Signature

DESCRIBE CORNER LOCATION RELATIVE TO NEAR-BY FEATURES, ALSO HOW TO REACH CORNER

PLANE COORDINATE POSITION DATA

State Zone
X
Y
Estab. By
Agency

4

Signature Title Division Headquarters Date

CORNER RECORD (PERPETUATION)

MONUMENT: DESCRIBE NEW MONUMENT SET, OR WORK DONE TO PRESERVE EXISTING MONUMENT
Straightened Con. Mon. and referenced.

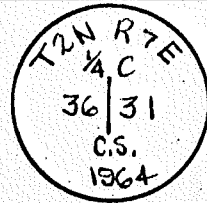

ACCESSORIES DESCRIBE NEW BT'S WITNESS OBJECTS ETC. ESTABLISHED, OR WORK DONE TO PRESERVE EXISTING EVIDENCE
Drove R.R.S. in 26" Fir N 36° 02' E 13.05'
Scribed 19" Fir C.S.B.T. and drove R.R.S. S 36° 02' W 23.80'
Brass cap W.C. on line 36|31 at base of mountain.

Work Done By Clair Pense Title County Surveyor Date 5/14/64 State Registration No. _____
or Agency _____

Certified Cor. Record Prepared ? Yes No Filed At: _____ Date _____

REMARKS

Index File No.

T.

R.

M.

Tract or Surv. No.

Cor.

13

Central REPORTED S

CONTROL CORNER

Index File No. Z 17

CORNER RECORD (SEARCH)

Tract or Survey No. _____

Cor. No. 105

T 2 N R. 6 E

R.D. _____ County Multnomah

Merid. WM

N.F. Mt. Hood State Oregon

CORNER DIAGRAM

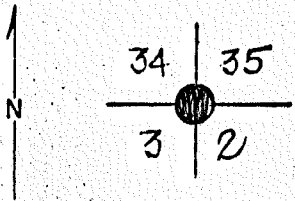

& verified this B.T. by _____

PHOTO IDENTIFICATION DATA

Photo No. _____
 Filed At. _____
 Object Ident. _____
 Ident. By _____
Signature 7

PLANE COORDINATE POSITION DATA

State _____ Zone _____
 X _____
 Y _____
 Estab. By _____
Agency 8

DESCRIBE CORNER MONUMENT FOUND

See Reverse

DESCRIBE BEARING TREES OR OTHER OFFICIAL ACCESSORIES FOUND

Found old B.T., "8" Ash N 60° 45' W 44.6" Set by Hammond's deputy in 1895. Now 18" tree with blazed ax marks. Located running Bonser's dist. of 2642' from $\frac{1}{4}$ cor. $\frac{35}{2}$ T 1 & 2 N - R 6E. Also found roots of fir stump N 49° 15' E 28.3'. Recorded by Hammond's deputy.

DESCRIBE CORNER LOCATION RELATIVE TO NEAR-BY FEATURES, ALSO HOW TO REACH CORNER

Signature _____ Title _____ Division _____ Headquarters _____ Date _____

CORNER RECORD (PERPETUATION)

MONUMENT: DESCRIBE NEW MONUMENT SET, OR WORK DONE TO PRESERVE EXISTING MONUMENT

Set concrete monument from N.W. B.T. Fir our survey by O.30; also good with U.P.R.R. AND Old Columbia River Highway Ties. Stamped & referenced as shown. Note - bearings established from our survey of S. line Sec. 35 T2 N - R 6 E.

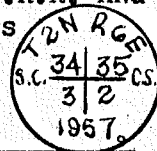

ACCESSORIES DESCRIBE NEW BT'S WITNESS OBJECTS ETC. ESTABLISHED, OR WORK DONE TO PRESERVE EXISTING EVIDENCE

Set 3/4" x 36" I.P. North 10.88'
 Set 3/4" x 36" I.P. N 56° 32' E 36.00'
 Scribed 24" Fir C.S.B.T. Drove R.R.S. N 56° 32' E 178.78'
 Set 3/4" x 36" I.P. South 56.90'
 Set 3/4" x 36" I.P. S 56° 32' W 32.36'

10

Work Done By Donald Ewing Title County Surveyor Date 10/24/58 State Registration No. _____
 or Agency _____

Certified Cor. Record Prepared ? Yes No Filed At: _____ Date _____

11

REMARKS

12

Index File No. T. R. M. Tract or Surv. No. Cor.

13

CONF. REPORTED CONTROL CORNER
Cor. No.

Index File No. 2 19
T 2 N R. 6 E
Merid. WM

CORNER RECORD (SEARCH) Tract or Survey No.
R.D. County Multnomah
N.F. Mt. Hood State Oregon

CORNER DIAGRAM

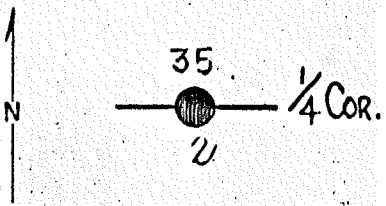

DESCRIBE CORNER MONUMENT FOUND
Stone and B.T. at this corner were removed, found marked stone lying on ground. In 1934 Ernest Nelson surveyed "Bonnie Park" subdivision and used this stone for initial point. We reestablished this $\frac{1}{4}$ corner from his I.P. on Sec. Line. Checks O.K. with survey of school property to South. 2

DESCRIBE BEARING TREES OR OTHER OFFICIAL ACCESSORIES FOUND
Found $\frac{3}{4}$ " I.P. 30.00' S 89° 57' 10" E and $\frac{1}{4}$ " I.P. 130.00' S 89° 57' 10" E. 3

PHOTO IDENTIFICATION DATA
Photo No.
Filed At.
Object Ident.
Ident. By
Signature 7

DESCRIBE CORNER LOCATION RELATIVE TO NEAR-BY FEATURES, ALSO HOW TO REACH CORNER 4

PLANE COORDINATE POSITION DATA
State Zone
X
Y
Estab. By
Agency 8

Signature Title Division Headquarters Date

CORNER RECORD (PERPETUATION)

MONUMENT: DESCRIBE NEW MONUMENT SET, OR WORK DONE TO PRESERVE EXISTING MONUMENT

Set 30" Concrete monument, stamped & referenced.

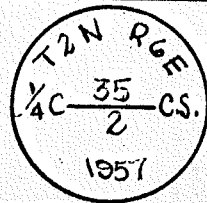

ACCESSORIES DESCRIBE NEW BT'S WITNESS OBJECTS ETC. ESTABLISHED OR WORK DONE TO PRESERVE EXISTING EVIDENCE

Cor. post school grounds fence S 0° 1' 50" W 82.84'
Cor. post school grounds fence S 88° 41' 50" W 48.65'

Work Done By Donald Ewing Title County Surveyor Date 10/22/56 State Registration No. _____
or Agency _____

Certified Cor. Record Prepared? Yes No Filed At: _____ Date _____

REMARKS

Index File No.

T.

R.

M.

Tract or Surv. No.

Cor.

12

13

REPORTED CONTROL CORNER

Index File No. Z 21

CORNER RECORD (SEARCH)

Tract or Survey No. _____
Cor. No. _____

T 2 N R. 6 E

R.D. _____ County Multnomah

Merid. WM

N.F. Mt. Hood State Oregon

CORNER DIAGRAM

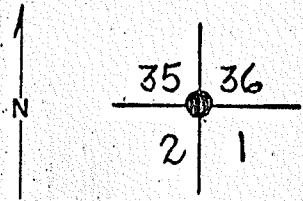

DESCRIBE CORNER MONUMENT FOUND

Found by pacing in $\frac{1}{2}$ mile from both N & W with compass, fits both lines good. Fits G.L.O. both for Devil's Canyon to south and two canyons to west. Fits G.L.O. traverse E. between

DESCRIBE BEARING TREES OR OTHER OFFICIAL ACCESSORIES FOUND

Found 14" Cottonwood G.L.O., 10" Cottonwood N $38^{\circ} 30'$ E 38 lk. 25.08. This tree whose fine rings indicated abnormally slow growth, had been chopped into 30 yrs. ago & indicated blaze had rotted out.

PHOTO IDENTIFICATION DATA

Photo No. _____
Filed At. _____
Object Ident. _____
Ident. By _____
Signature

DESCRIBE CORNER LOCATION RELATIVE TO NEAR-BY FEATURES, ALSO HOW TO REACH CORNER

PLANE COORDINATE POSITION DATA

State _____ Zone _____
X _____
Y _____
Estab. By _____
Agency

Signature _____ Title _____ Division _____ Headquarters _____ Date _____

CORNER RECORD (PERPETUATION)

MONUMENT: DESCRIBE NEW MONUMENT SET, OR WORK DONE TO PRESERVE EXISTING MONUMENT

Set corner from 1 B.T. N $38\frac{1}{2}^{\circ}$ E, 38 lks. Set 2" G.I.P. with brass cap, over corss on broad rock, piled rocks around. Stamped cap and referenced as shown. Bearings staff compass, Var. 20° .

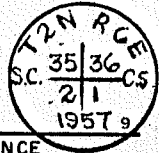

ACCESSORIES DESCRIBE NEW BT'S WITNESS OBJECTS ETC. ESTABLISHED, OR WORK DONE TO PRESERVE EXISTING EVIDENCE

Scribed 18" Fir C.S.B.T. Sec. 35 Drove small R.R.S. N 33° W 5.47'
 Put cross on exposed face of 6' x 3' rock N 13° 30' E 26.80
 Scribed 16" Fir C.S.B.T. Drove R.R.S. S 88° E 34.08'
 Drove R.R.S. in 24" Fir Stump S 21° W 48.65'

Work Done By Donald Ewing Title County Surveyor Date 11/7/57 State Registration No. _____ or Agency _____

Certified Cor. Record Prepared? Yes No Filed At: _____ Date _____

REMARKS

Index File No.

T.

R.

M.

Tract or Surv. No.

Cor.

12

13

13

12

11

10

6

INCH

SECTION OR SUBDIVISION S & S
TWP. 2N, RANGE 8 E, W.M.

CORNER No. 541

CORNER DESCRIPTION

I.R. SET BY
MARKÉCHASE
DEC 1971
W 1/4 COR

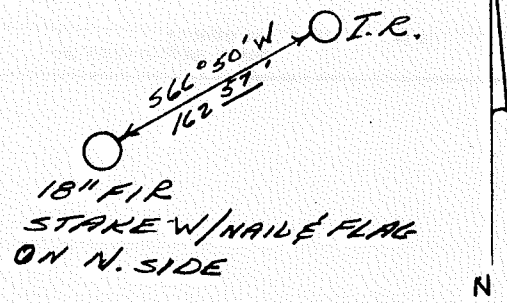

W.O. REF. MARKÉCHASE
71-929

CARD 1 OF 1

CORNER RECORD (PERPETUATION)

MONUMENT: DESCRIBE NEW MONUMENT SET OR WORK DONE TO PREPARE SURVEY

71
S
5
W

AD

Index File No. E-6

CORNER RECORD (SEARCH)

(Ref. FSM 7151.4)

Tract or Survey No. _____ Cor. No. W 1/16

T 2N R. 8E., W.M. R.D. COL GORG County HR.

Merid. _____ N.F. MT HOOD State OR

CORNER DIAGRAM

DESCRIBE CORNER MONUMENT FOUND SEE ATTACHED COUNTY CARD



DESCRIBE BEARING TREES OR OTHER OFFICIAL ACCESSORIES FOUND

PHOTO IDENTIFICATION DATA

Photo No. _____

Filed At. _____

Object Ident. _____

Ident. By _____

Signature

PLANE COORDINATE POSITION DATA

State _____ Zone _____

X _____

Y _____

Estab. By _____

Agency

Richmond

Signature

Title LS

Division

Headquarters

50

Date

2/24/56

7100-52 (3/68)

6

8

2

3

4

5

Index File No. E-7

CORNER RECORD (SEARCH)
(Ref. FSM 7151.4)

Tract or Survey No. _____ Cor. No. 1/4 COR

T 2N R. 8EWM R.D. Col. GORGE County H.R.
Merid. _____ N.F. MT HOOD State OR

CORNER DIAGRAM

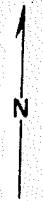

DESCRIBE CORNER MONUMENT FOUND _____ 1

DESCRIBE BEARING TREES OR OTHER OFFICIAL ACCESSORIES FOUND _____ 2

PHOTO IDENTIFICATION DATA

Photo No. _____
Filed At. _____
Object Ident. _____
Ident. By _____
Signature _____

DESCRIBE CORNER LOCATION RELATIVE TO NEAR-BY FEATURES, ALSO HOW TO REACH CORNER _____ 3

PLANE COORDINATE POSITION DATA

State _____ Zone _____
X _____
Y _____
Estab. By _____
Agency _____

J. Richmond Signature Title LS Division _____ Headquarters SO Date 2/24/86 FS-7100-52 (3/68) _____ 4

13
12

Cor.

Tract or Surv. No.

M.

SECTION OR SUBDIVISION MACOR

CORNER No. 540

TWP. 2N., RANGE 8 E, W.M.

CORNER DESCRIPTION

STONE 12" X 6" X 22"

"1/2" ON S. FACE

"C.S." ON N. FACE

W/NAIL ON TOP

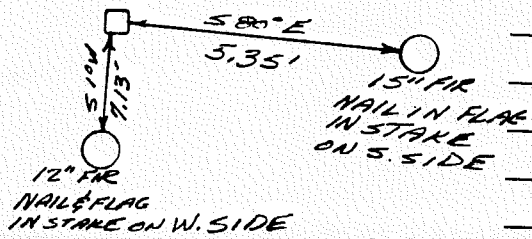

W.O. REF. MARX & CHASE

71-429

CARD..... OF

MONUMENT: DESCRIBE NEW MONUMENT SET, OR WORK DONE TO PRESERVE EXISTING MONUMENT

CORNER RECORD (PERPETUATION)

EVIDENCE

6

01

11