

Section: 31 Township:1 N Range: 11 E

Date: 5/29/24

Corner Designation Z4A (angle point)

- Condition Report Only
- Not Found
- Renewed
- Unrecorded
- Surveyed In
- Referenced Out

Previous Renewals/Surveys, etc:

(1859) The U.S. General Land Office contracted with David P. Thompson, Deputy Surveyor, under contract No. 79, to survey the Baseline from the southeast corner of section 32 in T1N R8E to the southeast corner of T1N R32E, conducted May 21, 1859 through June 8, 1859. References set:

- 6" Fir, N68W, 40 links
- 24" Fir, N30E, 43 links

(1882) The U.S. General Land Office contracted with Henry Meldrum, Deputy Surveyor, under contract No. 436, on April 26, 1882 to subdivide T1N R10E, conducted in November of 1882. Meldrum found Thompson's work through R11E to be out of specifications and therefore resurveyed the Baseline. Meldrum found "Old cor to Secs 31 and 32."

(1984) Danny Cron, under contract with the U.S. Forest Service, CS1985036, performed field work in the fall of 1984. Per Bureau of Land Management, old Thompson corners act as angle points and Cron set 3" aluminum cap stamped "T1N R11E AP S31/S1 T1S R10E 1984 PLS 1028" References set:

- 11" White Fir, S37E, 7.4', scribed "AP S1 BT"
- 13" White Fir, N5W, 17.', scribed "AP S31 BT"

(1994) R.A. Morris surveyed the south lines of section 36 T1N R10E and section 31 T1N R11E, CS1994132, for the U.S. Forest Service, conducted October 1993 and October 1994. Morris recovered the corner "3" alum cap per Survey No 85036."

Monument(s) & Accessories Found: (Condition and Source)

(2024) S. Deshong of US Forest Service, Columbia Land Zone recovered corner monument as set in 1984.

References found:

- Unrecorded 14" Hemlock, w/healed blaze and Bearing Tree/Land Survey Monument tags. Tag reads, "N10W 20.4"" Posted by "DAC" in Aug. 2008
- Unrecorded 25" Grand Fir, w/healed blaze and Bearing Tree/Land Survey Monument tags. Tag reads, "N84E 16.4"" Posted by "DAC" in Aug. 2008
- Bearing Tree tag found near down/decayed log, reads "S37E 7.4' 1984"

Monument Detail

3" aluminum cap, on 2.5" aluminum pipe, 3" above ground, reads: "T1N R11E AP S31/S1 T1S R10E 1984 PLS 1028"

Sketch

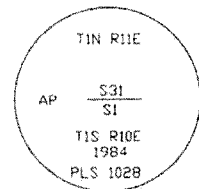

Monument Set (Procedures and Description)

None

New Accessories:

None

Surveyor's Seal

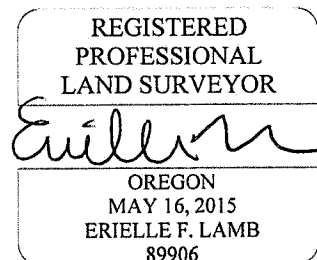

EXPIRES: 12/31/2024

Location & Comments:

- Set Aluminum guard posts 5' east and west of monument w/Property Boundary and Land Survey Monument signs attached.
- Painted 6" red bands on Bearing Trees and added new nails in tags.
- Corner lies approx 500' to West of Corner of S36, S31 and S1.
- Communication tower road is approx 550' to East

Compass Declination _____

Firm/Agency USDA Forest Service
Gifford Pinchot National Forest, Columbia Lands Zone

Address 987 McClellan Road
Vancouver, WA 98661

Party Chief S. Deshong

Notes _____

Witness R. Ellis, C. Clark