

SECTION OR SUBDIVISION

SEC 17

CORNER No. 1159

TWP. 1 N, RANGE 11 E, W.M.

CORNER DESCRIPTION

Set 5/8" IRON ROD  
 with a yellow cap  
 Put a tag on a  
 12" Douglas Fir  
 N 35° E 5.2' of  
 IRON ROD at HPC  
 NW Property Corner.

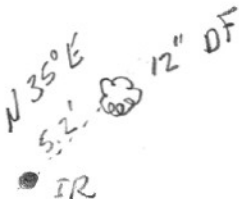

W.O. REF.

CARD 1 OF 1

HOOD RIVER COUNTY CORNER RESTORATION FORM

Section: 17 Township: 1N Range: 11E Date: 10/31/11

Corner Designation

PROPERTY CORNER

Condition Report Only  
 Not Found  
 Renewed CORNER CARD # 1159  
 Unrecorded  
 Surveyed In  
 Referenced Out

Previous Renewals/Surveys, etc: 95090

SET BY HOOD RIVER COUNTY

Monument(s) & Accessories Found: (Condition and Source)  
FOUND 5/8" REBAR, UP 0.6, LEANS NORTHWEST  
WITH SMASHED CAP, SET IN 95090.  
BEARING TREE W/TAG FOUND LAYING OVER.

Monument Detail

Sketch



Monument Set (Procedures and Description)

New Accessories:

BEARING TREE ADDED - 8" FIR S 85° E 14.05'

Location & Comments:

Surveyor's Seal

Compass Declination 16°  
Firm/Agency TENNESON  
ENGINEERING CORP.  
Address 3313 W. 2ND. ST.  
SUITE 100, THE DALLES, OR.  
Party Chief B. BESEDA  
Notes B. HOFFMAN  
Witness \_\_\_\_\_

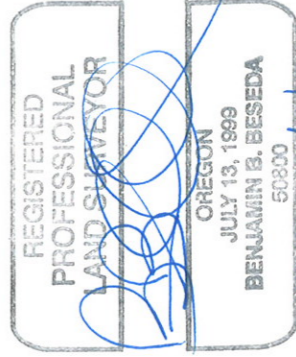

NOTE: BEARING TREES PAINTED WITH RED AND BLUE BANDS  
ALSO PAINTED "RP" ON BACK SIDE OF TREES.