

CC 1131

OREGON CORNER RESTORATION FORM

Section 26 Township 1 N Range 9 E

County Hood River Date May 13, 2011

CORNER DESIGNATION CS 1/16 Corner

Condition Report Only
 Not Found
 Renewed
 Unrecorded
 Surveyed In
 Referenced Out

Previous Renewals/Surveys, etc. Corner established by Tenneson Engineering Corp. by survey dated 5-10-68, filed April 29, 1969, SC-1271, Corner Card No. 1131.

Monument(s) & Accessories Found: (Condition and Source)
Found 5/8" rebar with 1-1/2" aluminum cap (no marks on cap) set by Tenneson 1968.
16" dead W. Fir with healed scar facing corner, Bearing Tree tag dated 5/16/85, bearing
N 87° E at distance of 21.0 on tag; 14" W. Fir with scribe visible on ground badly
decayed. White 4" x 4" Post on ground next to corner

Monument Detail

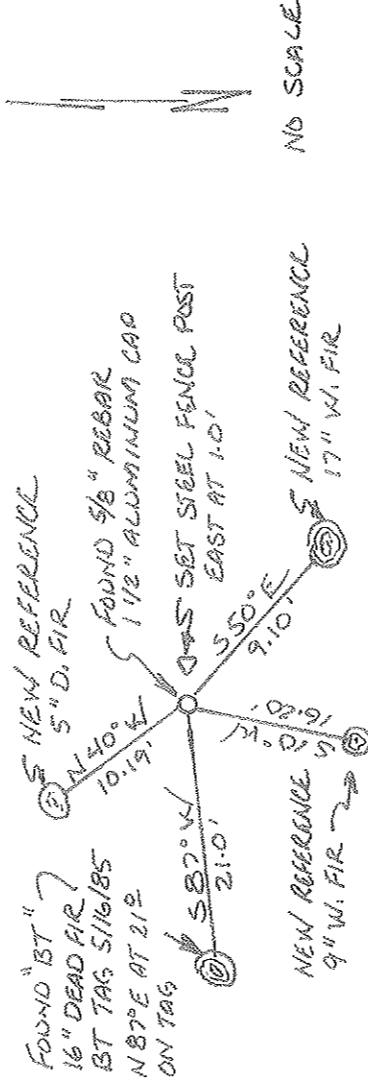

Sketch

Monument Set (procedures and Description)

New Accessories

5" D. Fir N 40 W at 10.19' (scribed SC 1/16 S26 BT); 17" W. Fir S 50 E at 9.10' (scribed
SC 1/16 S26 BT); 9" W. Fir S10 W at 16.20' (scribed SC 1/16 S26 BT); Steel fence post
East at 1.0'. New accessories have location tag above scribe and 20p nail at base of
scribe; all oriented toward monument. Bearing taken with hand compass having
declination of 21 East.

Location & Comments

Corner is approximately
600' west of existing
Gravel road

Surveyor's Seal

Compass Declination 21 E
 Firm/Agency: Ford Land Surveying
 Address: PO Box 353
Klickitat, WA 98628
 Party Chief: George Ford
 Notes: Field Book: 2011-2
 Witness: Charles Lysiak

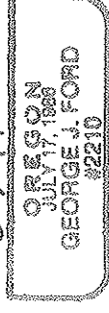

RECEIVED JUN -7 2011

SECTION OR SUBDIVISION

C-S 1/16 S26

CORNER No.

1131

TWP. 1N, RANGE 9 E, W.M.

CORNER DESCRIPTION

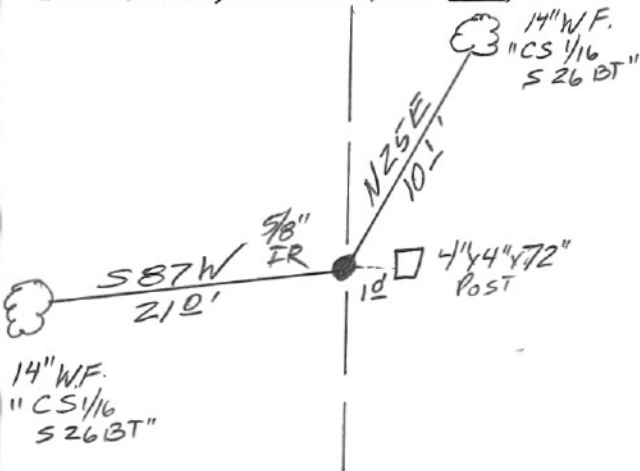

SET BY TEC 1962
BT's, Post SET BY
O.S.F.O. in 1985

W.O. REF.

CORNER REPORT FILE

CARD

OF