

CC 1129

OREGON CORNER RESTORATION FORM

Section 26 Township 1 N Range 9 E

County Hood River Date May 13, 2011

CORNER DESIGNATION S 1/16 Corner
S 26- S25

- Condition Report Only
- Not Found
- Renewed
- Unrecorded
- Surveyed In
- Referenced Out

Previous Renewals/Surveys, etc. Corner established by Tenneson Engineering Corp. by survey dated 5-10-68. filed April 29, 1969, SC-1271, Corner Card No. 1129.

Monument(s) & Accessories Found: (Condition and Source)
Found 5/8" rebar with 1-1/2" aluminum cap (no marks on cap) set by Tenneson 1968.
21" D. Fir with healed scar facing corner, O.S.B.F. Bearing Tree tag dated 1985.
bearing N 37 W at distance of 17.0 on tag; 24" D. Fir with healed scar facing corner.
O.S.B.F. Bearing Tree tag dated 1985, N 86 E at a distance of 13.4' on tag, decayed.
White 4"x 4" Post on ground next to corner

Monument Detail

Sketch

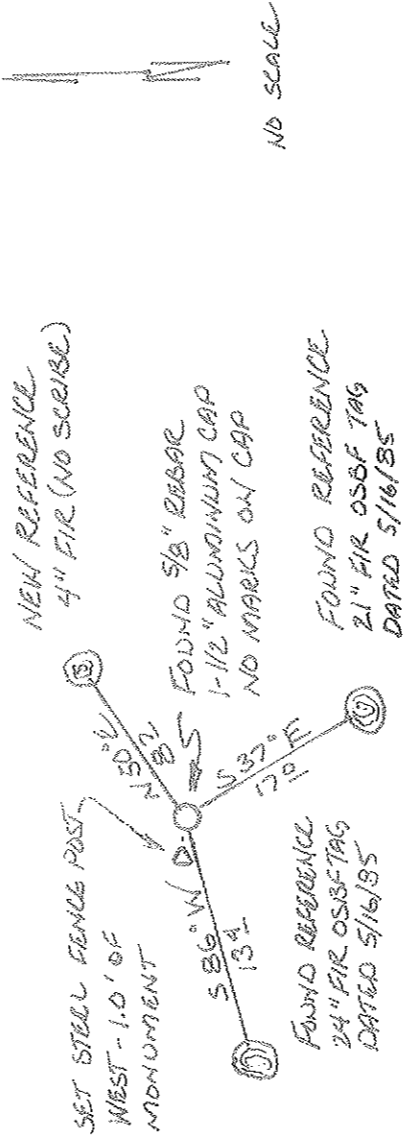

Monument Set (procedures and Description)

N/A

New Accessories

4" D. Fir N 50 E at 8.7' (no scribe); no other trees suitable; Steel fence post West at 1.0'.
New accessories have location tag above scribe and 20p nail at base of scribe; all
oriented toward monument. Bearing taken with hand compass having declination of 21
East.

Location & Comments

No comments

Compass Declination 21
Firm/Agency:
Ford Land Surveying
PO Box 353
Klickitat, WA 98628
Party Chief: George Ford
Notes: Field Book - 2011-2
Witness: Charles Lysiak

Surveyor's Seal



RECEIVED JUN - 7 2011

SECTION OR SUBDIVISION

S 1/16 S 25 / 26

CORNER No.

1129

TWP.

1N

RANGE

9 E

W.M.

CORNER DESCRIPTION

SET BY T.E.C. 11/12

BT'S SET BY O.S.F.D.

14 1985 SET POST.

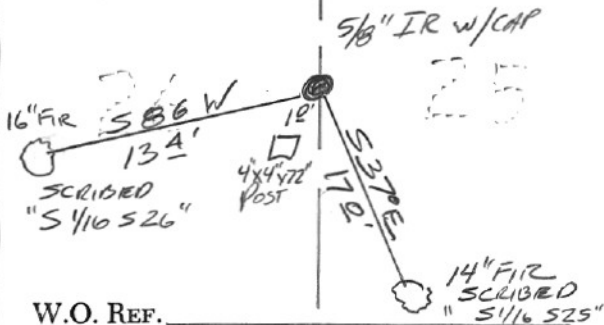

W.O. REF.

"CORNER REPORT FILE"

CARD

OF