

SECTION OR SUBDIVISION Sect. 6

CORNER No. 1114

TWP. 1N, RANGE 11E, W.M.

↑N Prop. cor.

CORNER DESCRIPTION

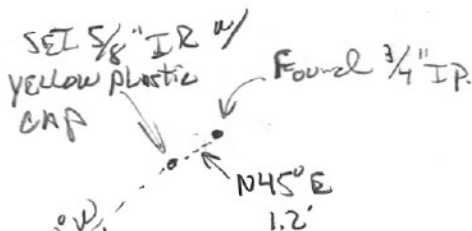

Set 5/8" IR w/ yellow
 plastic cap from which
 a tagged 6" DF bears
 S 60° W 12.0'. Also,
 found a 3/4" IP N 45° E
 approx. 1.2'

W.O. REF.

"ELAINE" Job File PT. #56

CARD BK 2/88 OF A 8