

SECTION OR SUBDIVISION

$\frac{1}{4}$ cor 31/32

CORNER No.

1022

TWP.

1N

RANGE

10

W.M.

CORNER DESCRIPTION



cor is 1" IP
on west edge
of Old Parkdale
Rd.

W.O. REF.

CARD

OF

SECTION OR SUBDIVISION 1/4 31/32

CORNER No. 1022

TWP. N, RANGE 10, W.M.

CORNER DESCRIPTION

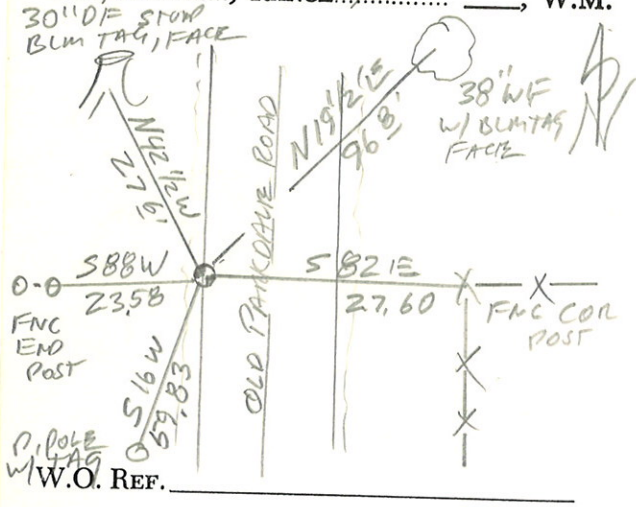

FD-BC 4" DEEP

1/4 AC @ WEST FOG LINE

ADDED 3 TIES BY 10/07

CARD 2 OF 2