

SECTION OR SUBDIVISION $\frac{1}{4}$ COR 16 15

TWP. 2N, RANGE 10 E, W.M.

CORNER No. 1001

CORNER DESCRIPTION

POWER POLE
060111-17

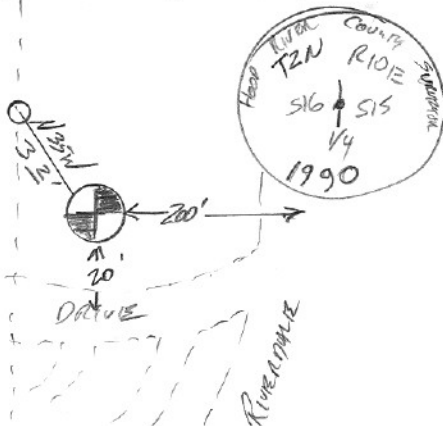

W.O. REF. 1-91, pg 12-26

COR. IS $\frac{3}{4}$ I.P. AS TIED BY KLEIN FROST & D.L.C. 2-91 CORNER NOT FOUND; PROBABLY TORN OUT WHEN POWER POLE REPLACED; SET I.P./B.C. @ POSITION AS PER ABOVE SURVEYORS BY TRAVERSE TO SEC CORNS NE S of $\frac{1}{4}$ COR; PLACED RING OF STONES AROUND MON.

CARD 1 OF 1