

SECTION OR SUBDIVISION

TWP. 2N, RANGE 9, W.M.

CORNER No. 967

CORNER DESCRIPTION

cor. set by
proportion - 1980
by T.E.C.

CORNER RECORD (PERPETUATION)

J-13

MONUMENT DESCRIBE NEW MONUMENT SET, OR WORK DONE TO PRESERVE EXISTING MONUMENT

Set aluminum cap on a 2-1/2 inch pipe, 30 inches long, 24 inches in the ground, and built a mound of stone.



ACCESSORIES DESCRIBE NEW BT WITNESS OBJECTS ETC. ESTABLISHED, OR WORK DONE TO PRESERVE EXISTING EVIDENCE

- A douglas fir, 16" diam. bears N. 4° E 23.0 ft., marked T2N R9E S10 BT.
- A douglas fir, 10" diam. bears S. 80° E 15.5 ft., marked T2N R9E S15 BT.
- A douglas fir, 12" diam. bears S. 39° W. 14.0 ft., marked T2N R9E S16 BT.
- A douglas fir, 6" diam. bears N. 13° W 18.3 ft., marked T2N R9E S9 BT.

Work Done By Lawrence E. Jones Surveyor Date 9/80 State Registration No. LS #994

Certified Cor Record Prepared? Yes No Filed At Date

REMARKS

Index File No. J-13

CORNER RECORD (SEARCH)

(Ref. FSM 7151.4)

Tract or Survey No. CS81-097

Cor. Sec. No. 9-10-15-16

T 2N R. 9E

R.D. Hood River County Hood River

Merid. Willamette

N.F. Mt. Hood State Oregon

CORNER DIAGRAM

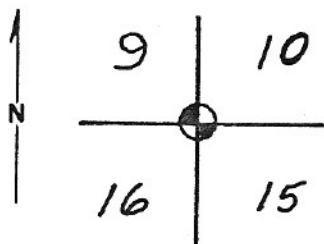

DESCRIBE CORNER MONUMENT FOUND

None. Corner position re-established by single proportionate measure from found corners 1 mile east and west as per the same procedure used when corner was originally set by GLO.

DESCRIBE BEARING TREES OR OTHER OFFICIAL ACCESSORIES FOUND

None.

PHOTO IDENTIFICATION DATA

Photo No. _____

Filed At. _____

Object Ident. _____

Ident. By _____

Signature

PLANE COORDINATE POSITION DATA

State Oregon Zone North

X 730,247.80

Y 1,696,185.70

Estab. By TEC

Agency

DESCRIBE CORNER LOCATION RELATIVE TO NEAR-BY FEATURES, ALSO HOW TO REACH CORNER

From junction of roads N-20 and N-21 go northeast on N-21 a distance of 1.9 mile, more or less. Take right fork and stay on main gravel road to end. Corner lies north 1,000 ft., more or less, top of ridge.

Signature _____ Title _____ Division _____ Headquarters _____ Date _____ 7100-52-(3.68)

Surveyor

Sept 1, 1980

CORNER RECORD (PERPETUATION)

MONUMENT: DESCRIBE NEW MONUMENT SET, OR WORK DONE TO PRESERVE EXISTING MONUMENT

Set aluminum cap on a 2-1/2 inch pipe, 30 inches long, 24 inches in the ground, and built a mound of stone.

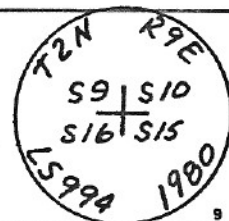

ACCESSORIES: DESCRIBE NEW BT'S WITNESS OBJECTS ETC. ESTABLISHED, OR WORK DONE TO PRESERVE EXISTING EVIDENCE

- A douglas fir, 16" diam. bears N. 4°E 23.0 ft., marked T2N R9E S10 BT.
- A douglas fir, 10" diam. bears S. 80° E 15.5 ft., marked T2N R9E S15 BT.
- A douglas fir, 12" diam. bears S. 39° W. 14.0 ft., marked T2N R9E S16 BT.
- A douglas fir, 6" diam. bears N. 13° W 18.3 ft., marked T2N R9E S9 BT.

Work Done By Lawrence E. Jones Title Surveyor Date 9/80 State Registration No. LS #994

Certified Cor. Record Prepared? Yes No Filed At: _____ Date _____

REMARKS