

SECTION OR SUBDIVISION

CORNER No. 885

TWP. 2N, RANGE 10 E, W.M.

CORNER DESCRIPTION

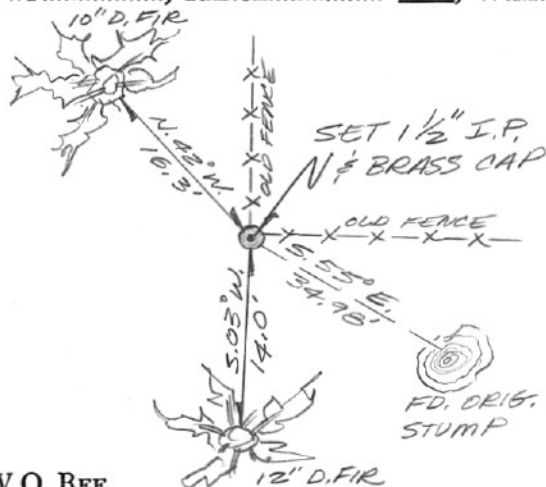

CORNER IS A
1 1/2" IRON PIPE
WITH BRASS CAP
MARKED;
HOOD RIVER COUNTY
T2N R10E W.M.
1981
1/28
433

W.O. REF. _____

CARD OF