

SECTION OR SUBDIVISION

$\frac{1}{4}$

$\frac{30}{31}$

TWP. 2N, RANGE 10 E, W.M.

CORNER No. 883

CORNER DESCRIPTION

CORNER IS A
1 1/2" IRON PIPE
WITH BRASS CAP.
B.C. MARKED
T2N, R10E.
1/4 $\frac{530}{331}$ 80 H.R.C.



W.O. REF. _____

CARD OF

LAND CORNER MONUMENT RECORD

R. 10 E.

LOCATION

LC 883

T. 2

	6	5	4	3	2
					1
	7	8	9	10	11
					12
	18	17	16	15	14
					13
	19	20	21	22	23
					24
	30	29	28	27	26
					25
	31	32	33	34	35
					36

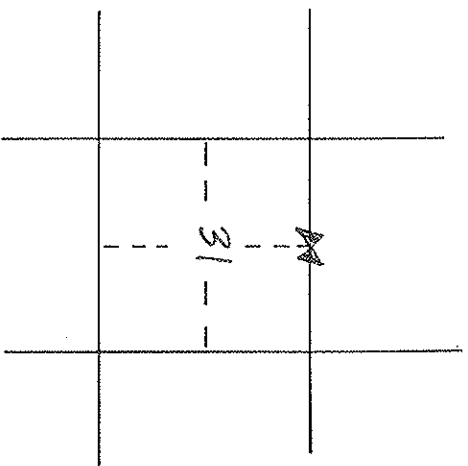

TOWNSHIP 2N RANGE 10E SECTION 31

TYPE OF MONUMENT; TIES TO BEARING TREES, OBJECTS, etc. (SKETCH)

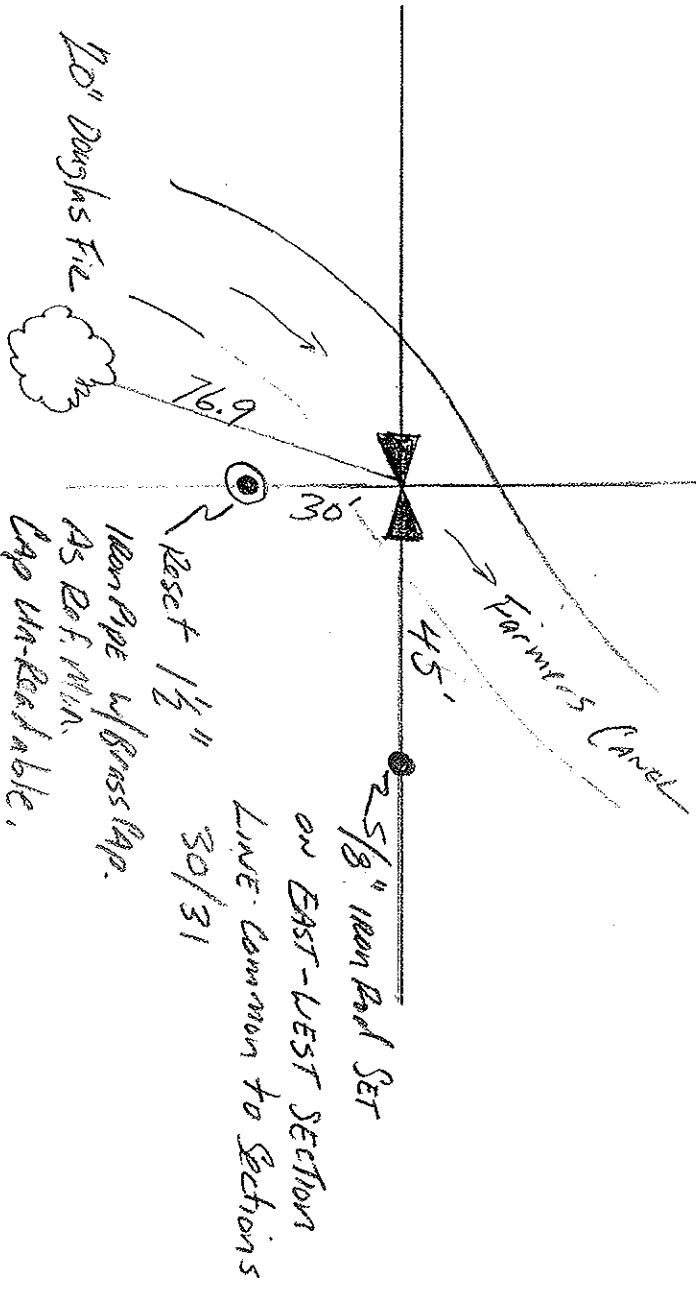

REMARKS: (History of Corner, etc.)

(FIELD BOOK 15, page 105 @ County Surveyors Office)

- A.S. Patallo - SET STONE @ position NOV 21ST 1909 - Later Replaced by PIPE
- CMH HAN-UBAET DR. LICENSE #766 - LOCATED IN 1924
- W. Perkins - LOCATED IN 1955
- " " - LOCATED IN 1958 C.S. 0574
- Bishop L.S. 896 - LOCATED IN Ditch 1980 C.S. 80082
- DAWD L.S. 2393 - LOCATED 2001 C.S. 2001-05
- CORNER DESTROYED IN 2009 - 2010
- RESET AS REFERENCED MON (AS SHOWN) JULY 2010, LS 72306

NAME ERIK M. CARLSON DATE 11-4-2010

REGISTRATION NO. 72306