

SECTION OR SUBDIVISION

8 | 9
17 | 16

TWP. 2N, RANGE 9 E, W.M.

CORNER No. 876

CORNER DESCRIPTION

B.C. WI 2 1/2" I.P. WI

MO. OF STONES

SET BY TEC 7/1980

FD 18" X 14" X 10" STONE

NO MK.

1 ORG B.T.

NEW B.TS MKD.

T2N R9E S (BT)

CARD OF

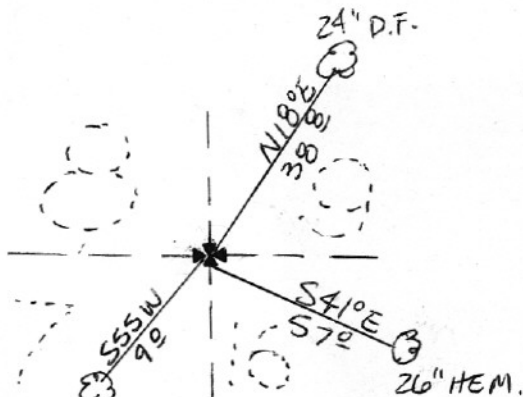

W.O. REF. 15 X 2 X 25 BLDS
MKD "X"

USDA-FOREST SERVICE

Index File No. J-9

CORNER RECORD (SEARCH)
(Ref. FSM 7151.4)

CC0876
Tract or Survey No. CS81-097 Cor. Secs. 8-9-16-17

T 2N. R. 9E. R.D. Hood River County Hood River
Merid. Willamette N.F. Mt. Hood State Oregon

CORNER DIAGRAM

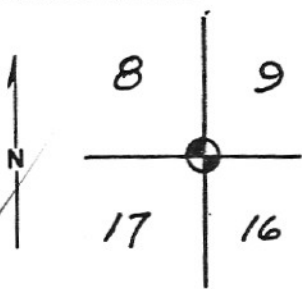

DESCRIBE CORNER MONUMENT FOUND

18"x14"x10" stone at proper location from GLO bearing tree, but with no visible markings.

DESCRIBE BEARING TREES OR OTHER OFFICIAL ACCESSORIES FOUND

A 6" fir bears N. 40° W. 22.4 feet.

PHOTO IDENTIFICATION DATA

Photo No. _____
Filed At. _____
Object Ident. _____
Ident. By _____
Signature

DESCRIBE CORNER LOCATION RELATIVE TO NEAR-BY FEATURES, ALSO HOW TO REACH CORNER

Take Warren Lake Trail from Old Mt. Defiance Road. Go 1/4 mile west of lake to orange ribbon line north and south. Go north 2500 feet to corner.

PLANE COORDINATE POSITION DATA

State _____ Zone _____
X _____
Y _____
Estab. By _____
Agency

Signature

Title Surveyor

Division _____

Headquarters _____

Date

July, 1980

7100-52 (3-68)

CORNER RECORD (PERPETUATION)

J-9

MONUMENT: DESCRIBE NEW MONUMENT SET, OR WORK DONE TO PRESERVE EXISTING MONUMENT

Set brass disc on a 2-1/2" galvanized pipe, 30 inches long, 24 inches in the ground and built a mound of stone.

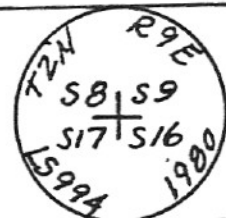

ACCESSORIES DESCRIBE NEW BT'S WITNESS OBJECTS ETC. ESTABLISHED, OR WORK DONE TO PRESERVE EXISTING EVIDENCE

A fir 24" in diameter bears N. 18° E. 38.8 ft. dist. marked T 2 N, R 9 E, S 9 (BT)
A hemlock 26" diameter bears S. 41° E. 57.0 ft. dist. marked T 2 N, R 9 E, S 16 (BT)
A boulder 1.5'x2'x2.5' exposed bears S. 55° W. 9.0 ft. dist. marked "X"

Work Done By Lawrence E. Jones Title Surveyor Date 7/80 State Registration No. L.S. 994

Certified Cor. Record Prepared? Yes No Filed At: _____ Date _____

REMARKS

CC0876

Index

CORNER RECORD (SEARCH)

Tract or

Cor. 8-9-16-17

File No. J-9

(Ref. FSM 7151.4)

Survey No. CS81-047

T 2N. R. 9E.

R.D. Hood River

County Hood River

Merid. Willamette

N.F. Mt. Hood

State Oregon

CORNER DIAGRAM

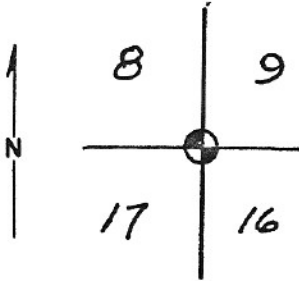

DESCRIBE CORNER MONUMENT FOUND

18"x14"x10" stone at proper location from GLO bearing tree, but with no visible markings.

DESCRIBE BEARING TREES OR OTHER OFFICIAL ACCESSORIES FOUND

A 46" fir bears N. 40° W. 22.4 feet.

PHOTO IDENTIFICATION DATA

Photo No. _____

Filed At. _____

Object Ident. _____

Ident. By _____

Signature

PLANE COORDINATE POSITION DATA

State Ore Zone North

X 730,292.67

Y 1,690,884.29

Estab. By TEC

Agency

Signature

Title

Division

Headquarters

Date

7100-52 (3.68)

Surveyor

July, 1980

CORNER RECORD (PERPETUATION)

J-9

MONUMENT: DESCRIBE NEW MONUMENT SET, OR WORK DONE TO PRESERVE EXISTING MONUMENT

Set brass disc on a 2-1/2" galvanized pipe, 30 inches long, 24 inches in the ground and built a mound of stone.

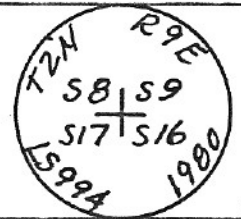

ACCESSORIES DESCRIBE NEW BT'S WITNESS OBJECTS ETC. ESTABLISHED, OR WORK DONE TO PRESERVE EXISTING EVIDENCE

- A fir 24" in diameter bears N. 18° E. 38.8 ft. dist. marked T 2 N, R 9 E, S 9 (BT)
- A hemlock 26" diameter bears S. 41° E. 57.0 ft. dist. marked T 2 N, R 9 E, S 16 (BT)
- A boulder 1.5'x2'x2.5' exposed bears S. 55° W. 9.0 ft. dist. marked "X"

Work Done By Lawrence E. Jones Title Surveyor

Date 7/80

State Registration No.

L.S. 994

Certified Cor Record Prepared? Yes No

Filed At.

Date

REMARKS