

HOOD RIVER COUNTY CORNER RESTORATION FORM

Section: 12 & 13 Township: 2N Range: 7E Date: 6-11-2021

Corner Designation:

Quarter corner of Sections 12 and 13

- Condition Report Only
- Not Found
- Renewed
- Unrecorded
- Surveyed In
- Referenced Out

Previous Renewals/Surveys, etc:

1925 - Record of Survey CS1482 by McQuinn and Powers described an iron pipe found and recorded the following bearing trees:

- 30" fir N86°30'W 46.44'
- 4" oak N24°15'E 5.39'
- 24" fir S04°48'E 34.50'

1973 - Hood River County forces found a 1-1/2" iron pipe and set a brass cap inside, as described in Corner Card 0645. The following accessories were noted:

- Nail and shiner 1 foot up on the north side of a 12" cherry East 12.3'
- Nail and shiner 1 foot up on the north side of a 30" maple S50°W 5.7'

1987 - Record of Survey CS87047 by L. Bishop described a brass cap pipe set by Hood River County found firmly in a mound of stone and recorded the following bearing trees:

- 48" sawed, rotted, doug fir stump with no marks (from Powers' survey) N85-1/2°W 46.4'
- 32" doug fir (from Powers' survey) S02°E 35.9'
- 6" maple scribed "1/4S12BT" N50°W 28.1'
- 18" doug fir scribed "1/4S13BT" S52°E 17.6'

Records of Survey CS93005, CS 96015, and CS2014008 all described a brass cap found marking this corner position with no accessories noted.

Monument(s) & Accessories Found: (Condition and Source)

On May 17, 2021, Erielle Lamb, PLS found a 3" brass cap in concrete flush with ground surface one foot west of an orange carsonite post. The following accessory was recovered:

Found 46" fir (from Bishop survey) S02°E 35.9'

Monument Detail

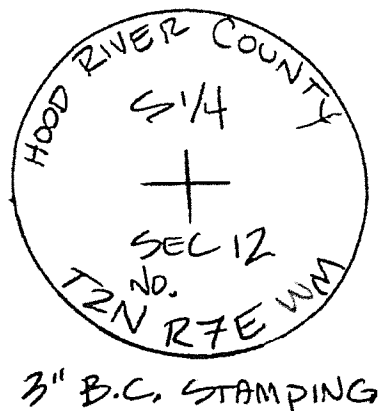

Sketch

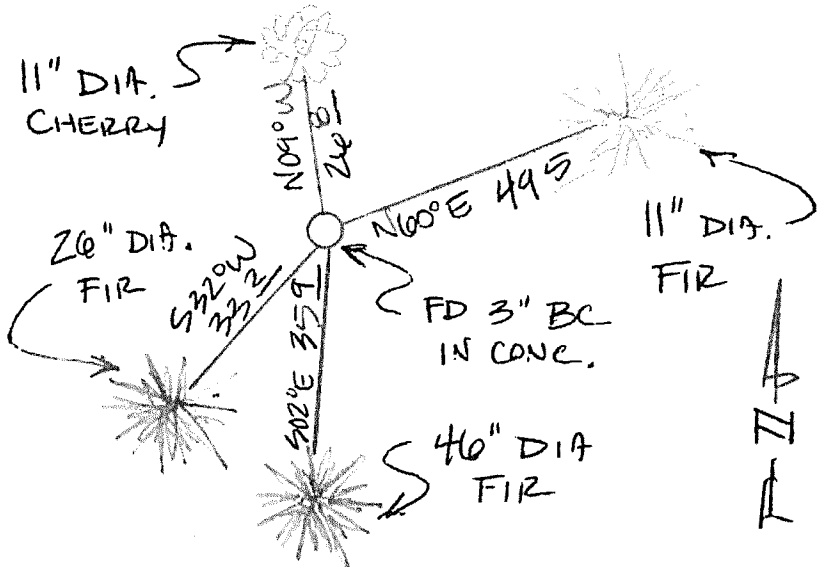

645

**Monument Set (Procedures and Description)**

None

**New Accessories:**

Set mag nail and brass washer right side center of 11" fir scribed "XBT" N60°E 49.5'

Set mag nail and brass washer right side center of 26" fir scribed "1/4S13 BT" S32°W 33.2'

Set mag nail and brass washer right side center of 11" cherry scribed "XBT" N09°W 26.8'

**Location & Comments:**

The corner is on a south facing slope, approximately 100 feet north of the Pacific Crest Trail #2000.

**Coordinates**

ORCS- Oregon North NAD83,

Grid Coordinates

Northing: 730476.799

Easting: 7848951.152

Elev: 659.425'

**Compass Declination:** 16°E

**Firm/Agency:**

U.S.D.A. Forest Service

**Address:**

987 McClellan Rd.

Vancouver, WA 98661

**Party Chief:**

Erielle Lamb, PLS

**Notes:**

CRG2021-04 Cascade Locks Trail

**Witness:**

D. Londen and R. Ellis

**Surveyor's Seal:**



EXPIRES: 12/31/2022

SECTION OR SUBDIVISION Sec. 12 S  $\frac{1}{4}$  COR. CORNER No. 645

TWP. 2N, RANGE 7 E, W.M.

CORNER DESCRIPTION

BRASS CAP SET IN  
1 1/2" I. P. 6-73 HRCO

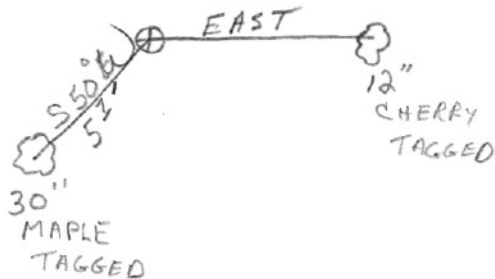

\* SEE BACK of CARD 2

W.O. REF. \_\_\_\_\_

CARD 1 OF 2

SECTION OR SUBDIVISION

1/4 cor 12/13

CORNER No.

6415

TWP. 2N, RANGE 7E, W.M.

CORNER DESCRIPTION

\* SEE BACK

(21)

FOUND: Bk. 6-P. 15 Powers reference trees

30" Fir now a 48" sawed, rotted D-Fir stump N85 1/2W 46.4' no marks

24" now 32" D-Fir S2E 35.9' (RECORD S4-48E 34.5) no marks

4" Oak gone as are all traces of the original BTs

Monument firmly set in a small mound of stone stamped:

S1/4 MARKED:

6" Maple N50W 28.1' scribed 1/4S12BT

S12 8" D-Fir S52E 17.6' " 1/4S13BT

T2NR7E

W.O. REF.

CS # 87047

CARD

2

OF

2

Book 1-88 pg. 100-99  
Field R.P.'d

7/28/88

↑  
N

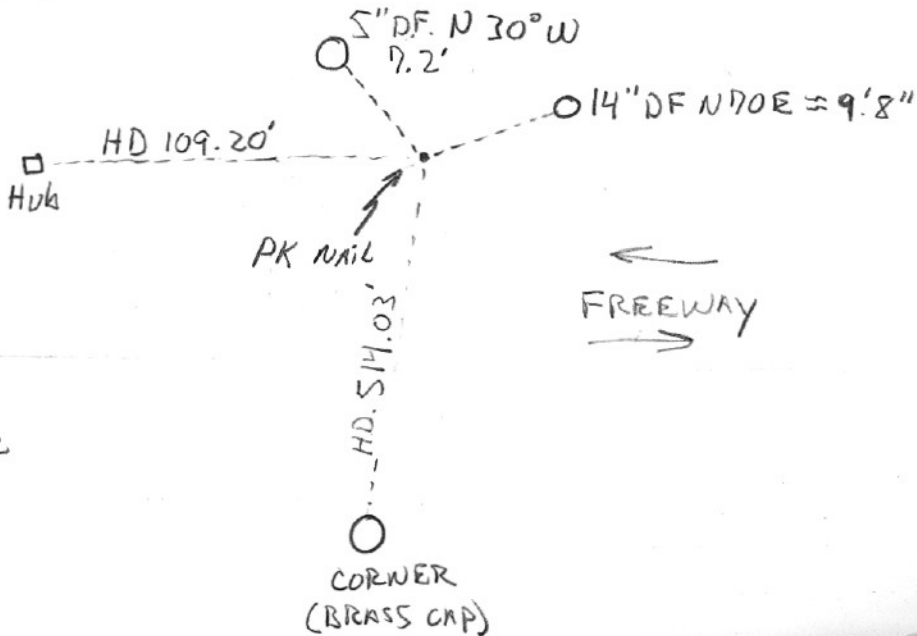

Hub + PK ARE  
AT TOP OF  
BLUFF

HOOD RIVER COUNTY

T 2N . R 7E , W.M.

Corner Code No. CC0645

Segregated Surveys:

Name 1/4 Corner 12/13 Corner No. \_\_\_\_\_  
(DLC, HES, Tract, Mining Claim, Indian Allotment, Federal Reserve, Townsite)

1. History of Corner Establishment and Subsequent Restoration:

1-1/2" iron pipe found in 1973 by Hood River County and remonumented same year.  
Brass cap was set in found pipe.

2. Description of Evidence Found:

1-1/2" iron pipe with tagged maple tree

3. Describe Monument, Accessories and Corollary Data to Perpetuate this Corner Location, Diagram corner and indicate meridian and reference to map of record. Surveyor's Field Book No. 3-75 Page No. \_\_\_\_\_ Date of work \_\_\_\_\_.

1/4 corner is 1-1/2 inch iron pipe with brass cap  
12" tagged cherry tree bears East 12.30 feet  
30" maple with tag bears S 50°W 5.70 feet

Oregon Plane Coordinates: \_\_\_\_\_ North Zone, X 1,644,524.526 Y, 730,534.903

Second Order Accuracy. Derived from: \_\_\_\_\_,

Pin Pointed on Photo No. \_\_\_\_\_ Date \_\_\_\_\_ Located at \_\_\_\_\_

Note: X = Easting  
Y = Northing

CC0645

1-1/2" iron pipe with brass cap

DESCRIPTION OF SURVEY STATION

STATE OREGON

COUNTY HOOD RIVER

NAME OF STATION S 1/4 Cor. Sec. 12 T2N, R7EWM

JOB NO. 18-75

CHIEF OF PARTY David Downing FIELD NOTES same DATE 11-18-75

STATION MARK	SURVEY POINTS AND PROMINENT OBJECTS WHICH CAN BE SEEN FROM GROUND STATION	DISTANCE	BEARING
B-4	1" iron pipe with yellow plastic cap marked H.R.C.  NOTE: All bearings and distances are Oregon State Plane Coordinates, North Zone	751.62'	S78°38'02"W

