

SECTION OR SUBDIVISION

11  
14

CORNER No. 312

TWP. 1N, RANGE 10, W.M.

CORNER DESCRIPTION

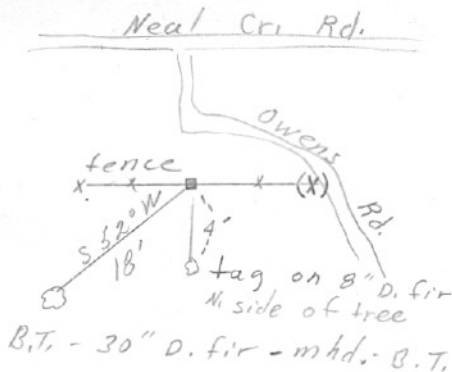

1/4 Cor.

1" pipe 10" high  
states a rotted down  
stump with scribbling  
in bark

fd. by V.R.E. - 1950

(x) line marker on  
fc. post along Owens Rd.

W.O. REF. \_\_\_\_\_

CARD \_\_\_\_\_ OF \_\_\_\_\_