

SECTION OR SUBDIVISION

CORNER No. 99

TWP.....1N....., RANGE.....9 E, W.M.

CORNER DESCRIPTION

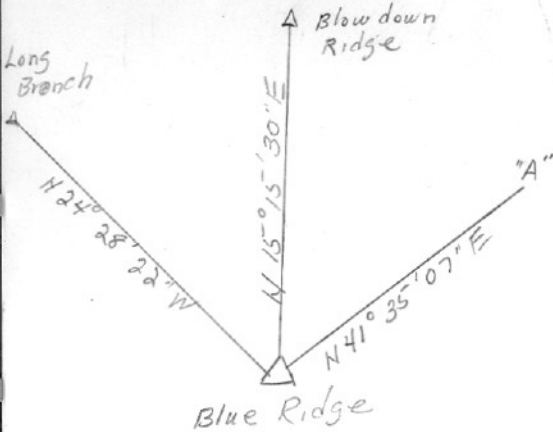

Blue Ridge
US C + B S.
Brass cap
Triangulation
point.
Not a corner

y = 676,032.0
x = 1,689,129.9

W.O. REF. _____

Jennison #3737 Cor #277

CARD..... OF