

SECTION OR SUBDIVISION

TWP. 1N, RANGE. 10E, W.M.

CORNER No. #68

CORNER DESCRIPTION

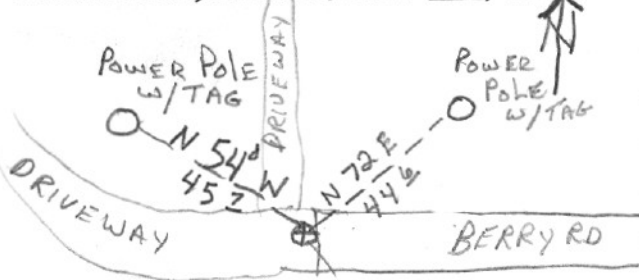

COR. IS $\frac{1}{2}$ " I.P.
 LOCATED AT WEST END
 OF SPERRY RD WHERE
 DRIVEWAYS START. COR
 IS 4" UNDER SURFACE
 OF GRAVEL RD.

W.O. REF.

8/25/76
 MONUMENT RISER CEMENTED
 IN AROUND IRON PIPE W/HID
 9-6-00 LP + RW

CARD

OF